

FILE NO. W0204
 DRAWING NO. W0204
 SCALE 1" = 800'
 MINIMUM DEGREE OF ACCURACY 1" = 200'
 PROVEN SOURCE OF ELEVATION OPERATORS RECORDS

I THE UNDERSIGNED, HEREBY CERTIFY THAT THIS PLAT IS CORRECT TO THE BEST OF MY KNOWLEDGE AND BELIEF AND SHOWS ALL THE INFORMATION REQUIRED BY LAW AND THE REGULATIONS ISSUED AND PRESCRIBED BY THE DEPARTMENT OF MINES.

(SIGNED) [Signature]
 R. P. E. _____ L. L. S. 423

PLACE SEAL HERE

(+) DENOTES LOCATION OF WELL ON UNITED STATES TOPOGRAPHIC MAPS
 FORM IV-6
 (8-78)



Division of Environmental Protection
 Office of Oil & Gas

DATE JUNE 27, 2003
 OPERATOR'S WELL NO. _____
 API WELL NO. _____
47 - 039 - 02235-F
 STATE COUNTY PERMIT

WELL TYPE: OIL _____ GAS X LIQUID INJECTION _____ WASTE DISPOSAL _____
 (IF "GAS", PRODUCTION _____ STORAGE _____ DEEP _____ SHALLOW X)
 LOCATION: ELEVATION 904.25' WATER SHED POCOTALIGO RIVER
 DISTRICT POCA COUNTY KANAWHA
 QUADRANGLE SISSONVILLE 7.5'
 SURFACE OWNER KANAWHA VALLEY ADVERTISING ACREAGE 348.48
 OIL & GAS ROYALTY OWNER KANAWHA VALLEY ADVERTISING LEASE ACREAGE 348.48
 LEASE NO. _____
 PROPOSED WORK: DRILL _____ CONVERT _____ DRILL DEEPER _____ REDRILL _____ FRACTURE OR STIMULATE _____ PLUG OFF OLD FORMATION _____ PERFORATE NEW FORMATION X OTHER PHYSICAL CHANGE IN WELL (SPECIFY) _____
 PLUG AND ABANDON _____ CLEAN OUT AND REPLUG _____
 TARGET FORMATION DEVONIAN SHALE ESTIMATED DEPTH _____
 WELL OPERATOR VIKING ENERGY INC. DESIGNATED AGENT _____
 ADDRESS P.O. Box 13366 ADDRESS MICHAEL PINKERTON
SISSONVILLE, WV 25360

DEEP WELL 6-6 Rocky Fork 312 Charleston, WV

KAN 0235-F

CHARLESTON BLUEPRINT 09294

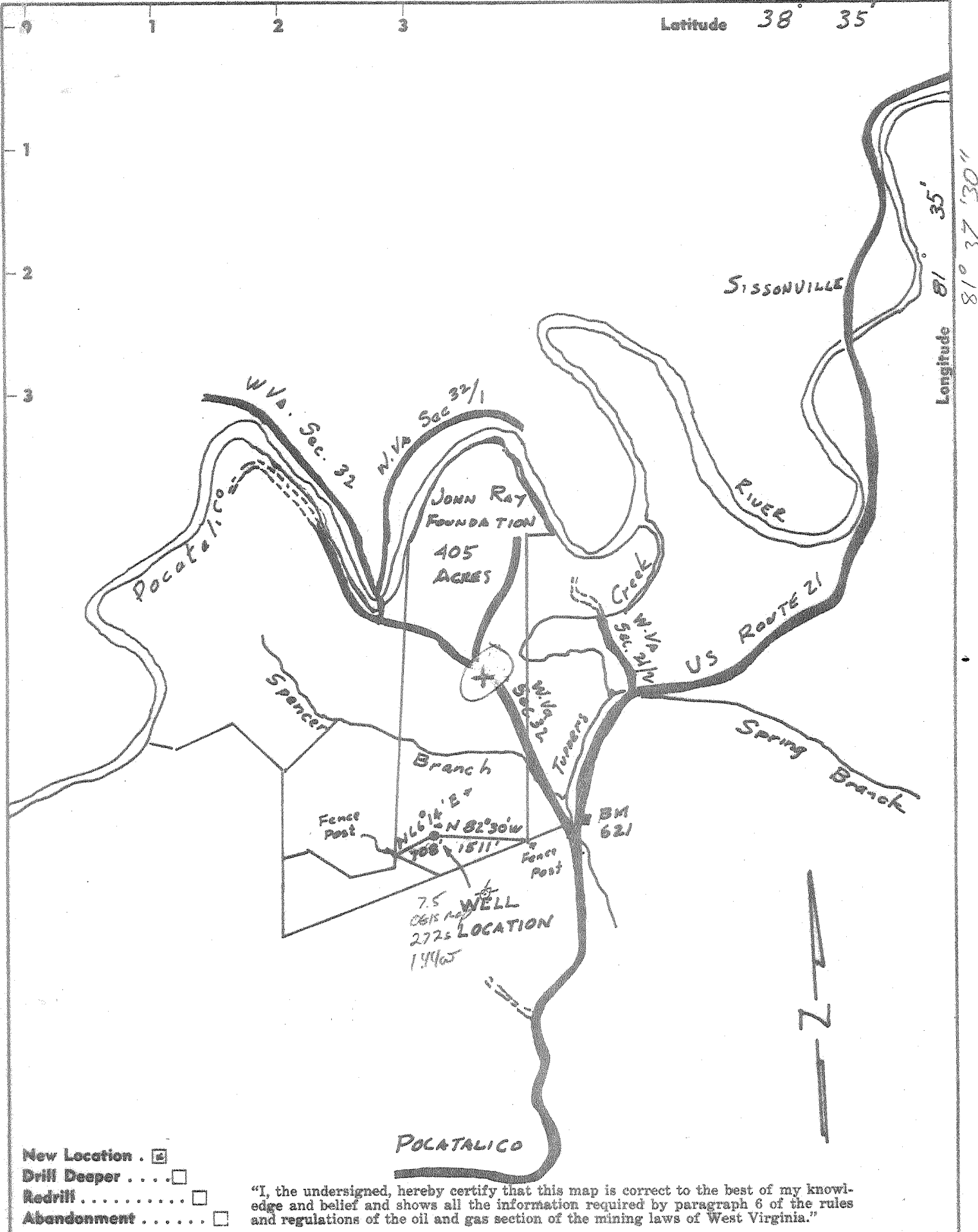

- New Location
- Drill Deeper
- Redrill
- Abandonment

"I, the undersigned, hereby certify that this map is correct to the best of my knowledge and belief and shows all the information required by paragraph 6 of the rules and regulations of the oil and gas section of the mining laws of West Virginia."

Company PROFESSIONAL PETROLEUM EXPLORATION INC.
 Address 2318 North Meridian St. Indianapolis, Indiana 46208
 Farm JOHN RAY
 Tract _____ Acres 405 Lease No. _____
 Well (Farm) No. 1 Serial No. _____
 Elevation (Spirit Level) 904.25
 Quadrangle KENNA SC
 County KANAWHA District POCA
 Engineer Arthur E. Parks
 Engineer's Registration No. 1530
 File No. 5-429 Drawing No. 1
 Date March 20, 1968 Scale 1" = 2000'

STATE OF WEST VIRGINIA
 DEPARTMENT OF MINES
 OIL AND GAS DIVISION
 CHARLESTON

WELL LOCATION MAP
 FILE NO. KAN-2235

+ Denotes location of well on United States Topographic Maps, scale 1 to 62,500, latitude and longitude lines being represented by border lines as shown.

- Denotes one inch spaces on border line of original tracing.

allow



STATE OF WEST VIRGINIA
DEPARTMENT OF MINES
OIL AND GAS WELLS DIVISION

- Rotary
- Spudder
- Cable Tools
- Storage

Oil or Gas Well Gas
(KIND)

WELL RECORD

Quadrangle Kenna 15Min
Permit No. Kanawaha 2235

Company <u>Professional Petroleum Exploration, Inc.</u>	Casing and Tubing	Used in Drilling	Left in Well	Packers
Address <u>Suite 450 Denver Club Bldg. Denver, Colorado</u>	Size			
Farm <u>John Ray #1</u> Acres <u>250</u>				Kind of Packer
Location (waters) <u>Between Ptoaliaco River & Tupper Creek</u>				Size of
Well No. <u>#1</u> Elev. <u>916</u>	<u>13</u>			Depth set
District <u>Poca</u> County <u>Kanawaha</u>	<u>11 3/4</u>	<u>290'</u>	<u>290'</u>	Perf. top
The surface of tract is owned in fee by <u>John Ray</u>	<u>8 1/2</u>	<u>420 sks</u>	<u>2170'</u>	Perf. bottom
Mineral rights are owned by <u>John Ray</u>	<u>6%</u>	<u>157 sks</u>	<u>5748'</u>	Perf. top
Drilling commenced <u>April 16, 1968</u>	<u>4 1/2</u>			Perf. bottom
Drilling completed <u>May 1, 1968</u>	<u>3</u>		<u>5710'</u>	Perf. top
Date Start <u>Fraced</u> <u>May 8m</u> To	<u>2" tubing</u>			Perf. bottom
With <u>Sabd & Water</u>	Liners Used			

Open Flow /10ths Water in Inch Attach copy of cementing record.
Nat 15-25MM /10ths Merc. in. Inch CASING CEMENTED SIZE No. Ft. Date
 Volume Cu. Ft. Amount of cement used (bags)
 Rock Pressure lbs. hrs. Name of Service Co. Dowell
 Oil 4bbl bbls., 1st 24 hrs. COAL WAS ENCOUNTERED AT FEET INCHES
 WELL ACIDIZED (DETAILS) FEET INCHES FEET INCHES
 WELL FRACTURED (DETAILS) 1300 bbls & 48,000 lbs sand FEET INCHES FEET INCHES

RESULT AFTER TREATMENT (Initial open Flow or bbls.) 118MM 118,000.000 118,000 McF
 ROCK PRESSURE AFTER TREATMENT HOURS
 Fresh Water Feet Salt Water Feet
 Producing Sand Newburg Depth 5809 1/2

Formation	Color	Hard or Soft	Top	Bottom	Oil, Gas or Water	Depth	Remarks
✓ Big Lime		Hard	1730	1860			
✓ Big Injun		Soft	1860	1950			
Berea		Soft	None				
✓ Onadaga		Hard	4926	5030			
✓ Oriskany		Hard	5030	5062			
✓ Newburg		Hard	5794	5809 1/2		TD 5809 1/2	

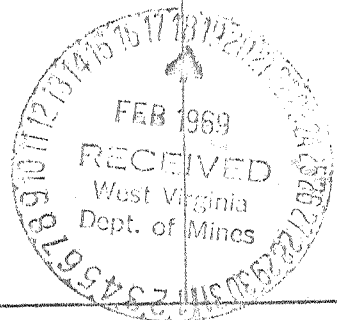

(over)

5-5 Rocky Fork 312

MAR 02 1969

Date: 09/11/03
API # 47-039-02235

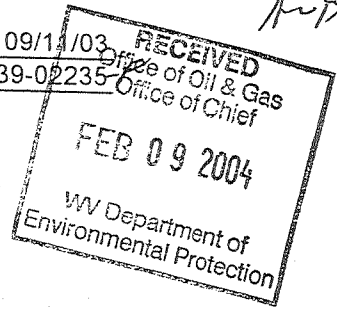

State of West Virginia
Department of Environmental Protection
Office of Oil & Gas

Well Operators Report of Well Work

Operators well name: John Ray 1
Farm Name: KANAWHA VALLEY ADY. Operator # 51440

Location: Elevation 904.25 Quadrangle: KENNA
District POCA County: Kanawha
Latitude: _____ Feet 32' of 30" Deg. 38' Min. _____ Sec.
Longitude: _____ Feet 37' of 30" Deg. 81' Min. _____ Sec.

Company: Viking Energy
Address: PO Box 13366
Sissonville, WV 25360

Agent:	Mickey Pinkerton	Casing & Tubing	Used in Drilling	Left in Well	Cement Fill up Cu Ft		
Inspector	CARLOS HIVELEY						
Date Permit Issued	8-29-03	11 3/4		290 FT		Sks	CU FT
Date Well Work Commenced	09/11/03	8 5/8		2170 FT		Sks	CU FT
Date Well Work Completed	9-15-03	5 1/2		5748 FT		Sks	CU FT
Verbal Plugging:				FT		Sks	CU FT
Date Permission Granted On				FT		Sks	CU FT
Rotary X Cable RIG						Sks	CU FT
Total Depth (feet):							
Fresh Water Depth:							
Salt Water Depth							
Is coal being mined in area ?							
Coal Depths							

OPEN FLOW DATA:

Producing Formation: Oriskany
GAS: Initial Open Flow: 60 MCF/d OIL: _____ Pay zone depth (ft) 5032 to 5043
Final Open Flow: 50 MCF/d Initial Open Flow: _____ Bbl/d
Time of open flow between initial and final tests 24 Hours Final Open Flow: _____ Bbl/d
Static rock pressure: 100 PSI (surface pressure) after 24 Hours

Second producing formation:
GAS: Initial Open Flow: _____ MCF/d OIL: _____ Pay zone depth (ft) _____ to _____
Final Open Flow: _____ MCF/d Initial Open Flow: _____ Bbl/d
Time of open flow between initial and final tests _____ Hours Final Open Flow: _____ Bbl/d
Static rock pressure: _____ PSI (surface pressure) after _____ Hours

NOTE: ON BACK OF THESE FORM PUT THE FOLLOWING: 1) DETAILS OF PERFORATED INTERVALS, FRACTURING OR STIMULATING, PHYSICAL CHANGE, ETC. 2) THE WELL LOG WHICH IS A SYSTEMATIC DETAILED GEOLOGIC RECORD OF ALL FORMATIONS, INCLUDING COAL ENCOUNTERED BY THE WELBORE.

Signed: Michael Pinkerton
By: Viking Energy
Date: 2-4-04

MAR 19 2004

DEEP WELL

KAN 2235

Viking Energy
PO Box 13366
Sissonville, WV 25360

RE: REWORK OF THE John Ray 1

API # 39-047-02235

9/11 Move in Key energy rig up and set bridge plug at 5110. Well previously perforated at 5032 to 5043 with 29 holes.
Rig up BJ services and frac well with a X link system placing 24,812 lbs 20/40 sand at an average rate of 21 BPM & max sand conc. Of 4 PPG.

Max treating pressure	3099
Min. treating pressure	1670
Avg. treating pressure	2384
ISDP	2642
5 min shut in	1484
10 min shut in	1340
15 min shut in	

Fluid used 481 bbls

Turn over to Viking to clean up well.

APR 19 2004

