

Latitude 38° 30'

3.88 mi. S.
1.48 mi. W.

Longitude 81° 45'

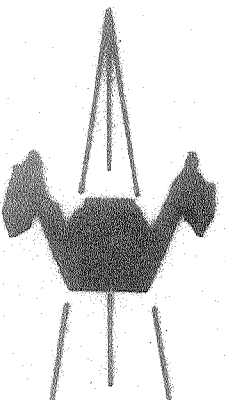
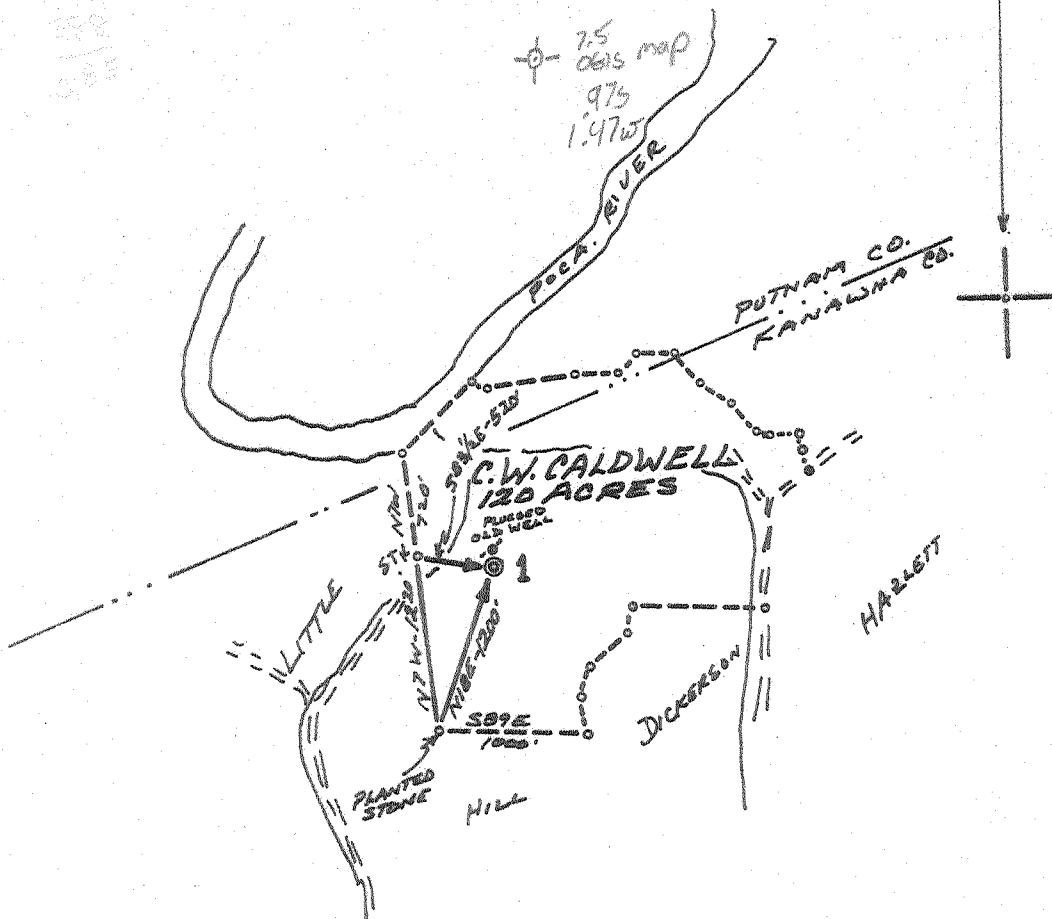

ACCURACY: 1 / 200

Source of Elevation OLD WELL (598.1')

I, the undersigned, hereby certify that this map is correct to the best of my knowledge and belief and shows all the information required by paragraph 6 of the rules and regulations of the oil and gas section of the mining laws of West Virginia.

- New Location
- Drill Deeper
- Abandonment
- Fracture
- Redrill

Chet Waterman

Company WASK - MITCHELL
 Address 912-A Goff Bldg. Clarksburg, W. Va.
 Farm C.W. CALDWELL
 Tract _____ Acres 120 Lease No. _____
 Well (Farm) No. 1 Serial No. _____
 Elevation (Spirit Level) 617.8
 Quadrangle ST. ALBANS NE
 County KANAWHA District UNION
 Engineer CHET WATERMAN
 Engineer's Registration No. 3788
 File No. 68003-58 Drawing No. _____
 Date 5/21/68 Scale 1" = 1320'

STATE OF WEST VIRGINIA
 DEPARTMENT OF MINES
 OIL AND GAS DIVISION
 CHARLESTON

WELL LOCATION MAP
 FILE NO. KAN-2261-P

+ Denotes location of well on United States Topographic Maps, scale 1 to 62,500, latitude and longitude lines being represented by border lines as shown.

— Denotes one inch spaces on border line of original tracing.

Newburg - Deep Well - 6-0 Rocky Fork (312)



STATE OF WEST VIRGINIA
DEPARTMENT OF MINES
OIL AND GAS DIVISION

Rotary
Spudder
Cable Tools
Storage

Quadrangle St Albans

Permit No. KAN-2261

WELL RECORD

Oil or Gas Well _____ (KIND)

Company Wosk & Mitchell
Address 912-A Goff Bldg., Clarksburg, W. Va.
Farm C. W. Caldwell Acres 120
Location (waters) Poca River
Well No. 1 Elev. 595.57 G. R.
District Union County Kanawha
The surface of tract is owned in fee by C. W. Caldwell, et al
Address P.O. Box 951
Mineral rights are owned by C. W. Caldwell, et al
Address P.O. Box 951
Drilling commenced May 29, 1968
Drilling completed June 12, 1968
Date Shot From _____ To _____
With _____
Open Flow _____ /10ths Water in _____ Inch
_____ /10ths Merc. in _____ Inch
Volume _____ Cu. Ft.
Rock Pressure _____ lbs. _____ hrs.
Oil _____ bbls., 1st 24 hrs.
WELL ACIDIZED (DETAILS) _____
WELL FRACTURED (DETAILS) _____

Casing and Tubing	Used in Drilling	Left in Well	Packers
Size			Kind of Packer
16			
3/8	252.30	252.30	
9-5/8	1739.24	1239.24	Size of
8 1/4			
7	5192	4192	Depth set
16			
4 1/2			
3			Perf. top
2			Perf. bottom
Liners Used			Perf. top
			Perf. bottom

Attach copy of cementing record.
CASING CEMENTED _____ SIZE _____ No. Ft. _____ Date _____
Amount of cement used (bags) See other side
Name of Service Co. _____
COAL WAS ENCOUNTERED AT _____ FEET _____ INCHES
_____ FEET _____ INCHES _____ FEET _____ INCHES
_____ FEET _____ INCHES _____ FEET _____ INCHES

RESULT AFTER TREATMENT (Initial open Flow or bbls.) _____
ROCK PRESSURE AFTER TREATMENT _____ HOURS
Fresh Water _____ Feet 170' Salt Water _____ Feet
Producing Sand _____ Depth _____

Formation	Color	Hard or Soft	Top	Bottom	Oil, Gas or Water	Depth	Remarks
Sand & Shale			Surface	960	Water	170	
Salt Sand			960	1380			
Lime			1380	1578			
Injun Sand			1578	1650			
Sandy Shale			1650	4425			
Corniferous			4425	4595			
Oriskany			4495	4525			
Lime, Dolomite, Shale			4525	5220			
Newburg			5220	5232			
Dolomite			5232	5257			
XX T.D.			5257				



Copy of logs of is not that need to add

Formation	Color	Hard or Soft	Top	Bottom	Oil, Gas or Water	Depth Found	Remarks
<u>Casing Record</u>							
13-3/8" H-40, 48# Csg. set @ 262' KB and cemented with 200 sacks of cement w/4% CaCl ₂							
9-5/8" H-40, 32.30# csg. set @ 1739.24 KB and cemented w/150 sacks of cement w/2% CaCl ₂							
7" N-80, 28# set @ 5192' KB and cemented with 150 sacks of cement							

Date _____, 19__

APPROVED _____, Owner

By J. L. D... ..
(Title)