

Latitude 38° 30'

0.02 mi. S.
1.51 mi. W.

Longitude 81° 40'

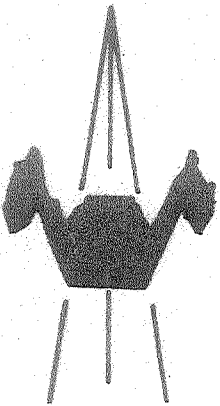
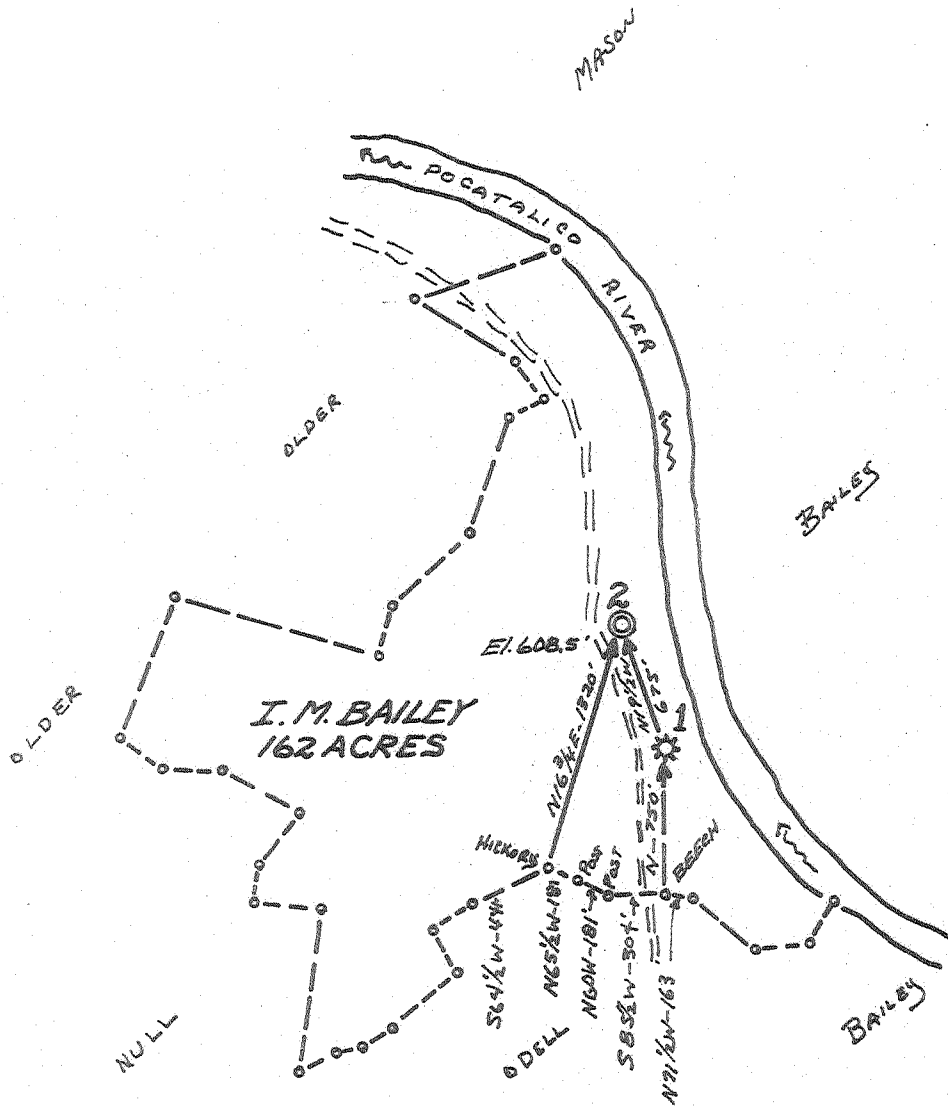

ACCURACY: 1' / 200'

Source of Elevation USBM ON POCA RIVER (603')

- New Location
- Drill Deeper
- Abandonment
- Fracture
- Redrill

I, the undersigned, hereby certify that this map is correct to the best of my knowledge and belief and shows all the information required by paragraph 6 of the rules and regulations of the oil and gas section of the mining laws of West Virginia.

Chet Waterman

Company APPALACHIAN EXPLORATION & DEVELOPMENT INC.
 Address CHARLESTON, W. VA.
 Farm I. M. BAILEY
 Tract Acres 162 Lease No.
 Well (Farm) No. 2 Serial No.
 Elevation (Spirit Level) 608.5'
 Quadrangle CHARLESTON NW
 County KANAWHA District UNION
 Engineer CHET WATERMAN
 Engineer's Registration No. 3788
 File No. 68003-94 Drawing No.
 Date 6/6/68 Scale 1" = 1000'

STATE OF WEST VIRGINIA
DEPARTMENT OF MINES
OIL AND GAS DIVISION
CHARLESTON

WELL LOCATION MAP

FILE NO. KAN-2266

+ Denotes location of well on United States Topographic Maps, scale 1 to 62,500, latitude and longitude lines being represented by border lines as shown.

— Denotes one inch spaces on border line of original tracing.



STATE OF WEST VIRGINIA
DEPARTMENT OF MINES
OIL AND GAS DIVISION 7

Rotary
Spudder
Cable Tools
Storage

Quadrangle Charleston N.W.

Permit No. Kanawah-2266

WELL RECORD

Oil or Gas Well Gas
(KIND)

Company <u>Appalachian Exploration & Development, Inc.</u>	Casing and Tubing	Used in Drilling	Left in Well	Packers
Address <u>P.O. Box 628, Charleston, W. Va. 25322</u>	Size			
Farm <u>I. M. Bailey</u> Acres <u>162</u>	16			
Location (waters) <u>Pocatalico</u>	13-3/8	70	70	Kind of Packer <u>Baker</u>
Well No. <u>2</u> Elev. <u>608.5</u>	12 9-5/8	1745	1745	Size of <u>5-1/2</u>
District <u>Union</u> County <u>Kanawha</u>	8 1/4			Depth set <u>5356</u>
The surface of tract is owned in fee by <u>I. M. Bailey</u>	8 1/2 7	5388	5388	
Rt. <u>4, Box 28</u> Address <u>Charleston, W. Va.</u>	5 3/16			Perf. top <u>None</u>
Mineral rights are owned by <u>I. M. Bailey</u>	4 1/2			Perf. bottom
Rt. <u>4, Box 28</u> Address <u>Charleston, W. Va.</u>	3			Perf. top
Drilling commenced <u>June 22, 1968</u>	2-7/8	5356	5356	Perf. bottom
Drilling completed <u>July 27, 1968</u>	Liners Used <u>5 1/2</u>	793	793	
Date Shot <u>None</u> From To				

Attach copy of cementing record. (See back of sheet.)

CASING CEMENTED SIZE No. Ft. Date

Amount of cement used (bags)

Name of Service Co. Dowell

COAL WAS ENCOUNTERED AT FEET INCHES

FEET INCHES FEET INCHES

FEET INCHES FEET INCHES

WELL ACIDIZED (DETAILS)

WELL FRACTURED (DETAILS) 591 barrels water, 14000# sand.

RESULT AFTER TREATMENT (Initial open Flow or bbls.) 33,000 Mcf 33,000,000

ROCK PRESSURE AFTER TREATMENT 1725 HOURS 72

Fresh Water Feet Salt Water Feet

Producing Sand Newburg Depth 5439

Formation	Color	Hard or Soft	Top	Bottom	Oil, Gas or Water	Depth	Remarks
Clay & sand		Soft	0	40			
Sand & shale		Soft	40	1025			
Sand		Soft	1025	1425			
Sand & shale - <u>Mason?</u>		Soft	1425	1440			
Shaly lime - <u>L. Lime?</u>		Hard	1440	1460			
Lime - <u>Bialime</u>		Hard	1460	1635			
Sand - <u>Injun</u>		Soft	1635	1675			
Shale		Soft	1675	4605			
Lime - <u>Onondaga</u>		Hard	4605	4675			
Sand		Soft	4675	4704	Gas		Oriskany
Lime		Hard	4740	5430			
Sand		Soft	5430	5439	Gas		Newburg
					5430 609 4821	5430 4675 755	

