

NOTE: THIS PLAT IS FOR PERMIT PURPOSE ONLY, FOR ACTUAL FIELD, SEE PLAT DATED 8-6-68, FILE 58-69.

FILE NO. W-0104
 DRAWING NO. W-0104
 SCALE 1" = 400'
 MINIMUM DEGREE OF ACCURACY 1" IN 200'
 PROVEN SOURCE OF ELEVATION OPERATORS RECORDS

I THE UNDERSIGNED, HEREBY CERTIFY THAT THIS PLAT IS CORRECT TO THE BEST OF MY KNOWLEDGE AND BELIEF AND SHOWS ALL THE INFORMATION REQUIRED BY LAW AND THE REGULATIONS ISSUED AND PRESCRIBED BY THE DEPARTMENT OF MINES.
 (SIGNED) [Signature]
 R. P. E. _____ L. L. S. 1423

PLACE SEAL HERE

(+) DENOTES LOCATION OF WELL ON UNITED STATES TOPOGRAPHIC MAPS
 FORM IV-6
 (8-78)



DATE JUNE 14, 2003
 OPERATOR'S WELL NO. DORA BAILEY, ETC.
 API WELL NO. _____
47 - 39 - 02298-F
 STATE COUNTY PERMIT

Division of Environmental Protection
 Office of Oil & Gas

WELL TYPE: OIL _____ GAS X LIQUID INJECTION _____ WASTE DISPOSAL _____
 (IF "GAS", PRODUCTION X STORAGE _____ DEEP _____ SHALLOW X)
 LOCATION: ELEVATION 795.96' WATER SHED DERRICK'S CREEK OF POCATAHICO
 DISTRICT POCA COUNTY KANAWHA
 QUADRANGLE SISSONVILLE 7.5'
 SURFACE OWNER THOMAS L. McVEY, II ACREAGE 34.00
 OIL & GAS ROYALTY OWNER DEBRA ANN POWELL LEASE ACREAGE 34.00
 LEASE NO. _____
 PROPOSED WORK: DRILL _____ CONVERT _____ DRILL DEEPER _____ REDRILL _____ FRACTURE OR STIMULATE _____ PLUG OFF OLD FORMATION _____ PERFORATE NEW FORMATION X OTHER PHYSICAL CHANGE IN WELL (SPECIFY) _____
 PLUG AND ABANDON _____ CLEAN OUT AND REPLUG _____
 TARGET FORMATION DEVONIAN SHALE ESTIMATED DEPTH 5,000'
 WELL OPERATOR VIKING ENERGY INC. DESIGNATED AGENT MICHAEL PINKERTON
 ADDRESS P.O. BOX 13366 ADDRESS SAME AS OPERATOR
SISSONVILLE, WV 25360

DEEP WELL 6-6 312 Rocky Fork (Charleston WV)

KAN 2298 F

CHARLES FOR BLUEPRINT 092941

38° 32' 30"

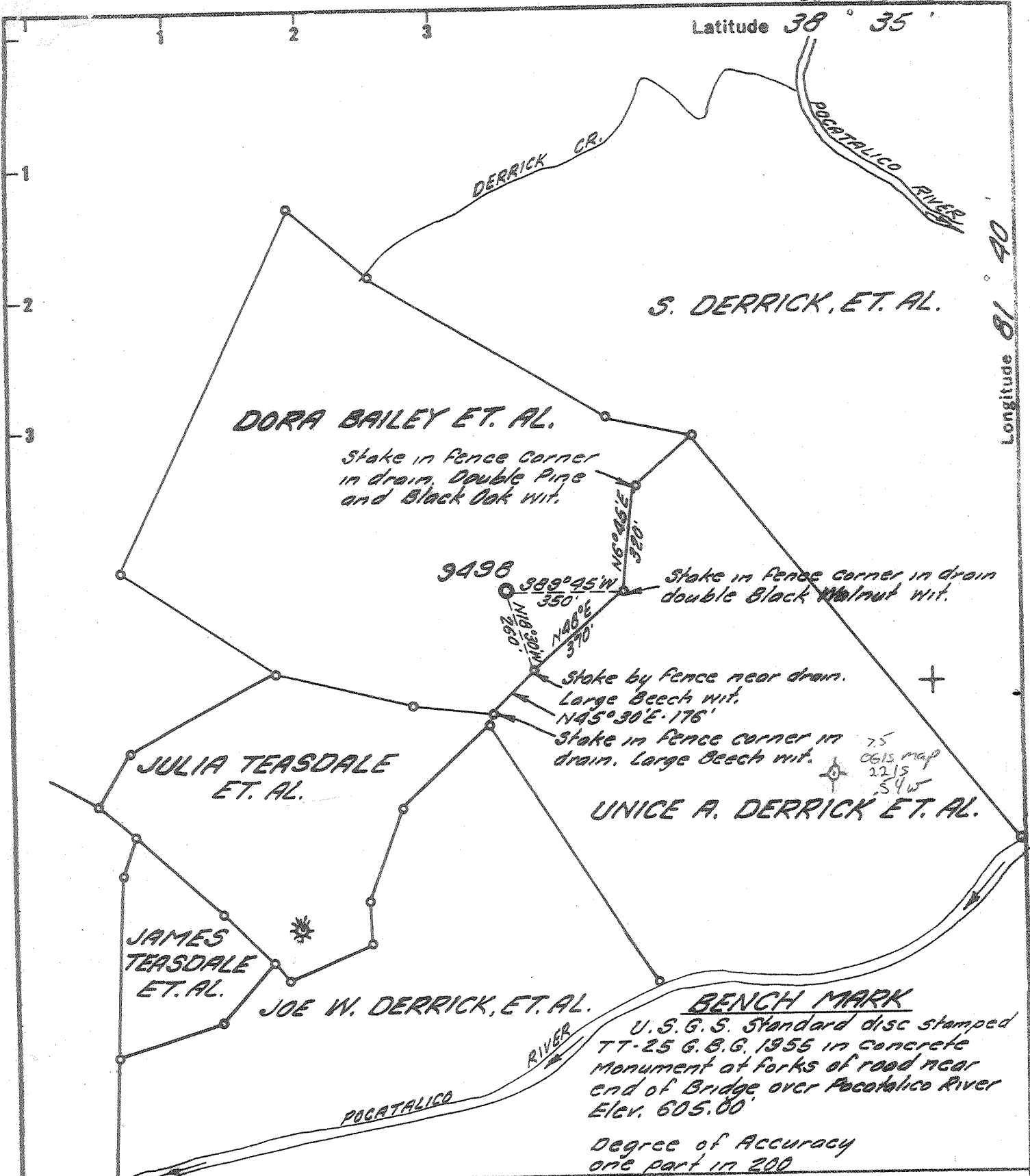

Fracture	<input type="checkbox"/>
Before 6/5/29	<input type="checkbox"/>
New Location	<input checked="" type="checkbox"/>
Drill Deeper	<input type="checkbox"/>
Redrill	<input type="checkbox"/>
Abandonment	<input type="checkbox"/>

I, the undersigned, hereby certify that this map is correct to the best of my knowledge and belief and shows all the information required by Paragraph 5 of the Rules and Regulations of the Oil and Gas Section of the Mining Laws of West Virginia.
 The accuracy of this survey is within the limits and as prescribed in paragraph 5 by the Oil and Gas Division of the Department of Mines Regulations.

Company UNITED FUEL GAS CO.
 Address CHARLESTON, W.VA.
 Farm DORA BAILEY, ET. AL.
 Tract _____ Acres 278 Lease No. _____
 Well (Farm) No. _____ Serial No. 9498
 Elevation (Spirit Level) 795.96'
 Quadrangle KENNA SW
 County KANAWHA District POCA
 Engineer Clayton E. Hardman
 Engineer's Registration No. 2330
 File No. 58-69 Drawing No. _____
 Date 8-6-68 Scale 1" = 400'

48488
 48487
 63523
 49107
 48492
 48486
 48491
 48489
 63133
 63134

STATE OF WEST VIRGINIA
 DEPARTMENT OF MINES
 OIL AND GAS DIVISION
 CHARLESTON

WELL LOCATION MAP
 FILE NO. Kan-2298

+ Denotes location of well on United States Topographic Maps, scale 1 to 62,500 latitude and longitude lines being represented by border lines as shown.
 - Denotes one inch spaces on border line of original tracing.



STATE OF WEST VIRGINIA
DEPARTMENT OF MINES
OIL AND GAS DIVISION

Rotary
Spudder
Cable Tools
Storage

Quadrangle Kenna
~~Sissonville~~

WELL RECORD

Permit No. KAN-2298

Oil or Gas Well Gas
(411D)

Company United Fuel Gas Company
Address P.O. Box 1273 Charleston, W. Va.
Farm Dora Bailey ET. AL Acres 278
Location (waters) Pocatalico River
Well No. 9498 Elev. 809:96 KB
805:98 GL
District Poca County Kanawha
The surface of tract is owned in fee by _____
Address _____
Mineral rights are owned by Adam C. Bailey, et. al.
Address Dunbar, W. Va.
Drilling commenced 9-2-68
Drilling completed 9-12-68
Date Shot Not Shot From _____ To _____

Casing and Tubing	Used in Drilling	Left in Well	Packers
Size			Kind of Packer
16			
13	98'	98'	
10			Size of
3 3/8" 9"	1903'	1903'	
3 3/8" 7"	5673'	5673'	Depth set
5 3/16"			Perf. top
4 1/2"			Perf. bottom
3	5672'	5672'	Perf. top
2			Perf. bottom
Liners Used			

Open Flow 1/10ths Water in _____ Inch
1/10ths Merc. in _____ Inch
Volume 30 Mcf 30000 Cu Ft.
Rock Pressure _____ lbs. _____ hrs.
Oil _____ bbls., 1st 24 hrs.
WELL ACIDIZED (DETAILS) _____
WELL FRACTURED (DETAILS) Mud Acid 1,000 gals. Fill up 7,250 gals. Treating 22,100 gals.
Over flush 9,000 gals. Sand 20-40 30,000#
RESULT AFTER TREATMENT (Initial open Flow or bbls.) 69 Mmcf 69,000 Mmcf 69,000,000
ROCK PRESSURE AFTER TREATMENT 1800.7 HOURS 2 1/2
Fresh Water _____ Feet _____ Salt Water _____ Feet _____
Producing Sand Newburg Depth 5663

Attach copy of cementing record.
CASING CEMENTED 7" SIZE 5608' No. Ft. _____ Date _____
Amount of cement used (bags) 150
Name of Service Co. Halliburton
COAL WAS ENCOUNTERED AT _____ FEET _____ INCHES
_____ FEET _____ INCHES _____ FEET _____ INCHES
_____ FEET _____ INCHES _____ FEET _____ INCHES

Formation	Color	Hard or Soft	Top	Bottom	Oil, Gas or Water	Depth	Remarks
Soil			0	10			
Sand			10	165			
Shale			165	240		5659	5659
Sand			240	360		809	4887
Sand-Shale			360	1175	Salt Water	4850	772
Salt Sand			1175	1795	1175'		
Big Lime			1795	1960			
Injun			1960	2000			
Shale			2000	4792			
Cornif			4792	4887			
Criskany			4887	4930	Show gas 4900'		
Dolomite			4930	5659	Show gas 5495'		
Newburg			5659	5663	30Mcf @ 5660'		
Total Depth				5663			

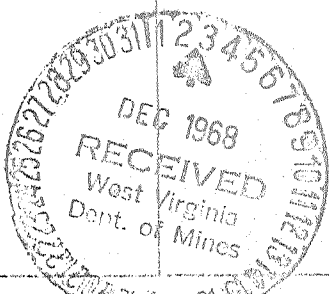

Test before Fracturing: 30 Mmcf
Final Open Flow: 69 Mmcf (Four Point Potential Test) RP 1800.7 psig; Shut In 9-12-68 7" Casing 2 1/2 Hour
Casing Points
13-3/8" 95' Cemented 75 Bags
9-5/8" 1900' Cemented 100 Bags
7" 5620' Cemented 150 Bags
No Loss Run:
Permit No. KAN-2298

~~SECRET~~
State of West Virginia
Department of Environmental Protection
Office of Oil & Gas
Well Operators Report of Well Work

bc 13

Operators well name: Dora Bailey
Farm Name: McVEY THOMAS II Operator # 51440

Location: Elevation 808.96 Quadrangle: KENNA
District POCA County: Kanawha
Latitude: _____ Feet 32 of 30 Deg. 38 Min. _____ Sec.
Longitude: _____ Feet 40 of 00 Deg. 81 Min. _____ Sec.

Company: Viking Energy
Address: PO Box 13366
Sissonville, WV 25360

RECEIVED
Office of Oil & Gas
Office of Chief

FEB 09 2004

WV Department of
Environmental Protection

Agent:	Mickey Pinkerton	Casing & Tubing	Used in Drilling	Left in Well	Cement Fill up Cu Ft		
Inspector	<i>Carlos Heveley</i>						
Date Permit Issued	<u>8-8-03</u>	<u>13</u>		<u>98</u> FT	Sks		CU FT
Date Well Work Commenced	<u>08/17/03</u>	<u>9</u>		<u>190.3</u> FT	Sks		CU FT
Date Well Work Completed		<u>7</u>		<u>567.3</u> FT	Sks		CU FT
Verbal Plugging:		<u>2</u>		<u>5000</u> FT	Sks		CU FT
Date Permission Granted On				FT	Sks		CU FT
Rotary X Cable	<u>RIG</u>						
Total Depth (feet):							
Fresh Water Depth:							
Salt Water Depth							
Is coal being mined in area ?							
Coal Depths							

OPEN FLOW DATA:

GAS: Producing Formation: Oriskany Pay zone depth (ft) 4866 to 4907
Initial Open Flow: 100 MCF/d OIL: Initial Open Flow: Bbl/d
Final Open Flow: 70 MCF/d Final Open Flow: Bbl/d
Time of open flow between initial and final tests 24 Hours
Static rock pressure: 250 PSI (surface pressure) after 24 Hours

GAS: Second producing formation: _____ Pay zone depth (ft) _____ to _____
Initial Open Flow: _____ MCF/d OIL: Initial Open Flow: _____ Bbl/d
Final Open Flow: _____ MCF/d Final Open Flow: _____ Bbl/d
Time of open flow between initial and final tests _____ Hours
Static rock pressure: _____ PSI (surface pressure) after _____ Hours

NOTE: ON BACK OF THESE FORM PUT THE FOLLOWING: 1) DETAILS OF PERFORATED INTERVALS, FRACTURING OR STIMULATING, PHYSICAL CHANGE, ETC. 2) THE WELL LOG WHICH IS A SYSTEMATIC DETAILED GEOLOGIC RECORD OF ALL FORMATIONS, INCLUDING COAL ENCOUNTERED BY THE WELLBORE.

Signed: *Michael Pinkerton*
By: *Viking Energy*
Date: 2-4-04

FEB 19 2004

DEEP WELL

KAN 2298

WR - 35
Rev (5-01)

Date: 08/25/03
API # 47-039-02298

State of West Virginia
Department of Environmental Protection
Office of Oil & Gas

Operators well name: Dora Bailey
Farm Name: 0 Operator # 41350

Company: **Reed Gas Inc.**
Address: 1206 Kanawha Blvd. E.- Suite 201
Charleston, WV 25301

GEOLOGICAL RECORD

Description:	Top	Bottom
NA Well is a rework		

Additional Comments:

APR 19 2004

Viking Energy
PO Box 13366
Sissonville, WV 25360

RE: REWORK OF Dora Bailey

API # 47-039-02298

Moved in rig and tripped tubing and prep well

8/17/2003

Moved in Key Energy/ Set a 7" bridge plug at 5003 ft. Well previously perforated with 18 holes from 4866 to 4883 and 11 holes from 4897 to 4907

Moved in BJ Services and dropped 250 gals 15% HCl acid treated for iron, clay and with a non-emulsifier. Run in hole with a Baker 2 7/8 X 7" set down packer and set packer at 4784 (cement top estimated at 4750 ft)

8/18/2003

Move in and rig up BJ Services. Started to frac - fluid was not X-linking. Shut down found blender was recirculating the X-linker. Refilled tank and regelled. Fraced through 2 7/8 tubing at an average rate of 13.3 BPM. 30,193 Lbs of 20/40 sand was placed at a max concentration of 4 Lbs. Per gal.

Max treating pressure	4400
Min. treating Pressure	3685
Avg. treating pressure	4040
ISDP	3200
5 Min shut in	2160
10 Min	1460
15 Min	0

Fluid used 448 bbls

Release packer and trip out of hole

Turn over to Viking Energy for flow back and clean up.

MAR 19 2004

KAN 2298