

ACCURACY: 1p 200p

Source of Elevation MOUTH OF COVEN (700)

- New Location
- Drill Deeper
- Abandonment  *issued 2/7/75*
- Fracture
- Redrill

I, the undersigned, hereby certify that this map is correct to the best of my knowledge and belief and shows all the information required by paragraph 6 of the rules and regulations of the oil and gas section of the mining laws of West Virginia.

*Chet Waterman*

COLUMBIA GAS TRANSMISSION CORP.	
Company <del>MONTGOMERY OIL &amp; GAS CO.</del>	
Address <u>P.O. BOX 1273</u> <u>CHARLESTON, W. VA.</u>	
Farm <u>WILBUR M. CAVENDER</u>	
Tract _____	Acres <u>53</u> Lease No. _____
Well (Farm) No. <u>1</u>	Serial No. <u>9699</u>
Elevation (Spirit Level) <u>1262.1'</u>	
Quadrangle <u>CHARLESTON</u>	<u>NC</u>
County <u>KANAWHA</u>	District <u>UNION</u>
Engineer <u>CHET WATERMAN</u>	
Engineer's Registration No. <u>3788</u>	
File No. <u>60003-161</u>	Drawing No. _____
Date <u>9/18/68</u>	Scale <u>1" = 200'</u>

STATE OF WEST VIRGINIA  
DEPARTMENT OF MINES  
OIL AND GAS DIVISION  
CHARLESTON

WELL LOCATION MAP  
FILE NO. KAN-2313-P

+ Denotes location of well on United States Topographic Maps, scale 1 to 62,500, latitude and longitude lines being represented by border lines as shown.

— Denotes one inch spaces on border line of original tracing.

47-039

*Deep well*

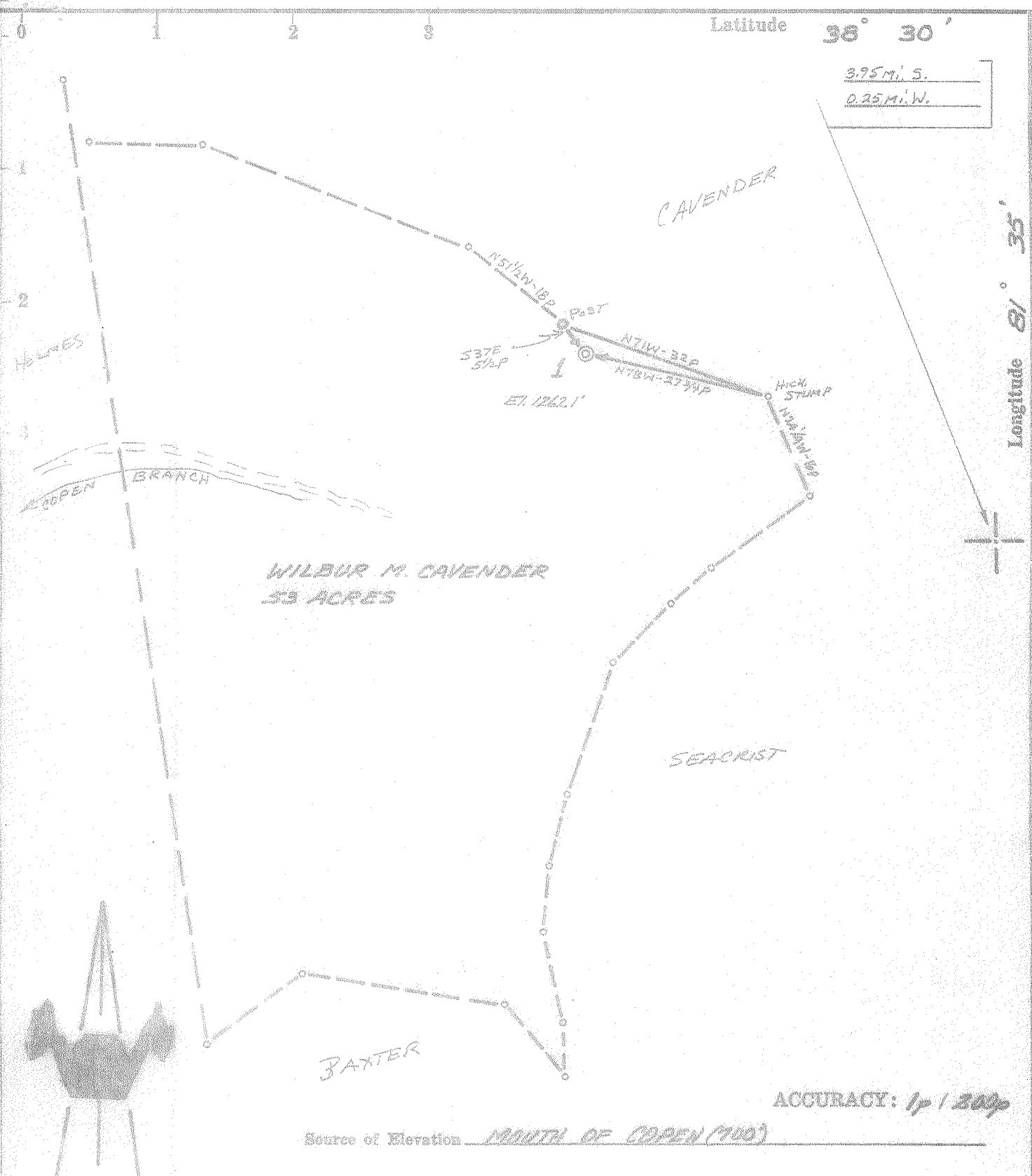

- New Location
- Drill Deeper
- Abandonment
- Fracture
- Redrill

I, the undersigned, hereby certify that this map is correct to the best of my knowledge and belief and shows all the information required by paragraph 6 of the rules and regulations of the oil and gas section of the mining laws of West Virginia.

*Chet Waterman*

Company MONTLAR OIL & GAS CO.  
 Address CHARLESTON, W. VA.  
 Farm WILBUR M. CAVENDER  
 Tract \_\_\_\_\_ Acres 53 Lease No. \_\_\_\_\_  
 Well (Farm) No. 1 Serial No. \_\_\_\_\_  
 Elevation (Spirit Level) 1262.1'  
 Quadrangle CHARLESTON NC  
 County KANAWHA District UNION  
 Engineer CHET WATERMAN  
 Engineer's Registration No. 8798  
 File No. 60003-101 Drawing No. \_\_\_\_\_  
 Date 9/18/68 Scale 1" = 200'

STATE OF WEST VIRGINIA  
 DEPARTMENT OF MINES  
 OIL AND GAS DIVISION  
 CHARLESTON

WELL LOCATION MAP  
 FILE NO. KAN-1313

+ Denotes location of well on United States Topographic Maps, scale 1 to 62,500, latitude and longitude lines being represented by border lines as shown.

— Denotes one inch spaces on border line of original tracing.



STATE OF WEST VIRGINIA  
DEPARTMENT OF MINES  
OIL AND GAS DIVISION

Rotary   
Spudder   
Cable Tools   
Storage

Quadrangle .....

Permit No. Kan-2313

**WELL RECORD**

Oil or Gas Well Gas  
(KIND)

Company Montlar Oil & Gas Company  
Address 212 Branchfield Dr.  
Farm Wilbur M. Cavender Acres 53  
Location (waters) Kanawha Two Mile  
Well No. 1 Elev. 1262  
District Union County Kanawha  
The surface of tract is owned in fee by W. M. Cavender  
Address Rt. 1, Box 338  
Mineral rights are owned by W. M. Cavender  
Address Rt. 1, Box 338  
Drilling commenced Nov. 4, 1968  
Drilling completed Nov. 12, 1968  
Date Shot: From ..... To .....

Casing and Tubing	Used in Drilling	Left in Well	Packers
Size			Kind of Packer
16			
13 3/8	62	62	
9-5/8	2262	2262	Size of
8 1/4			
6 3/8 7	6115	6115	Depth set
5 3/16			
4 1/2			
3			Perf. top
2			Perf. bottom
Liners Used			Perf. top
			Perf. bottom

Open Flow /10ths Water in ..... Inch  
/10ths Merc. in ..... Inch  
Volume 4,000,000 Cu. Ft.  
Rock Pressure 2100+ lbs. hrs.  
Oil ..... bbls., 1st 24 hrs.  
WELL ACIDIZED (DETAILS) .....

Attach copy of cementing record.  
CASING CEMENTED ..... SIZE ..... No. Ft. .... Date  
Amount of cement used (bags) .....

WELL FRACTURED (DETAILS) 800 Bbls - 20,000# 20-40 sand - 2% Kcl  
RESULT AFTER TREATMENT (Initial open flow or bbls.) No Test  
ROCK PRESSURE AFTER TREATMENT 2100+ HOURS  
Fresh Water ..... Feet ..... Salt Water ..... Feet  
Producing Sand ..... Depth .....

COAL WAS ENCOUNTERED AT ..... FEET ..... INCHES  
..... FEET ..... INCHES ..... FEET ..... INCHES  
..... FEET ..... INCHES ..... FEET ..... INCHES

Formation	Color	Hard or Soft	Top	Bottom	Oil, Gas or Water	Depth	Remarks
Top Soil			0	10			
Sa-Sh			10	1460			
-Salt Sand			1460	2000			
-Big Lime			2000	2160			
-Inj. Sand			2160	2200			
Shale			2200	5290			
-Lime & Dol. <i>corn.</i>			5290	5395			
-Sand <i>orisk</i>			5395	5470			
Lime & Dol.			5470	6148			
-Newburg			6148	6168	Gas	6153	
TD		<i>McKenzie?</i>	6178				
			<i>6148</i>	<i>6148</i>			
			<i>5395</i>	<i>1262</i>			
			<i>753</i>	<i>4886</i>			

