

New Location   
 Drill Deeper   
 Abandonment   
 Dated - 5-17-69

Minimum Error of Closure 1 in 1000  
 Source of Elevation Elev. 645' Road Intersection 3/4 mile South of LOC.  
 "I, the undersigned, hereby certify that this map is correct to the best of my knowledge and belief and shows all the information required by paragraph 6 of the rules and regulations of the oil and gas section of the mining laws of West Virginia."

Company J.L. TRITTIPO  
 Address NELSON Bldg. CHARLESTON, W.Va.  
 Farm POCA COAL LAND CO.  
 Tract pt. of 1738 Ac. Acres \_\_\_\_\_ Lease No. \_\_\_\_\_  
 Well (Farm) No. 1 Serial No. \_\_\_\_\_  
 Elevation (Spirit Level) 659.0  
 Quadrangle KENNA SW  
 County KANAWHA District POCA  
 Engineer T. G. Sefton  
 Engineer's Registration No. 1832  
 File No. \_\_\_\_\_ Drawing No. \_\_\_\_\_  
 Date 4-23-69 Scale 1" = 1000'

STATE OF WEST VIRGINIA  
 DEPARTMENT OF MINES  
 OIL AND GAS DIVISION  
 CHARLESTON

**WELL LOCATION MAP**  
 FILE NO. Kan-2393-P

+ Denotes location of well on United States Topographic Maps, scale 1 to 62,500 latitude and longitude lines being represented by border lines as shown.  
 - Denotes one inch spaces on border line of original tracing.

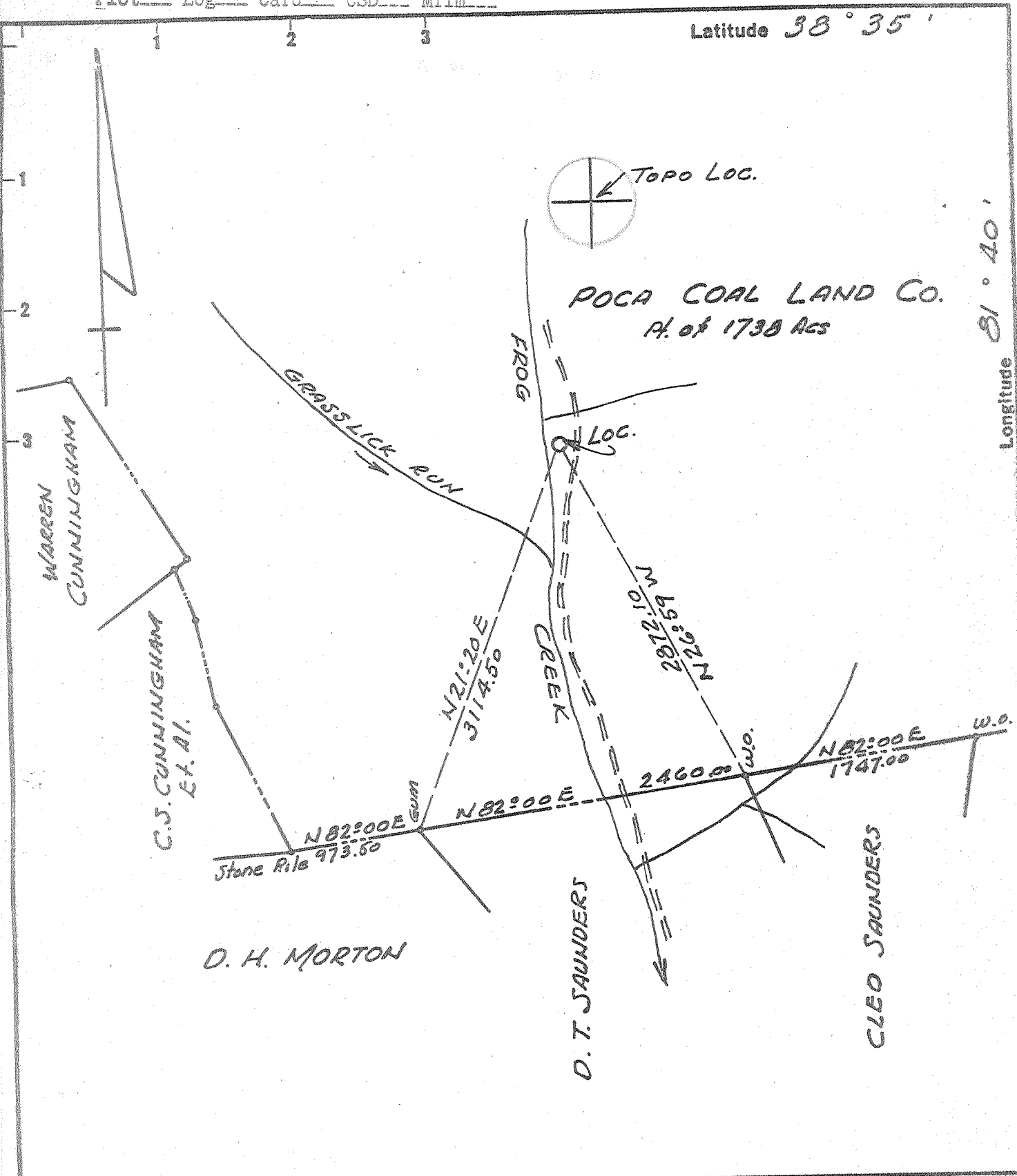

New Location   
 Drill Deeper   
 Abandonment

Minimum Error of Closure 1 in 1000  
 Source of Elevation Elev. 645' Road Intersection 3/4 mile South of Loc.  
 "I, the undersigned, hereby certify that this map is correct to the best of my knowledge and belief and shows all the information required by paragraph 6 of the rules and regulations of the oil and gas section of the mining laws of West Virginia."

Company J. L. TRITTIPO  
 Address NELSON Bldg. CHARLESTON, W.Va.  
 Farm POCA COAL LAND CO.  
 Tract Pt. of 1738 Ac. Acres \_\_\_\_\_ Lease No. \_\_\_\_\_  
 Well (Farm) No. 1 Serial No. \_\_\_\_\_  
 Elevation (Spirit Level) 659.0  
 Quadrangle KENNA SW  
 County KANAWHA District POCA  
 Engineer T. L. Seltzer  
 Engineer's Registration No. 1832  
 File No. \_\_\_\_\_ Drawing No. \_\_\_\_\_  
 Date 4-23-69 Scale 1" = 1000'

STATE OF WEST VIRGINIA  
 DEPARTMENT OF MINES  
 OIL AND GAS DIVISION  
 CHARLESTON

WELL LOCATION MAP  
 FILE NO. Kan-2393

+ Denotes location of well on United States Topographic Maps, scale 1 to 62,500 latitude and longitude lines being represented by border lines as shown.  
 - Denotes one inch spaces on border line of original tracing.

5-0 Rocky Fork 312

Deep Well (Newburg)  
 MAY 11 1969



STATE OF WEST VIRGINIA  
DEPARTMENT OF MINES  
OIL AND GAS DIVISION

Rotary   
Spudder   
Cable Tools   
Storage

Quadrangle Kenna

Permit No. Kan-2393

WELL RECORD

Oil or Gas Well Dry  
(KIND)

Company J. L. Trittipo  
Address 600 Commerce Square  
Farm Poca Coal Land Acres 1738  
Location (waters) Grasslick Run  
Well No. 1 Elev. 659  
District Poca County Kanawha  
The surface of tract is owned in fee by C. M. Melton  
Address Liberty, West Va.  
Mineral rights are owned by Poca Coal Land Co.  
Address Uniontown, Pa.

Drilling commenced May 1, 1969  
Drilling completed May 17, 1969  
Date Shot From To

With  
Open Flow /10ths Water in Inch  
/10ths Merc. in Inch  
Volume Cu. Ft.  
Rock Pressure lbs. hrs.  
Oil bbls., 1st 24 hrs.

WELL ACIDIZED (DETAILS)  
WELL FRACTURED (DETAILS)

RESULT AFTER TREATMENT (Initial open Flow or bbls.)  
ROCK PRESSURE AFTER TREATMENT HOURS  
Fresh Water 700 Feet Salt Water 1300 Feet  
Producing Sand Dry Hole Depth

Casing and Tubing	Used in Drilling	Left in Well	Packers
Size			Kind of Packer
16			
13 3/8	77	77	
10			Size of
8 5/8	2020	2020	
6 3/4			Depth set
5 7/16	5527	5527	
4 1/2			Perf. top
3			Perf. bottom
2			Perf. top
Liners Used			Perf. bottom

Attach copy of cementing record  
CASING CEMENTED 13 3/8 SIZE 7020 No. Ft. 5-2-69 Date  
Amount of cement used (bags) 2 1/2 1000 5-14-69  
Name of Service Co. Halliburton  
COAL WAS ENCOUNTERED AT FEET INCHES  
FEET INCHES FEET INCHES  
FEET INCHES FEET INCHES

Formation	Color	Hard or Soft	Top	Bottom	Oil, Gas or Water	Depth	Remarks
Soil	Black	S	0	20			
Sand & Shale	Brown	Medium	20	190			
Sand	"	Hard	190	220			
Sand & Shale	Brown	Medium	220	1250	F. Water		
Sand	White	Hard	1250	1805	S. Water		
Lime	"	"	1805	2010			
Sand	Brown	Medium	2010	2030	5558	5558	
Sand & Shale	Brown	Soft	2030	2275	4825	659	
Sand	White	Hard	2275	2290	733	4899	
Shale	Brown	Soft	2290	4725			
Lime	Brown	Hard	4725	4825			
Sand	"	"	4825	4848			
Lime	"	"	4848	5558			
Sand	White	"	5558	5570			
Lime	Brown	"	5570	5588	T D		

