

Fracture Before 6/5/27
 New Location
 Drill Deeper
 Redrill
 Abandonment

I, the undersigned, hereby certify that this map is correct to the best of my knowledge and belief and shows all the information required by Paragraph 5 of the Rules and Regulations of the Oil and Gas Section of the Mining Laws of West Virginia.
 The accuracy of this survey is within the limits and as prescribed in paragraph 5 by the Oil and Gas Division of the Department of Mines Regulations.

Company Columbia Gas Trans. Corp.
 Address P.O. Box 1273, Charleston, W.V. 25325
 Farm C. C. FISHER HRS. ET. AL.
 Tract _____ Acres 299 Lease No. 47510 ET. AL.
 Well (Farm) No. 2 Serial No. 9537 P.I.
 Elevation (Spirit Level) 830.22'
 Quadrangle KENNA PLAINANCE 7.5'
 County KANAWHA District POCA
 Engineer Adrian E. Chapman
 Engineer's Registration No. 2330
 File No. 64-69 Drawing No. _____
 Date APRIL 29, 69 Scale 1" = 400'

STATE OF WEST VIRGINIA
 DEPARTMENT OF MINES
 OIL AND GAS DIVISION
 CHARLESTON

WELL LOCATION MAP
 FILE NO. Kan-2409-P

+ Denotes location of well on United States Topographic Maps, scale 1 to 62,500 latitude and longitude lines being represented by border lines as shown.
 - Denotes one inch spaces on border line of original tracing.

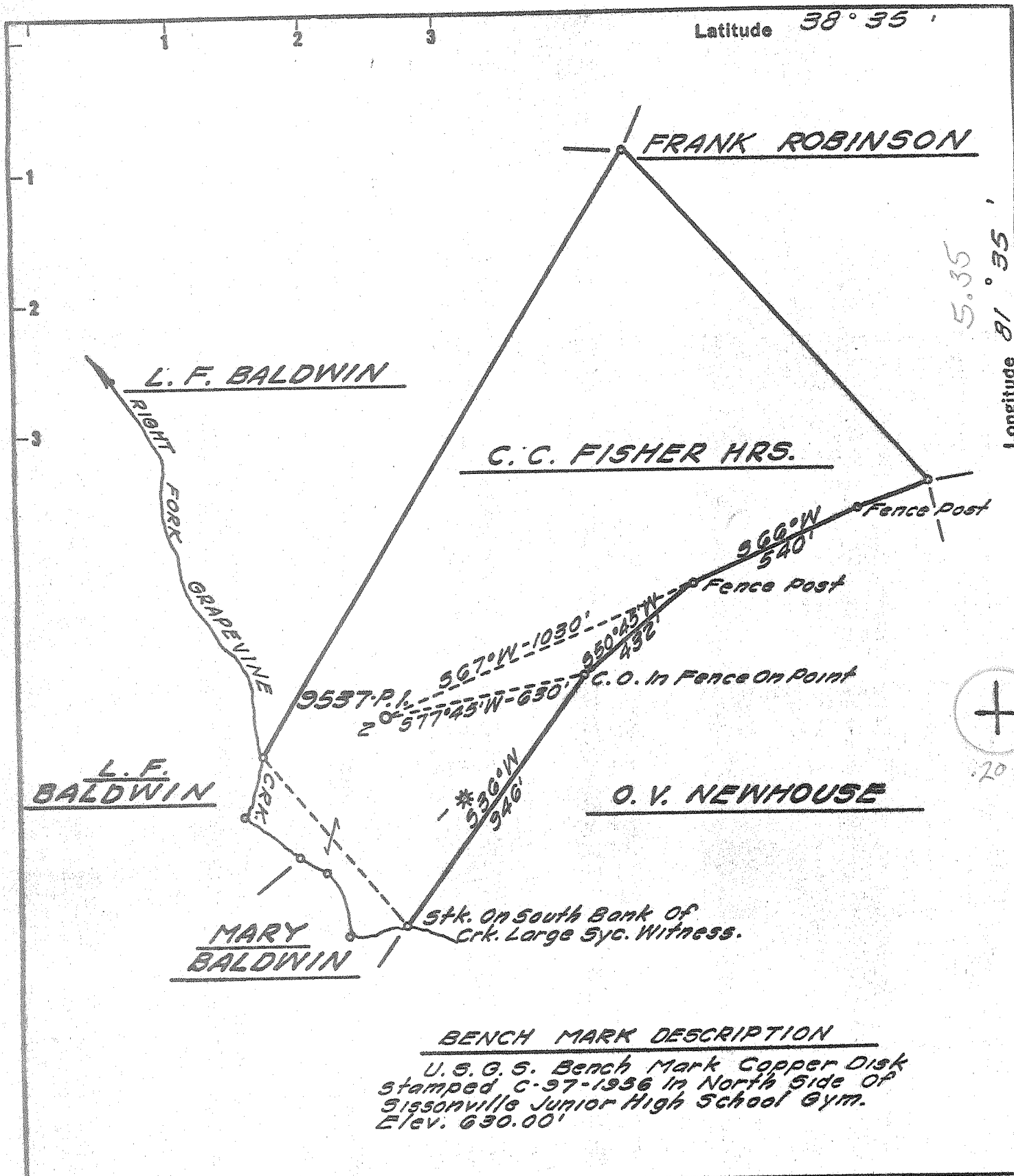

Fracture Before 6/5/27
 New Location
 Drill Deeper
 Redrill
 Abandonment

I, the undersigned, hereby certify that this map is correct to the best of my knowledge and belief and shows all the information required by Paragraph 5 of the Rules and Regulations of the Oil and Gas Section of the Mining Laws of West Virginia.
 The accuracy of this survey is within the limits and as prescribed in paragraph 5 by the Oil and Gas Division of the Department of Mines Regulations.

Company UNITED FUEL GAS CO.
 Address CHARLESTON, W. VA.
 Farm C. C. FISHER HRS. ET. AL.
 Tract _____ Acres 299 Lease No. 47510 ET. AL.
 Well (Farm) No. 2 Serial No. 9537 P.I.
 Elevation (Spirit Level) 830.22'
 Quadrangle KENNA 50
 County KANAWHA District POCA
 Engineer Arthur E. Hardman
 Engineer's Registration No. 2330
 File No. 64-69 Drawing No. _____
 Date APRIL 29, 69 Scale 1" = 400'

(Taken over by J.L. Trittippo)
STATE OF WEST VIRGINIA
 DEPARTMENT OF MINES
 OIL AND GAS DIVISION
 CHARLESTON

WELL LOCATION MAP
 FILE NO. Man-2409

+ Denotes location of well on United States Topographic Maps, scale 1 to 62,500 latitude and longitude lines being represented by border lines as shown.
 - Denotes one inch spaces on border line of original tracing.

MAY 27 1969

U. F. G. Co. 73.5787%
 Spartan 8.0267%
 Ashland 8.0267%
 A. E. D. 10.3679%

Form OG-10



STATE OF WEST VIRGINIA
 DEPARTMENT OF MINES
 OIL AND GAS DIVISION

Rotary
 Spudder
 Cable Tools
 Storage

Quadrangle Sissonville

Permit No. KAN-2409

WELL RECORD

Oil or Gas Well Gas
 (KIND)

Company United Fuel Gas (Taken over by J.L. Trittipo)
 Address P. O. Box 1273 Charleston, W. Va.
 Farm C. C. Fisher Hrs., Et. Al. Acres. 299
 Location (waters) Rt. Fork of Grapevine Creek
 Well No. 9537 PI Elev. 830.22'
 District Poca County Kanawha

Casing and Tubing	Used in Drilling	Left in Well	Packers
Size			Kind of Packer
16		220'	
13		1845'	Size of
9"		5720'	Depth set
7"			Perf. top
6 1/2"			Perf. bottom
5 3/16"			Perf. top
4 1/2"			Perf. bottom
3"			
2"			
Liners Used			

The surface of tract is owned in fee by _____
 Address _____

Mineral rights are owned by _____
 Address _____

Drilling commenced June 15, 1969
 Drilling completed June 24, 1969
 Date Shot Not Shot From _____ To _____

Open Flow 1/10ths Water in _____ Inch
1/10ths Merc. in _____ Inch
 Volume 200 Mcf Cu. Ft.
 Rock Pressure _____ lbs. _____ hrs.
 Oil _____ bbls., 1st 24 hrs.

Attach copy of cementing record.
 CASING CEMENTED 7" SIZE No. Ft. 5675' Date _____
 Amount of cement used (bags) 150
 Name of Service Co. Dowell
 COAL WAS ENCOUNTERED AT _____ FEET _____ INCHES
 _____ FEET _____ INCHES FEET _____ INCHES
 _____ FEET _____ INCHES FEET _____ INCHES

WELL ACIDIZED (DETAILS) _____
 WELL FRACTURED (DETAILS) Did not fracture.

RESULT AFTER TREATMENT (Initial open Flow or bbls.) _____
 ROCK PRESSURE AFTER TREATMENT _____ HOURS _____
 Fresh Water 206 Feet _____ Salt Water _____ Feet _____
 Producing Sand Newburg Depth _____

Formation	Color	Hard or Soft	Top	Bottom	Oil, Gas or Water	Depth	Remarks
Top Soil			0	20	Fresh water	@206'	
Shale-Sand			20	1000	Wet @ 500'		
Big Lime Sand			1000	1540			
Big Lime			1540	1695			
Injun			1695	1740			
Shale			1740	4800			
Cornif. Lime			4800	4885			
Ork. Sand			4885	4920			
Lime & Dol.			4920	5704			
Newburg			5704	5714			
Lime <u>McKenzie</u>			5714	5735			
Total Depth			5735				

Test before fracturing 200 MCF
Did Not Fracture.

Casing Points
13-3/8" 220' Cemented 175-Sks
9-5/8" 1845' Cemented 600-Sks
7" 5720' Cemented 150-Sks

Permit No. KAN:2409
 Well Sold to J. L. Trittipo

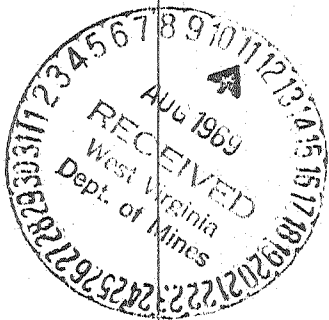

PI completion rpt on reverse side

AUG 20 1969

