

Jamie 9/19/69

Latitude 38 30

5410

Longitude 81 30
7100
81° 32' 30"

K15

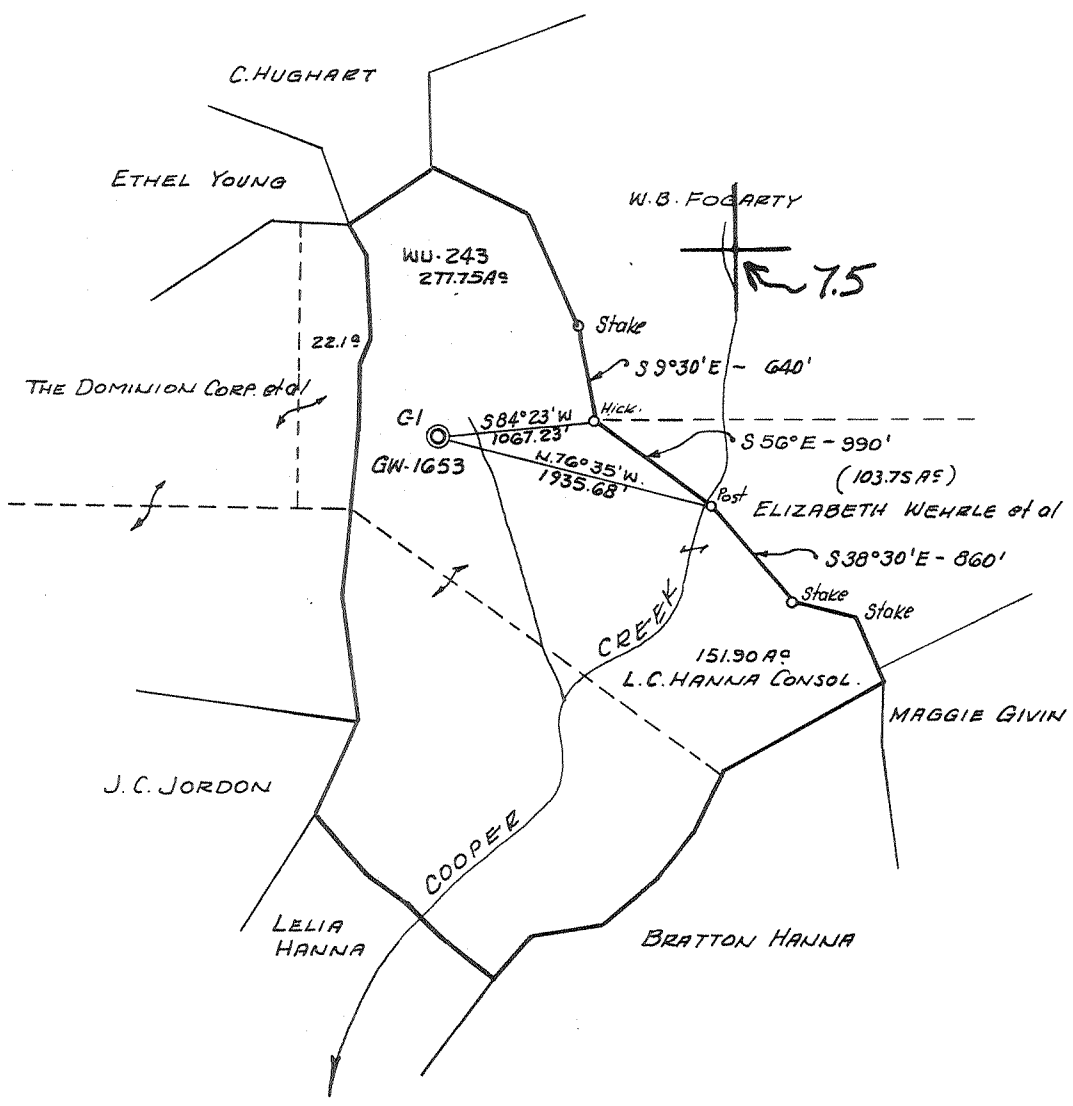

- New Location .
- Drill Deeper
- Redrill
- Abandonment

"I, the undersigned, hereby certify that this map is correct to the best of my knowledge and belief and shows all the information required by paragraph 6 of the rules and regulations of the oil and gas section of the mining laws of West Virginia."
ELEVATION BASE FROM GW-444

Company OXY USA INC.
 Address BOX 873 CHARLESTON, W.VA.
 Farm LEONARD C. HANNA, CONSOL.
 Tract Acres 217.75 Lease No. WU-243
 Well (Farm) No. E-1 Serial No. GW-1653
 Elevation (Spirit Level) 873.95
 Quadrangle CHARLESTON - 15/Big Chimney 7.5
 County KANAWHA District ELK
 Engineer Wendell S. Maxine
 Engineer's Registration No. 2113
 File No. _____ Drawing No. W-3-69
 Date 29 MAY 69 Scale 1"=1320'

STATE OF WEST VIRGINIA
 DEPARTMENT OF MINES
 OIL AND GAS DIVISION
 CHARLESTON

WELL LOCATION MAP
 FILE NO. KAN-2410 Plugging
47-039-

+ Denotes location of well on United States Topographic Maps, scale 1 to 62,500, latitude and longitude lines being represented by border lines as shown.

- Denotes one inch spaces on border line of original tracing.

SEP 20 1969

Latitude 38 30

1.39 S
3.33 W

Longitude 81 30'

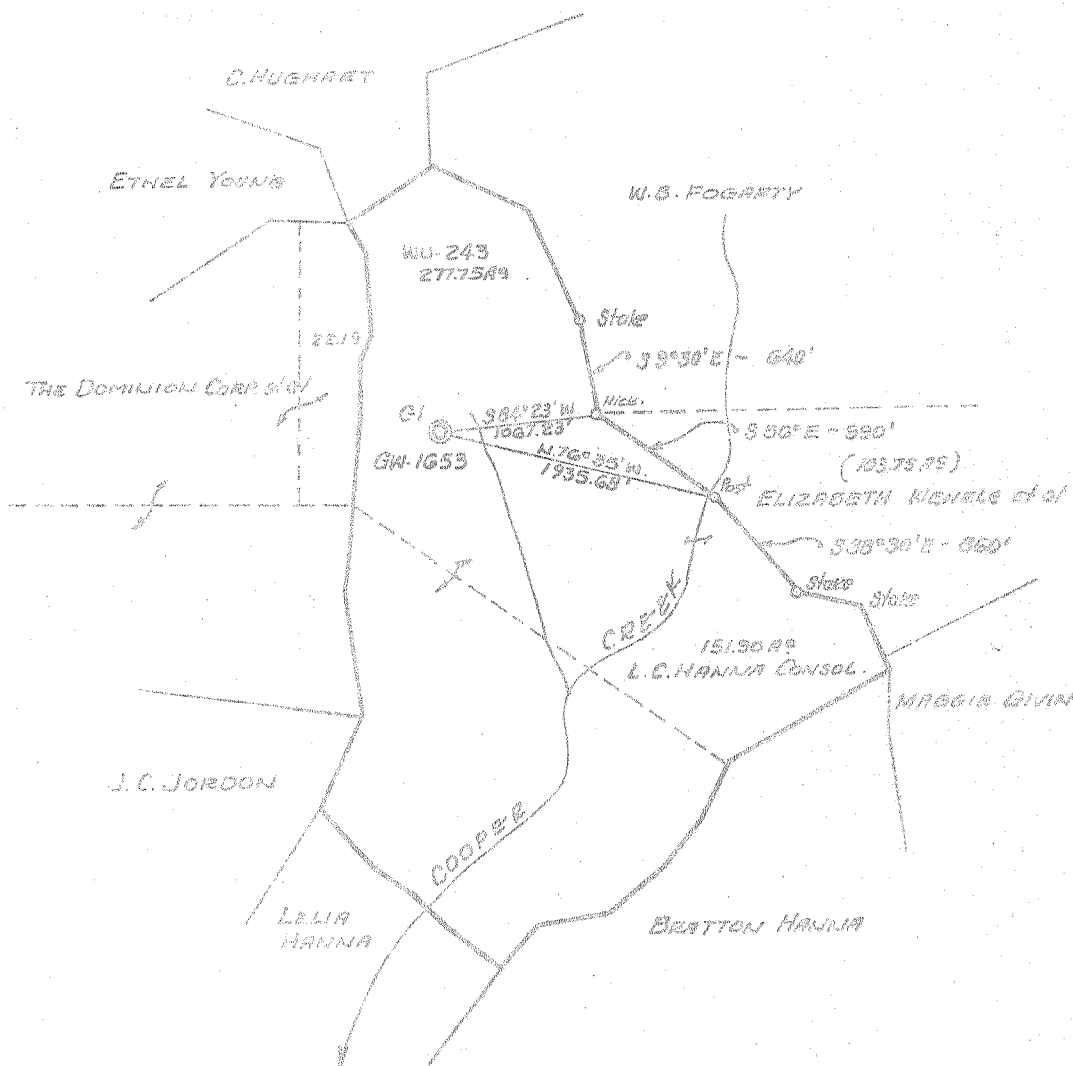

2.02 S
0.51 W

- New Location
- Drill Deeper
- Redrill
- Abandonment

"I, the undersigned, hereby certify that this map is correct to the best of my knowledge and belief and shows all the information required by paragraph 8 of the rules and regulations of the oil and gas section of the mining laws of West Virginia." ELEVATION BASE FROM GN-545

Company CITIES SERVICE OIL COMPANY
 Address Box 873 Charleston, W. Va.
 Firm LEONARD C. HANNA, CONSOL.
 Tract Acres 277.75 Lease No. WV-243
 Well (Form) No. G-1 Serial No. GW-1653
 Elevation (Spirit Level) 873.95
 Quadrangle CHARLESTON - 1 NE
 County KANAWHA District FLK
 Engineer Wendell S. Moore
 Engineer's Registration No. 2113
 File No. _____ Drawing No. WV-3-69
 Date 23 MAY 69 Scale 1"=1320'

STATE OF WEST VIRGINIA
 DEPARTMENT OF MINES
 OIL AND GAS DIVISION
 CHARLESTON

WELL LOCATION MAP
 FILE NO. KAN-2410

+ Denotes location of well on United States Topographic Maps, scale 1 to 62,500, latitude and longitude lines being represented by border lines as shown.
 - Denotes one inch spaces on border line of original tracing.



STATE OF WEST VIRGINIA
DEPARTMENT OF MINES
OIL AND GAS DIVISION 4

Rotary
Spudder
Cable Tools
Storage
Oil or Gas Well **Gas** (KIND)

Quadrangle Chas. 1 30° 30' 3-22

Permit No. KAN-2410

WELL RECORD

Company Cities Service Oil Company
Address Box 873, Charleston, W. Va. 25323
Farm L. C. Hanna Consol. Acres 277.75
Location (waters) Coopers Creek
Well No. "E" #1, GW-1653 Elev. 879'
District E1k County Kanawha
The surface of tract is owned in fee by Reba H. Mechinsky, et al
1335 Hickory Road Address Chas. W. Va.
Mineral rights are owned by Harry L. Paxton, et al
910 Price St. Address Chas. W. Va.
(for further add. contact C. S. O. Co) 8-30-69
Drilling commenced 8-30-69
Drilling completed 9-12-69
Date Shot. From To

Casing and Tubing	Used in Drilling	Left in Well	Packers
Size			Kind of Packer
16			none
13 3/8" 48#	62'	62'	Size of
10 24#	1907'	1907'	Depth set
8 5/8"			Perf. top
5 1/2" 17#	5801'	5801'	Perf. bottom
4 1/2"			Perf. top
3			Perf. bottom
2 3/8" 4.7#	5850'	5850'	
Liners Used	with cage		

Open Flow /10ths Water in Inch
/10ths Merc. in Inch
Volume Cu. Ft.
Rock Pressure lbs. hrs.
Oil bbls. 1st 24 hrs.
WELL ACIDIZED (DETAILS) not acidized
WELL FRACTURED (DETAILS) see reverse side

Attach copy of cementing record.
CASING CEMENTED SIZE No. Ft. Date
Amount of cement used (bags)
Name of Service Co. see reverse side
COAL WAS ENCOUNTERED AT None FEET INCHES
FEET INCHES FEET INCHES
FEET INCHES FEET INCHES

RESULT AFTER TREATMENT (Initial open Flow or bbls.)

60,000 MCFD Newburg *see revised record*

ROCK PRESSURE AFTER TREATMENT

24 HOURS Tub. 2217#; BH 2233#

Fresh Water 568' Feet

Salt Water Feet

Producing Sand Newburg Sand

Depth 5769-5794' per electric logs

Formation	Color	Hard or Soft	Top	Bottom	Oil, Gas or Water	Depth	Remarks
Shale			0	70			
Sand			70	81			
Sand and Shale			81	273			
Sand			273	298			
Sand and Shale			298	382			
Sand			382	415			
Shale			415	678	F. water	568'	
Sand and Shale			678	980			
Sand			980	1366			
Lime			1366	1772			
Lime and Shale			1772	1785			
Sand			1785	1815			
Sand and Shale			1815	1905			
Shale			1905	2527			
Sand and Shale			2527	2587			
Shale			2587	4891			
Lime			4891	5778			
Newburg Sand			5778	5794	Gas	5778'	est. 25,000MCF
Lime	<u>McKenzie</u>		5794	5822			
Total depth				5822'	Drillers' meas.		
				5815'	Schlumberger's Meas.		
Electric Logs showed:							
Newburg Sand			5769	5794			

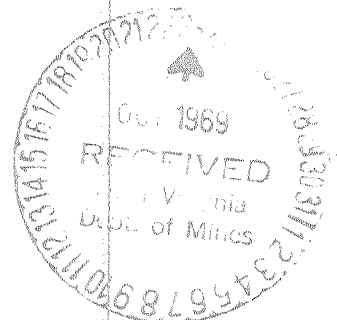

Formation	Color	Hard or Soft	Top 4'	Bottom	Oil, Gas or Water	Depth Found	Remarks
CASING RECORD							
8-30-69							Set and cemented 13-3/8" 48# H-40 casing at 79' with 100 sacks regular cement with 4% ca. cl. Good returns.
9-4-69							Set and cemented 8-5/8" 24# J-55 new casing at 1905' with 222 sacks Pozmix and 100 sacks regular cement. Cement circulated to surface. Pumped 50 bbls. 6% gel with lost circulation material ahead of cement.
9-9-69							Set and cemented 5-1/2" 17# J-55 and N-80 new casing at 5740' (2,094' of N-80 run on top of string) with 125 sacks cement and 35 sacks Latex. Pumped 300 bbls. 6% gel with lost circulation material ahead of cement. Good circulation of gel to the surface. Centralizers 5707', 5509', 5514', 5425' and 5319'. Float at 5707'
9-13-69							Ran Schlumberger Dual Induction, Gamma Ray Compensated Formation Density, caliper and Cement Bond Log. Schlumberger T.D. 5815'
9-30-69							FRACTURED THE NEWBURG SAND Pumped in 500 gallons MCA and 1,000 gallons regular 15% acid. Followed with 26,000# 20-40 sand in 24,000 gallons gelled water. Maximum treating pressure 4100#. Average treating pressure 3880#. AIR 32 bbl/min. Used 690 bbls. total fluid-flowing back.
10-2-69							24 hour SIP tubing 2217#, annulus 2233#. F.O.F. 60,000 MCFD.

Date October 22, 19 69

APPROVED Cities Service Oil Company, Owner

By L. D. Todd, Region Manager
(Title)



STATE OF WEST VIRGINIA
DEPARTMENT OF MINES
OIL AND GAS WELLS DIVISION

Rotary
Spudder
Cable Tools
Storage

Quadrangle Chas. 1 3-22
Permit No. KAN-2410

WELL RECORD
AMENDED

Oil or Gas Well Gas
(KIND)

Company Cities Service Oil Company
Address Box 873, Charleston, W. Va. 25323
Farm L. C. Hanna Consol. Acres 277.75
Location (waters) Coopers Creek
Well No. "E" #1 GW-1653 Elev. 879'
District E1k County Kanawha
The surface of tract is owned in fee by Reba H. Mechinsky, et al
1335 Hickory Road, Address Chas. W. Va.
Mineral rights are owned by Harry L. Paxton, et al
910 Price St. Address Chas. W. Va.
(for further add. contact C. S. O. Co) 8-30-69
Drilling commenced 9-12-69
Drilling completed 9-12-69
Date Shot not shot From To
With
Open Flow /10ths Water in Inch
 /10ths Merc. in Inch
Volume Cu. Ft.
Rock Pressure lbs. hrs.
Oil bbls., 1st 24 hrs.
WELL ACIDIZED (DETAILS) not acidized
WELL FRACTURED (DETAILS) see reverse side

Casing and Tubing	Used in Drilling	Left in Well	Packers
Size			Kind of Packer
16			none
13 3/8" 48#	62'	62'	Size of
10			Depth set
8 1/4" 24#	1907'	1907'	
6%			Perf. top
5-1 1/2" 17#	5801'	5801'	Perf. bottom
4 1/2			Perf. top
3			Perf. bottom
2 3/8" 4.7#	5850'	5850'	
Liners Used	with cage		

Attach copy of cementing record.
CASING CEMENTED SIZE No. Ft. Date
Amount of cement used (bags)
Name of Service Co. see reverse side
COAL WAS ENCOUNTERED AT FEET INCHES
 FEET INCHES FEET INCHES
 FEET INCHES FEET INCHES

RESULT AFTER TREATMENT (Initial open Flow or bbls.) 168,000 MCFD (Newburg) (4 point test) 6,800,000
ROCK PRESSURE AFTER TREATMENT HOURS Tubing 2232#, annulus 2235#
Fresh Water 568' Feet Salt Water Feet
Producing Sand Newburg Sand Depth 5769-5794' per electric logs

Formation	Color	Hard or Soft	Top	Bottom	Oil, Gas or Water	Depth	Remarks
Shale			0	70			
Sand			70	81	5769	5769	
Sand and Shale			81	273	879		
Sand			273	298	4890		
Sand and Shale			298	382			
Sand			382	415			
Shale			415	678	F. water	568'	
Sand and Shale			678	980			
Sand			980	1366			
Lime			1366	1772 -406			
Lime and Shale			1772	1785 -13			
Sand			1785	1815 -30			
Sand and Shale			1815	1905			
Shale			1905	2527			
Sand and Shale			2527	2587			
Shale			2587	4891			
Lime			4891	5778			
Newburg Sand			5778	5794	Gas	5778'	est. 25,000 Mcf
Lime McKenzie			5794	5822			
Total depth				5822'	Drillers' meas. =		
				5815'	Schlumberger's meas.		
Electric logs showed:							
Newburg Sand			5769	5794	25		

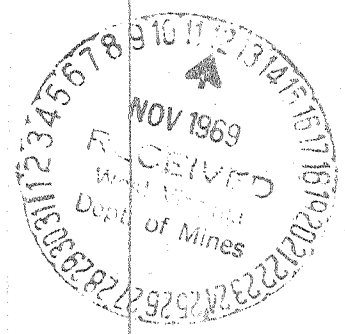

Formation	Color	Hard or Soft	Top \angle	Bottom	Oil, Gas or Water	Depth Found	Remarks
CASING RECORD							
8-30-69							Set and cemented 13-3/8" 48# H-40 casing at 79' with 100 sacks regular cement with 4% ca. cl. Good returns.
9-4-69							Set and cemented 8-5/8" 24# J-55 new casing at 1905' with 222 sacks Pozmix and 100 sacks regular cement. Cement circulated to surface. Pumped 50 bbls. 6% gel with lost circulation material ahead of cement.
9-9-69							Set and cemented 5-1/2" 17# J-55 and N-80 new casing at 5740' (2,094' of N-80 run on top of string) with 125 sacks cement and 35 sacks Latex. Pumped 300 bbls. 6% gel with lost circulation material ahead of cement. Good circulation of gel to the surface. Centralizers 5707', 5609', 5514', 5425' and 5319'. Float at 5707'
9-13-69							Ran Schlumberger Dual Induction, Gamma Ray, Compensated Formation Density, Caliper and Cement Bond Log. Schlumberger T. D. 5815'
9-30-69							FRACTURED THE NEWBURG SAND
							Pumped in 500 gallons MCA and 1,000 gallons regular 15% acid. Followed with 26,000# 20-40 sand in 24,000 gallons gelled water. Maximum treating pressure 4100#. Average treating pressure 3880#. AIR 32 bbl/min. Used 690 bbls. total fluid-flowing back.
10-2-69							24 hour SIP tubing 2217#, annulus 2233#, F. O. F. 60,000 MCFD
10-28-69							United Fuel ran 4 point open flow test. Well calculated 168,000 MCFD open flow at the face of the sand from test. Shut in pressure - tubing 2232#, annulus 2235#.

Date November 11, 1969.

APPROVED Cities Service Oil Company, Owner

By L. D. Todd, Region Manager
(Title)

STATE OF WEST VIRGINIA
DEPARTMENT OF ENERGY
DIVISION OF OIL AND GAS

AFFIDAVIT OF PLUGGING AND FILLING WELL

AFFIDAVITE SHOULD BE IN TRIPLICATE, one copy mailed to the Division, one copy to be retained by the Well Operator and the third copy (and extra copies if required) should be mailed to each coal operator at their respective addresses.

Farm name: KANAWHA VALLEY OIL CO Operator Well No.:HANNA E1-GW1653

LOCATION: Elevation: 873.95 Quadrangle: BIG CHIMNEY
District: ELK County: KANAWHA
Latitude: 7100 Feet South of 38 Deg. 30 Min. 0 Sec.
Longitude 5410 Feet West of 81 Deg. 32 Min. 30 Sec.

Well Type: OIL _____ GAS X

Company: OXY USA INC.
P. O. BOX 873
CHARLESTON, WV 25323

Coal Operator Not Applicable
or Owner _____

Agent: DELBERT G. OLIVER
Inspector: CARLOS HIVELY
Permit Issued: 09/25/89

Coal Operator _____
or Owner _____

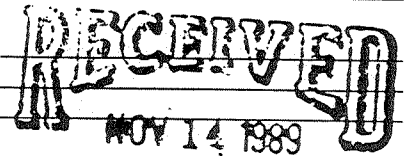

AFFIDAVIT

STATE OF WEST VIRGINIA,
County of KANAWHA

ss:

DIVISION OF OIL & GAS
DEPARTMENT OF ENERGY

TIMOTHY A. COOK, OXY USA INC. and TIM HICKMAN, WELL TECH being first duly sworn according to law depose and say that they are experienced in the work of plugging and filling oil and gas wells and were employed by OXY USA INC., well operator, and participated in the work of plugging and filling the above well, that said work was commenced on the 2ND day of NOVEMBER, 1989, and that the well was plugged and filled in the following manner:

TYPE	FROM	TO	PIPE REMOVED	LEFT
60 sks Latex Cement	5570'	4895'	5570' of 2-3/8"	196' (SEE BACK)
Baker 5-1/2" Model T CTBP		4894'		
6% Gel	4894'	4085'	4000' of 5-1/2"	1740'
45 sks Class "A" Cement	4085'	3885'		
6% Gel	3885'	1995'		
60 sks Class "A" Cement	1995'	1795'		
Baker 8-5/8" Model N-1 CTBP		1795'		
6% Gel	1795'	150'		
47 sks Class "A" Cement	150'	0'		

Description of monument: 8-5/8" CASING, 5 FT HIGH WITH OXY USA INC., HANNA E-1, GW 1653, API NO. 47-39-02410-P ON NAME PLATE
and that the work of plugging and filling said well was completed on the 9TH day of NOVEMBER, 1989.

And further deponents saith not.

Sworn and subscribe before me this 9 day of November, 1989
My commission expires: June 1, 1999

Timothy A. Cook
Tim Hickman (Well Tech)
Donald G. Bay NOV 20 1989
Notary Public
Commission Expires _____

039 2410

MR. JAMIE STEVENS VERBALLY APPROVED CUTTING OFF STUCK TUBING AT 10:30 A.M. NOVEMBER 3, 1989.
PULLED 25,000 LBS OVER TUBING STRING WEIGHT. COULD NOT PUMP DOWN TUBING OR CASING AT
1000 PSIG.

RECEIVED
NOV 14 1989

DIVISION OF OIL & GAS
DEPARTMENT OF ENERGY

[Faint, illegible handwritten notes]

NOV 20 1989