

Plot Log Card CSD Mflm

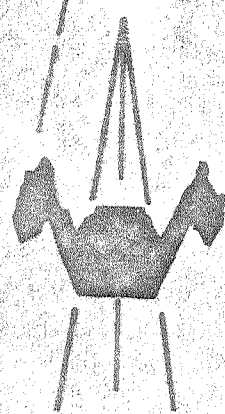
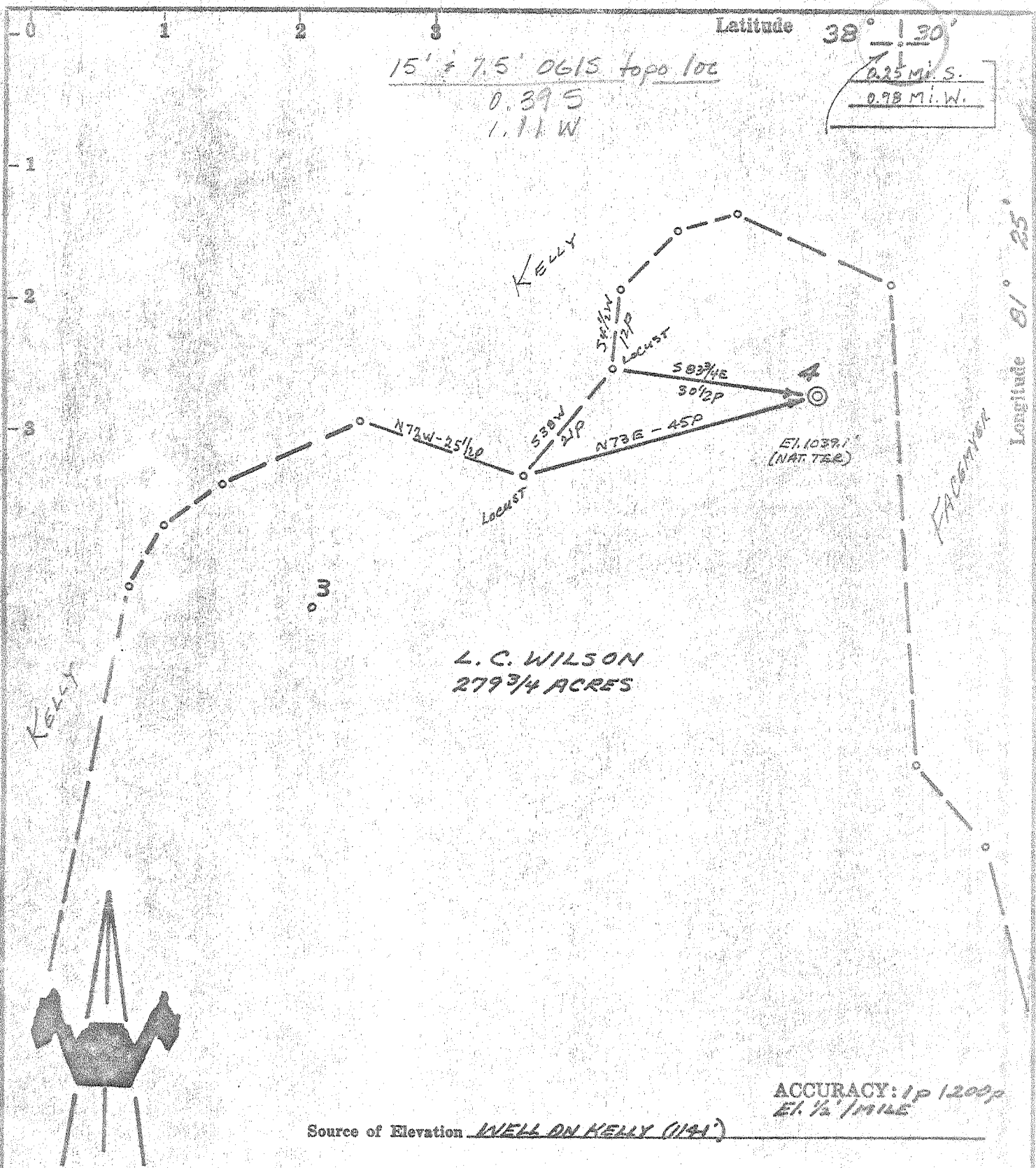

ACCURACY: 1 P 1200 P
E1. 1/2 MILE

Source of Elevation WELL ON KELLY (1141)

- New Location
- Drill Deeper
- Abandonment
- Fracture
- Redrill

I, the undersigned, hereby certify that this map is correct to the best of my knowledge and belief and shows all the information required by paragraph 6 of the rules and regulations of the oil and gas section of the mining laws of West Virginia.

Chet Waterman

Company	MAREVE OIL CORPORATION
Address	P. O. BOX 1228 PARKERSBURG, W. VA. 26101
Farm	L.C. WILSON
Tract	Acres 279 3/4 Lease No. _____
Well (Farm) No.	4 Serial No. _____
Elevation (Spirit Level)	10391'
Quadrangle	CLENDENIN
County	KANAWHA District <u>NW</u>
Engineer	CHET WATERMAN <u>Big SANDY - Elk</u>
Engineer's Registration No.	3788 <u>on line - closer to Elk</u>
File No.	69003-224 Drawing No. _____
Date	6/16/69 Scale 1" = 200'

STATE OF WEST VIRGINIA
DEPARTMENT OF MINES
OIL AND GAS DIVISION
CHARLESTON

WELL LOCATION MAP
FILE NO. KAN-2419

- + Denotes location of well on United States Topographic Maps, scale 1 to 62,500, latitude and longitude lines being represented by border lines as shown.
- Denotes one inch spaces on border line of original tracing.

6-6 Blue Creek (Falling Rock) 217

JUL 18 1969