

0.250
5.0
1.50
M

Elevation based on U.S.G.S. B.M. #TF-22, standard metal plate in concrete block north of Legg Fork Road, 1500' northeast of mouth of Munday Hollow. Elev. = 645.0

"I, the undersigned, hereby certify that this map is correct to the best of my knowledge and belief and shows all the information required by paragraph 6 of the rules and regulations of the oil and gas section of the mining laws of West Virginia."

John H. Burtwell

Accuracy of survey is within limits set by the Oil & Gas Division, W.Va. Dept. of Mines.

New Location
 Drill Deeper
 Abandonment
 Transferred to Ashland Oil, Inc. 2-16-70

Company	PROFESSIONAL OIL MANAGEMENT, INC.
Address	BOX 374-ANN ARBOR, MICH.
Farm	MILLER-REESE UNIT
Tract	Acres 86 Lease No.
Well (Farm) No.	1 Serial No.
Elevation (Spirit Level)	1057.5
Quadrangle	CHARLESTON NC
County	KANAWHA District POCA
Engineer	<i>John H. Burtwell</i>
Engineer's Registration No.	1442
File No.	Drawing No.
Date	DEC. 19, 1969 Scale 1" = 660'

STATE OF WEST VIRGINIA
 DEPARTMENT OF MINES
 OIL AND GAS DIVISION
 CHARLESTON

WELL LOCATION MAP
 FILE NO. KAN-2452

+ Denotes location of well on United States Topographic Maps, scale 1 to 62,500, latitude and longitude lines being represented by border lines as shown.
 - Denotes one inch spaces on border line of original tracing.

6-6 Rocky Fork 312

Deep Well (Newburg)

MAR 09 1970

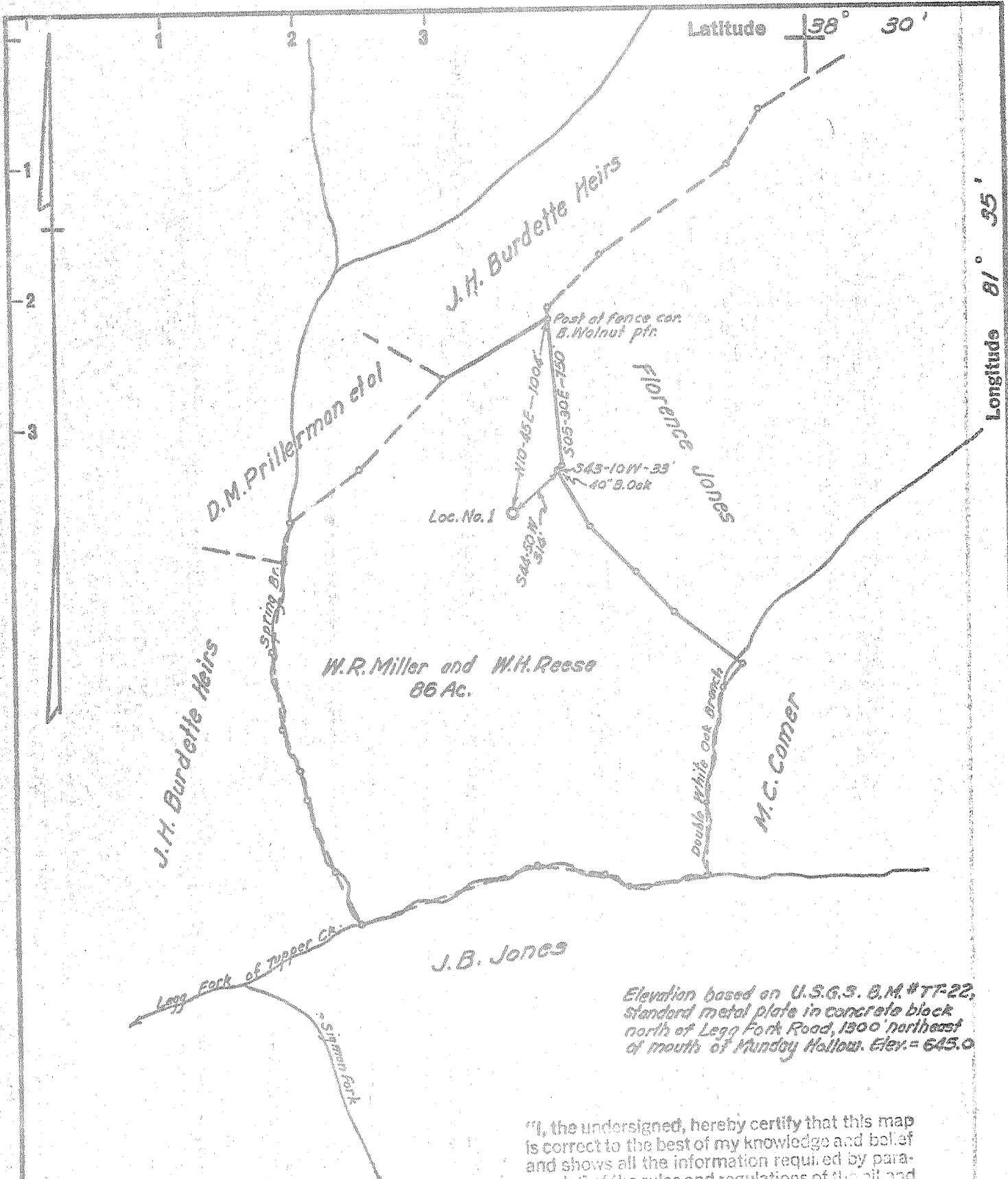

Elevation based on U.S.G.S. B.M. #TF-22, standard metal plate in concrete block north of Legg Fork Road, 1500' northeast of mouth of Munday Hollow. Elev. = 645.0

"I, the undersigned, hereby certify that this map is correct to the best of my knowledge and belief and shows all the information required by paragraph 6 of the rules and regulations of the oil and gas section of the mining laws of West Virginia."

John H. Burdett

Accuracy of survey is within limits set by the Oil & Gas Division, W.Va. Dept. of Mines.

New Location
 Drill Deeper
 Abandonment *Transferred to Ashland Oil, Inc. 2-16-70*

Company	<u>PROFESSIONAL OIL MANAGEMENT, INC.</u>
Address	<u>BOX 374-ANN ARBOR, MICH.</u>
Farm	<u>MILLER-REESE UNIT</u>
Tract	Acres <u>86</u> Lease No. _____
Well (Farm) No.	<u>1</u> Serial No. _____
Elevation (Spirit Level)	<u>1057.5</u>
Quadrangle	<u>CHARLESTON</u> <u>NC</u>
County	<u>KANAWHA</u> District <u>POCA</u>
Engineer	<u>John H. Burdett</u>
Engineer's Registration No.	<u>1442</u>
File No.	Drawing No. _____
Date	<u>DEC. 19, 1969</u> Scale <u>1" = 660'</u>

STATE OF WEST VIRGINIA
 DEPARTMENT OF MINES
 OIL AND GAS DIVISION
 CHARLESTON

WELL LOCATION MAP
 FILE NO. KAN-2452

+ Denotes location of well on United States Topographic Maps, scale 1 to 62,500, latitude and longitude lines being represented by border lines as shown.

- Denotes one inch spaces on border line of original tracing.

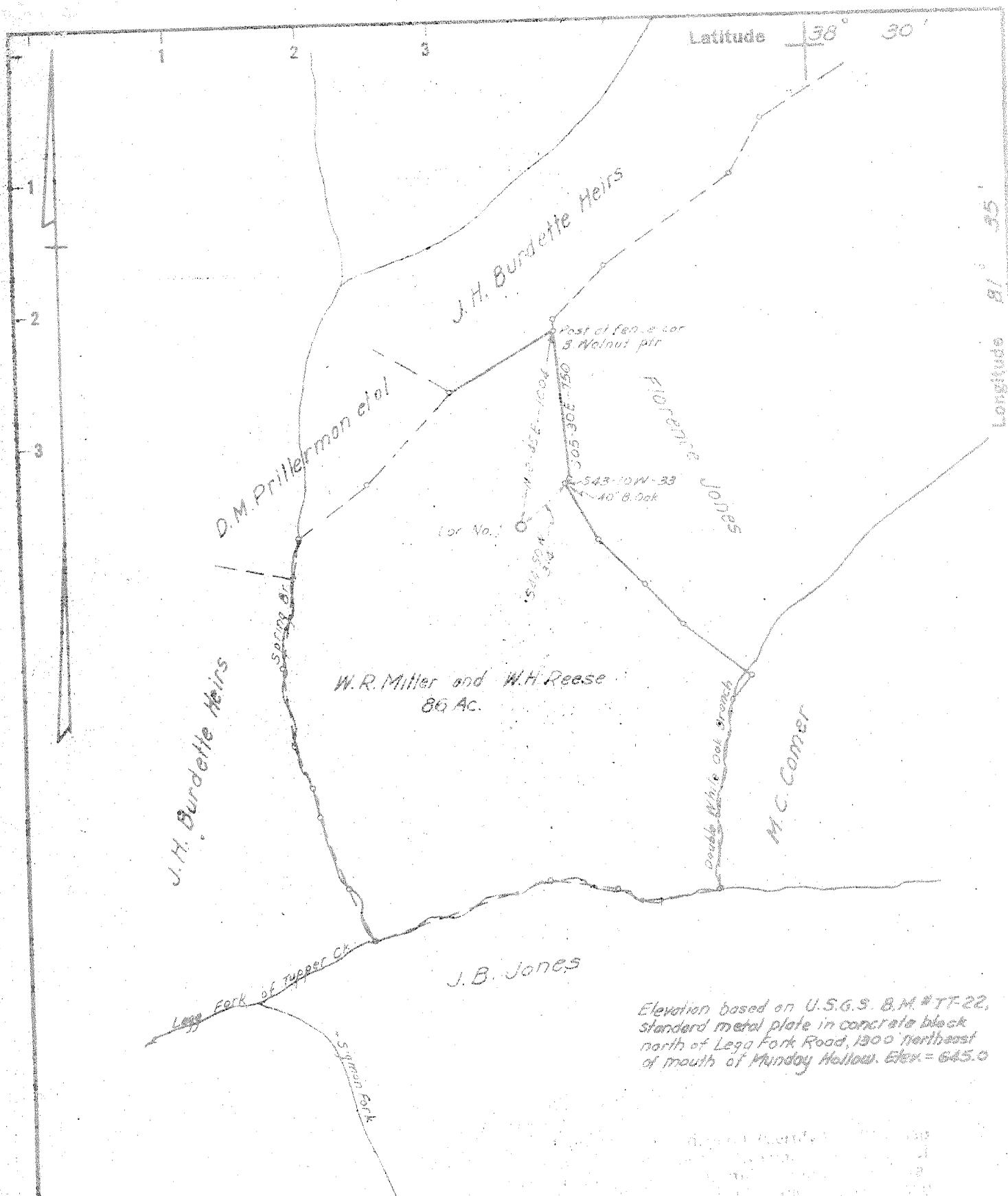

Elevation based on U.S.G.S. B.M. #TT-22, standard metal plate in concrete block north of Lega Fork Road, 1300' northeast of mouth of Munday Hollow. Elev. = 645.0

Accuracy of survey is within limits set by the Oil & Gas Division, W.Va. Dept. of Mines

New Location
 Drill Deeper
 Abandonment

John H. Burtwell

Company PROFESSIONAL OIL MANAGEMENT, INC.
 Address BOX 374-ANN ARBOR, MICH.
 Farm MILLER-REESE UNIT
 Tract _____ Acres 86 Lease No. _____
 Well (Farm) No. 1 Serial No. _____
 Elevation (Spirit Level) 1057.5
 Quadrangle CHARLESTON NC
 County KANAWHA District POCA
 Engineer John H. Burtwell
 Engineer's Registration No. 1442
 File No. _____ Drawing No. _____
 Date DEC. 19, 1969 Scale 1" = 660'

STATE OF WEST VIRGINIA
 DEPARTMENT OF MINES
 OIL AND GAS DIVISION
 CHARLESTON

WELL LOCATION MAP
 FILE NO. KAN-2452

+ Denotes location of well on United States Topographic Maps, scale 1 to 62,500, latitude and longitude lines being represented by border lines as shown.
 - Denotes one inch spaces on border line of original tracing.

RECEIVED

JUL 8 1970



STATE OF WEST VIRGINIA

OIL & GAS DIVISION DEPARTMENT OF MINES
DEPT. OF MINES AND GAS WELLS DIVISION

Rotary
 Spudder
 Cable Tools
 Storage
 Oil or Gas Well (Gas) (KIND)

Quadrangle... Charleston
 Permit No. KAN-2452

WELL RECORD

Company	Address	Farm	Location (waters)	Well No.	District	The surface of tract is owned in fee by	Mineral rights are owned by	Drilling commenced	Drilling completed	Date Shot	With	Open Flow	Volume	Rock Pressure	Oil	WELL ACIDIZED (DETAILS)	WELL FRACTURED (DETAILS)	RESULT AFTER TREATMENT	ROCK PRESSURE AFTER TREATMENT	Fresh Water	Producing Sand
Ashland Oil, Inc.	P. O. Box 391, Ashland, Ky. 41101	Miller-Reece et al	Legg Fork of Tupper's Creek	Unit No. 1	Poca	Ida Linkenauger	Wm. Reece, W. R. Miller, al Box 474 Legg Star Rt.	April 17, 1970	May 19, 1970			/10ths Water in	11 MMCF w/side static before Frac.	Not taken			By Halliburton May 28, 1970 My-T-Frac w/500 gal. 15% MCA, 476 Bbl. treated wtr, 44,000# 2/40 sand. See details	17 MMCF Side Static after Frac	912 psig		Newburg
Attach copy of cementing record. 13 3/8" w/30 sx 4/19/70 CASING CEMENTED 8 5/8" w/390 sx 4/28/70 Amount of cement used (bags) 5 1/2" w/100 cu. ft. & 200gal. Cement Name of Service Co. Well Service, Halliburton, Dowell COAL WAS ENCOUNTERED AT _____ FEET _____ INCHES _____ FEET _____ INCHES _____ FEET _____ INCHES _____ FEET _____ INCHES _____ FEET _____ INCHES Hours 44 Salt Water _____ Feet Depth 5940-5949																					

Formation	Color	Hard or Soft	Top	Bottom	Oil, Gas or Water	Depth	Remarks
Shale & Sand			0	1252			
Salt Sand			1252	1733			
Shale			1733	1740			
Little Lime			1740	1778			
Pencil Cave			1778	1782			
Big Lime			1782	1940			
Injun			1940	1999			
Shale & Sand			1999	2414			
Berea?			2414	2423			
Shale			2423	5043			
Corniferous			5043	5148			
Oriskany			5148	5200			
Lime & Dolomite			5200	5940			
Newburg, Gas			5940	5949			
Sand, tite			5949	5960			
Dolomite McKenzie			5960	5972			

Note: Log made from Geolograph record, no electric log run
 DTD 5972

(over)

Formation	Color	Hard or Soft	Top	Bottom	Oil, Gas or Water	Depth Found	Remarks
46' of 13 3/8"	48# H-40	csg. @ 46' w/	30 sx. circl.	by Well Service			
2004' of 8 5/8"	24# H-40	csg @ 2021'	w/100 sx. Standard Bulk	cem, 2 sx. Calcium Chloride (2% blend) 290 sx Halliburton light cem., 25# Flocele, 10 sx. Gel, 1-Guide Shoe, 1 insert Float valve, 1 - self fill-up unit, 3 csg centralizers	by Halliburton	April 4, 1970.	
5899' of 5 1/2"	17# N-80	R-2 csg. @ 5915'	w/100 cu. ft. Neat,	200 gal. Gealment (Latex cement) 230 bbl. Gel, 5 centralizers, 1 guide shoe, 1 float collar, 2 Dowell baskets, plug down 4 a.m. May 6, 1970 by Dowell.			
5919' of 2 3/8"	OD 4.6#	J-55 R 2 tubing w/Baker non-ported seating nipple and w/collar open ended bottom. 1 - 5' & 1 - 10' sub. Tubing on hanger.				5/19/70.	
May 28, 1970 -	Hole was full of Gel from fishing job. Circled hole clean. My-T-Frac using 500 gal. 15% MCA, Treatment; 476 Bbl. treated wtr. w/44,000# 20/40 sand, used 5 gal. suds, 20 gal. Morflo, 200# WAC-9, 20 Sx. KCl. Displaced w/105 bbl. wtr. Breakdown pressure 2,000#, Max 4500#, Average 4075#. Shut-in pressure 4200#, 5 min- 3900#, 15 min. 3600# Max. Sd concentration - 4#/gal., average - 2.2#/gal. Frac down annulus only. Frac by Halliburton Services.						
May 29, 1970	Unloaded hole w/nitrogen, used 71.99MSCF pumped by Aircowell.						
Calculated Open Flow	10.7 MMCF/D @						
Initial Rock Pressure	of 912.0 psig after frac.						

Date..... June 30....., 1970.....

APPROVED ASHLAND OIL, INC., Owne
By Bill D. [Signature]
Division Manager (Title)