

Company CITIES SERVICE OIL COMPANY
 Address BOX 873 CHARLESTON W. VA.
 Farm MOSE PUSHKIN ET AL (CONSOL)
 Part of 310.0 AF
 Tract _____ Acres 175 Lease No. NW 248
 Well (Farm) No. B-1 Serial No. GW 1603
 Elevation (Spirit Level) 888.13
 Quadrangle CHARLESTON 3 2 X NE
 County KANAWHA District FOR Poca
 Engineer Wendell J. Moore
 Engineer's Registration No. 2113
 File No. _____ Drawing No. W-2-70
 Date 3 FEB 70 Scale 1" = 660'

STATE OF WEST VIRGINIA
 DEPARTMENT OF MINES
 OIL AND GAS DIVISION
 CHARLESTON

WELL LOCATION MAP
 FILE NO. KAN-2458-P

+ Denotes location of well on United States Topographic Maps, scale 1 to 62,500, latitude and longitude lines being represented by border lines as shown.

- Denotes one inch spaces on border line or original tracing.

Deep Well

JUN 21 1974

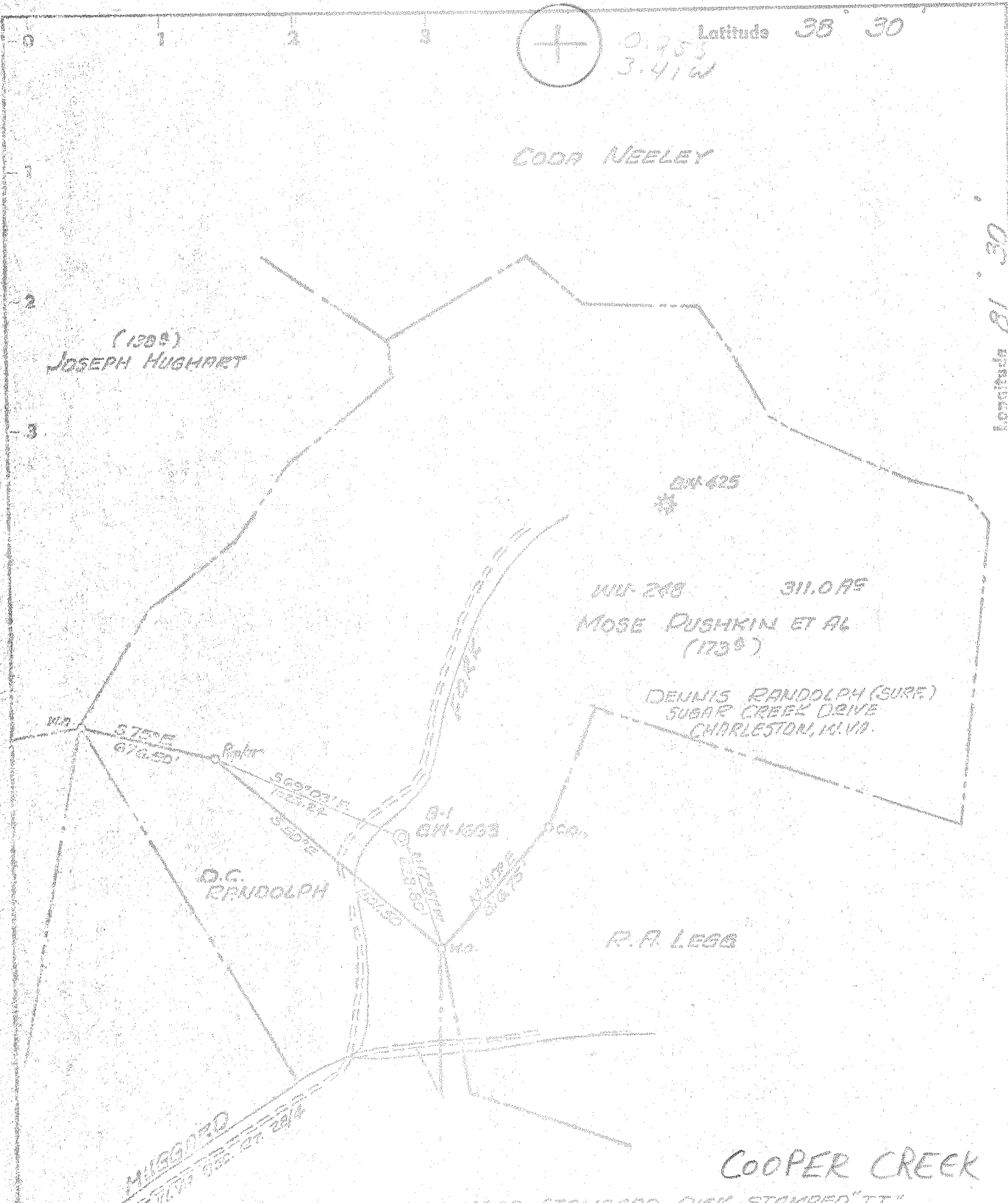

- New Location
- Drill Deeper
- Redrill
- Abandonment

BENCH MARK: USES STANDARD DISK STAMPED "TT"
 21069 1955 "705" LEGG SCHOOL
 DEGREE OF ACCURACY (ONE PART IN 200)

"I, the undersigned, hereby certify that this map is correct to the best of my knowledge and belief and shows all the information required by paragraph 8 of the rules and regulations of the oil and gas section of the mining laws of West Virginia."

Company CITIES SERVICE OIL COMPANY
 Address Box 873 Charleston W. Va.
 Name MOSE PUSHKIN ET AL (CONSOLE)
 Title Acres 173 Lease No. 1411 249
 Well (Form) No. B-1 Serial No. 34/1933
 Elevation (Spirit Level) 688.13
 Quadrangle CHARLESTON NE
 County KANAWHA District East POCA
 Engineer's Registration No. 2119
 File No. 41-2-70 Drawing No. 41-2-70
 Date 3 FEB 70 Scale 1"=660'

STATE OF WEST VIRGINIA
 DEPARTMENT OF MINES
 OIL AND GAS DIVISION
 CHARLESTON

WELL LOCATION MAP
 FILE NO. KAN-2458

+ Denotes location of well on United States Topographic Maps, scale 1 to 62,500, latitude and longitude lines being represented by border lines as shown.

- Denotes one inch spaces on border line of original tracing.



STATE OF WEST VIRGINIA
DEPARTMENT OF MINES 2
OIL AND GAS WELLS DIVISION

Rotary
Spudder
Cable Tools
Storage

adrangle Charleston
mit No. KAN-2458

WELL RECORD

Oil or Gas Well Gas
(KIND)

Company Cities Service Oil Company
Address Box 873, Charleston, W. Va. 25323
Owner Mose Pushkin, et al Acres 311.0
Location (waters) Huggard Fork
Well No. "B" #1, GW-1663 Elev. 888.13
District Poca County Kanawha
The surface of tract is owned in fee by Dennis Randolph
Gar Creek Dr. Address Chas. W. Va.
General rights are owned by Kanawha Bank & Trust & Rose Pushkin, Trustees
under M. Pushkin Tr. Address Charleston, W. Va.
Drilling commenced 6-8-70
Drilling completed 6-20-70
Shot not shot From To

Casing and Tubing	Used in Drilling depth set	Left in Well	Packers
Size			Kind of Packer
16			none
13 3/8" 48#	75'	75'	Size of
10			Depth set
8 1/4" 24#	1936'	1936'	
6 3/4" 17#	5744'	5744'	
4 1/2"			Perf. top
3			Perf. bottom
2 3/8" 4.7#	5822'	5822'	Perf. top
Liners Used			Perf. bottom

Open Flow /10ths Water in Inch
 /10ths Merc. in Inch
Volume Cu. Ft.
Back Pressure lbs hrs.
 bbls., 1st 24 hrs.
WELL ACIDIZED (DETAILS) not acidized
WELL FRACTURED (DETAILS)

Attach copy of cementing record.
CASING CEMENTED SIZE No. Ft. Date
Amount of cement used (bags)
Name of Service Co. see reverse side
COAL WAS ENCOUNTERED AT 500 FEET 48 INCHES
 FEET INCHES FEET INCHES
 FEET INCHES FEET INCHES

RESULT AFTER TREATMENT (Initial open Flow or bbls.) 15,000 MCF/D Newburg (4 point test) 15,000.000
ROCK PRESSURE AFTER TREATMENT 72 HOURS 1978# D. W.
Fresh Water Feet Salt Water Feet
Producing Sand Newburg Sand Depth 5802-22- per electric logs

Formation	Color	Hard or Soft	Top	Bottom	Oil, Gas or Water	Depth	Remarks
Lime and Sandy Lime			0	70			
Hard Rock			70	130			
Sand			130	190			
Sandy Lime			190	500			
Sand			500	504			
Sandy Lime			504	565			
Sand w/ stringers			565	982			
Sand			982	1470			
Sand			1470	1484			
Sandy Lime			1484	1538			
Sand			1538	1746			
Sand			1746	1788			
Sand			1788	1830			
Sand			1830	4890			
Onondaga Lime			4890	5000			
Riskany Sand			5000	5010			
Sand			5010	5807			
Newburg Sand			5807	5815			
Sand and Shale	<u>McKenzie</u>		5815	5845			
Total depth				5845' Drillers' Meas. = 5839' Birdwell's Meas			
Electric Logs show							
Onondaga			4890'				
Riskany			5002'				
Newburg Sand			5802'	5822'			

RECEIVED
SEP 4 1970

Formation	Color	Hard or Soft	Top ²	Bottom	Oil, Gas or Water	Depth Found	Remarks
CASING RECORD							
6-8-70							Set and cemented 13-3/8" 48# B-grade H-40 casing at 75' with 100 sacks of regular cement. Cement circulated to surface.
6-12-70							Drilled 10-5/8" hole to 1936'. Set and cemented 8-5/8" 24# H-40 new casing at 1,936' with 150 sacks Lite Poz 3 and 100 sacks of regular cement with 2% ca. cl. Cement circulated to surface. Pumped 50 bbls. gel with loss circulation material ahead of cement. Float at 1,903'. Centralizers at 1809' and 1711'.
6-17-70							Set and cemented 5-1/2" 17# K-55 new and B-grade casing (1422' of new casing on bottom) at 5,744' and 125 sacks of Lite Poz 3 and 35 sacks of Latex. Pumped 250 bbls. of gel with loss circulation material ahead of cement. Gel circulated to surface. Float at 5,715'. Centralizers at 5,715', 5,627', 5,539', 5,455' and 5,361'. Basket at 4,830'
6-16-70							Ran Birdwell Gamma Ray inside D. P. Top of Onondaga by Gamma Ray 4,890'- Top of Oriskany 5,002'
6-20-70							Ran Birdwell Gamma Ray, Density and Proximity Logs. Loggers' TD 5,839'. Newburg Sand 5,802' to 5,822' with 5' of 8 to 15% porosity.
7-1-70							Fraced Newburg Sand with 500 gallons mud acid and followed with 18,000# of 20-40 sand in 21,000 gallons gelled water. Maximum treating pressure 5,500#. Average treating pressure 4,500#. AIR 16 B/M.
7-13-70							4 point test - bottom hole absolute open flow 15,000 MCFD. 72 hours SIP 1,978# deadweight.

Date September 3, 1970

APPROVED Citron Service Oil Company (Owner)

By L. D. Todd, Region Prod. Manager
(Title)

STATE OF WEST VIRGINIA
DEPARTMENT OF MINES

OIL AND GAS WELLS DIVISION

RE-PLUGGING
AFFIDAVIT OF PLUGGING AND FILLING WELL

RECEIVED
SEP 3 - 1981
OIL AND GAS DIVISION
WV DEPARTMENT OF MINES

AFFIDAVIT SHOULD BE MADE IN TRIPLICATE, ONE COPY MAILED TO THE DEPARTMENT, ONE COPY TO BE RETURNED BY THE WELL OPERATOR AND THE THIRD COPY (AND EXTRA COPIES IF REQUIRED) SHOULD BE MAILED TO EACH COAL OPERATOR AT THEIR RESPECTIVE ADDRESSES.

LESSORS:

- 1 - Kanawha Banking & Trust Co. & Rose Pushkin Trustees: ~~XXXXXXXXXXXXXXXXXXXX~~ Mose Pushkin Trust, Trust Dept., Kanawha Banking & Trust Co., ~~XXXXXXXX~~ Charleston, WV 25177
- 2 - Dessie E. Wolfe, Single; 113 Va. Hgts., St. Albans ~~XXXXXXXXXXXXXXXXXXXX~~ WV 25177
- 3 - Clarence H. Bostic, widower; Box 609, Sissonville, WV ~~XXXXXXXX~~ 25185
- 4 - Juanita Curry & Earl N. Curry; Box 608, Sissonville ~~XXXXXXXXXXXXXXXXXXXX~~ WV 25185
- 5 - Chester Hughart & Alma D. Hughart, 802 Marianna St., ~~XXXXXX~~ Charleston, WV (see additional lessors on attached sheet)

Cities Service Company
NAME OF WELL OPERATOR
P.O. Box 873, Charleston, WV 25323
COMPLETE ADDRESS
September 2 19 81
WELL AND LOCATION
Poca District
Kanawha County
Well No. "B" #1, GW-1663
Mose Pushkin, et al Farm

STATE INSPECTOR SUPERVISING PLUGGING: Martin Nichols

AFFIDAVIT

STATE OF WEST VIRGINIA,
County of Kanawha } ss:

Roy Pulliam, Jr. and Morris G. Belcher
being first duly sworn according to law depose and say that they are experienced in the work of plugging and filling oil and gas wells and were employed by Cities Service Company well operator and participated in the work of plugging and filling the above well, that said work was commenced on the 26th day of August, 19 81, and that the well was plugged and filled in the following manner:

BAND OR ZONE RECORD FORMATION	FILLING MATERIAL	PLUGS USED SIZE & KIND	CASING	
			CSG PULLED	CSG LEFT IN
1990'	8-5/8" casing surface to 1914'. Drilled plugs to 2065'. Set Baker cast iron bridge plug w/2 sx. CalSeal on top.			
1964' - 1794'	60 sx. Thixotropic cement, gelled hole w/6% gel.			
800' - 554'	60 sx. Thixotropic cement			
554'	Baker cast iron bridge plug w/2 sx. CalSeal on top. Gelled hole to surface. Welded vented cap onto 8-5/8" casing.			
COAL STRATA		DESCRIPTION OF MONUMENT		
(NAME)	monument inscribed with:	Pushkin B-1, GW-1663		
(NAME)		Replugged 8-12-81		
(NAME)		47-039-2458-P		
(NAME)		CSOC		

and that the work of plugging and filling said well was completed on the 31st day of August, 19 81.

And further deponents saith not.

Roy Pulliam, Jr.
Morris G. Belcher

Sworn to and subscribed before me this 2nd day of September, 19 81.

Charles D. Stansbury
Commissioner Notary Public

My commission expires: 4-7-89

THIS IS AN ESTIMATE ONLY
ACTUAL INFORMATION WILL BE SUBMITTED ON OG-10 UPON COMPLETION

PROPOSED WORK ORDER TO RE- DRILL _____ DEEPEN _____ FRACTURE-STIMULATE _____
 DRILLING CONTRACTOR: (If Known) _____ RESPONSIBLE AGENT: _____
 NAME _____ NAME Paul D. Phillips
 ADDRESS _____ ADDRESS Box 873, Charleston, WV 25323
 TELEPHONE _____ TELEPHONE 304-344-8383
 ESTIMATED DEPTH OF COMPLETED WELL: 2050 ROTARY X CABLE TOOLS _____
 PROPOSED GEOLOGICAL FORMATION: _____
 TYPE OF WELL: OIL _____ GAS X COMB. _____ STORAGE _____ DISPOSAL _____
 RECYCLING _____ WATER FLOOD _____ OTHER _____

TENTATIVE CASING PROGRAM:

CASING AND TUBING SIZE	USED FOR DRILLING	LEFT IN WELL	CEMENT FILL UP OR SACKS - CUBIC FT.
20 - 16			
13 - 22 3/8" 48#	75'	75'	
9 - 5/8			
8 - 5/8 24#	1936'	1936'	250 sx
7			
5 1/2 17#	5744'	1604'	160 sx
4 1/2			
3			Perf. Top
2			Perf. Bottom
Liners			Perf. Top
			Perf. Bottom

APPROXIMATE FRESH WATER DEPTHS _____ FEET _____ SALT WATER _____ FEET _____
 APPROXIMATE COAL DEPTHS 500 _____
 IS COAL BEING MINED IN THE AREA? _____ BY WHOM? _____

TO DRILL:

SUBMIT FIVE (5) COPIES OF OG - 1, \$100.00 PERMIT FEE, PERFORMANCE BOND AND PERMANENT COPY OF PLAT.

TO DRILL DEEPER OR REDRILL:

SUBMIT FIVE (5) COPIES OF OG - 1, SHOWING ORIGINAL PERMIT NUMBER AND PERFORMANCE BOND. ON WELLS DRILLED PRIOR TO 1929, A PERMANENT COPY OF THE PLAT AND THE ORIGINAL WELL RECORD MUST ALSO BE SUBMITTED.

TO FRACTURE - STIMULATE:

OIL AND/OR GAS WELL ORIGINALLY DRILLED BEFORE JUNE 5, 1929, FIVE (5) COPIES OG - 1, PERFORMANCE BOND, PERMANENT PLAT AND ORIGINAL WELL RECORD.

OIL AND/OR GAS WELL ORIGINALLY DRILLED ON AND/OR AFTER JUNE 5, 1929, FIVE COPIES OG - 1, SHOWING ORIGINAL PERMIT NUMBER, AND PERFORMANCE BOND.

Required forms must be filed within ninety (90) days of completion for bond release. Inspector to be notified twenty-four (24) hours in advance.

The following waiver must be completed by the coal operator if the permit is to be issued within ten days of receipt thereof.

WAIVER: I the undersigned, Agent for _____ Coal Company, Owner or Operator of the coal under this lease have examined and place on our mine maps this proposed well location.

We the _____ Coal Company have no objections to said well being drilled at this location, providing operator has complied with all rules and regulations in Articles 4, 5, and 7, Chapter 22 of the West Virginia Code.

For Coal Company

Official Title