

DEGREE OF ACCURACY-ONE PART IN 200. NO COAL OPERATIONS.

Fracture	
Before 6/5/29	<input type="checkbox"/>
New Location	<input checked="" type="checkbox"/>
Drill Deeper	<input type="checkbox"/>
Redrill	<input type="checkbox"/>
Abandonment	<input checked="" type="checkbox"/>

I, the undersigned, hereby certify that this map is correct to the best of my knowledge and belief and shows all the information required by Paragraph 5 of the Rules and Regulations of the Oil and Gas Section of the Mining Laws of West Virginia.
 The accuracy of this survey is within the limits and as prescribed in Paragraph 5 by the Oil and Gas Division of the Department of Mines Regulations.

Company PATRICK PETROLEUM CORR
 Address CHARLESTON, W.VA.
 Farm COPENHAVER, ET. AL.
 Tract. _____ Acres 69 Lease No. _____
 Well (Farm) No. 1 Serial No. _____
 Elevation (Spirit Level) 828.73
 Quadrangle CHARLESTON, W.VA. NE
 County KANAWHA District ELK
 Surveyor Jarvis A. Chadeain
 Surveyor's Registration No. 259
 File No. BK.1-PG.20 Drawing No. _____
 Date DEC. 28, 1971 Scale 1"=400'

STATE OF WEST VIRGINIA
 DEPARTMENT OF MINES
 OIL AND GAS DIVISION
 CHARLESTON

WELL LOCATION MAP
 FILE NO. KAN-2559-P

+ Denotes location of well on United States Topographic Maps, scale 1 to 62,500 latitude and longitude lines being represented by border lines as shown.
 - Denotes one inch spaces on border line of original tracing.

47-039

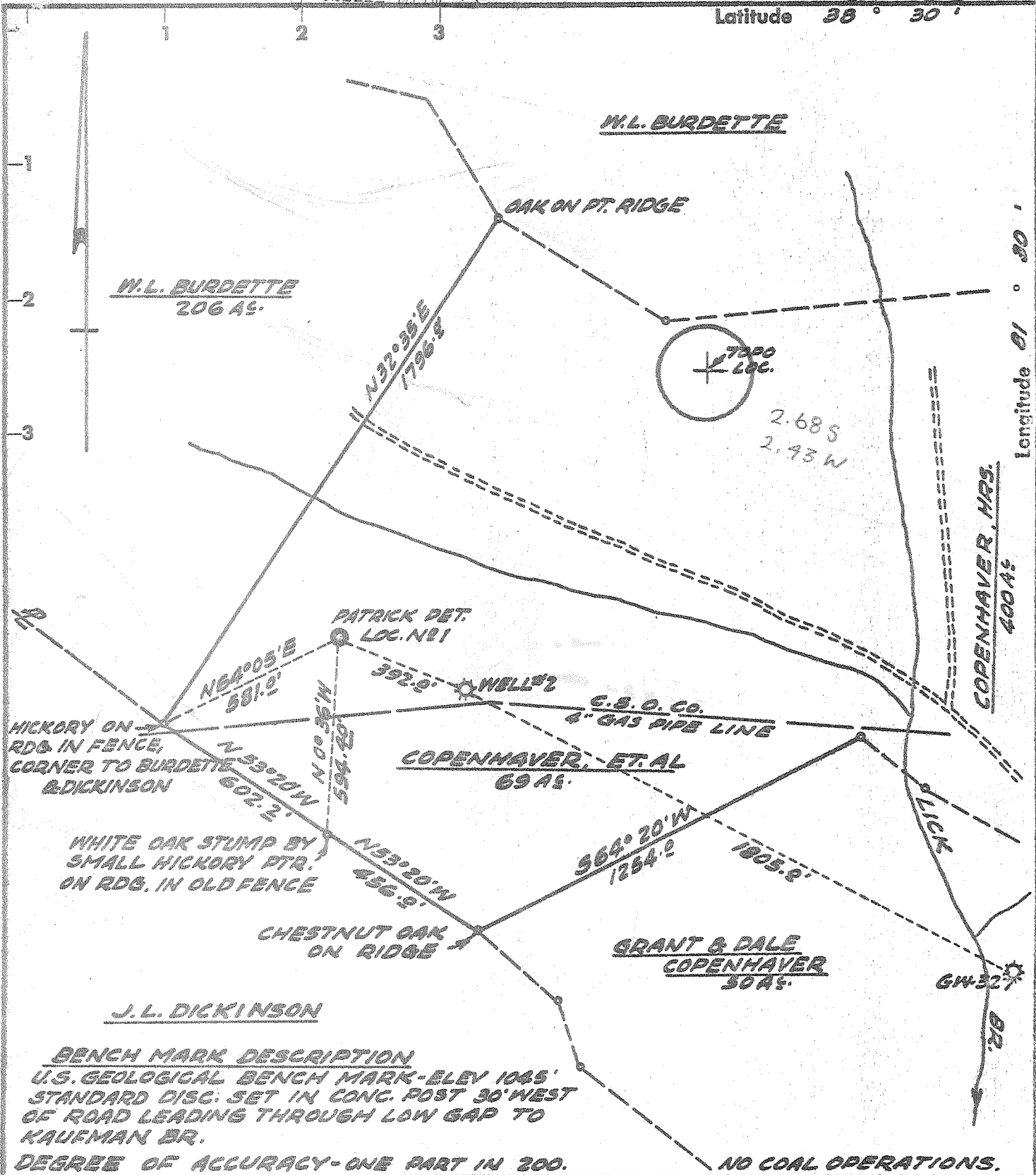

BENCH MARK DESCRIPTION
 U.S. GEOLOGICAL BENCH MARK - ELEV 1085'
 STANDARD DISC. SET IN CONC. POST 30' WEST
 OF ROAD LEADING THROUGH LOW GAP TO
 KAUFMAN BR.
 DEGREE OF ACCURACY - ONE PART IN 200.

NO COAL OPERATIONS.

- Fracture
- Before 6/5/29
- New Location
- Drill Deeper
- Redrill
- Abandonment

I, the undersigned, hereby certify that this map is correct to the best of my knowledge and belief and shows all the information required by Paragraph 5 of the Rules and Regulations of the Oil and Gas Section of the Mining Laws of West Virginia.
 The accuracy of this survey is within the limits and as prescribed in Paragraph 5 by the Oil and Gas Division of the Department of Mines Regulations.

Company PATRICK PETROLEUM CORR
 Address CHARLESTON, W.VA.
 Farm COPENHAVER, ET. AL.
 Tract _____ Acres 69 Lease No. _____
 Well (Farm) No. 1 Serial No. _____
 Elevation (Spirit Level) 035.79
 Quadrangle CHARLESTON, W.VA. NE
 County KANAWHA District ELK
 Surveyor Jarrel A Chadenine
 Surveyor's Registration No. 259
 File No. BK.1-PS.20 Drawing No. _____
 Date DEC. 29, 1971 Scale 1" = 400'

STATE OF WEST VIRGINIA
 DEPARTMENT OF MINES
 OIL AND GAS DIVISION
 CHARLESTON

WELL LOCATION MAP
 FILE NO. KAN-2559

+ Denotes location of well on United States Topographic Maps, scale 1 to 62,500 latitude and longitude lines being represented by border lines as shown.
 - Denotes one inch spaces on border line of original tracing.

G-6 Cooper Creek (331)

Deep Well (Newburg)
 JAN 18 1972



STATE OF WEST VIRGINIA
DEPARTMENT OF MINES
OIL AND GAS WELLS DIVISION

Rotary
Spudder
Cable Tools
Storage

Quadrangle CHARLESTON

WELL RECORD

Permit No. KAN-2559

Oil or Gas Well GAS
(KIND)

Company	Patrick Petroleum Corporation		Casing and Tubing	Used in Drilling	Left in Well	Packers
Address	610 Commerce Sq., Charleston, W. Va.		Size			
Farm	Copenhaver, et al	Acres. 69	16			Kind of Packer
Location (waters)	Lick Branch		13 -3/8"	60'	60'	
Well No.	One (1)	Elev. 835.79	12 9-5/8"	1808'	1808'	Size of
District	Elk	County Kanawha	14 7"	5709'	5709'	Depth set
The surface of tract is owned in fee by W. Grant Copenhaver & heirs			5 3/16"			
Mineral rights are owned by Same			4 1/2"			
Drilling commenced	12-31-71		3"			Perf. top
Drilling completed	1-23-72		2 -3/8"	5727'	5727'	Perf. bottom
Date Shot	From	To	Liners Used			Perf. top
With						Perf. bottom

Open Flow /10ths Water in Inch Attach copy of cementing record.
 Volume 3,000 MCF Cu. Ft. CASING CEMENTED SIZE No. Ft. Date
 Rock Pressure NOT TAKEN lbs. Amount of cement used (bags) See Below
 Oil bbls., 1st 24 hrs. Name of Service Co.
 WELL ACIDIZED (DETAILS) FEET INCHES FEET INCHES
 WELL FRACTURED (DETAILS) 15,000# Sand, 500 gal. acid, 1,000 bbl. water.

RESULT AFTER TREATMENT (Initial open Flow or bbls.)
 ROCK PRESSURE AFTER TREATMENT HOURS
 Fresh Water 110' Feet Salt Water Feet
 Producing Sand Newburg Depth

Formation	Color	Hard or Soft	Top	Bottom	Oil, Gas or Water	Depth	Remarks
Red Shale			0	40			
Sand			40	50			
Sandy Shale			50	100			
Shale			100	297			13-3/8" cemented w/70 sks. Com.
Sand			297	365			
Sand & Shale			365	418			
Shale			418	480			
Sand & Shale			480	492			
Sand			492	605			
Sand			605	633			
Sand & Shale			633	845			
Sand			845	980			
Sand - Hard			980	1220			
Shale			1220	1225			
Sandy Shale			1225	1249			
Sand			1249	1496			
Lime			1496	1662			
Injun			1662	1680			
Sandy Shale			1680	1710			9-5/8" cemented w/325 Sk. Lt. 100 sks. neat w/2% cc
Shale & Sandy Shale			1710	1835			
Shale			1835	1900			
Sand & Shale			1900	2200			
Lime			2200	5718			7", cemented w/150 cu. ft/or 130 sks. cement
<u>Newburg</u>			5718	5722			
Lime and Shale - <u>Mckensia</u>			5722	5745			

RECEIVED
MAY 12 1972
OIL & GAS DIVISION
DEPT. OF MINES