



west virginia department of environmental protection

Office of Oil and Gas
601 57th Street, S.E.
Charleston, WV 25304
(304) 926-0450
fax: (304) 926-0452

Earl Ray Tomblin, Governor
Randy C. Huffman, Cabinet Secretary
www.dep.wv.gov

Thursday, October 20, 2016
NOTICE OF PERMIT CANCELLATION
Vertical / Plugging - 2

C. I. MCKOWN & SON, INC.
P. O. BOX 711

NEWTON, WV 252660711

Re: Permit cancellation for 64
47-039-02689-00-00

The FINAL INSPECTION REPORT for the CANCELLED PERMIT, issued for U.S. Well Number 47-039-02689-00-00 , has been received by the Office of Oil and Gas. The permit has been cancelled as of 10/19/2016 .

If there are any questions, please feel free to contact me at (304) 926- 0450.

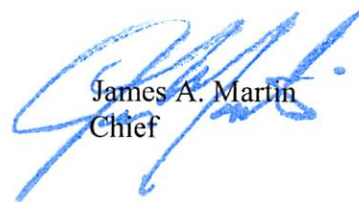

James A. Martin
Chief

Operator's Well Number: 64
Farm Name: BLUE EAGLE LAND, LLC
U.S. WELL NUMBER: 47-039-02689-00-00
Vertical / Plugging - 2
Date Cancelled: 10/19/2016

Promoting a healthy environment.

10/21/2016

WW-7
8-30-06



West Virginia Department of Environmental Protection
Office of Oil and Gas

WELL LOCATION FORM: GPS

API: 047-039-02689 WELL NO.: 64

FARM NAME: BLUE CREEK

RESPONSIBLE PARTY NAME: C.I. McKOWN & SON, INC.

COUNTY: KANAWHA DISTRICT: MALDEN

QUADRANGLE: QUICK 7.5'

SURFACE OWNER: BLUE EAGLE LAND, LLC

ROYALTY OWNER: RANGE RESOURCES - PINE MOUNTAIN INC.

UTM GPS NORTHING: 4,243,752 (NAD 83)

UTM GPS EASTING: 461,908 (NAD 83) GPS ELEVATION: 341 (1119')

The Responsible Party named above has chosen to submit GPS coordinates in lieu of preparing a new well location plat for a plugging permit or assigned API number on the above well. The Office of Oil and Gas will not accept GPS coordinates that do not meet the following requirements:

1. Datum: NAD 1983, Zone: 17 North, Coordinate Units: meters, Altitude: height above mean sea level (MSL) – meters.
2. Accuracy to Datum – 3.05 meters
3. Data Collection Method:

Survey grade GPS : Post Processed Differential

Real-Time Differential

Mapping Grade GPS : Post Processed Differential

Real-Time Differential

4. Letter size copy of the topography map showing the well location.

I the undersigned, hereby certify this data is correct to the best of my knowledge and belief and shows all the information required by law and the regulations issued and prescribed by the Office of Oil and Gas.

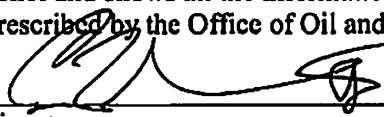
 PRESIDENT 4/11/14
 Signature Title Date

CANCELED
Plugging
39 02689A

38 25

81 25

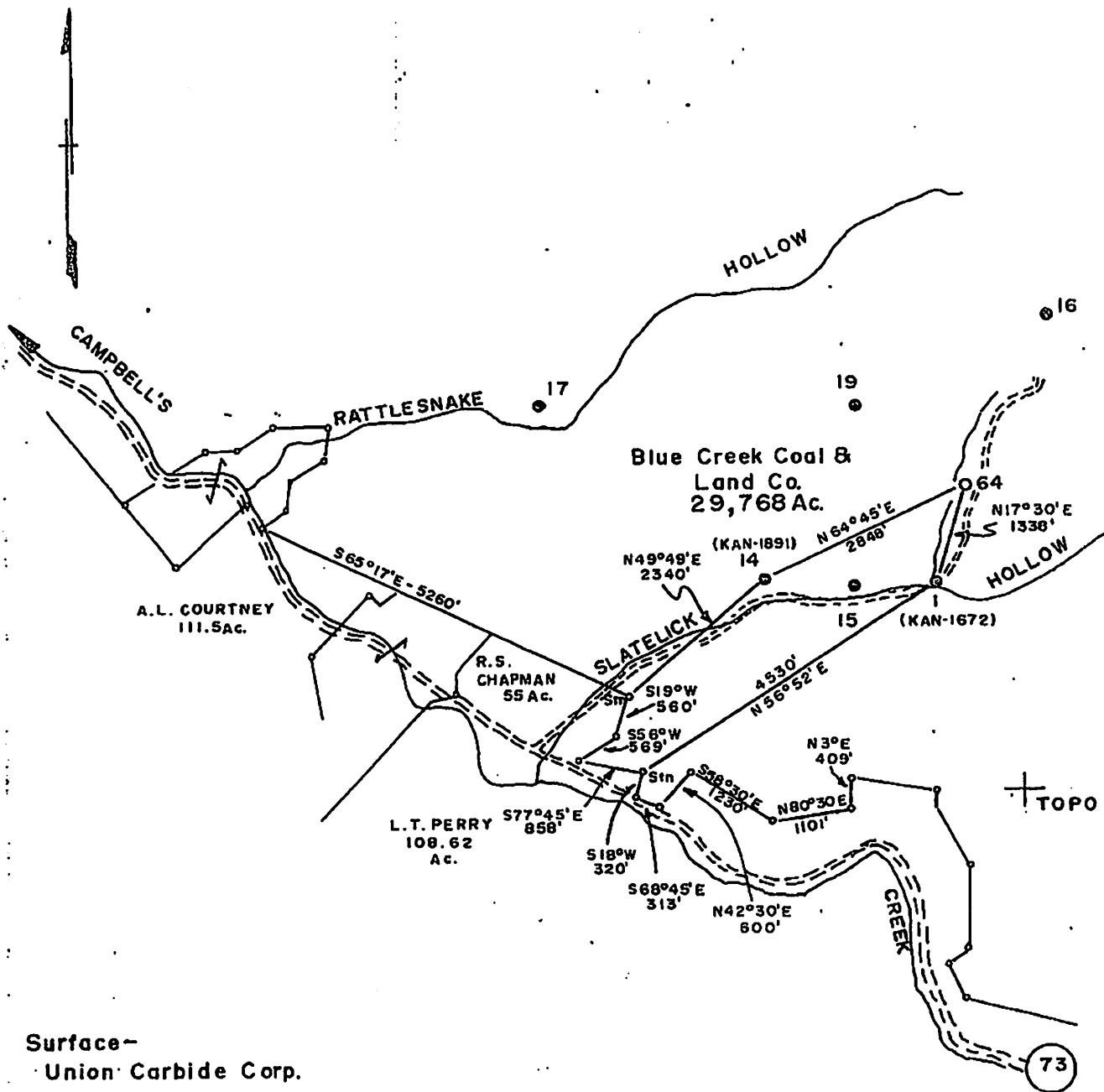

Surface -
Union Carbide Corp.

Minimum Error of Closure: 1' in 200'

Source of Elevation \pm 1, by Blue Creek Gas Co. (KAN-1672)

Elevation - 1014.41

I, the undersigned, hereby certify that this map is correct to the best of my knowledge and belief and shows all the information required by paragraphs 6, 7, 8, and 9 of the regulations of the oil and gas section of the Department of Mineral Resources.

Signed: *Charles A. Leman*

Map No. 110 Square 75 48

Fracture
New Location
Drill Deeper
Abandonment

LESSOR: PENNAR COMPANY
ADDRESSES: P.O. Box 158, Parkersburg, W. Va. 26101
BLUE CREEK COAL & LAND CO.
Area 29,768 Lease No. 57822
Well No. 64 Section No. 64
Elevation Spud Level 1118.63
Geologic CLENDENIN
County KANAWHA District MALDEN
Surveyor CURTIS A. HAYES
Surveyor's Registration No. 278
Date No. 44 Drawing No. 44
Date 12-12-74 Scale 1" = 2000'

STATE OF WEST VIRGINIA
DEPARTMENT OF MINERAL RESOURCES
OIL AND GAS DIVISION
CHARLESTON
WELL LOCATION MAP
FILE NO.
10/21/2016
RECEIVED
Office of Oil and Gas
APR 28
Denotes location of well on Topographic Map, scale 1" = 2000' and longitude lines being represented on border lines as shown.
- Denotes one inch spaces on border lines of original tracing.
WV Department of
Mental Protection