



west virginia department of environmental protection

Office of Oil and Gas
601 57th Street, S.E.
Charleston, WV 25304
(304) 926-0450
fax: (304) 926-0452

Earl Ray Tomblin, Governor
Randy C. Huffman, Cabinet Secretary
www.dep.wv.gov

Thursday, October 20, 2016
NOTICE OF PERMIT CANCELLATION
Vertical / Plugging - 2

C. I. MCKOWN & SON, INC.
P. O. BOX 711

NEWTON, WV 252660711

Re: Permit cancellation for 66
47-039-02723-00-00

The FINAL INSPECTION REPORT for the CANCELLED PERMIT, issued for U.S. Well Number 47-039-02723-00-00 , has been received by the Office of Oil and Gas. The permit has been cancelled as of 10/19/2016 .

If there are any questions, please feel free to contact me at (304) 926- 0450.

James A. Martin
Chief

Operator's Well Number: 66
Farm Name: BLUE CREEK COAL & LAND
U.S. WELL NUMBER: 47-039-02723-00-00
Vertical / Plugging - 2
Date Cancelled: 10/19/2016

Promoting a healthy environment.

10/21/2016

Plugging Cancelled
390 2723A

WW-7
8-30-06



West Virginia Department of Environmental Protection
Office of Oil and Gas
WELL LOCATION FORM: GPS

API: 047-039-02723 WELL NO.: 66

FARM NAME: BLUE CREEK

RESPONSIBLE PARTY NAME: C.I. McKOWN & SON, INC.

COUNTY: KANAWHA DISTRICT: MALDEN

QUADRANGLE: QUICK 7.5'

SURFACE OWNER: BLUE EAGLE LAND, LLC

ROYALTY OWNER: RANGE RESOURCES - PINE MOUNTAIN INC.

UTM GPS NORTHING: 4,242,916 (NAD 83)

UTM GPS EASTING: 461,721 (NAD 83) GPS ELEVATION: 372 (1221')

The Responsible Party named above has chosen to submit GPS coordinates in lieu of preparing a new well location plat for a plugging permit or assigned API number on the above well. The Office of Oil and Gas will not accept GPS coordinates that do not meet the following requirements:

1. Datum: NAD 1983, Zone: 17 North, Coordinate Units: meters, Altitude: height above mean sea level (MSL) – meters.
2. Accuracy to Datum – 3.05 meters
3. Data Collection Method:

Survey grade GPS : Post Processed Differential

Real-Time Differential

Mapping Grade GPS : Post Processed Differential

Real-Time Differential

4. Letter size copy of the topography map showing the well location.

I the undersigned, hereby certify this data is correct to the best of my knowledge and belief and shows all the information required by law and the regulations issued and prescribed by the Office of Oil and Gas.

Signature

PRESIDENT

Title

4/11/14

Date

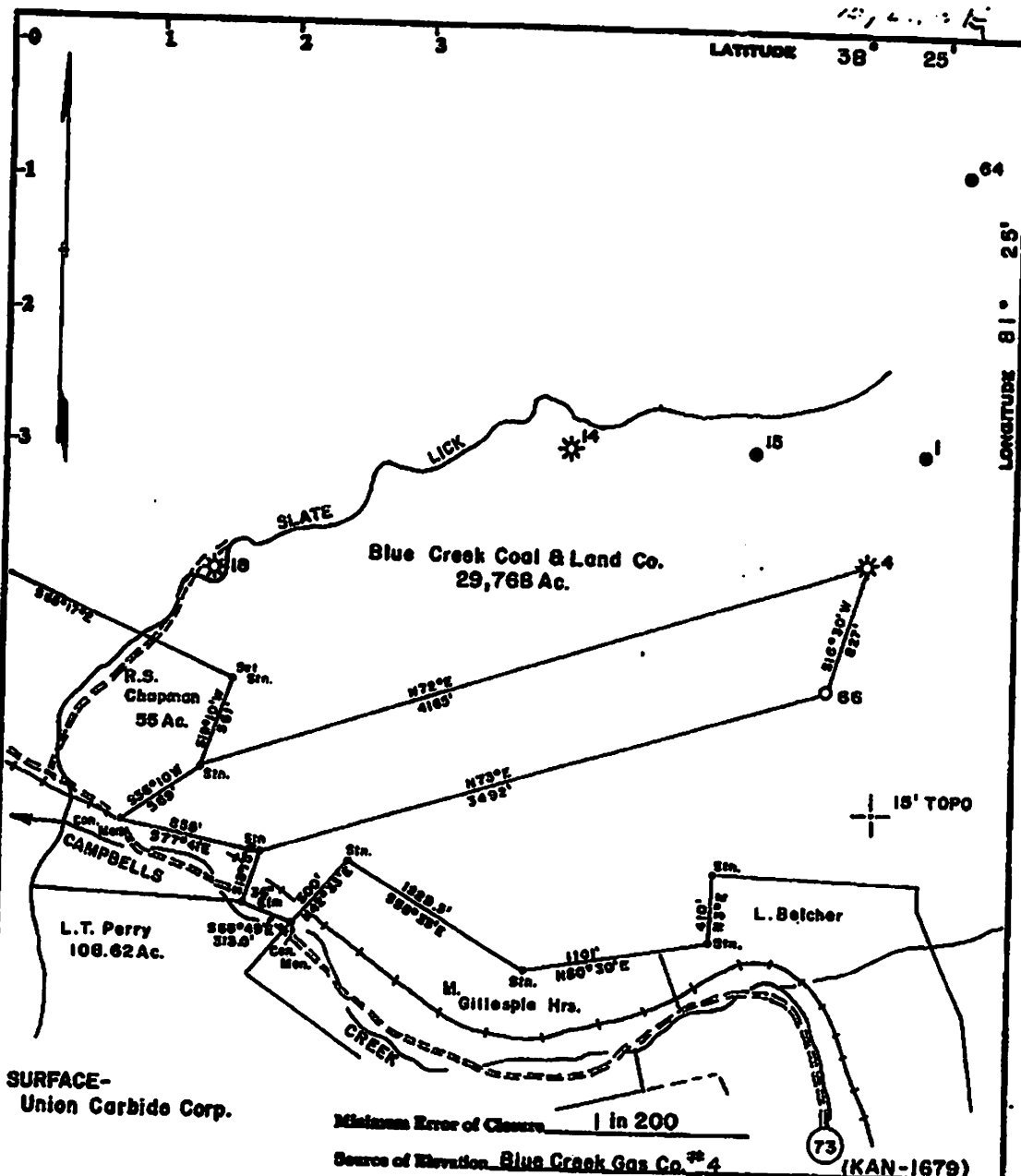

SURFACE-
Union Carbide Corp.

Minimum Error of Closure 1 in 200

Source of Elevation Blue Creek Gas Co. #4 (KAN-1679)
Elevation - 1160.42

- Fracture
- New Location
- Drill Deeper
- Abandonment

I, the undersigned, hereby certify that this map is correct to the best of my knowledge and belief and shows all the information required by paragraph 6 of the rules and regulations of the oil and gas section of the mining laws of West Virginia.

Map No. 110 Signed: *Curtis A. Lucas*
Squares: N 375 E W 48

Company	PENNZOIL COMPANY	
Address	P. O. Box 1588, Parkersburg, W. Va. 26101	
Farm	BLUE CREEK LAND & COAL CO.	
Tract	Acres 29,768	Lease No. 57822-50
Well (Farm) No.	66	Serial No.
Elevation (Spirit Level)	1221.32	
Quadrangle	GLENDEIN 15'	
County	KANAWHA	District MALDEN
Surveyor	CURTIS A. LUCAS	
Surveyor's Registration No.	275	
File No.	44	Drawing No.
Date	10-27-78	Scale 1" = 800'

STATE OF WEST VIRGINIA
DEPARTMENT OF MINES
OIL AND GAS DIVISION
CHARLESTON
CANCELED
WELL LOCATION MAP
FILE NO. KAN-2723

+ Denotes location of well on United States Topographic Maps, scale 1 to 62,500, latitude and longitude lines being represented by border lines as shown.

- Denotes one inch space on border line of original tracing. 47-039

BRUNING 44-1 27198