

1110. 5-2-83

5350' W

LATITUDE 36°30'00" (7.5)
36°30'00" (15)

LONGITUDE 81°25'00" (15)
81°25'00" (7.5)

- ④ N65°56'E-724'
- ② N60°30'E-586'
- ② N30°01'W-914'
- ② 365°57'E-433'
- ② 518°22'E-607'
- ② 519°10'W-491'
- ② 524°50'E-588'
- ② N74°35'E-617'
- ① 599°34'W-656'
- ② N22°27'W-651'
- ② N21°43'E-304'
- ② N31°35'W-828'
- ② N78°44'W-431'
- ② 531°56'E-694'
- ② 563°07'W-698'
- ② 575°33'W-683'
- ② N71°18'30'W-538'
- ② N45°59'E-125'
- ② 584°56'W-111'
- ⑦ 538°47'W-889'
- ② N17°30'W-578'
- ② N25°03'W-689'
- ② N28°58'E-1091'
- ② N87°02'E-937'

1962 MAGNETIC NORTH

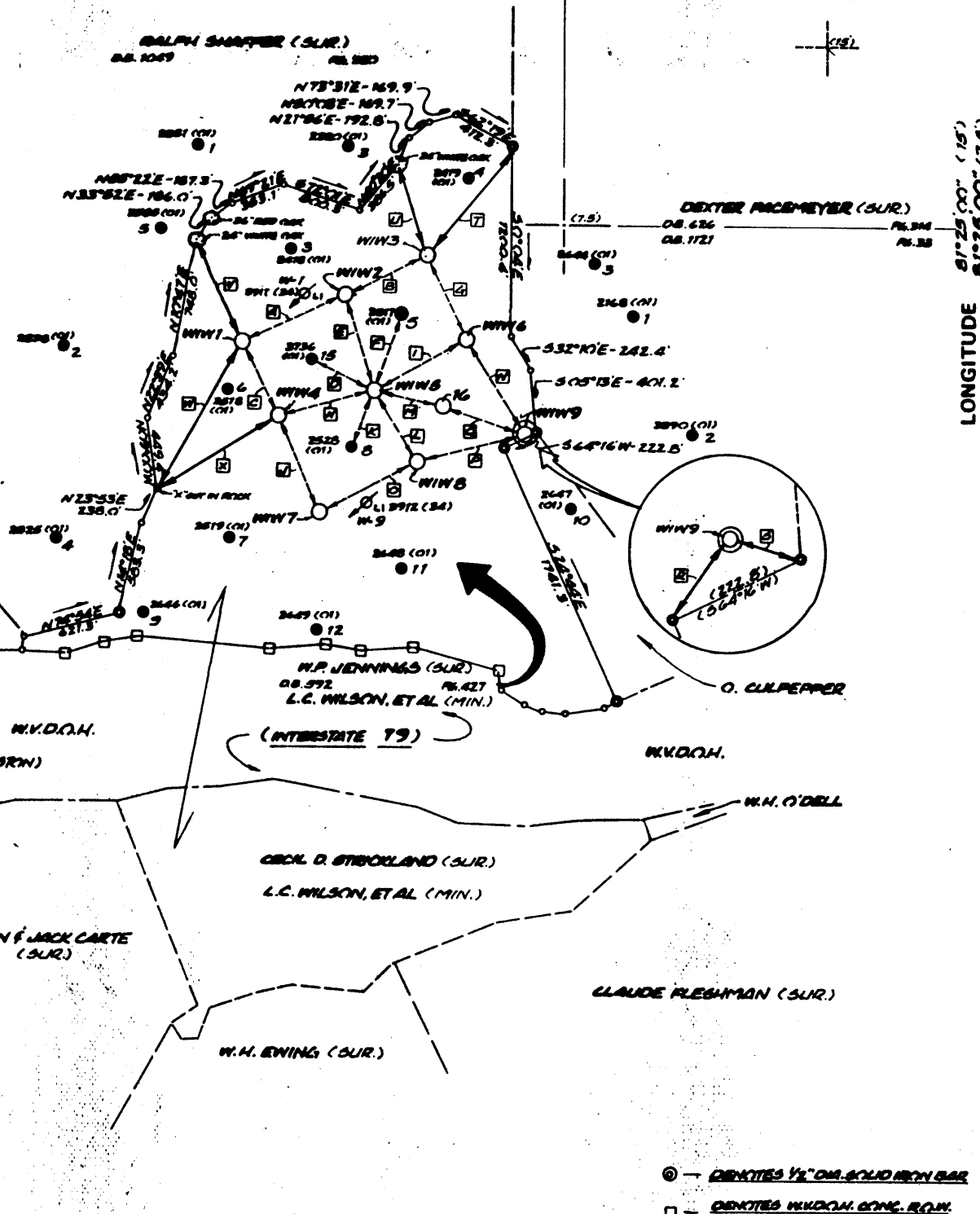

⊙ - DENOTES 1/2" DIA. SOLID IRON BAR
□ - DENOTES WOODEN CONC. ROD. MONUMENT PLAND

FILE NO. 8331-9
DRAWING NO. _____
SCALE 1" = 1000'
MINIMUM DEGREE OF ACCURACY 1" IN 1500'
PROVEN SOURCE OF ELEVATION EXIST. WELL - L.C. WILSON'S
ELEV.: 927'

I THE UNDERSIGNED, HEREBY CERTIFY THAT THIS PLAT IS CORRECT TO THE BEST OF MY KNOWLEDGE AND BELIEF AND SHOWS ALL THE INFORMATION REQUIRED BY LAW AND THE REGULATIONS ISSUED AND PRESCRIBED BY THE DEPARTMENT OF MINES.
(SIGNED) Bruce Hager
R.P.E. _____ L.L.S. 577

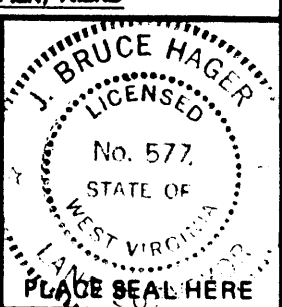

STATE OF WEST VIRGINIA
DEPARTMENT OF MINES
OIL AND GAS DIVISION



DATE APRIL 11 1983
OPERATOR'S WELL NO. WIW9
API WELL NO. _____
47 - 039 - 3960-LI-D
STATE COUNTY PERMIT

(+) DENOTES LOCATION OF WELL ON UNITED STATES TOPOGRAPHIC MAPS
WELL TYPE: OIL ___ GAS ___ LIQUID INJECTION ___ WASTE DISPOSAL ___
(IF "GAS,") PRODUCTION ___ STORAGE ___ DEEP ___ SHALLOW ___
LOCATION: ELEVATION 1175' WATER SHED WILLS CREEK OF LITTLE SANDY CREEK
DISTRICT ELK COUNTY KANAWHA
QUADRANGLE BLUE CREEK T.5; CLENDENIN T.5
SURFACE OWNER W.P. JENNINGS ACREAGE 139.91
OIL & GAS ROYALTY OWNER L.C. WILSON, ET AL LEASE ACREAGE 279
LEASE NO. W-1099
PROPOSED WORK: DRILL ___ CONVERT ___ DRILL DEEPER ___ REDRILL ___ FRACTURE OR STIMULATE ___ PLUG OFF OLD FORMATION ___ PERFORATE NEW FORMATION ___ OTHER PHYSICAL CHANGE IN WELL (SPECIFY) _____

PLUG AND ABANDON ___ CLEAN OUT AND REPLUG ___
TARGET FORMATION BIG INDIAN ESTIMATED DEPTH 2350'
WELL OPERATOR QUAKER STATE OIL REC CORP. DESIGNATED AGENT CARL J. CARLSON
ADDRESS PO. BOX 1327 ADDRESS PO. BOX 1327

KAN. 3960 LI

5-2-83

Plot Card 08D

5350' W

LATITUDE 36°30'00" (7.5)
36°30'00" (15)

LONGITUDE 81°25'00" (15)
81°25'00" (7.5)

- ☐ N63°46'E-784'
- ☐ N60°30'E-586'
- ☐ N30°01'N-514'
- ☐ 365°57'E-433'
- ☐ 318°22'E-607'
- ☐ 319°07'W-491'
- ☐ 324°50'E-588'
- ☐ N74°35'E-617'
- ☐ 359°34'W-656'
- ☐ N22°27'W-651'
- ☐ N21°43'E-384'
- ☐ N31°35'W-528'
- ☐ N78°44'W-431'
- ☐ 331°56'E-694'
- ☐ 363°07'W-698'
- ☐ 373°33'W-683'
- ☐ N71°18'30'W-538'
- ☐ N45°39'E-125'
- ☐ 384°56'W-111'
- ☐ 338°47'W-889'
- ☐ N17°30'W-578'
- ☐ N25°03'W-689'
- ☐ N28°38'E-1091'
- ☐ N37°02'E-937'

1982 MAGNETIC NORTH

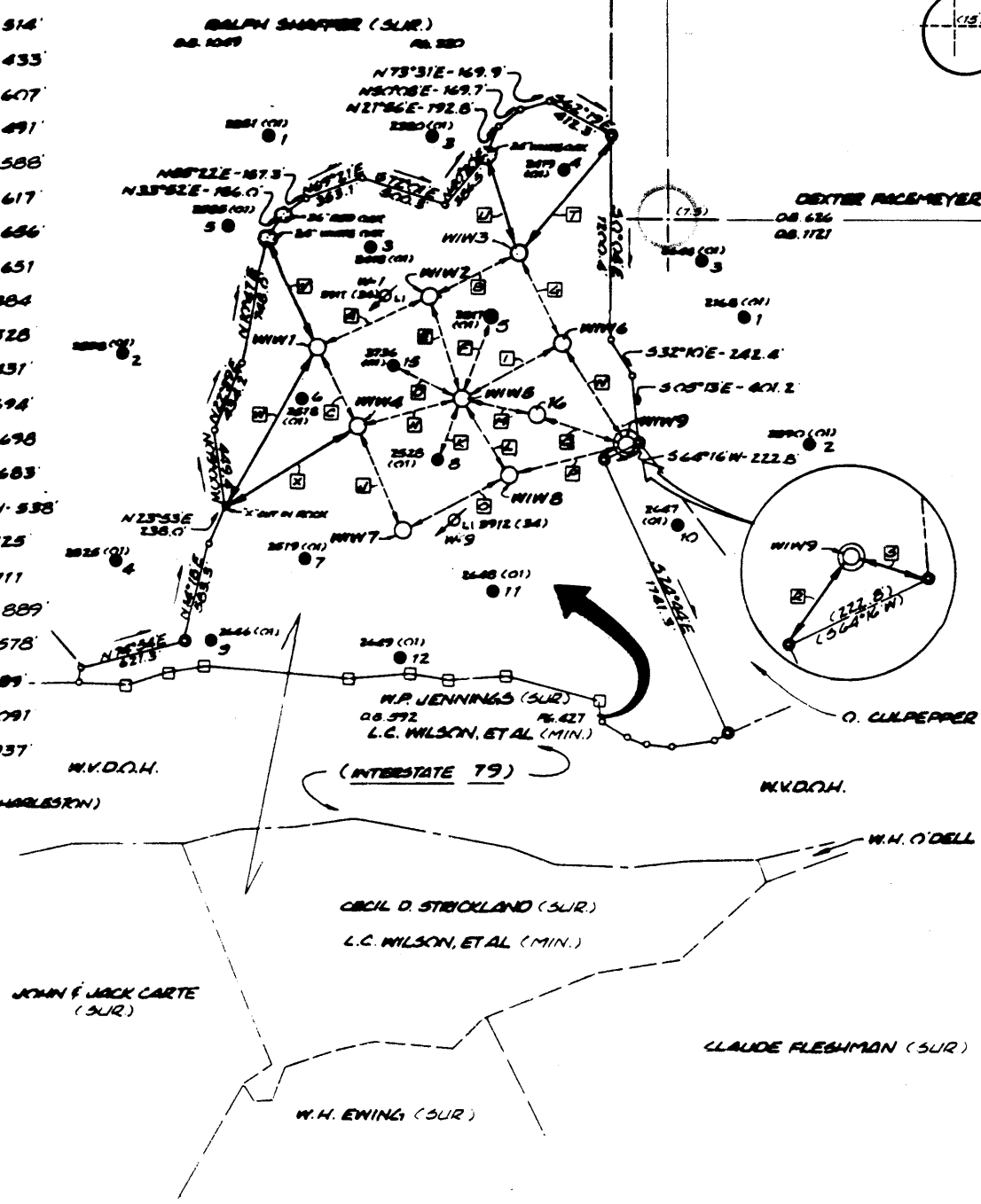

⊙ - DENOTES 1/2" DIA. SOLID IRON BAR
☐ - DENOTES W.V.D.O.H. CONC. B.O.W. PERMIT FOUND

FILE NO. 8331-9
DRAWING NO. _____
SCALE 1" = 1000'
MINIMUM DEGREE OF ACCURACY 1" IN 1000'
PROVEN SOURCE OF ELEVATION EXIST. WELL - L.C. WILSON (15)
ELEV.: 927'

I THE UNDERSIGNED, HEREBY CERTIFY THAT THIS PLAT IS CORRECT TO THE BEST OF MY KNOWLEDGE AND BELIEF AND SHOWS ALL THE INFORMATION REQUIRED BY LAW AND THE REGULATIONS ISSUED AND PRESCRIBED BY THE DEPARTMENT OF MINES.
(SIGNED) Bruce Hager
R.P.E. _____ L.L.S. 577

PLACE SEAL HERE

STATE OF WEST VIRGINIA
DEPARTMENT OF MINES
OIL AND GAS DIVISION



DATE APRIL 11, 19 83
OPERATOR'S WELL NO. W1W9
API WELL NO. 47-039-3960-LI
STATE COUNTY PERMIT

(+) DENOTES LOCATION OF WELL ON UNITED STATES TOPOGRAPHIC MAPS
WELL TYPE: OIL ___ GAS ___ LIQUID INJECTION ___ WASTE DISPOSAL ___
(IF "GAS,") PRODUCTION ___ STORAGE ___ DEEP ___ SHALLOW ___
LOCATION: ELEVATION 1175' WATER SHED WILLS CREEK OF LITTLE SANDY CREEK
DISTRICT ELK COUNTY KANAWHA
QUADRANGLE BLUE CREEK 7.5; GLENDENIN 15' NW
SURFACE OWNER W.P. JENNINGS ACREAGE 139.91
OIL & GAS ROYALTY OWNER L.C. WILSON, ET AL LEASE ACREAGE 279
LEASE NO. W-1099
PROPOSED WORK: DRILL CONVERT ___ DRILL DEEPER ___ REDRILL ___ FRACTURE OR STIMULATE ___ PLUG OFF OLD FORMATION ___ PERFORATE NEW FORMATION ___ OTHER PHYSICAL CHANGE IN WELL (SPECIFY) _____

MAY 09 1983

PLUG AND ABANDON ___ CLEAN OUT AND REPLUG ___
TARGET FORMATION BIG INJUN ESTIMATED DEPTH 2350' 8-0 Blue Creek (217)
WELL OPERATOR QUAKER STATE OIL REC CORP DESIGNATED AGENT CARL J. CARLSON

KAN. 3960 LI

IV-35
(Rev 8-81)

OIL & GAS DIVISION
DEPT. OF MINES



State of West Virginia
Department of Mines
Oil and Gas Division

Date September 30, 1983
Operator's
Well No. WIW #9
Farm L.C. WILSON
API No. 47 - 039 - 3960

WELL OPERATOR'S REPORT
OF
DRILLING, FRACTURING AND/OR STIMULATING, OR PHYSICAL CHANGE

WELL TYPE: Oil ___ / Gas ___ / Liquid Injection XX / Waste Disposal ___ /
(If "Gas," Production ___ / Underground Storage ___ / Deep ___ / Shallow ___ /)

LOCATION: Elevation: 1175 Watershed Wills Creek of Little Sandy Creek
District: Elk County Kanawha Quadrangle Blue Creek

COMPANY QUAKER STATE OIL REFG. CORP.
ADDRESS P.O.Box 1327, Parkersburg, WV 26102-1327
DESIGNATED AGENT Carl J. Carlson
ADDRESS Same as above
SURFACE OWNER W.P. Jennings
ADDRESS Box 142, Sissonville, WV
MINERAL RIGHTS OWNER L.C. Wilson
ADDRESS 1618 Kanawha Blvd., Charleston, WV
OIL AND GAS INSPECTOR FOR THIS WORK Craig Davidson
Duckworth Box 107, Gassaway, WV 26624
PERMIT ISSUED 4/14/83
DRILLING COMMENCED 6/14/83
DRILLING COMPLETED 6/17/83

Casing & Tubing	Used in Drilling	Left in Well	Cement fill up Cu. ft.
Size 20-16 Cond.			
13-10"			
9 5/8			
8 5/8	650	650	cts
7			
5 1/2			
4 1/2	2310	2310	150 sx
3			
2			
Liners used			

GEOLOGICAL TARGET FORMATION Big Injun Depth 2174 - 2231 feet
Depth of completed well 2325 feet Rotary XX / Cable Tools
Water strata depth: Fresh 554 feet; Salt 1460 feet
Coal seam depths: NA Is coal being mined in the area? No

OPEN FLOW DATA

Producing formation NA Pay zone depth _____ feet
Gas: Initial open flow _____ Mcf/d Oil: Initial open flow _____ Ebl/d
Final open flow _____ Mcf/d Final open flow _____ Ebl/d
Time of open flow between initial and final tests _____ hours
Static rock pressure 900 psig (surface measurement) after _____ hours shut in
(If applicable due to multiple completion--)
Second producing formation _____ Pay zone depth _____ feet
Gas: Initial open flow _____ Mcf/d Oil: Initial open flow _____ Ebl/d
Final open flow _____ Mcf/d Oil: Final open flow _____ Ebl/d
Time of open flow between initial and final tests _____ hours
Static rock pressure _____ psig (surface measurement) after _____ hours shut in

DETAILS OF PERFORATED INTERVALS, FRACTURING OR STIMULATING, PHYSICAL CHANGE, ETC.

Perforated from 2187 - 2229 w/22 shots.
 Frac'd w/106 bbl. water and 16 sx 20/40 sand,
 Fm. breakdown - 2000 psi
 ISIP - 900psi

WELL LOG

FORMATION	COLOR	HARD OR SOFT	TOP FEET	BOTTOM FEET	REMARKS
					Including indication of all fresh and salt water, coal, oil and gas
Shale & Siltstone			0	554	
Sandstone			554	561	
Shale & Sandstone			561	1460	
Salt Sand			1460	1867	
Shale			1867	1988	
Little Lime			1988	2035	
Pencil Cave			2035	2048	
Big Lime			2048	2174	
<u>Injun Sand</u>			2174	2233	
Shale			2233	2325 TD	

(Attach separate sheets as necessary)

QUAKER STATE OIL REFINING CORPORATION
 Well Operator
 Steve Opritza - Geologist
 By: Steve Opritza
 Date: 9/30/83

Note: Regulation 2.02(i) provides as follows:
 "The term 'log' or 'well log' shall mean a systematic

IV-3
(Reverse)
[02-83]

- 1) Date: April 14 1983
- 2) Operator's Well No. L.C. WILSON #WIW-9
- 3) SIC Code
- 4) API Well No. 47 - 039 - 3960
State County Permi
- 5) UIC Permit: _____

DRILLING CONTRACTOR
CLINT HURT & ASSOCIATES
P.O. Box 383, Elkview, WV 25071

STATE OF WEST VIRGINIA
LIQUID INJECTION OR WASTE DISPOSAL WELL PERMIT APPLICATION

For Both
 DEPT. OF MINES, OFFICE OF OIL AND GAS, DNR, DIVISION OF WATER RESOURCES

- 6) WELL TYPE: Liquid Injection XX / Disposal ___ / Gas Injection ___ /
- 7) LOCATION: Elevation 1175' Watershed Wills Creek of Little Sandy Creek
 District Elk County Kanawha Quadrangle Blue Creek
- 8) WELL OPERATOR QUAKER STATE OIL REFG. CORP. 12) DESIGNATED AGENT Carl J. Carlson
 Address P.O. Box 1327 Address P.O. Box 1327
Parkersburg, WV 26102-1327 Parkersburg, WV 26102-1327
- 9) ROYALTY OWNER L.C. Wilson 13) COAL OPERATOR NA
 Address 1618 Kanawha Boulevard Address _____
Charleston, WV
- Acreage 279
- 10) SURFACE OWNER W. P. Jennings, etal 14) COAL OWNER(S) WITH DECLARATION ON RECORD:
 Address Box 142, Sissonville, WV 25185 Name NA
 Address _____ Address _____
 Acreage 139.91 Name APR 15 1983
 Address _____
 OIL & GAS DIVISION
 DEPT. OF MINES
- 11) OIL AND GAS INSPECTOR TO BE NOTIFIED BEFORE DRILLING, AND 24 HOURS IN ADVANCE OF ANY MECHANICAL INTEGRITY TEST
 Name Homer Dougherty 15) COAL LESSEE WITH DECLARATION ON RECORD:
 Address Linden Rt. Box 3-A Name NA
Looneyville, WV 25259 Address _____

16) The undersigned well operator is entitled to operate for liquid injection or waste disposal purposes at the above location under a deed ___ / lease ___ / other contract XX / dated Nov. 30, 1973, to the undersigned well operator from Mareve Oil Corp.. (If said deed, lease, or other contract has been recorded:) Recorded on Dec. 3, 1973, in the office of the Clerk of the County Commission of Kanawha County, West Virginia, in Assignment Book 32 at page 66. A permit is requested as follows:

- 17) PROPOSED WORK: Convert ___ / Drill XX / Drill deeper ___ / Fracture or stimulate ___ / Plug off old formation ___ / Other physical change in well (specify) _____
- 18) Date of first liquid injection or waste disposal: July 1, 1983.

PROPOSED WORK ORDER
 THIS IS AN ESTIMATE ONLY:
 ACTUAL INFORMATION MUST BE SUBMITTED ON FORM IV-37 UPON COMPLETION

- 19) Estimated depth of completed well 2350' feet Rotary XX / Cable tools ___ /
- 20) Approximate water strata depths: Fresh, 575 feet; salt, 1514 feet.
- 21) Approximate coal seam depths: NA Is coal being mined in the area? Yes ___ / No XX /
- 22) GEOLOGICAL TARGET FORMATION Big Injun Depth 2173 feet(top) to 2229 feet(bottom)
 - a) Virgin reservoir pressure in target formation 530 psig; Source Shut-in Test (24hr)
 - b) Estimated reservoir fracture pressure 1400 psig (BIFFP)
 - c) Perforation intervals 2173 - 2229 Open-hole intervals None
- 23) MAXIMUM PROPOSED INJECTION OPERATIONS
 Volume per hour: 20 bbl. Bottom hole pressure: 2000 psig
- 24) DETAILED IDENTIFICATION OF MATERIALS TO BE INJECTED - PLUS ADDITIVES
Formation brine from Big Injun & bacteriacide, corrosion inhibitor, and scale inhibitor treated with x-cide xc-402 Spec. gravity = 0.963
- 25) SPECIFICATION FOR CATHODIC PROTECTION AND OTHER CORROSION CONTROL None
- 26) FILTERS (IF ANY) 2 Stage Filter System: 75 micron cartridge vessel on main line and 5 micron cartridge vessel at the injection well.

27) CASING AND TUBING PROGRAM

CASING OR TUBING TYPE	SPECIFICATIONS					FOOTAGE INTERVALS		CEMENT FILL-UP OR SACKS Cubic ft.	PACKERS
	Size	Grade	Weight per ft.	New	Used	For drilling	Left in well		
Conductor									Kinds
Fresh water	8 5/8	H-40	20	xx		605' 605'	605' 605'	cts	Neat
Coal									Sizes
Intermediate									
Production	4 1/2	J-55	9.5	xx		2350'	2350'	235 sx	Depths set
Tubing									
Liners									Perforations
									Top Bottom

28) Copies of this Permit Application and the enclosed plat and reclamation plan have been mailed or delivered by hand to the above named coal operator, coal owner(s), and coal lessee on or before the day of the mailing or delivery of this Permit Application to the Department of Mines at Charleston, West Virginia.

The person signing this document shall make the following certification:

"I certify under penalty of law that I have personally examined and am familiar with the information submitted in this document and all attachments and that, based on my inquiry of those individuals immediately responsible for obtaining the information, I believe that the information is true, accurate, and complete. I am aware that there are significant penalties for submitting false information, including the possibility of fine and imprisonment.

QUAKER STATE OIL REFINING CORPORATION
Well Operator

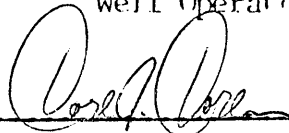
By: 
Its Carl J. Carlson
District Production Manager

W A I V E R

The undersigned coal operator _____ / owner _____ / lessee _____ / of the coal under this well location has examined this proposed well location. If a mine map exists which covers the area of the well location, the well location has been added to the mine map. The undersigned has no objection to the work proposed to be done at this location, provided, the well operator has complied with all applicable requirements of the West Virginia Code and the governing regulations.

Date: _____, 19____. By: _____
Its _____

OFFICE USE ONLY

PERMIT

Permit number 47-039-3960 Date May 4 1983

This permit covering the well operator and well location shown below is evidence of permission granted to drill in accordance with the pertinent legal requirements subject to the conditions contained herein and on the reverse hereof. Notification must be given to the District Oil and Gas Inspector prior to the construction of roads, locations and pits for any permitted work. (Refer to No. 10)

In addition, the well operator or his contractor shall notify the proper District Oil and gas Inspector 24 hours before actual permitted work has commenced.

Permit expires January 4, 1984 unless work is commenced prior to that date and prosecuted with due diligence.

Bond:	Agent:	Plat:	Casing:	Fee:
<u>Blanket</u>	<u>O.T. m.f.</u>	<u>MJ</u>	<u>MJ</u>	<u>8231</u>

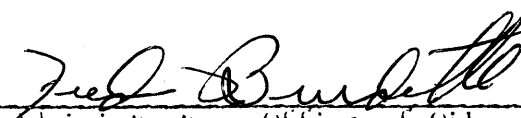
Administrator, Office of Oil and Gas

R-38
2-May-92

API # 47-39-03960-P

STATE OF WEST VIRGINIA
DIVISION OF ENVIRONMENTAL PROTECTION
SECTION OF OIL AND GAS

DEC 14 1992
Permitting
Office of Oil & Gas

AFFIDAVIT OF PLUGGING AND FILLING WELL

AFFIDAVIT SHOULD BE IN TRIPLICATE, one copy mailed to the Division, one copy to be retained by the Well Operator and the third copy (and extra copies if required) should be mailed to each coal operator at their respective addresses.

Farm name: JENNINGS, W.P. & CLARA H Operator Well No.: L.C. WILSON #9

LOCATION: Elevation: 1175.00 Quadrangle: BLUE CREEK
District: ELK County: KANAWHA
Latitude: 3650 Feet South of 38 Deg. 30 Min. 0 Sec.
Longitude 5350 Feet West of 81 Deg. 25 Min. 0 Sec.

Well Type: OIL _____ GAS _____ UIC X _____

Company: Quaker State Corporation Coal Operator _____
P.O. Box 189 or Owner - N/A
Belpre, OH 45714

Agent: Frank Rotunda Coal Operator _____
or Owner N/A

Permit Issued: 05/26/92

AFFIDAVIT

STATE OF WEST VIRGINIA,
County of Kanawha ss:

Roger Atkinson and Leroy Bush being first duly sworn according to law depose and say that they are experienced in the work of plugging and filling oil and gas wells and were employed by the above named well operator, and participated in the work of plugging and filling the above well, and Carlos Hively Oil and Gas Inspector representing the Director, say that said work was commenced on the 26th day of October, 1992, and that the well was plugged and filled in the following manner:

TYPE	FROM	TO	PIPE REMOVED	LEFT
6% Gel	2315	2230		
Class A Cmt. 17 sks	2230	2030		
6% Gel	2030	1325		
Cut 4 1/2 @ 1325			0-1325' 4 1/2	1325-2315 4 1/2
Class A Cmt. 47 sks	1325	1175		
6% Gel	1175	700		
Class A Cmt. 31 sks	700	600		650' 8 5/8
6% Gel	600	100		
Class A Cmt. 35 sks	100	0		

Description of monument: 5 1/2 Casing 47-39-03960-P P&A 10/26/92
and that the work of plugging and filling said well was completed on the 26th day of October, 1992.

And further deponents saith not.

Sworn and subscribe before me this 8th day of December, 1992
My commission expires: 3-14-92

Roger Atkinson
Leroy Bush
Dolores L Branch
Notary Public

Dolores L. Branch
Notary Public, State of Ohio
My Commission Expires March 14, 1992

Oil and Gas Inspector: *Carlos W. Hively*
12-3-92