



1) Date: June 1, 1983
 2) Operator's Well No. JAMES COURTNEY ETAL #1
 3) API Well No. 47 - 039 3969
 State County Permit

DRILLING CONTRACTOR:

Clint Hurt & Assoc.
P.O. Box 388
Elkview, WV 25071

STATE OF WEST VIRGINIA
 DEPARTMENT OF MINES, OIL AND GAS DIVISION

OIL AND GAS WELL PERMIT APPLICATION

- 4) WELL TYPE: A Oil XX / Gas _____
 B (If "Gas", Production _____ / Underground storage _____ / Deep _____ / Shallow _____)
- 5) LOCATION: Elevation: 915.5 Watershed: Sand Run of Elk River
 District: Big Sandy County: Kanawha Quadrangle: Blue Creek
- 6) WELL OPERATOR QUAKER STATE OIL REFG. CORP. 11) DESIGNATED AGENT Carl J. Carlson
 Address P.O. Box 1327 Address Same
Parkersburg, WV 26102-1327
- 7) OIL & GAS ROYALTY OWNER J.M. Courtney, etal 12) COAL OPERATOR na
 Address See attached sheet Address _____
- 8) SURFACE OWNER J.M. Osborne 13) COAL OWNER(S) WITH DECLARATION ON RECORD
 Address Wills Creek Rd. Name J.M. Courtney
Elkview, WV 25071 Address _____
 Acreage 48 Name JUN - 3 1983
 Acreage 48 Address _____
- 9) FIELD SALE (IF MADE) TO: Columbia Gas Trans, Corp. 14) COAL LESSEE WITH DECLARATION ON RECORD
 Address P.O.Box 1273, Charleston, WV Name na DEPT. OF MINES
 Address _____
- 10) OIL & GAS INSPECTOR TO BE NOTIFIED
 Name Craig Duckworth Address _____
 Address P.O.Box 454
Mt. Lookout, WV 26673
- 15) PROPOSED WORK: Drill XX / Drill deeper _____ / Redrill _____ / Fracture or stimulate _____
 Plug off old formation _____ / Perforate new formation _____
 Other physical change in well (specify) _____
- 16) GEOLOGICAL TARGET FORMATION, Big Injun
 17) Estimated depth of completed well, 2068 feet
 18) Approximate water strata depths: Fresh, 316 feet; salt, 1266 feet.
 19) Approximate coal seam depths: na Is coal being mined in the area? Yes _____ / No XX /

20) CASING AND TUBING PROGRAM

CASING OR TUBING TYPE	SPECIFICATIONS					FOOTAGE INTERVALS		CEMENT FILL-UP OR SACKS (Cubic feet)	PACKERS
	Size	Grade	Weight per ft.	New	Used	For drilling	Left in well		
Conductor									Kinds
Fresh water	<u>8 5/8"</u>	<u>H-40</u>	<u>20#</u>	<u>xx</u>		<u>346</u>	<u>346</u>	<u>cts</u>	<u>AS Req by Rule 15-05</u>
Coal									Sizes
Intermediate									
Production	<u>4 1/2 "</u>	<u>J-55</u>	<u>9.5#</u>	<u>xx</u>		<u>2068</u>	<u>2068</u>	<u>207 sx</u>	<u>Depths set OR AS REQ by Rule 15-01</u>
Tubing	<u>2"</u>	<u>J</u>	<u>4.5#</u>	<u>xx</u>		<u>1918</u>	<u>1918</u>	<u>---</u>	
Liners									Perforations:
									Top Bottom

21) EXTRACTION RIGHTS

Check and provide one of the following:
 Included is the lease or leases or other continuing contract or contracts by which I hold the right to extract oil or gas.
 The requirement of Code 22-4-1-(c) (1) through (4). (See reverse side for specifics.)

22) ROYALTY PROVISIONS

Is the right to extract, produce or market the oil or gas based upon a lease or other continuing contract or contracts providing for flat well royalty or any similar provision for compensation to the owner of the oil or gas in place which is not inherently related to the volume of oil or gas so extracted, produced or marketed? Yes No

If the answer above is No, nothing additional is needed. If the answer is Yes, you may use Affidavit Form IV-60.

23) Required Copies (See reverse side.)

24) Copies of this Permit Application and the enclosed plat and reclamation plan have been mailed by registered mail or delivered by hand to the above named coal operator, coal owner(s), and coal lessee on or before the day of the mailing or delivery of this Permit Application to the Department of Mines at Charleston, West Virginia.

Notary: Dolores L. Branch
 My Commission Expires Feb. 25, 1985

Signed: Carl J. Carlson
 Its: District Production Manager

OFFICE USE ONLY
 DRILLING PERMIT

Permit number 47-039-3969 Date June 17 1983
02/16/2024

This permit covering the well operator and well location shown below is evidence of permission granted to drill in accordance with the pertinent legal requirements subject to the conditions contained herein and on the reverse hereof. Notification must be given to the District Oil and Gas Inspector. (Refer to No. 10) Prior to the construction of roads, locations and pits for any permitted work. In addition, the well operator or his contractor shall notify the proper district oil and gas inspector 24 hours before actual permitted work has commenced.)

Permit expires February 17, 1984 unless drilling is commenced prior to that date and prosecuted with due diligence.

Bond:	Agent:	Plat:	Casing:	Fee:
	<u>8695</u>			

T. L. ...
 Administrator, Office of Oil and Gas

Line Item Explanation

- 1) Date of Application
- 2) Your well name and number
- 3) To be filled out by office of oil & gas
- 4A) "Oil" means natural crude oil or petroleum and other hydrocarbons, regardless of gravity, which are produced at the well in liquid form by ordinary production methods and which are not the result of condensation of gas after it leaves underground reservoirs: "Gas" means all natural gas and all other fluid hydrocarbons not defined as oil.
- 4B) "Shallow well" means any well drilled and completed in a formation above the top of the uppermost member of the "Onondaga Group" or a depth less than six thousand feet, whichever is shallower.
"Deep well" means any well drilled and completed in a formation at or below the top of the uppermost member of the "Onondaga Group" or at a depth less than six thousand feet, whatever is shallower.
- 5) Where well is located
- 6) Before a permit can be issued in a corporation, company partnership, or fictitious name, the name must be registered with the Secretary of State Office
- 7) Use separate sheet if necessary
- 8) Present surface owner at time application is filed.
- 9) Optional
- 11) See Reg. 7.01 relating to code §22-4-1k
- 12) "Coal Operator" means any persons, firm, partnership, partnership association or corporation that proposes to or does operate a coal mine. See Note 24
- 13 & 14) As per §22-4-20; See Note 24
- 15) Work that will be attempted—A separate Form IV-2 shall not be required for fracturing or stimulating a well where fracturing or stimulating is to be part of the work for which a permit is sought and is noted as such on the Form IV-2 filed in connection therewith.
- 16) Anticipated formation for which well will be completed
- 17) Self explanatory
- 18) Depth to deepest freshwater, and shallowest salt water, taken from nearby wells corrected for differences in elevation
- 19) All coal seam depths
- 20) Proposed casing program and cementing refer to Code 22-4-5, 22-4-6, 22-4-7, 22-4-8, 22-4-8a Reg 9.01, 15.01, 15.02, 15.03, 15.04, 25.01, 25.02, 25.03, 25.04
- 21) Code 22-4-11(c) - In lieu of filing the lease or leases or other continuing contract or contracts, the applicant for a permit described herein may file the following:
 - (1) A brief description of the tract of land including the district and county wherein the tract is located;
 - (2) The identification of all parties to all leases or other continuing contractual agreements by which the right to extract, produce or market the oil or gas is claimed;
 - (3) The book and page number wherein each such lease or contract by which the right to extract, produce or market the oil or gas is recorded;
 - (4) A brief description of the royalty provisions of each such lease or contract.
- 22) Code 22-4-11(d) and 22-4-11(e).
- 23) Regulation 7.02 of the Department of Mines provides that the original and four copies of Form IV-2 must be filed with the Department, accompanied by (i) a plat in the form prescribed by Regulation 11, (ii) a bond in one of the forms prescribed by Regulation 12, or in lieu thereof the other security allowed by Code §22-4-2, (iii) Form IV-9, "Reclamation Plan", applicable to the reclamation required by Code §22-4-12b and Regulation 23, (iv) unless previously paid on the same well, the fee required by Code §22-4-12a, and (v) if applicable, the consent required by Code §22-4-8a from the owner of any water well or dwelling within 200 feet of the proposed well.
- 24) **The above named coal operator, coal owner(s), and coal lessee are hereby notified that any objection they wish to make or are required to make by Code §22-4-3 must be filed with the Department of Mines within fifteen (15) days after the receipt of this Application by the Department.**

The following waiver must be completed by the coal operator and by any coal owner or coal lessee who has recorded a declaration under Code 22-4-20, if the permit is to be issued within fifteen (15) days of receipt thereof.

WAIVER

02/16/2024

The undersigned coal operator _____/ owner _____/ lessee _____/ of the coal under this well location has examined this proposed well location. If a mine map exists which covers the area of the well location, the well location has been added to the mine map. The undersigned has no objection to the work proposed to be done at this location, provided, the well operator has complied with all applicable requirements of the West Virginia Code and the governing regulations.

Date: _____, 19_____

By _____

Its _____

IV-9 REVERSE
 Revised 11-81

ATTACH OR PHOTOCOPY SECTION OF
 INVOLVED TOPOGRAPHIC MAP.
 QUADRANGLE Blue Creek

LEGEND

Well Site 













Access Road 

WELL SITE PLAN

Sketch to include well location, existing access road, roads to be constructed, length and slope of road, wellsite, drilling pits and necessary structures numbered or lettered to correspond with the first part of this plan. Include all natural drainage.

Land Use: Pasture Hayland Cropland Woodland

LEGEND

Property boundary 	North Arrow 
Road 	Diversion 
Existing fence 	Spring 
Planned fence 	Wet Spot 
Stream 	Building 
Open Ditch 	Drain pipe 
Waterway 	

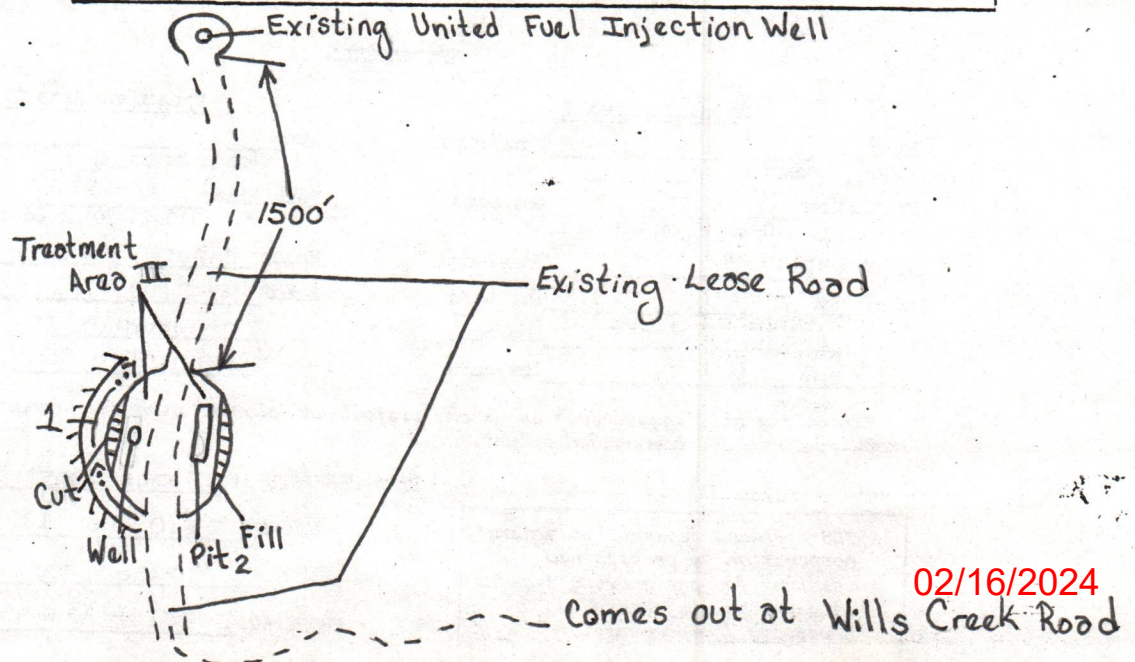
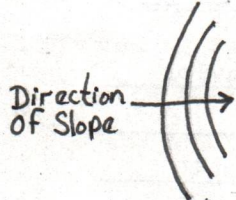
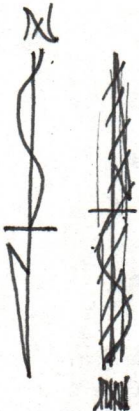

APR. 29 1983



IV-9
Revised 11-81

DATE 4-25-83

WELL NO. Courtney #1

State of West Virginia
Department of Mines
Oil and Gas Division

API NO. 47 - 039 - 8969

CONSTRUCTION AND RECLAMATION PLAN

COMPANY NAME Quaker State Oil Refining Corporation
Address P.O. Box 1327-Pksbg., WV 26101
Telephone (614) 423-9543

DESIGNATED AGENT Carl J. Carlson
Address P.O. Box 1327-Pksbg., Wv 26101
Telephone (614) 423-9543

LANDOWNER Billy Osborne

SOIL CONS. DISTRICT Capitol

Revegetation to be carried out by Petro-Services and/or Quaker State (Agent)

This plan has been reviewed by Capitol SCD. All corrections and additions become a part of this plan:

R. C. Alford
MAY 2 1983
(Date)
(SCD Agent)

RECEIVED
JUN - 3 1983

OIL & GAS DIVISION
DEPT. OF MINES

ACCESS ROAD	LOCATION
Structure <u>N/A</u> (A)	Structure <u>Diversion Ditch</u> (1)
Spacing _____	Material <u>Soil</u>
Page Ref. Manual _____	Page Ref. Manual <u>2-10 & 2-12</u>
Structure <u>N/A</u> (B)	Structure <u>Drilling Pit</u> (2)
Spacing _____	Material <u>Soil</u>
Page Ref. Manual _____	Page Ref. Manual _____
Structure <u>N/A</u> (C)	Structure <u>Topsoil to be removed</u> (3)
Spacing _____	Material <u>for later use</u>
Page Ref. Manual _____	Page Ref. Manual _____

All structures should be inspected regularly and repaired if necessary. All commercial timber is to be cut and stacked and all brush and small timber to be cut and removed from the site before dirt work begins.

REVEGETATION

Treatment Area I	Treatment Area II
Lime <u>3</u> Tons/acre or correct to pH <u>6.5</u>	Lime <u>3</u> Tons/acre or correct to pH <u>6.5</u>
Fertilizer <u>1/4 Ton</u> lbs/acre (10-20-20 or equivalent)	Fertilizer <u>1/4 Ton</u> lbs/acre (10-20-20 or equivalent)
Mulch Paper <u>3/4</u> Tons/acre	Mulch Paper <u>3/4</u> Tons/acre
Seed* <u>KY Blue 25</u> lbs/acre	Seed* <u>KY Blue 25</u> lbs/acre
<u>Crownvetch 25</u> lbs/acre	<u>Crownvetch 25</u> lbs/acre
<u>Penny Rye 25</u> lbs/acre	<u>Penny Rye 25</u> lbs/acre

*Inoculate all legumes such as vetch, trefoil and clovers with the proper bacterium. Inoculate with 3X recommended amount.

PLAN PREPARED BY James Scott Taylor

ADDRESS P.O. Box 1327

Pksbg., WV 26101

PHONE NO. (614) 423-9543

NOTES: Please request landowners' cooperation to protect new seedling for one growing season. Attach separate sheets as necessary for comments.

02/16/2024

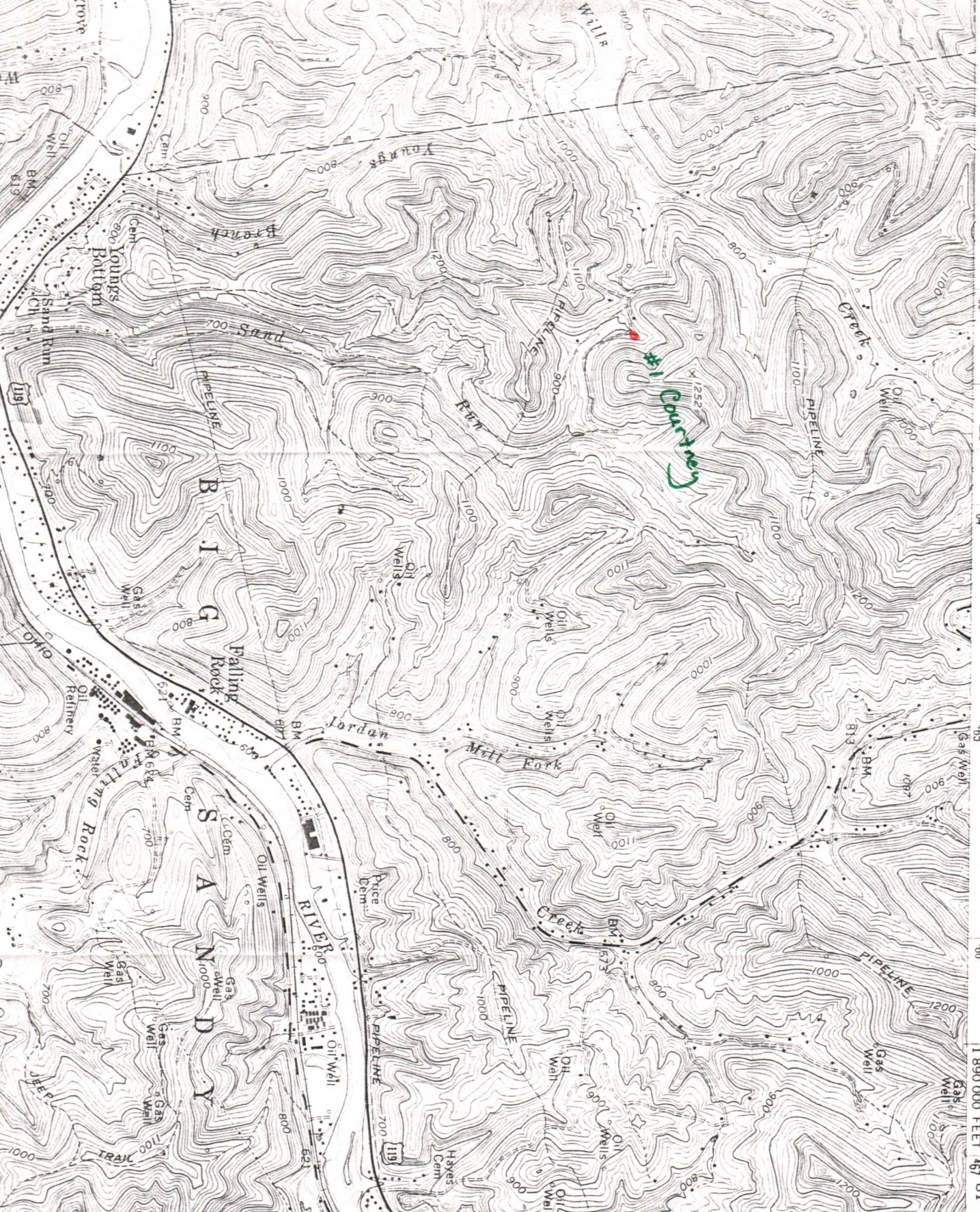

463 25 464 465 466 467 468 469 470 471 472 473 474 475 476 477 478 479 480 481 482 483 484 485 486 487 488 489 490 491 492 493 494 495 496 497 498 499 500

1 890 000 FEET 467 81 ° 22' 30" 38 ° 30'

CLENDENIN 1.7 MI. SPENCER 31 MI.

540 000 FEET

4259 4260 4261

55 (17C) 147

BLUE CREEK QUADRANGLE
WEST VIRGINIA - KANAWHA CO.
7.5 MINUTE SERIES (TOPOGRAPHIC)

11

RECEIVED

JUN -3 1983

ITEM #21 - EXTRACTION RIGHTS
CODE 22-4-11 (C)OIL & GAS DIVISION
DEPT. OF MINES

48.00 ACRES Big Sandy DISTRICT Kanawha COUNTY, WV

Bounded as follows:

on the North by M. J. Rucker; M.F. Shaffer

on the East by T. Burdette

on the South by O. T. Woods

on the West by M. F. Shaffer; C. A. Ray Heirs

Lessors & Address	Percent OGM Royalty Interest (of 1/8ths)	Recording	
		BK	PG
1. Arline Allen, et vir Apt. B-1 1806 Camellia Rd. Munster, Indiana 46321	proportionate share of 1/8 royalty	214	33
2. Maxine Raymond, et vir Box 82 Pineville, W. Va. 24874	same "	214	487
3. Dorothy Clark 1518 North Drive So. Charleston, W. Va. 25305	"	214	306
4. James D. Robertson, et ux Rt.3, Box 283 Kingston, TN 37763	"	217	274
5. Maxine Crow 2762 S. Sherwood Dr. Mobile, Ala. 36606	"	216	91
6. Wilda Hoffman 2762 S. Sherwood Dr. Mobile, Ala. 36606	"	216	91
7. James M. Courtney Falling Rock, WV 25079	"	203	87
8. Patrick R. Courtney, et ux Falling Rock, WV 25079	"	203	87
9. Marie Stephenson Apt. 208 3 Brooks St. Charleston, W. Va. 25300	"	214	39
10. Helen F. Ore, et vir Box 443 Clendenin, W.Va. 25045	"	214	39

02/16/2024

ITEM #21 - EXTRACTION RIGHTS
CODE 22-4-11 (C)

48.00 ACRES Big Sandy DISTRICT Kanawha COUNTY, WV

Bounded as follows:

on the North by M. J. Rucker; M.F. Shaffer

on the East by T. Burdette

on the South by O. T. Woods

on the West by M. F. Shaffer; C.A. Ray Heirs

Lessors & Address	Percent OGM Royalty Interest (of 1/8ths)	Recording	
		BK	PG
11. Fannie Louise Robertson 346 Elk River Rd. Clendenin, WV 25045	proportionate share of 1/8 royalty	214	39
12. Bernard Clark 1239 Dixie Highway Rossford, OH 43460	same	214	39
13. Lewis A. Clark 505 Everest Ave. St. Albans, WV 25177	"	214	39
14. Kathleen Murray 911 S. Walnut St. St. Albans, WV 25177	"	214	39
15. Mary Gross 2622 Bard St. St. Albans, WV 25177	"	214	39
16. James P. Clark, et ux 1060 Highland Dr. St. Albans, W. Va. 25177	"	214	39
17. Michael C. Lynch, et ux Rt. 2, Box 168E Beckley, WV 25801	"	214	499
18. Diana G. Phillips, et vir 111 Crystal Ave. Beckley, WV 25801	"	214	496
19. Eloise Desmond, et vir 319 Cleveland Ave. McDaniel Crest Wilmington, Delaware 19803	"	214	493
20. Genevieve Mastridge, et vir Rt. 1, Box 599 Campbell Hall, NY 10916	"	214	490

02/16/2024

DETAILS OF PERFORATED INTERVALS, FRACTURING OR STIMULATING, PHYSICAL CHANGE, ETC.

Perforated from 1894 - 1932 with 39 shots.

Frac'd with 390 bbl. water and 160 sx of 20/40 sand. Breakdown 2000 psi.
I.S.I. 1170 psi.

WELL LOG

FORMATION	COLOR	HARD OR SOFT	TOP FEET	BOTTOM FEET	REMARKS Including indication of all fresh and salt water, coal, oil and gas
Shale & Siltstone			0	160	
Sandstone			160	186	
Shale & Siltstone			186	296	
Sandstone			186	296	
Sandstone			296	304	
Shale & Siltstone			304	1148	
Salt Sand			1148	1571	
Shale			1571	1667	
Sandstone			1667	1688	
Shale			1688	1698	
Little Lime			1698	1743	
Pencil Cave			1743	1751	
Big Lime			1751	1892	
Big Injun			1892	1933	
Shale & Siltstone			1933	2036 TD	

(Attach separate sheets as necessary)

QUAKER STATE OIL REFINING CORPORATION
 Well Operator
 Steve Opritza Geologist
 By: Steve Opritza 02/16/2024
 Date: August 17, 1983

Note: Regulation 2.02(i) provides as follows:
 "The term 'log' or 'well log' shall mean a systematic detailed geological record of all formations, including coal, encountered in the drilling of a well."

OG-RECEIVED

JUN 27 1983

OIL AND GAS DIVISION
WV DEPARTMENT OF MINES

STATE OF WEST VIRGINIA
DEPARTMENT OF MINES
OIL AND GAS WELLS DIVISION

INSPECTOR'S WELL REPORT

Permit No. D39-3969

Oil or Gas Well _____
(KIND)

Company QUAKER STATE OIL
 Address PARKERSBURG, W. VA.
 Farm JAMES COURTNEY
 Well No. 1
 District ELK County KANAWHA
 Drilling commenced 6/18/83
 Drilling completed 6/21/83 Total depth 2009
 Date shot _____ Depth of shot _____
 Initial open flow _____ /10ths Water in _____ Inch
 Open flow after tubing _____ /10ths Merc. in _____ Inch
 Volume _____ Cu. Ft.
 Rock pressure _____ lbs. _____ hrs.
 Oil _____ bbls., 1st 24 hrs.
 Fresh water _____ feet _____ feet
 Salt water _____ feet _____ feet

CASING AND TUBING	USED IN DRILLING	LEFT IN WELL	PACKERS
Size			
16			Kind of Packer
13			
10			Size of
8 3/4			
6 5/8			Depth set
5 3/16			
3			Perf. top
2			Perf. bottom
Liners Used			Perf. top
			Perf. bottom

CASING CEMENTED 8 5/8 SIZE 347 No. FT. 6/19 Date
 NAME OF SERVICE COMPANY HALLIBURTON
 COAL WAS ENCOUNTERED AT _____ FEET _____ INCHES
 _____ FEET _____ INCHES _____ FEET _____ INCHES
 _____ FEET _____ INCHES _____ FEET _____ INCHES

Drillers' Names CLINT HURT RIG 2 LARRY MOORE (TOOL PUSHER)

Remarks: RAN 347' OF 8 5/8 CEMENTED WITH 120 SKS

6/22/83
DATE

Craig Duckworth 505
DISTRICT WELL INSPECTOR

02/16/2024

STATE OF WEST VIRGINIA
DEPARTMENT OF MINES
OIL AND GAS WELLS DIVISION

INSPECTOR'S WELL REPORT

Permit No. _____

Oil or Gas Well _____
(KIND)

Company _____
 Address _____
 Farm _____
 Well No. _____
 District _____ County _____
 Drilling commenced _____
 Drilling completed _____ Total depth _____
 Date shot _____ Depth of shot _____
 Initial open flow _____ /10ths Water in _____ Inch
 Open flow after tubing _____ /10ths Merc. in _____ Inch
 Volume _____ Cu. Ft.
 Rock pressure _____ lbs. _____ hrs.
 Oil _____ bbls., 1st 24 hrs.
 Fresh water _____ feet _____ feet
 Salt water _____ feet _____ feet

CASING AND TUBING	USED IN DRILLING	LEFT IN WELL	PACKERS
Size			
16			Kind of Packer _____
13			
10			Size of _____
8 1/4			
6 5/8			Depth set _____
5 3/16			
3			Perf. top _____
2			Perf. bottom _____
Liners Used			Perf. top _____
			Perf. bottom _____

CASING CEMENTED _____ SIZE _____ No. FT. _____ Date _____
 NAME OF SERVICE COMPANY _____
 COAL WAS ENCOUNTERED AT _____ FEET _____ INCHES
 _____ FEET _____ INCHES _____ FEET _____ INCHES
 _____ FEET _____ INCHES _____ FEET _____ INCHES

Drillers' Names _____

Remarks: _____

DATE _____

02/16/2024

DISTRICT WELL INSPECTOR



RECEIVED

AUG 19 1983

STATE OF WEST VIRGINIA
DEPARTMENT OF MINES
OIL AND GAS WELLS DIVISION

OIL & GAS DIVISION
DEPT. OF MINES

NOTICE OF INTENTION TO PLUG AND ABANDON WELL

(REQUIRED BY SECTION 9, ARTICLE 4, CHAPTER 22 OF THE CODE)

To THE DEPARTMENT OF MINES,
Charleston, W. Va.

NA
Coal Operator

QUAKER STATE OIL REFINING CORPORATION
Name of Well Operator

P.O. Box 1327
Parkersburg, WV 26102-1327

Address

Complete Address

NA
Coal Owner

August 17, 1983
Date

WELL TO BE ABANDONED

Address

Big Sandy District

James M. Courtney, etal
Lease or Property Owner

Kanawha County

Falling Rock, WV 25079
Address

Well No. 1

J.M. Courtney Farm

Inspector Craig Duckworth, Davision Rt., Box 107, Gassaway, WV Telephone 364-5942

TO BE NOTIFIED 24 HOURS IN ADVANCE OF PLUGGING OPERATIONS

Gentlemen:—

The undersigned well operator is about to abandon the above described well and will commence

the work of plugging and abandoning said well on the date inspector is notified (which date shall not be less than five days after the day on which this notice so mailed is received, or in due course should be received by the Department of Mines).

This notice is given you in order that your respective representatives may be present at the plugging and filling of said well. You are further notified that whether you are represented or not represented the undersigned will proceed on that date, or shortly thereafter, to plug and fill said well in the manner required by Section 10, Article 4, Chapter 22 of the Code and given in detail on the reverse side of this notice, in "Work Order."

This notice is being mailed by registered mail to each of you at the above addresses on the above date.

Very truly yours,

QUAKER STATE OIL REFG. CORP. Well Operator
Carl J. Carlson - Dist. Manager

NOTE: Upon the abandonment of any well drilled prior to June 1, 1929, a plat prepared by a registered engineer, shall be filed with THREE COPIES OF APPLICATION, (OG-9) AND "WORK ORDER" AND TWO COPIES OF THE WELL RECORD, (OG-10). The map must show the district and county in which the tract of land is located, the name and acreage of same, the name or names of the owners and names of adjacent tracts and the location of the well to be abandoned, determined by survey with the courses and distances of such well from two permanent points or landmarks on said tract, in compliance with Rule 5 of the Rules and Regulations.

NOTE: In case plugging is not commenced within four months from the date of permit, same shall expire and be of no further force or effect.

NOTE: PERMIT IS NON TRANSFERABLE.

PROPOSED MANNER OF PLUGGING AND FILLING WELL

(REQUIRED BY RULES AND REGULATIONS)

WEST VIRGINIA DEPARTMENT OF MINES

OIL AND GAS DIVISION

WORK ORDER

Well to be plugged and filled as follows:

Cement from 1950' to 1850' across Big Injun.

Gel from 1850' to 1800'.

Cement from 1800' to 1750' across top of Big Lime.

Gel from 1750' to 1300'.

Cement from 1300' to 1200' across Salt Sand.

Gel from 1200' to 400'.

Cement from 400' to 300' across freshwater zone.

Gel from 300' to 100'.

Cement from 100' to Surface.

Approximately 980' of 4½" casing should be recovered prior to plugging. If this freepoint doesn't fall within one of the above plugged intervals, an additional plug will be placed at this point.

To the Department of Mines
Coal Owner or Operator,
Lease or Property Owner.

IF PARTIAL PLUGGING
PLEASE SUBMIT REVISED WELL RECORD
WHEN WORK IS COMPLETED.

Gentlemen:

This "work order" is submitted for your approval and concurrence and unless notified of your disapproval or non-concurrence, the undersigned will proceed with the plugging and filling of said well in the above described manner on the date inspector is notified after permit is issued.

Very truly yours,

Well Operator

No objections have been filed by the coal owner or coal operator, or any available adjacent lease or property owners or interposed by the Department of Mines to the manner herein described for the plugging and filling of the well above mentioned. Therefore, the same is hereby approved this

27th day of September, 1983.

DEPARTMENT OF MINES
Oil and Gas Division

02/16/2024

By: Michael J. Davis

NOTE: This "work order" shall be filed in triplicate, one copy for the files of the Department of Mines; one to be approved or corrected and returned to the well operator as his authority for plugging said well; and one for the well inspector.

FORM IV-38
[08-78]

RECEIVED
JAN 10 1984

Date: December 15, 1983

Operator's Well No. Courtney #1

API Well No. 47 - 039 - 3969 - 1
State County Permit

STATE OF WEST VIRGINIA
DEPARTMENT OF MINES, OIL AND GAS DIVISION
DEPT. OF MINES
AFFIDAVIT OF PLUGGING AND FILLING WELL

WELL TYPE: Oil X / Gas ___ / Liquid Injection ___ / Waste Disposal ___ /
(If "Gas", Production ___ / Underground storage ___ / Deep ___ / Shallow ___ /
LOCATION: Elevation: 915.5' Watershed: Sand Run of Elk River
District: Big Sandy County: Kanawha Quadrangle: Blue Creek

WELL OPERATOR Quaker State Oil Refining Corp.
Address P.O. Box 1327
Parkersburg, WV 26101

DESIGNATED AGENT Carl J. Carlson
Address P.O. Box 1327
Parkersburg, WV 26101

STATE OF WEST VIRGINIA,)
COUNTY OF Kanawha) SS:

Roy Ice and Jack Sutherland,

being first duly sworn according to law, depose and say that they are experienced in the work of plugging and filling oil and gas wells; that they were employed by Quaker State Oil Refining Corp., the well operator, and participated in the work of plugging and filling the above well; that the work was commenced on December 14, 1983, and completed on December 14, 1983, in the following manner:

PERMITTED WORK: Plug and abandon X / Clean out and replug ___ /

PLUGGING MATERIALS

Type of Cement	Other Materials	Depth	Thickness
Reg. Neat		1950'-1750'	200'
	Gel	1750'-1300'	450'
Reg. Neat		1300'-1200'	100'
	Gel	1200'-400'	800'
Reg. Neat		400'-300'	100'
	Gel	300'-100'	200'
Reg. Neat		100'-Surface	100'

VENT PIPE None
MISCELLANEOUS MATERIALS None
CASING LOST 1710' of 4 1/2"

TYPE OF RIG:
Owner: Well Op'r X / Contractor ___ /
Rig time: 1 days plus 0 hours

COAL SEAMS (NAMES AND DEPTHS)

None

DESCRIPTION OF WELL MONUMENT

Four foot marker including API permit number, well name and number, and plugging date.

Jack Sutherland (SEAL)
Roy Ice (SEAL)

02/16/2024

Subscribed and sworn to before me this

15th day of December, 1983.

My commission expires July 2, 1986.

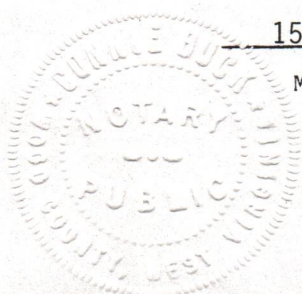

Connie Buck
Notary Public

KAN 3969

RECEIVED

DEPT. OF MINES
OFFICE OF THE SUPERVISOR

02/16/2024





RECEIVED

MAY 14 1984

OIL & GAS DIVISION
DEPT. OF MINES

State of West Virginia
Department of Mines
Oil and Gas Division
Charleston 25305
FINAL INSPECTION REPORT
INSPECTORS COMPLIANCE REPORT
January 13, 1984

OK

COMPANY Quaker State Oil Refining Co.

PERMIT NO 039-3969-P

P. O. Box 1327

FARM & WELL NO Courtney #1

Parkersburg, West Virginia 26101

DIST. & COUNTY Big Sandy/Kanawha

RULE	DESCRIPTION	IN COMPLIANCE	
		Yes	No
23.06	Notification Prior to Starting Work	<u> </u>	<u> </u>
16.01	Required Permits at Wellsite	<u> </u>	<u> </u>
17.02	Method of Plugging	<u> </u>	<u> </u>
18.01	Materials used in Plugging	<u> </u>	<u> </u>
23.02	Maintained Access Roads	<u> </u>	<u> </u>
25.01	Necessary Equipment to Prevent Waste	<u> </u>	<u> </u>
23.04	Reclaimed Drilling Pits	<u> </u>	<u> </u>
23.05	No Surface or Underground Pollution	<u> </u>	<u> </u>
17.06	Statutory Affidavit	<u> </u>	<u> </u>
7.06	Parties Responsible	<u> </u>	<u> </u>
7.05	Identification Markings	<u> </u>	<u> </u>

I HAVE INSPECTED THE ABOVE CAPTIONED WELL AND RECOMMEND THAT IT BE RELEASED:

SIGNED Rodney Dillon

DATE 5/16/84

Your Affidavit of Plugging was received and reclamation requirements approved. The well designated by the above permit number has been released under your bond.

T. H. ...
Administrator-Oil & Gas Division

May 21, 1984

DATE

6-17-83

NOTE: BEARINGS & DISTANCES IN PARENTHESIS INDICATE ACTUAL DEED CALLS.

LATITUDE 38°30'00" (7.5)
38°30' (15)

(15)

LONGITUDE 81°25'00" (15)
81°25' (15)

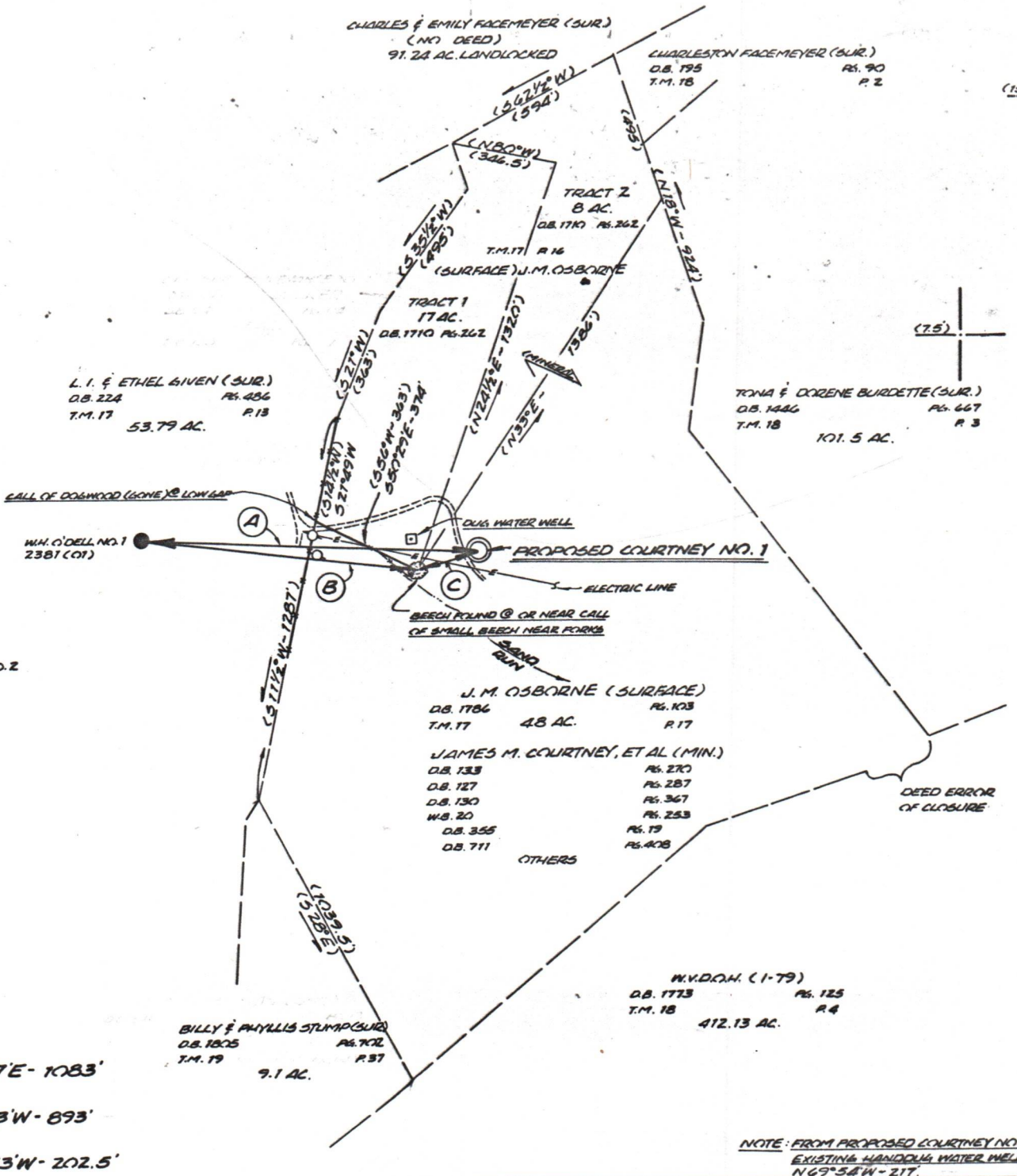

"1983 MAGNETIC"

- (A) $S 76^{\circ} 57' E - 1083'$
- (B) $N 72^{\circ} 53' W - 893'$
- (C) $S 84^{\circ} 53' W - 202.5'$

NOTE: FROM PROPOSED COURTNEY NO. 1 TO EXISTING HANDCUM WATER WELL IN N 69° 58' W - 217.

FILE NO. 8334
 DRAWING NO. _____
 SCALE 1" = 500'
 MINIMUM DEGREE OF ACCURACY 1' IN 200'
 PROVEN SOURCE OF ELEVATION EXISTING W.H. O'DELL NO. 1 WELL - ELEV. 861.5'

I THE UNDERSIGNED, HEREBY CERTIFY THAT THIS PLAT IS CORRECT TO THE BEST OF MY KNOWLEDGE AND BELIEF AND SHOWS ALL THE INFORMATION REQUIRED BY LAW AND THE REGULATIONS ISSUED AND PRESCRIBED BY THE DEPARTMENT OF MINES.

(SIGNED) Bruce Hager
 R.P.E. _____ L.I.S. 577

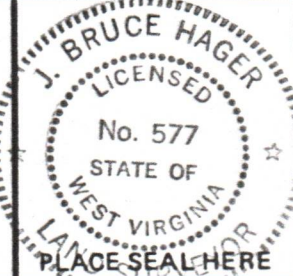

STATE OF WEST VIRGINIA
 DEPARTMENT OF MINES
 OIL AND GAS DIVISION



DATE APRIL 15, 19 83
 OPERATOR'S WELL NO. COURTNEY NO. 1
 API WELL NO. _____
47 - 039 - 3969-P
 STATE COUNTY PERMIT

(+) DENOTES LOCATION OF WELL ON UNITED STATES TOPOGRAPHIC MAPS
 WELL TYPE: OIL GAS _____ LIQUID INJECTION _____ WASTE DISPOSAL _____
 (IF "GAS,") PRODUCTION _____ STORAGE _____ DEEP _____ SHALLOW _____
 LOCATION: ELEVATION 915.5' WATER SHED SAND RUN OF ELK RIVER
 DISTRICT BIG SANDY COUNTY KANAWHA
 QUADRANGLE BLUE CREEK 7.5', CLENDENIN 15'
 SURFACE OWNER J.M. OSBORNE ACREAGE 48
 OIL & GAS ROYALTY OWNER JAMES M. COURTNEY, ET AL LEASE ACREAGE 48
 LEASE NO. _____
 PROPOSED WORK: DRILL CONVERT _____ DRILL DEEPER _____ REDRILL _____ FRACTURE OR STIMULATE _____ PLUG OFF OLD FORMATION _____ PERFORATE NEW FORMATION _____ OTHER PHYSICAL CHANGE IN WELL (SPECIFY) _____

PLUG AND ABANDON _____ CLEAN OUT AND REPLUG _____
 TARGET FORMATION BIG INJUN ESTIMATED DEPTH 2066'
 WELL OPERATOR QUAKER STATE OIL REF CORP DESIGNATED AGENT CARL J. CARLSON
 ADDRESS P.O. BOX 1327 ADDRESS P.O. BOX 1327
PARKERSBURG, WV 26101 PARKERSBURG, WV 26101

FORM IV-6 (8-78)

K.M.V. 3969