

N.B. M-19 PG. 8 & 22

FILE NO KGS-8
 MAP NO QUICK QUAD.
 SCALE 1" = 2000'
 MINIMUM DEGREE OF ACCURACY 1:2500
 PROVEN SOURCE OF ELEVATION U.S.G.S. B.M. SHOWN EL. 687'

I, THE UNDERSIGNED HEREBY CERTIFY THAT THIS PLAT IS CORRECT TO THE BEST OF MY KNOWLEDGE AND BELIEF AND SHOWS ALL THE INFORMATION REQUIRED BY LAW AND THE REGULATIONS ISSUED AND PRESCRIBED BY THE DEPARTMENT OF MINES.
 (SIGNED) Amy J. Berger Jr.
 HARRY L. BERGER JR.

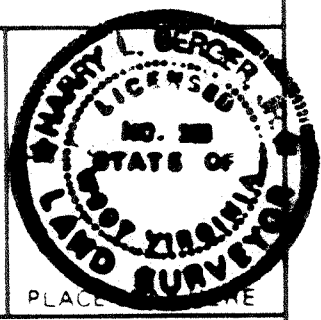

(+) DENOTES LOCATION OF WELL ON UNITED STATES TOPOGRAPHIC MAPS
 FORM IV-6 (878)

DATE MAY 20 1982
 OPERATOR'S WELL NO KGS-8
 API WELL NO 47-039-3986
 STATE COUNTY PERMIT

STATE OF WEST VIRGINIA
 DEPARTMENT OF MINES
 OIL AND GAS DIVISION

WELL TYPE OIL ___ GAS LIQUID INJECTION ___ WASTE DISPOSAL ___
 (IF "GAS") PRODUCTION STORAGE ___ DEEP ___ SHALLOW

LOCATION ELEVATION 1192.86' WATER SHED PIGEONROOST FORK
 DISTRICT ELK COUNTY KANAWHA
 QUADRANGLE 7-1/2 QUICK & 15-CLENDENIN S.W.

SURFACE OWNER UNION CARBIDE CORP. ACREAGE 2389
 OIL & GAS ROYALTY OWNER UNION CARBIDE CORP. LEASE ACREAGE 2389
 LEASE NO. _____

PROPOSED WORK DRILL CONVERT ___ DRILL DEEPER ___ REDRILL ___ FRACTURE OR STIMULATE ___ PLUG OFF OLD FORMATION ___ PERFORATE NEW FORMATION ___ OTHER PHYSICAL CHANGE IN WELL (SPECIFY) _____

PLUG AND ABANDON ___ CLEAN OUT AND REPLUG ___
 TARGET FORMATION BROWN SHALE ESTIMATED DEPTH 4545'
 OPERATOR RUBIN RESOURCES, INC. AGENT RICK RUBIN
 ADDRESS 1007 C Bridge Road ADDRESS 1007 C Bridge Road
Charleston, W.Va. 25314 CHARLESTON, WV 25314

SEP 12 1983

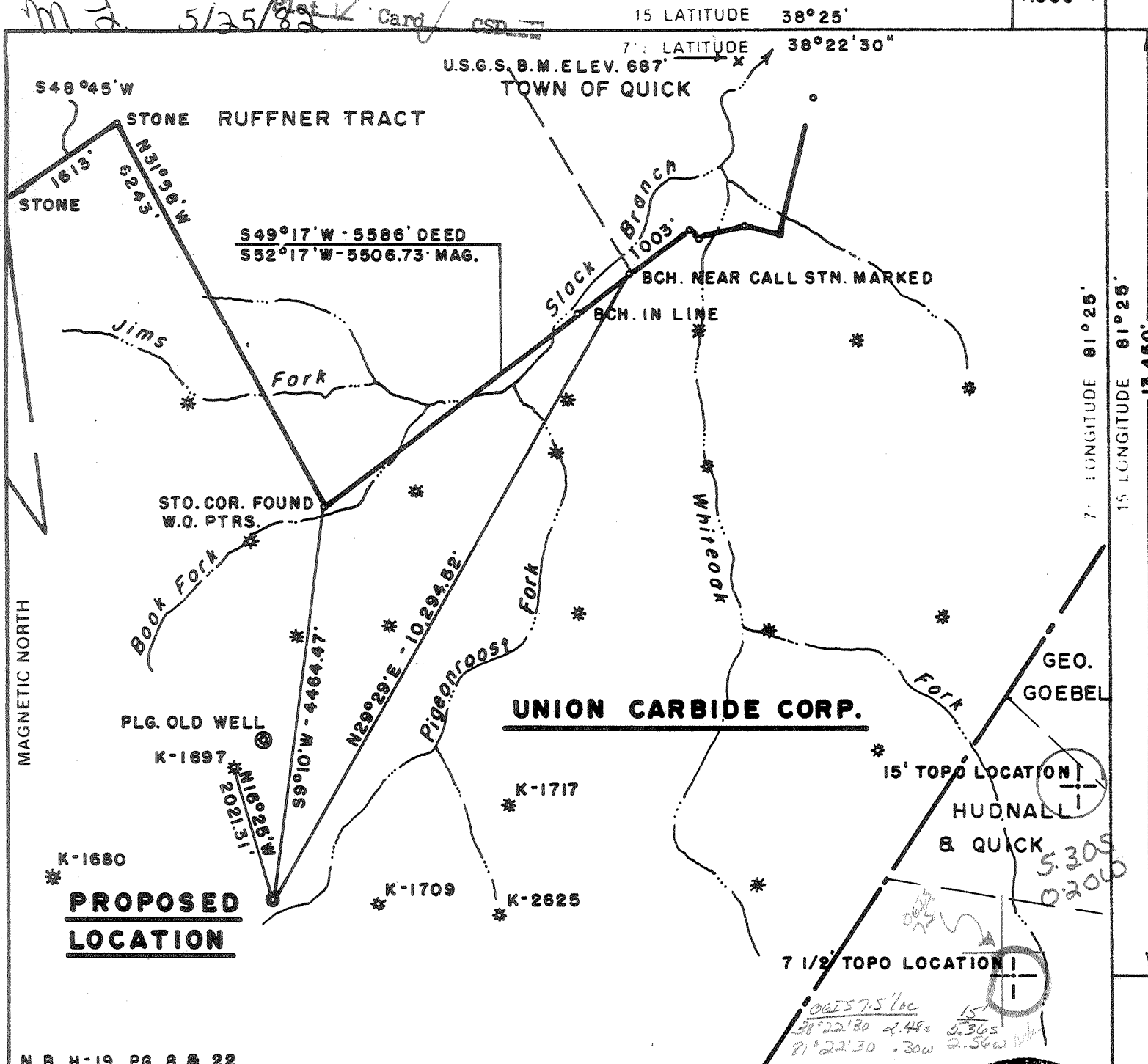

N.B. H-19 PG. 8 & 22

FILE NO KCS-8
 MAP NO QUICK QUAD.
 SCALE 1" = 2000'
 MINIMUM DEGREE OF ACCURACY 1:2500
 PROVEN SOURCE OF ELEVATION U.S.G.S. B.M. SHOWN EL. 687

I, THE UNDERSIGNED HEREBY CERTIFY THAT THIS PLAT IS CORRECT TO THE BEST OF MY KNOWLEDGE AND BELIEF AND SHOWS ALL THE INFORMATION REQUIRED BY LAW AND THE REGULATIONS ISSUED AND PRESCRIBED BY THE DEPARTMENT OF MINES.

(SIGNED) Harry L. Berger Jr.
 HARRY L. BERGER JR. L.L.S.

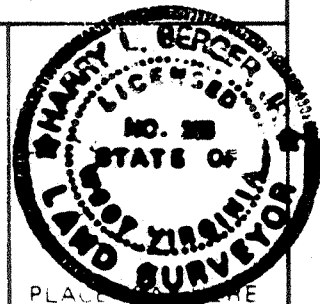

(+) DENOTES LOCATION OF WELL ON UNITED STATES TOPOGRAPHIC MAPS
 FORM IV-6 (878)



DATE MAY 20 1982
 OPERATOR'S WELL NO KCS-8
 API WELL NO 47-039-3879
 STATE WV COUNTY CLAY PERMIT 3879

STATE OF WEST VIRGINIA
 DEPARTMENT OF MINES
 OIL AND GAS DIVISION

WELL TYPE OIL GAS LIQUID INJECTION WASTE DISPOSAL
 (IF "GAS") PRODUCTION STORAGE DEEP SHALLOW
 LOCATION ELEVATION 1199.86' WATER SHED PIGEONROOST FORK
 DISTRICT ELK COUNTY KANAWHA
 QUADRANGLE 7 1/2' QUICK & 15' CLENDENIN S.W.
 SURFACE OWNER UNION CARBIDE CORP. ACREAGE 2389
 OIL & GAS ROYALTY OWNER UNION CARBIDE CORP. LEASE ACREAGE 2389
 LEASE NO. _____
 PROPOSED WORK DRILL CONVERT DRILL DEEPER REDRILL FRACTURE OR STIMULATE PLUG OFF OLD FORMATION PERFORATE NEW FORMATION OTHER PHYSICAL CHANGE IN WELL (SPECIFY) _____

PLUG AND ABANDON CLEAN OUT AND REPLUG
 TARGET FORMATION BROWN SHALE ESTIMATED DEPTH 4545'
 OPERATOR BLUE CREEK GAS CO. AGENT STEVE RUBIN
 ADDRESS BOX 6357 ADDRESS BOX 6357
CHARLESTON, WV 25302 CHARLESTON, WV 25302

JUN 14 1982

DETAILS OF PERFORATED INTERVALS, FRACTURING OR STIMULATING, PHYSICAL CHANGE, ETC.

PERFORATING : 25 perforations
 Top Perforation at 3397'
 Bottom Perforation at 4370' Huron

FRACTURING : 75 Quality Foam
 600 sks. sand
 single stage
 dropped 10 balls
 WELL LOG

FORMATION	COLOR	HARD OR SOFT	TOP FEET	BOTTOM FEET	REMARKS Including indication of all fresh and salt water, coal, oil and gas
Rock & dirt			0	20	
Sand			20	196	
Sand & Shale			196	515	
Shale			515	800	
Sand & Shale			800	991	
Coal			991	992	
Sand			992	1105	
Coal			1105	1109	
Sand & Shale			1109	1143	
Salt Sand & Shale			1143	1280	
Sand			1280	1580	
Little Lime			1580	1632	
Shale			1632	1645	
Big Lime			1645	1814	
Red Rock			1814	1823	
Injun			1823	1842	
Shale			1842	1902	
Weir			1902	1920	
Shale			1920	2238	
Berea			2238	2246	
Shale			2246	4442	T.D. in Huron

(Attach separate sheets as necessary)

Rubin Resources Inc.

Well Operator

By: Rick Rubin

Date: 11-22-83

Note: Regulation 2.02(i) provides as follows:
 "The term 'log' or 'well log' means a detailed geological record of a well, including all formations encountered in the drill."

is:
 all mean a systematic record of all formations, including all formations encountered in the drill of a well."



1) Date: August 30, 1983
 2) Operator's Well No. KCS 8
 3) API Well No. 47 - 039 - 3986
 State County Permit

STATE OF WEST VIRGINIA
 DEPARTMENT OF MINES, OIL AND GAS DIVISION
APPLICATION FOR A WELL WORK PERMIT

- 4) WELL TYPE: A Oil / Gas X /
 B (If "Gas", Production / Underground storage / Deep / Shallow)
- 5) LOCATION: Elevation: 1200' Watershed: Pigeonroost Fork
 District: Elk County: Kanawha Quadrangle: Quick
- 6) WELL OPERATOR Rubin Resources Inc. 7) DESIGNATED AGENT Rick Rubin
 Address 1007 C Bridge Road Address 1007 C Bridge Road
Charleston, WV 25314 Charleston, WV 25314
- 8) OIL & GAS INSPECTOR TO BE NOTIFIED 9) DRILLING CONTRACTOR:
 Name Craig Duckworth Name
 Address P.O. Box 107 Davison Route Address
Gassaway, WV 26624
- 10) PROPOSED WELL WORK: Drill X / Drill deeper / Redrill / Stimulate X /
 Plug off old formation / Perforate new formation X /
 Other physical change in well (specify)
- 11) GEOLOGICAL TARGET FORMATION, Shale
- 12) Estimated depth of completed well, 4400 feet
 13) Approximate trata depths: Fresh, 499 feet; salt, feet.
 14) Approximate coal seam depths: Is coal being mined in the area? Yes / No

15) CASING AND TUBING PROGRAM

CASING OR TUBING TYPE	SPECIFICATIONS					FOOTAGE INTERVALS		CEMENT FILL-UP OR SACKS (Cubic feet)	PACKERS
	Size	Grade	Weight per ft.	New	Used	For drilling	Left in well		
Conductor	9 5/8		36	X		500'	500'	Cement to Surface	By Rule 15.0
Fresh water									
Coal									Sizes
Intermediate	7"		23	X		1860'	1860'	40 sks.	
Production	4 1/2"		10.5	X		4400'	4400'	100 sks.	Depths set <u>OK AS REQ BY Rule 15.0!</u>
Tubing									Perforations:
Liners									Top Bottom

OFFICE USE ONLY
 DRILLING PERMIT

Permit number 47-039-3986 Date September 6, 1983

This permit covering the well operator and well location shown below is evidence of permission granted to drill in accordance with the pertinent legal requirements subject to the conditions contained herein and on the reverse hereof. Notification must be given to the District Oil and Gas Inspector, (Refer to No. 8) Prior to the construction of roads, locations and pits for any permitted work. In addition, the well operator or his contractor shall notify the proper district oil and gas inspector 24 hours before actual permitted work has commenced.)

The permitted work is as described in the Notice and Application, plat, and reclamation plan, subject to any modifications and conditions specified on the reverse hereof.

Permit expires September 6, 1985 unless well work is commenced prior to that date and prosecuted with due diligence.

Bond: <u>BB</u>	Agent: <u>OK</u>	Plat: <u> </u>	Casing: <u> </u>	Fee: <u>202</u>
-----------------	------------------	-------------------------	---------------------------	-----------------

 Administrator, Office of Oil and Gas

NOTE: Keep one copy of this permit posted at the drilling location.



Date: May 17, 19 82

Operator's Well No. KCS, 2

API Well No. 47 039 3879

State County Permit

STATE OF WEST VIRGINIA
DEPARTMENT OF MINES, OIL AND GAS DIVISION
OIL AND GAS WELL PERMIT APPLICATION

WELL TYPE: Oil / Gas X /
(If "Gas", Production / Underground storage / Deep / Shallow /)

LOCATION: Elevation: 1199.86' Watershed: Blue Creek
District: E1k County: Kanawha Quadrangle: Quick

WELL OPERATOR Blue Creek Gas Company
Address P.O. Box 6357
Charleston, WV 25302

DESIGNATED AGENT Steven Rubin
Address P.O. Box 6357
Charleston, WV 25302

OIL & GAS ROYALTY OWNER Union Carbide
Address P.O. Box 8004
South Charleston, WV 25303
Acreage 2389

COAL OPERATOR Union Carbide
Address P.O. Box 8004
South Charleston, WV 25303

SURFACE OWNER Union Carbide
Address P.O. Box 8004
South Charleston, WV 25303
Acreage

COAL OWNER(S) WITH DECLARATION ON RECORD:
Name
Address
Name **RECEIVED**
MAY 24 1982
Address
OIL AND GAS DIVISION
WV DEPARTMENT OF MINES

FIELD SALE (IF MADE) TO:
Address

COAL LESSEE WITH DECLARATION ON RECORD:
Name
Address

OIL & GAS INSPECTOR TO BE NOTIFIED
Name Martin Nichols
Address Clendenin, WV

The undersigned well operator is entitled to operate for oil or gas purposes at the above location under a deed / lease X other contract / dated July 3, 19 44, to the undersigned well operator from United Fuel Gas Co.

(If said deed, lease, or other contract has been recorded:)
Recorded on May 29, 19 45, in the office of the Clerk of the County Commission of Kanawha County, West Va., in Charleston Book 103 at page 78. A permit is requested as follows:

PROPOSED WORK: Drill X / Drill deeper / Redrill / Fracture or stimulate X /
Plug off old formation / Perforate new formation X /
Other physical change in well (specify)

—planned as shown on the work order on the reverse side hereof.

The above named coal operator, coal owner(s), and coal lessee are hereby notified that any objection they wish to make or are required to make by Code §22-4-3 must be filed with the Department of Mines within fifteen (15) days after the receipt of this Application by the Department.

Copies of this Permit Application and the enclosed plat and reclamation plan have been mailed by registered mail or delivered by hand to the above named coal operator, coal owner(s), and coal lessee on or before the day of the mailing or delivery of this Permit Application to the Department of Mines at Charleston, West Virginia.

PLEASE SUBMIT COPIES OF ALL GEOPHYSICAL LOGS DIRECTLY TO:
WEST VIRGINIA OIL AND GAS CONSERVATION COMMISSION
1615 WASHINGTON STREET EAST CHARLESTON, WV 25311
TELEPHONE: (304) 348-3092

PERMIT BOND

Blue Creek Gas Company
Well Operator
By Steven Rubin
Its Director of Operations

PROPOSED WORK ORDER

THIS IS AN ESTIMATE ONLY:
ACTUAL INFORMATION MUST BE SUBMITTED ON FORM IV-35 UPON COMPLETION

DRILLING CONTRACTOR (IF KNOWN) N/A
Address _____

GEOLOGICAL TARGET FORMATION, Shale

Estimated depth of completed well, 4545 feet Rotary X / Cable tools _____ /

Approximate water strata depths: Fresh, 499.8 feet; salt, _____ feet.

Approximate coal seam depths: _____ Is coal being mined in the area? Yes X / No _____ /

CASING AND TUBING PROGRAM

CASING OR TUBING TYPE	SPECIFICATIONS					FOOTAGE INTERVALS		CEMENT FILL-UP OR SACKS (Cubic feet)	PACKERS
	Size	Grade	Weight per ft	New	Used	For drilling	Left in well		
Conductor	9 5/8			X		500	500	Cement to Surface	Kinds
Fresh Water									
Coal									Sizes
Intermediate	7"		20	X		1860	1860	40 sks.	
Production	4 1/2"		10.5	X		4545	4545	100 sks.	Depths set
Tubing									
Liners									Perforations:
									Top Bottom

NOTE: Regulation 7.02 of the Department of Mines provides that the original and four copies of Form IV-2 must be filed with the Department, accompanied by (i) a plat in the form prescribed by Regulation 11, (ii) a bond in one of the forms prescribed by Regulation 12, or in lieu thereof the other security allowed by Code § 22-4-2, (iii) Form IV-9, "Reclamation Plan", applicable to the reclamation required by Code § 22-4-12b and Regulation 23, (iv) unless previously paid on the same well, the fee required by Code § 22-4-12a, and (v) if applicable, the consent required by Code § 22-4-8a from the owner of any water well or dwelling within 200 feet of the proposed well.

A separate Form IV-2 shall not be required for fracturing or stimulating a well where fracturing or stimulating is to be part of the work for which a permit is sought and is noted as such on the Form IV-2 filed in connection therewith.

THIS PERMIT MUST BE POSTED AT THE WELL SITE.
ALL PROVISIONS BEING IN ACCORDANCE WITH CHAPTER 22,
ARTICLE 4 OF THE W. VA. CODE, THE LOCATION IS HEREBY
APPROVED FOR drilling. THIS PERMIT SHALL EXPIRE
IF OPERATIONS HAVE NOT COMMENCED BY 2-9-83
BY [Signature]

The following waiver must be completed by the coal operator and by any coal owner or coal lessee who has recorded a declaration under Code 22-4-20, if the permit is to be issued within fifteen (15) days of receipt thereof.

WAIVER

The undersigned coal operator _____ / owner _____ / lessee _____ / of the coal under this well location has examined this proposed well location. If a mine map exists which covers the area of the well location, the well location has been added to the mine map. The undersigned has no objection to the work proposed to be done at this location, provided, the well operator has complied with all applicable requirements of the West Virginia Code and the governing regulations.

Date: _____, 19 _____

By _____
Its _____