



1) Date: August 30, 19 83
 2) Operator's Well No. KCS 8
 3) API Well No. 47 - 039 - 3986
 State County Permit

STATE OF WEST VIRGINIA
 DEPARTMENT OF MINES, OIL AND GAS DIVISION
 APPLICATION FOR A WELL WORK PERMIT

- 4) WELL TYPE: A Oil / Gas /
 B (If "Gas", Production / Underground storage / Deep / Shallow /)
- 5) LOCATION: Elevation: 1200' Watershed: Pigeonroost Fork
 District: Elk County: Kanawha Quadrangle: Quick
- 6) WELL OPERATOR Rubin Resources Inc. 7) DESIGNATED AGENT Rick Rubin
 Address 1007 C Bridge Road Address 1007 C Bridge Road
Charleston, WV 25314 Charleston, WV 25314
- 8) OIL & GAS INSPECTOR TO BE NOTIFIED 9) DRILLING CONTRACTOR:
 Name Craig Duckworth Name _____
 Address P.O. Box 107 Davison Route Address _____
Gassaway, WV 26624
- 10) PROPOSED WELL WORK: Drill / Drill deeper / Redrill / Stimulate /
 Plug off old formation / Perforate new formation /
 Other physical change in well (specify) _____
- 11) GEOLOGICAL TARGET FORMATION, Shale
- 12) Estimated depth of completed well, 4400 feet
 13) Approximate trata depths: Fresh, 499 feet; salt, _____ feet.
 14) Approximate coal seam depths: _____ Is coal being mined in the area? Yes / No /

15) CASING AND TUBING PROGRAM

CASING OR TUBING TYPE	Size	SPECIFICATIONS				FOOTAGE INTERVALS		CEMENT FILL-UP OR SACKS (Cubic feet)	PACKERS
		Grade	Weight per ft.	New	Used	For drilling	Left in well		
Conductor	9 5/8		36	X		500'	500'	Cement to Surface	By Rule 15-01
Fresh water									
Coal									Sizes
Intermediate	7"		23	X		1860'	1860'	40 sks.	
Production	4 3/8"		10.5	X		4400'	4400'	100 sks.	Depths set <u>OK AS REQ</u> <u>By Rule 15-01</u>
Tubing									Perforations:
Liners									Top Bottom

OFFICE USE ONLY
 DRILLING PERMIT

Permit number 47-039-3986 Date September 6, 1983

This permit covering the well operator and well location shown below is evidence of permission granted to drill in accordance with the pertinent legal requirements subject to the conditions contained herein and on the reverse hereof. **Notification must be given to the District Oil and Gas Inspector, (Refer to No. 8) Prior to the construction of roads, locations and pits for any permitted work.** In addition, the well operator or his contractor shall notify the proper district oil and gas inspector 24 hours before actual permitted work has commenced.)

The permitted work is as described in the Notice and Application, plat, and reclamation plan, subject to any modifications and conditions specified on the reverse hereof.
 Permit expires September 6, 1985 unless well work is commenced prior to that date and prosecuted with due diligence.

Bond: <u>BB</u>	Agent: <u>OK</u>	Plat: <u>[Signature]</u>	Casing: <u>[Signature]</u>	Fee: <u>202</u>
-----------------	------------------	--------------------------	----------------------------	-----------------

[Signature]
 Administrator, Office of Oil and Gas

NOTE: Keep one copy of this permit posted at the drilling location.



OFFICE USE ONLY

PERMIT MODIFICATIONS AND CONDITIONS (IF ANY) TO THE PROPOSED WELL WORK

1) LOCATION: 1200' Elevation, Pigeonroast Fork, Kanawha County, West Virginia

2) WELL OPERATOR: Hublin Resources Inc., 1007 G Bridge Road, Charleston, WV 25314

3) DESIGNATED AGENT: Rick Hublin, 1007 G Bridge Road, Charleston, WV 25314

4) DRILLING CONTRACTOR: Grain Drickworth, P.O. Box 107, Davison Route, Gasaway, WV 26024

5) PROPOSED WELL WORK: Drill X, 100' depth, plus old formation

6) APPROXIMATE COAL SEAM DEPTH: 100' (approximate)

7) APPROXIMATE STRATIGRAPHIC POSITION: 100' (approximate)

8) ESTIMATED DEPTH OF COMPLETED WELL: 100' (approximate)

9) GENERAL PHYSICAL CHANGE IN WELL (SPECIFY): Shale

10) IS COAL BEING MINED IN THE AREA? Yes

OFFICE USE ONLY

This part of Form IV-2(b) is to record the dates of certain occurrences and any follow-up inspections.

Date	Date(s)
Application received	Follow-up inspection(s)
Well work started	"
Completion of the drilling process	"
Well Record received	"
Reclamation completed	"

OTHER INSPECTIONS

Reason: _____

Reason: _____

Agent:	Agent:	Agent:	Agent:
--------	--------	--------	--------

AUG. 29 1983



IV-9
(Rev 8-81)

DATE August 29, 1983
WELL NO. KCS 8
API NO. 47 - 039 - 3986

State of West Virginia
Department of Mines
Oil and Gas Division

CONSTRUCTION AND RECLAMATION PLAN

COMPANY NAME Rubin Resources Inc. DESIGNATED AGENT Rick Rubin
Address 1007 C Bridge Rd. Chas. WV Address 1007 C Bridge Rd. Chas. WV
Telephone 342-1205 Telephone 342-1205
LANDOWNER Union Carbide SOIL CONS. DISTRICT Capitol
Revegetation to be carried out by Rubin Resources Inc. (Agent)

This plan has been reviewed by CAPITOL SCD. All corrections and additions become a part of this plan: AUG. 29 1983

(Date)
R. C. Alford
(SCD Agent)

ACCESS ROAD	LOCATION
Structure <u>Existing Road</u> (A)	Structure <u>Drilling Pit</u> (1)
Spacing <u>To be improved as needed</u>	Material <u>Earthen</u>
Page Ref. Manual _____	Page Ref. Manual <u>N/A</u>
Structure _____ (B)	Structure <u>Diversion Ditch</u> (2)
Spacing _____	Material <u>Earthen</u>
Page Ref. Manual _____	Page Ref. Manual <u>2-12, 2-13</u>
Structure _____ (C)	Structure _____ (3)
Spacing _____	Material _____
Page Ref. Manual _____	Page Ref. Manual _____

All structures should be inspected regularly and repaired if necessary. All commercial timber is to be cut and stacked and all brush and small timber to be cut and removed from the site before dirt work begins.

REVEGETATION

Treatment Area I

Lime 3 Tons/acre
or correct to pH _____

Fertilizer _____ lbs/acre
(10-20-20 or equivalent)

Mulch Hay 2.0 Tons/acre

Seed* Ky. 31 Tall Fescue lbs/acre
_____ 50 lbs/acre
_____ lbs/acre

Treatment Area II

Lime 3 Tons/acre
or correct to pH _____

Fertilizer 500 lbs/acre
(10-20-20 or equivalent)

Mulch Hay 2.0 Tons/acre

Seed* Ky. 31 Tall Fescue lbs/acre
_____ 50 lbs/acre
_____ lbs/acre

*Inoculate all legumes such as vetch, trefoil and clovers with the proper bacterium. Inoculate with 3X recommended amount.

PLAN PREPARED BY Rick Rubin 02/16/2024
ADDRESS 1007 C Bridge Rd.
Charleston, WV 25314
PHONE NO. 342-1205

NOTES: Please request landowner's cooperation to protect new seedling for one growing season. Attach separate sheets as necessary for comments.

ATTACH OR PHOTOGRAPHY SECTION OF INVOLVED TOPOGRAPHIC MAP. QUADRANGLE Quick

2024/16/120 ATTACHED SHEET

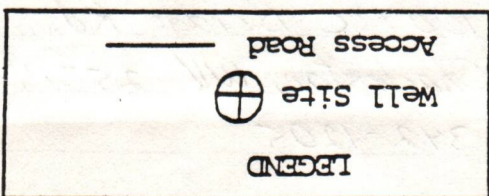

WELL SITE PLAN

sketch to include well location, existing access road, roads to be constructed, well site, drilling pits and necessary structures numbered or lettered to correspond with the first part of this plan. Include all natural drainage.

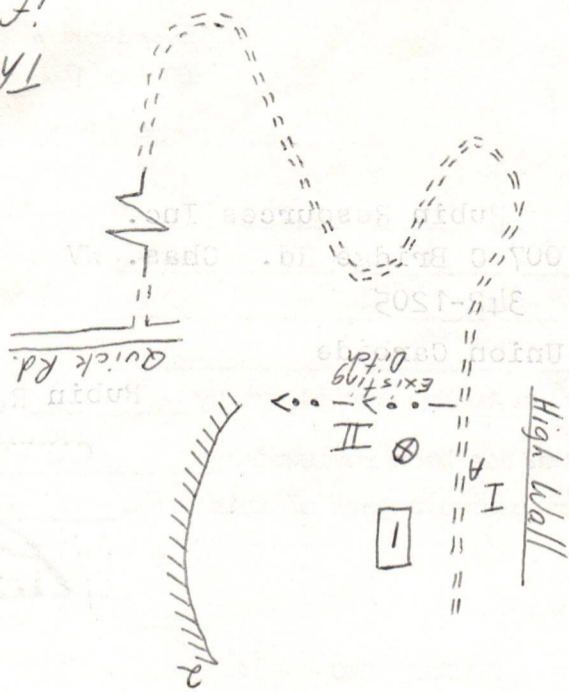
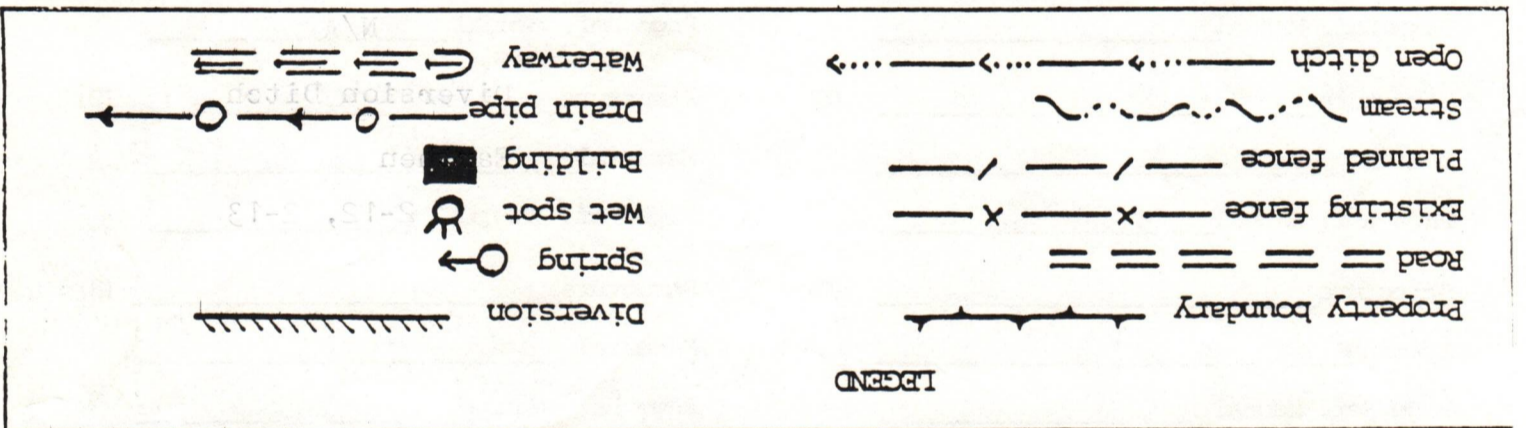

The existing road will be upgraded if needed according to the requirements used for the access road, and Topsoil shall be scraped from the disturbed area, stockpiled and utilized for topdressing after the site is regraded



02/16/2024



1) Date: August 30, 19 83
 2) Operator's Well No. KCS 8
 3) API Well No. 47 039
 State County Permit

STATE OF WEST VIRGINIA
 DEPARTMENT OF MINES, OIL AND GAS DIVISION
 APPLICATION FOR A WELL WORK PERMIT

- 4) WELL TYPE: A Oil / Gas /
 B (If "Gas", Production / Underground storage / Deep / Shallow /)
- 5) LOCATION: Elevation: 1200' Watershed: Pigeonroost Fork
 District: Elk County: Kanawha Quadrangle: Quick
- 6) WELL OPERATOR Rubin Resources Inc. 7) DESIGNATED AGENT Rick Rubin
 Address 1007 C Bridge Road Address 1007 C Bridge Road
Charleston, WV 25314 Charleston, WV 25314
- 8) OIL & GAS INSPECTOR TO BE NOTIFIED 9) DRILLING CONTRACTOR:
 Name Craig Duckworth Name _____
 Address P.O. Box 107 Davison Route Address _____
Gassaway, WV 26624
- 10) PROPOSED WELL WORK: Drill / Drill deeper / Redrill / Stimulate /
 Plug off old formation / Perforate new formation /
 Other physical change in well (specify) _____
- 11) GEOLOGICAL TARGET FORMATION, Shale
- 12) Estimated depth of completed well, 4400 feet
 13) Approximate strata depths: Fresh, 499 feet; salt, _____ feet.
 14) Approximate coal seam depths: _____ Is coal being mined in the area? Yes / No

15) CASING AND TUBING PROGRAM

CASING OR TUBING TYPE	SPECIFICATIONS					FOOTAGE INTERVALS		CEMENT FILL-UP OR SACKS (Cubic feet)	PACKERS	
	Size	Grade	Weight per ft.	New	Used	For drilling	Left in well			
Conductor	9 5/8		36	X		500'	500'	Cement to	Surface	
Fresh water										
Coal									Sizes	
Intermediate	7"		23	X		1860'	1860'	40 sks.		
Production	4 1/2"		10.5	X		4400'	4400'	100 sks.	Depths set	
Tubing										
Liners									Perforations:	
									Top	Bottom

INSTRUCTIONS TO COAL OPERATOR, OWNER, OR LESSEE

The named coal operator, coal owner(s), and coal lessee are hereby notified that any objection they wish to make or are required to make by Code §22-4-3 must be filed with the Department of Mines within fifteen (15) days after the receipt of this Application by the Department.

The following waiver must be completed by the coal operator and by any coal owner or coal lessee who has recorded a declaration under Code §22-4-20, if the permit is to be issued within fifteen (15) days of the filing of the Application.

WAIVER

The undersigned coal operator UNION CARBIDE / owner _____ / lessee _____ / of the coal under this well location has examined this proposed well location. If a mine map exists which covers the area of the well location, the well location has been added to the mine map. The undersigned has no objection to the work proposed to be done at this location, provided, the well operator has complied with all applicable requirements of the West Virginia Code and the governing regulations.

Date: 8-31-, 19 83
 By: UNION CARBIDE CORP.
W. W. Underwood
 Its: ENGINEER

02/16/2024
 Coal Owner



DATE: 8-30, 19 83
OPERATOR'S
WELL NO.: KCS 8

API NO: 47 - 039 -
State County Permit No

State of West Virginia

OFFICE OF OIL AND GAS
DEPARTMENT OF MINES

A F F I D A V I T

State of West Virginia

County of Kanawha

I, Rick Rubin (the designated owner or operator, or authorized representative thereof), after being duly sworn, do depose and say that the undersigned is authorized by the owner of the working interest in the well permit application to which this affidavit is attached do state that (he, she, or it) shall tender to the owner of the oil and gas in place not less than one-eighth of the total amount paid to or received by or allowed to the owner of the working interest at the wellhead for the oil or gas so extracted, produced, or marketed before deducting the amount to be paid or set aside for the owner of the oil or gas in place, or all such oil or gas to be extracted, produced, or marketed from the well. West Virginia Code 22-4-11(e) (1982).

Signed: Rick Rubin

Taken, Subscribed, and sworn to before me this 31 day of August, 1983.

Notary: Dilma Parkman

My Commission Expires: February 19, 1991

OF-011771
5010-108-0100
5010-108-0100



100-108-0100
100-108-0100

REO 100-108-0100

100-108-0100

100-108-0100

100-108-0100

100-108-0100

100-108-0100

100-108-0100

AFFIDAVIT OF PERSONAL SERVICE ON SURFACE OWNER

STATE OF West Virginia ,
COUNTY OF Kanawha :

The undersigned, being first duly sworn, says that the undersigned served a true and complete copy of all sides of--

- (1) Notice on Form IV-2(A) x / Form IV-3(A) / Form IV-4(A) /
- (2) Application on Form IV-2(B) x / Form IV-3(B) / Form IV-4(B) /
- (3) Plat showing the well location on Form IV-6, and
- (4) Construction and Reclamation Plan on Form IV-9 (unless the application is to plug a well)

--all with respect to operator's Well No. KCS 8 located in Elk District, Kanawha County, West Virginia, upon the person or organization named--

UNION CARBIDE

--by delivering the same in Kanawha County, State of WV on the 30th day of August, 1983 in the manner specified below.

[COMPLETE THE APPROPRIATE SECTION]

For an individual:

[] Handing it to him / her / or, because he / she / refused to take it when I offered it, by leaving it in his / her / presence.

[] Handing it to a member of his or her family above the age of 16 years named _____ who resides at the usual place of abode of the person to be served, and asking the family member to give it to the person to be served as soon as possible.

For a partnership:

[] Handing it to _____, a partner of the partnership or, because the partner refused to take it when I handed it over, by leaving it in the presence of the partner.

For a limited partnership:

[] Handing it to the general partner, named _____, or, because the general partner refused to take it when I tried to hand it over, by leaving it in the presence of the general partner.

For a corporation:

[X] Handing it to the corporation's employee x / officer / director / attorney in fact / named U.K. Bachhawat.

Rick Rubin
(Signature of person executing service)

Taken, subscribed and sworn before me this 31 day of August, 1983.
My commission expires February 19, 1991.

Edilma Workman
Notary Public

(AFFIX SEAL IF NOTARIZED IF OUTSIDE THE STATE)

1) Date: 8-30, 1983
2) Operator's Well No. KCS#8
3) API Well No. 47 039 State County Permit

STATE OF WEST VIRGINIA
DEPARTMENT OF MINES, OFFICE OF OIL & GAS
NOTICE OF APPLICATION FOR A WELL WORK PERMIT

4) SURFACE OWNER(S) OF RECORD TO BE SERVED

(i) Name Union Carbide
Address P.O. Box 8004
South Charleston, WV 25303
(ii) Name _____
Address _____
(iii) Name _____
Address _____

5(i) COAL OPERATOR Union Carbide
Address P.O. Box 8004
South Charleston, WV 25303
5(ii) COAL OWNER(S) WITH DECLARATION ON RECORD:
Name _____
Address _____
Name _____
Address _____
5(iii) COAL LESSEE WITH DECLARATION ON RECORD:
Name _____
Address _____

TO THE PERSON(S) NAMED ABOVE: You should have received this Form and the following documents:

- (1) The Application for a Well Work Permit on Form IV-2(B) (or Form IV-4 if the well is to be plugged, which sets out the parties involved in the drilling or other work, and describes the well and its location and, if applicable, the proposed casing and cementing program;
- (2) The plat (surveyor's map) showing the well location on Form IV-6; and
- (3) The Construction and Reclamation Plan on Form IV-9 (unless the well work is only to plug a well), which sets out the plan for erosion and sediment control and for reclamation for the site and access road.

THE REASON YOU RECEIVED THESE DOCUMENTS IS THAT YOU HAVE RIGHTS REGARDING THE APPLICATION WHICH ARE SUMMARIZED IN THE "INSTRUCTIONS" ON THE REVERSE SIDE OF THE COPY OF THE APPLICATION (FORM IV-2(B) OR FORM 4, DESIGNATED FOR YOU. HOWEVER, YOU ARE NOT REQUIRED TO TAKE ANY ACTION AT ALL.

Take notice that under Chapter 22 of the West Virginia Code, the undersigned well operator proposes to file or has filed this Notice and Application and accompanying documents for a Well Work Permit with the Administrator of the Office of Oil and Gas, West Virginia Department of Mines, with respect to a well at the location described on attached Application and depicted on attached Form IV-6. Copies of this Notice, the Application, the plat, and the Construction and Reclamation Plan have been mailed by registered or certified mail or delivered by hand to the person(s) named above (or by publication in certain circumstances) on or before the day of mailing or delivery to the Administrator.

The truth of the information on the Notice and Application is verified and sworn to and the Notice is signed on behalf of the Well Operator in my County and State by

WELL OPERATOR Rubin Resources Inc.
By Rick Rubin
Its Vice President
Address 1007 C Bridge Rd.
Charleston, WV 25314
Telephone (304) 342-1205

RICK RUBIN
this 31 day of August, 1983.
My commission expires Feb. 19, 1991.

Dilma Workman
Notary Public, Kanawha County,
State of West Virginia

6) EXTRACTION RIGHTS

Check and provide one of the following:

- Included is the lease or leases or other continuing contract or contracts by which I hold the right to extract oil or gas.
- The requirement of Code 22-4-1-(c) (1) through (4). (See reverse side for specifics.)

7) ROYALTY PROVISIONS

Is the right to extract, produce or market the oil or gas based upon a lease or leases or other contract or contracts providing for flat well royalty or any similar provision for compensation to the owner of the oil or gas in place which is not inherently related to the volume of oil or gas so extracted, produced or marketed? Yes (No)

If the answer above is No, nothing additional is needed. If the answer is Yes, you may use Affidavit Form IV-60.

See the reverse side for line item instructions, and for instructions concerning the required copies of the Notice and Application, plat, and Construction and Reclamation Plan.

INSTRUCTIONS TO APPLICANT

CONCERNING THE LEASE ITEMS:

- 1) Date of Notice.
- 2) Your well name and number.
- 3) To be filled out by the Office of Oil & Gas.
- 4) & 5) Use separate sheet if necessary.
- 4) Surface owner(s) of record to be served with Notice and Application. However, see also Code § 22-4-1b(b) if "more than three tenants in common or other co-owners of interest described in subsection (a) of this section hold interests in such lands".
- 5(i) "Coal Operator" means any person, firm, partnership, partnership association or corporation that proposes to or does operate a coal mine.
- 5(ii, iii) See Code § 22-4-20.
- 6) See Code § 22-4-11(c). However, in lieu of filing the lease(s) or other continuing contract(s), the Applicant may fill out the information in the space provided below.
- 7) See Code § 22-4-11(d, e).

CONCERNING THE REQUIRED COPIES FOR FILING AND SERVICE:

Filing. Code § 22-4-1k and Regulation 7.02 provide that the original and required copies of the Notice and Application must be filed with the Administrator, accompanied by (i) a plat in the form prescribed by Regulation 11, (ii) a bond in one of the forms prescribed by Regulation 12, or in lieu thereof the other security allowed by Code § 22-4-1k(d) and the reclamation required by Code § 22-4-12b and Regulation 23, (iv) unless previously paid on the same well, the fees required by Code § 22-4-1a(c) and 22-3-12a, and (v) if applicable, the consent required by Code § 22-4-3a from the owner of any water well on dwelling within 200 feet of the proposed well.

Service. In addition, service must be made on the surface owner(s) and the person(s) with an interest in the coal. See Code § 22-4-1m, 22-4-2, 22-4-2a, and 22-4-2b.

INFORMATION SUPPLIED UNDER CODE § 22-4-11(d)

IN LIEU OF FILING LEASE(S) AND OTHER CONTINUING CONTRACT(S)

Under the oath required to make the verification on the obverse side of this Notice, I depose and say that I am the person who signed the Notice for the Applicant, and that—

- (1) the tract of land is the same tract described in the Application to which this Notice applies, partly or wholly depicted in the accompanying plat, and described in the Construction and Reclamation Plan;
- (2) the parties and recordation data (if recorded) for lease(s) or other continuing contract(s) by which the Applicant claims the right to extract, produce or market the oil or gas are as follows:

<u>Grantor, lessor, etc.</u>	<u>Grantee, lessee, etc.</u>	<u>Royalty</u>	<u>Book</u>	<u>Page</u>
Union Carbide	Rubin Resources Inc.	1/8th	103	78



IV-35
(Rev 8-81)

State of West Virginia
Department of Mines
Oil and Gas Division

Date 11-22-83
Operator's Well No. KCS #8
Farm Carbide
API No. 47-039-3986

WELL OPERATOR'S REPORT
OF
DRILLING, FRACTURING AND/OR STIMULATING, OR PHYSICAL CHANGE

WELL TYPE: Oil / Gas ✓ / Liquid Injection / Waste Disposal /
(If "Gas," Production / Underground Storage / Deep / Shallow /)

LOCATION: Elevation: 1200' Watershed Pigeonroost Fork
District: ELK County Kanawha Quadrangle Quick

COMPANY Rubin Resources Inc.
ADDRESS 1007 C Bridge Rd. Chas. WV 25314
DESIGNATED AGENT Rick Rubin
ADDRESS 1007 C Bridge Rd. Chas. WV 25314
SURFACE OWNER Union Carbide
ADDRESS P.O. Box 8004 So. Charleston WV
MINERAL RIGHTS OWNER Union Carbide
ADDRESS P.O. Box 8004 So. Charleston, WV
OIL AND GAS INSPECTOR FOR THIS WORK Jerry Halcomb ADDRESS Box 58 Indore, WV 25111
PERMIT ISSUED 9-5-83
DRILLING COMMENCED 10-12-83
DRILLING COMPLETED 10-21-83
IF APPLICABLE: PLUGGING OF DRY HOLE ON CONTINUOUS PROGRESSION FROM DRILLING OR REWORKING. VERBAL PERMISSION OBTAINED ON

Casing Tubing	Used in Drilling	Left in Well	Cement fill up Cu. ft.
Size 20-16 Cond.			
13-10"	12'	0	
9 5/8	495'	495'	To surface
8 5/8			
7	1665'	1665'	75 sks.
5 1/2			
4 1/2	4419'	4419'	115 sks.
3			
2			
Liners used			

GEOLOGICAL TARGET FORMATION Devonian Shale Depth 4400 feet
Depth of completed well 4440 feet Rotary ✓ / Cable Tools
Water strata depth: Fresh feet; Salt feet
Coal seam depths: Is coal being mined in the area? No

OPEN FLOW DATA

Producing formation Devonian Shale Pay zone depth 3397-4370 feet
Gas: Initial open flow 146 Mcf/d Oil: Initial open flow Bbl/d
Final open flow 133 Mcf/d Final open flow Bbl/d
Time of open flow between initial and final tests 14 hours
Static rock pressure 700 psig (surface measurement) after 72 hours shut in
(If applicable due to multiple completion--)
Second producing formation Pay zone depth feet
Gas: Initial open flow Mcf/d Oil: Initial open flow Bbl/d
Final open flow Mcf/d Oil: Final open flow Bbl/d
Time of open flow between initial and final tests hours
Static rock pressure psig (surface measurement) after hours shut in

(Continue on reverse side)

Kanawha 3986

DETAILS OF PERFORATED INTERVALS, FRACTURING OR STIMULATING, PHYSICAL CHANGE, ETC.

PERFORATING : 25 perforations
 Top Perforation at 3397'
 Bottom Perforation at 4370'

FRACTURING : 75 Quality Foam
 600 sfs. sand
 single stage
 dropped 10 balls

WELL LOG

FORMATION	COLOR	HARD OR SOFT	TOP FEET	BOTTOM FEET	REMARKS Including indication of all fresh and salt water, coal, oil and gas
Rock & dirt			0	20	
Sand			20	196	
Sand & Shale			196	515	
Shale			515	800	
Sand & Shale			800	991	
Coal			991	992	
sand			992	1105	
Coal			1105	1109	
Sand & Shale			1109	1143	
Salt Sand & Shale			1143	1280	
Sand			1280	1580	
Little Lime			1580	1632	
Shale			1632	1645	
Big Lime			1645	1814	
Red Rock			1814	1823	
Injun			1823	1842	
Shale			1842	1902	
Weir			1902	1920	
Shale			1920	2238	
Berea			2238	2246	
Shale			2246	4442	T.D.

(Attach separate sheets as necessary)

Rubin Resources Inc.

Well Operator

By: Rick Rubin

02/16/2024

Date: 11-22-83

Note: Regulation 2.02(i) provides as follows:
 "The term 'log' or 'well log' shall mean a systematic detailed geological record of all formations, including coal, encountered in the drilling of a well."

STATE OF WEST VIRGINIA
DEPARTMENT OF MINES
OIL AND GAS WELLS DIVISION

RECEIVED

OCT 17 1983

INSPECTOR'S WELL REPORT

OIL & GAS DIVISION
DEPT. OF MINES

Permit No. 47-039-3986

Oil or Gas Well _____
(KIND)

Company ROBIN RESOURCES
 Address CHARLESTON WVA.
 Farm UNION CARBIDE
 Well No. KCS 8
 District ELK County KANAWHA
 Drilling commenced 10-11-83
 Drilling completed _____ Total depth _____
 Date shot _____ Depth of shot _____
 Initial open flow _____ /10ths Water in _____ Inch
 Open flow after tubing _____ /10ths Merc. in _____ Inch
 Volume _____ Cu. Ft.
 Rock pressure _____ lbs. _____ hrs.
 Oil _____ bbls., 1st 24 hrs.
 Fresh water _____ feet _____ feet
 Salt water _____ feet _____ feet

CASING AND TUBING	USED IN DRILLING	LEFT IN WELL	PACKERS
Size			
16			Kind of Packer _____
13			
10			Size of _____
8 1/4			
6 3/8			Depth set _____
5 3/16			
3			Perf. top _____
2			Perf. bottom _____
Liners Used			Perf. top _____
			Perf. bottom _____

CASING CEMENTED 9 5/8 SIZE 4 1/4 No. FT. 10-1383 Date _____
 NAME OF SERVICE COMPANY B.J. HUGHES
 COAL WAS ENCOUNTERED AT _____ FEET _____ INCHES
 _____ FEET _____ INCHES FEET _____ INCHES
 _____ FEET _____ INCHES FEET _____ INCHES

Drillers' Names FALCON - RIC #2

Remarks: - CEMENT W/170^{SK} CLASS A ~~FOR~~ CIRCULATE TO SURFACE
PLUG DOWN @ 1:30 PM

10-13-83
DATE

Jerry W. Holcomb
02/16/2024
DISTRICT WELL INSPECTOR

FORM 20
2/16/82

STATE OF WEST VIRGINIA
DEPARTMENT OF MINES
OIL AND GAS WELLS DIVISION

INSPECTOR'S PLUGGING REPORT

Permit No. _____ Well No. _____

COMPANY _____ ADDRESS _____

FARM _____ DISTRICT _____ COUNTY _____

Filling Material Used _____

Liner			Location	Amount	Packer	Location
PLUGS USED AND DEPTH PLACED			BRIDGES		CASING AND TUBING	
CEMENT-THICKNESS	WOOD-SIZE	LEAD	CONSTRUCTION-LOCATION		RECOVERED	SIZE LOST

Drillers' Names _____

Remarks: _____

DATE I hereby certify I visited the above well on this date.

STATE OF WEST VIRGINIA
DEPARTMENT OF MINES
OIL AND GAS WELLS DIVISION

RECEIVED

OCT 24 1983

INSPECTOR'S WELL REPORT

OIL & GAS DIVISION
DEPT. OF MINES
Oil or Gas Well (KIND)

Permit No. 039-3986

Company RUBIN RESOURCES
 Address CHARLESTON W.VA.
 Farm UNION CARBIDE
 Well No. KCS 8
 District ELK County KANAWHA
 Drilling commenced 10-11-83
 Drilling completed _____ Total depth _____
 Date shot _____ Depth of shot _____
 Initial open flow _____ /10ths Water in _____ Inch
 Open flow after tubing _____ /10ths Merc. in _____ Inch
 Volume _____ Cu. Ft.
 Rock pressure _____ lbs. _____ hrs.
 Oil _____ bbls., 1st 24 hrs.
 Fresh water _____ feet _____ feet
 Salt water _____ feet _____ feet

CASING AND TUBING	USED IN DRILLING	LEFT IN WELL	PACKERS
Size			
16			Kind of Packer
13			
10			Size of
8 1/4			
6 3/4			Depth set
5 3/16			
3			Perf. top
2			Perf. bottom
Liners Used			Perf. top
			Perf. bottom

CASING CEMENTED 7" SIZE 1665 No. FT. 10-17-83 Date
75SK
 NAME OF SERVICE COMPANY B.J. HUGHES
 COAL WAS ENCOUNTERED AT _____ FEET _____ INCHES
 _____ FEET _____ INCHES FEET _____ INCHES
 _____ FEET _____ INCHES FEET _____ INCHES

Drillers' Names FALCON DRILLING RIC#2

Remarks: DRILLING @ 1793 ASK REP. FROM FALCON TO MAINTAIN ACCESS ROAD - THIS IS #2ND WARNING TO OPEN UP DRAINAGE ~~DITCHES~~ DITCHES

10-18-83
DATE

Jerry W. [Signature]
02/16/2024
DISTRICT WELL INSPECTOR

STATE OF WEST VIRGINIA
DEPARTMENT OF MINES
OIL AND GAS WELLS DIVISION
INSPECTOR'S PLUGGING REPORT

Permit No. _____

Well No. _____

COMPANY _____ ADDRESS _____

FARM _____ DISTRICT _____ COUNTY _____

Filling Material Used _____

Liner	Location	Amount	Packer	Location		
PLUGS USED AND DEPTH PLACED			BRIDGES	CASING AND TUBING		
CEMENT-THICKNESS	WOOD-SIZE	LEAD	CONSTRUCTION-LOCATION	RECOVERED	SIZE	LOST

Drillers' Names _____

Remarks: _____

DATE _____ I hereby certify I visited the above well on this date.

STATE OF WEST VIRGINIA
DEPARTMENT OF MINES
OIL AND GAS WELLS DIVISION

RECEIVED

OCT 24 1983

OIL & GAS DIVISION
DEPT. OF MINES

INSPECTOR'S WELL REPORT

Permit No. 039-3986

Oil or Gas Well _____
(KIND)

Company RUBIN RESOURCES
 Address CHARLESTON W.VA.
 Farm UNION CARBIDE
 Well No. KCS-8
 District ELK County KANAWHA
 Drilling commenced 10-10-83
 Drilling completed 10-21-83 Total depth 4430
 Date shot _____ Depth of shot _____
 Initial open flow _____ /10ths Water in _____ Inch
 Open flow after tubing _____ /10ths Merc. in _____ Inch
 Volume _____ Cu. Ft.
 Rock pressure _____ lbs. _____ hrs.
 Oil _____ bbls., 1st 24 hrs.
 Fresh water _____ feet _____ feet
 Salt water _____ feet _____ feet

CASING AND TUBING	USED IN DRILLING	LEFT IN WELL	PACKERS
Size			
16			Kind of Packer _____
13			
10			Size of _____
8 1/4			
6 3/8			Depth set _____
5 3/16			
3			Perf. top _____
2			Perf. bottom _____
Liners Used			Perf. top _____
			Perf. bottom _____

CASING CEMENTED _____ SIZE _____ No. FT. _____ Date _____

NAME OF SERVICE COMPANY _____

COAL WAS ENCOUNTERED AT _____ FEET _____ INCHES

_____ FEET _____ INCHES _____ FEET _____ INCHES

_____ FEET _____ INCHES _____ FEET _____ INCHES

Drillers' Names FALCON RIG # 2

Remarks: RAN 4420' 4 1/2 CEMENT BY B.J. HUGHES
TD 11:AM.

10-21-83

DATE

Jerry W. [Signature]
02/16/2024
DISTRICT WELL INSPECTOR

STATE OF WEST VIRGINIA
DEPARTMENT OF MINES
OIL AND GAS WELLS DIVISION

INSPECTOR'S PLUGGING REPORT

Permit No. _____

Well No. _____

COMPANY _____ ADDRESS _____

FARM _____ DISTRICT _____ COUNTY _____

Filling Material Used _____

Liner		Location	Amount	Packer	Location		
PLUGS USED AND DEPTH PLACED			BRIDGES		CASING AND TUBING		
CEMENT-THICKNESS	WOOD-SIZE	LEAD	CONSTRUCTION-LOCATION		RECOVERED	SIZE	LOST

Drillers' Names _____

Remarks: _____

DATE _____ I hereby certify I visited the above well on this date.



State of West Virginia
Department of Mines
Oil and Gas Division
Charleston 25305

RECEIVED
AUG 27 1984
OIL & GAS DIVISION
DEPT. OF MINES

FINAL INSPECTION REPORT
INSPECTORS COMPLIANCE REPORT
June 6, 1984

COMPANY Rubin Resources, Inc.
1007C Bridge Road
Charleston, West Virginia 25314

PERMIT NO 039-3986
FARM & WELL NO Carbide, KCS #8
DIST. & COUNTY Elk/Kanawha

RULE	DESCRIPTION	IN COMPLIANCE	
		YES	NO
23.06	Notification Prior to Starting Work	_____	_____
25.04	Prepared before Drilling to Prevent Waste	_____	_____
25.03	High-Pressure Drilling	_____	_____
16.01	Required Permits at Wellsite	_____	_____
15.03	Adequate Fresh Water Casing	_____	_____
15.02	Adequate Coal Casing	_____	_____
15.01	Adequate Production Casing	_____	_____
15.04	Adequate Cement Strenght	_____	_____
15.05	Cement Type	_____	_____
23.02	Maintained Access Roads	_____	_____
25.01	Necessary Equipment to Prevent Waste	_____	_____
23.04	Reclaimed Drilling Pits	_____	_____
23.05	No Surface or Underground Pollution	_____	_____
23.07	Requirements for Production & Gathering Pipelines	_____	_____
16.01	Well Records on Site	_____	_____
16.02	Well Records Filed	_____	_____
7.05	Identification Markings	_____	_____

I HAVE INSPECTED THE ABOVE CAPTIONED WELL AND RECOMMEND THAT IT BE RELEASED:

SIGNED Loel Dillon
DATE 8/20/84

Your well record was received and reclamation requirements approved. In accordance with Chapter 22, Article 4, Section 2, the above well will remain under bond coverage for the life of the well.

T. H. ...
Administrator-Oil & Gas Division
September 12, 1984

DATE

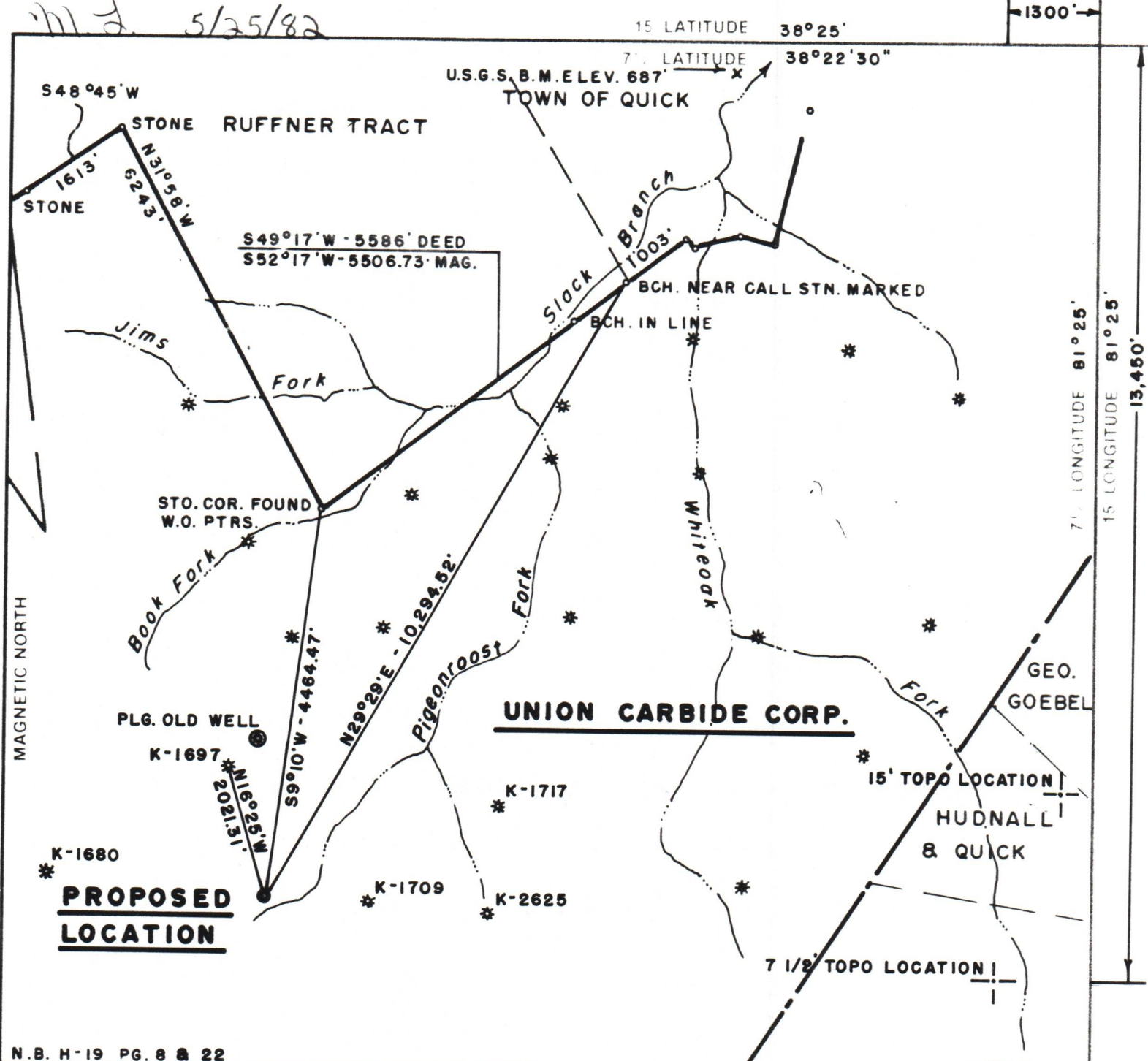

N.B. H-19 PG. 8 & 22

FILE NO KCS-8
 MAP NO QUICK QUAD.
 SCALE 1" = 2000'
 MINIMUM DEGREE OF ACCURACY 1:2500
 PROVEN SOURCE OF ELEVATION U.S.G.S. B.M. SHOWN
EL. 687'

I THE UNDERSIGNED HEREBY CERTIFY THAT THIS PLAT IS CORRECT TO THE BEST OF MY KNOWLEDGE AND BELIEF AND SHOWS ALL THE INFORMATION REQUIRED BY LAW AND THE REGULATIONS ISSUED AND PRESCRIBED BY THE DEPARTMENT OF MINES.
 (SIGNED) Harry L. Berger Jr.
 HARRY L. BERGER JR. L.L.S. 248

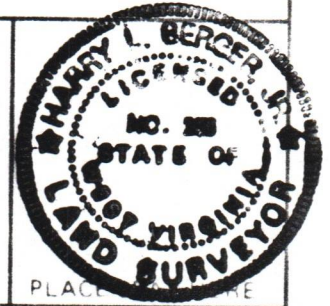

(+) DENOTES LOCATION OF WELL ON UNITED STATES TOPOGRAPHIC MAPS
 FORM IV-6 (878)



DATE MAY 20 19 82
 OPERATOR'S WELL NO KCS-8
 API WELL NO 47-039-3986
 STATE COUNTY PERMIT

STATE OF WEST VIRGINIA
 DEPARTMENT OF MINES
 OIL AND GAS DIVISION

WELL TYPE OIL GAS LIQUID INJECTION WASTE DISPOSAL
 (IF "GAS") PRODUCTION STORAGE DEEP SHALLOW
 LOCATION ELEVATION 1199.86' WATER SHED PIGEONROOST FORK
 DISTRICT ELK COUNTY KANAWHA
 QUADRANGLE 7 1/2' QUICK & 15' CLENDENIN S.W.

SURFACE OWNER UNION CARBIDE CORP. ACREAGE 2389
 OIL & GAS ROYALTY OWNER UNION CARBIDE CORP. LEASE ACREAGE 2389
 LEASE NO _____

02/16/2024

PROPOSED WORK DRILL CONVERT DRILL DEEPER REDRILL FRACTURE OR STIMULATE PLUG OFF OLD FORMATION PERFORATE NEW FORMATION OTHER PHYSICAL CHANGE IN WELL (SPECIFY) _____

PLUG AND ABANDON CLEAN OUT AND REPLUG
 TARGET FORMATION BROWN SHALE ESTIMATED DEPTH 4545'
 OPERATOR Rubin Resources, Inc. AGENT Rick RUBIN
 ADDRESS 1007 C Bridge Road ADDRESS 1007 C Bridge Road
Charleston, W.Va. 25314 CHARLESTON, WV 25314

Kan 3986