



1) Date: September 26, 19 84  
 2) Operator's Well No. Shonk Land Co. #34  
 3) API Well No. 47 039 4089  
 State County Permit

STATE OF WEST VIRGINIA  
 DEPARTMENT OF MINES, OIL AND GAS DIVISION  
 APPLICATION FOR A WELL WORK PERMIT

4) WELL TYPE: A Oil  / Gas  /  
 B (If "Gas", Production  / Underground storage  / Deep  / Shallow  )  
 5) LOCATION: Elevation: 1322' Watershed: Ten Mile Fork of Cabin Creek  
 District: Cabin Creek County: Kanawha Quadrangle: Eskdale  
 6) WELL OPERATOR Cabot Oil & Gas Corp. of WV 7) DESIGNATED AGENT H. Baird Whitehead  
 Address P.O. Box 628 Address P.O. Box 628  
Charleston, WV 25322 Charleston, WV 25322  
 8) OIL & GAS INSPECTOR TO BE NOTIFIED 9) DRILLING CONTRACTOR:  
 Name Rodney G. Dillon Name UNKNOWN  
 Address P.O. Box 7 Address \_\_\_\_\_  
Williamstown, WV 26187 375-3747

10) PROPOSED WELL WORK: Drill  / Drill deeper  / Redrill  / Stimulate   
 Plug off old formation  / Perforate new formation   
 Other physical change in well (specify) \_\_\_\_\_  
 11) GEOLOGICAL TARGET FORMATION, Brown Shale, Gordon, Big Lime  
 12) Estimated depth of completed well, 4860 feet  
 13) Approximate strata depths: Fresh, 322, 337 feet; salt, \_\_\_\_\_ feet.  
 14) Approximate coal seam depths: 272 (solid) 337 (solid) coal being mined in the area? Yes  No

RECEIVED  
 OCT 0 1984  
 OIL & GAS DIVISION  
 DEPT. OF MINES

15) CASING AND TUBING PROGRAM

CASING OR TUBING TYPE	SPECIFICATIONS					FOOTAGE INTERVALS		CEMENT FILL-UP OR SACKS (Cubic feet)	PACKERS
	Size	Grade	Weight per ft.	New	Used	For drilling	Left in well		
Conductor	16"		65	X		30	30	10 sks.	Kinds
Fresh water									
Coal									Sizes
Intermediate	8-5/8"		24	X		1600	1600	420 sks. CTC	Neat
Production	5-1/2"		15.50	X		4820	4820	285 sks. or	Depths set
Tubing								as req. by	Rule 15.01
Liners									Perforations:
									Top Bottom

OFFICE USE ONLY  
 DRILLING PERMIT

Permit number 47-039-4089 Date November 14 19 84

This permit covering the well operator and well location shown below is evidence of permission granted to drill in accordance with the pertinent legal requirements subject to the conditions contained herein and on the reverse hereof. **Notification must be given to the District Oil and Gas Inspector, (Refer to No. 8) Prior to the construction of roads, locations and pits for any permitted work.** In addition, the well operator or his contractor shall notify the proper district oil and gas inspector 24 hours before actual permitted work has commenced.)

The permitted work is as described in the Notice and Application, plat, and reclamation plan, subject to any modifications and conditions specified on the reverse hereof.  
 Permit expires November 14, 1986 unless well work is commenced prior to that date and prosecuted with due diligence.

Bond: <u>30</u>	Agent: <u>mt</u>	Plat: <u>T9</u>	Casing: <u>T9</u>	Fee: <u>013-859</u>
-----------------	------------------	-----------------	-------------------	---------------------

*[Signature]*  
 Administrator, Office of Oil and Gas





OFFICE USE ONLY

PERMIT MODIFICATIONS AND CONDITIONS (IF ANY) TO THE PROPOSED WELL WORK

RECEIVED  
DEPT. OF MINES  
OIL & GAS DIVISION

8130

Well No.	Depth	Interval	Permit No.	Permit Date	Permit Status	Permit Type
10	30	30	X	05		18"
150	1000	1000	X	24		8-3/8"
288	4820	4820	X	15.20		5-1/2"

OFFICE USE ONLY

This part of Form IV-2(b) is to record the dates of certain occurrences and any follow-up inspections.

	Date	Date(s)
Application received		
Well work started	November 14	" "
Completion of the drilling process		" "
Well Record received		" "
Reclamation completed		November 14, 1986

OTHER INSPECTIONS

Reason: \_\_\_\_\_  
Reason: \_\_\_\_\_

30  
11/14/86  
12/1/86



# CABOT OIL & GAS CORPORATION OF WEST VIRGINIA

SHONK LAND COMPANY #34 .

QUADRANGLE: Eskdale

COUNTY: Kanawha  
scale: 1"=2000'

DISTRICT: Cabin Creek  
contour interval: 40'

**KOLB ENTERPRISES Ltd.**  
CHARLESTON, W. VA.

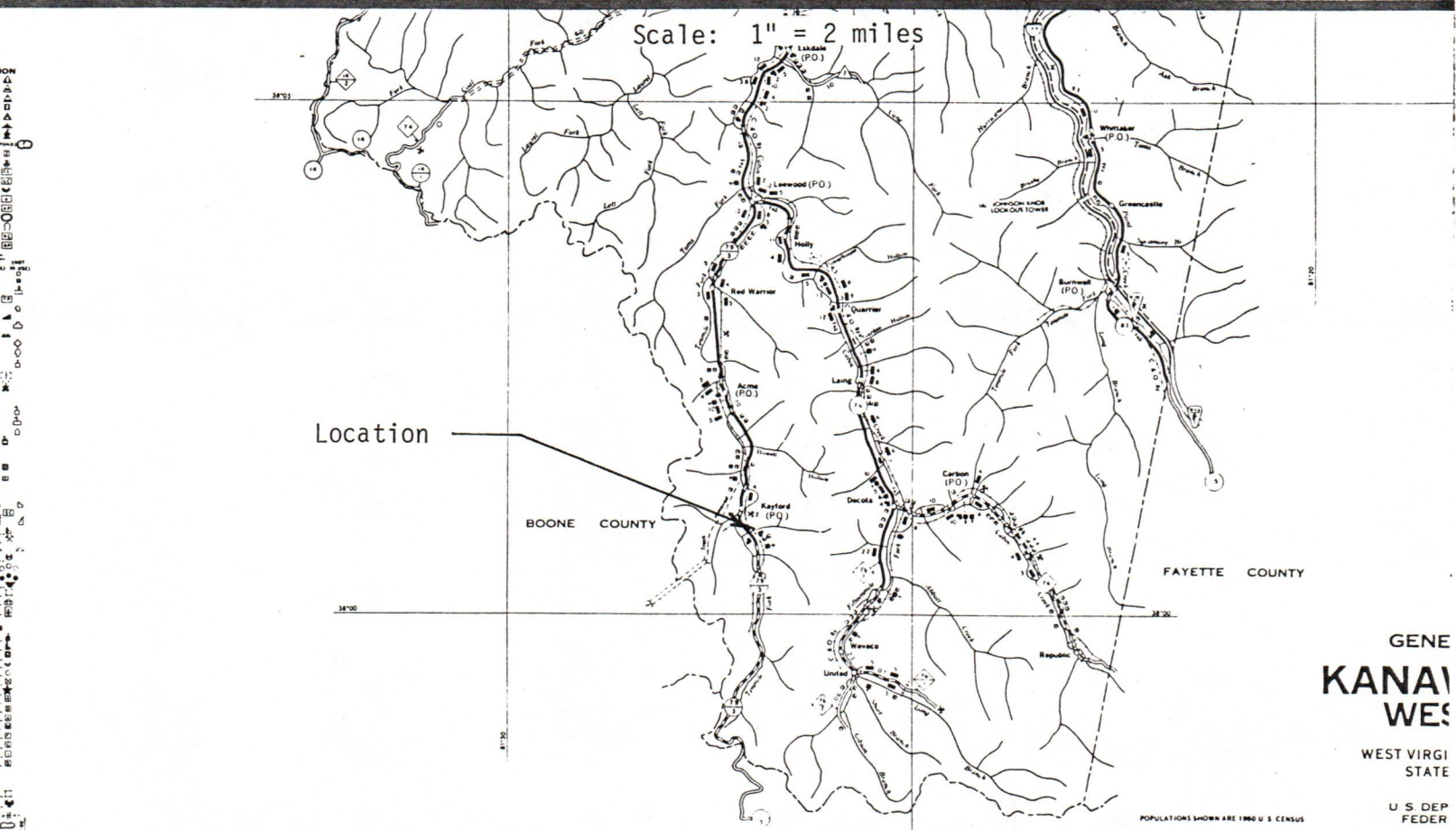
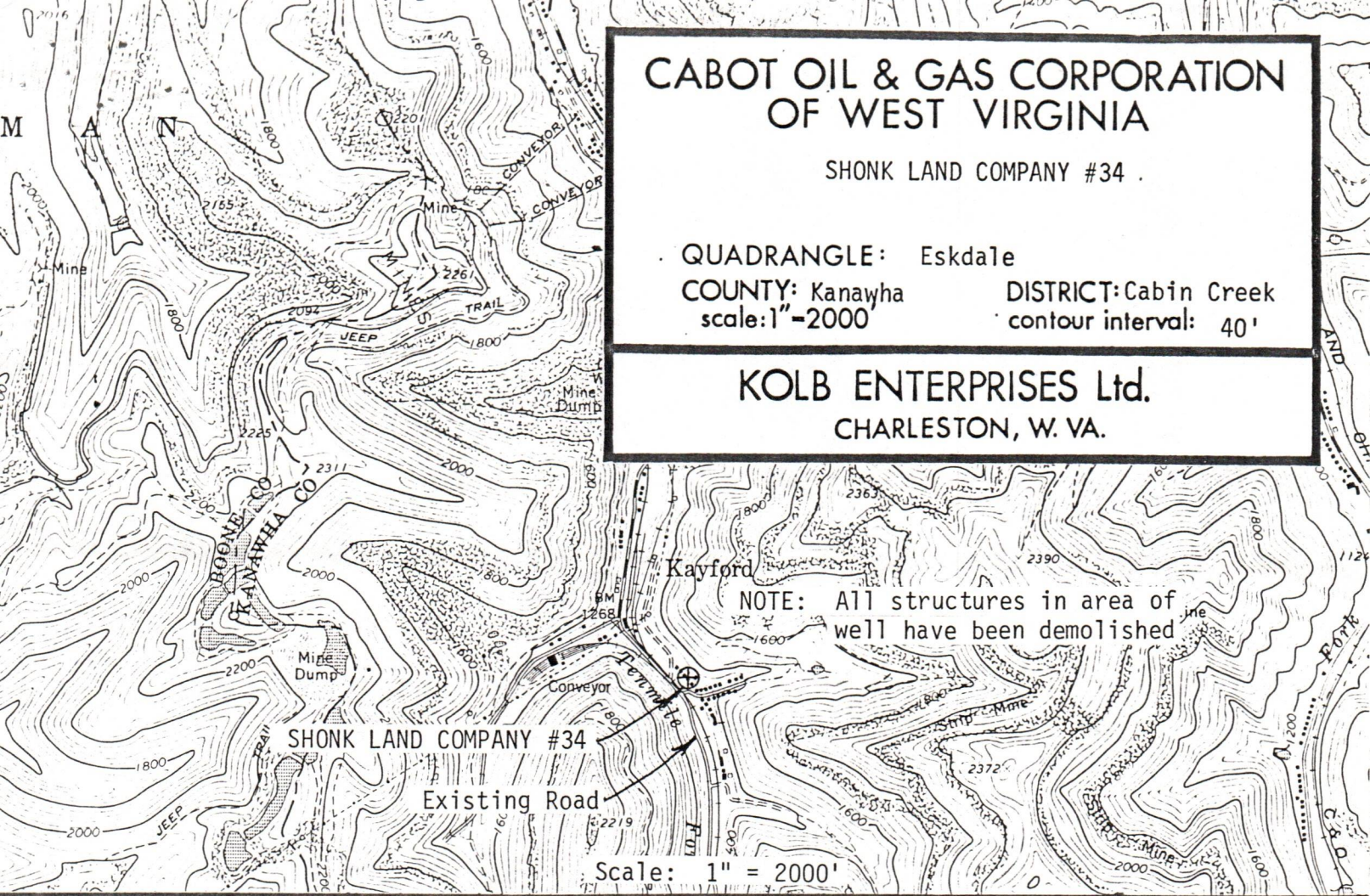

POPULATIONS SHOWN ARE 1980 U.S. CENSUS  
MILEAGES SHOWN ARE BETWEEN  
ADJACENT TOWNS AND DISTRICT SEATS  
THIS MAP IS DERIVED FROM U.S.G.S. TOPOGRAPHIC MAPS  
AERIAL PHOTOGRAPHS, HIGHWAY PLANS AND OTHER  
INFORMATION. BIENNIAL REVISIONS ARE MADE TO ROAD  
LOCATIONS, SURFACE TYPES, BOUNDARY LINES, POST  
OFFICES, PLACE NAMES AND OTHER NON-CULTURAL  
FEATURES. MODUS DE CULTURE BY FIELD SURVEY IN 1972.  
LAST REVISION DATE

1/27/2023





1) Date: September 26, 19 84  
 2) Operator's Well No. Shonk Land Co. #34  
 3) API Well No. 47 039 4089  
 State            County            Permit           

STATE OF WEST VIRGINIA  
 DEPARTMENT OF MINES, OIL AND GAS DIVISION  
APPLICATION FOR A WELL WORK PERMIT

- 4) WELL TYPE: A Oil            / Gas X /  
 B (If "Gas", Production            / Underground storage            / Deep            / Shallow X /)
- 5) LOCATION: Elevation: 1322' Watershed: Ten Mile Fork of Cabin Creek  
 District: Cabin Creek County: Kanawha Quadrangle: Eskdale
- 6) WELL OPERATOR Cabot Oil & Gas Corp. of WV 7) DESIGNATED AGENT H. Baird Whitehead  
 Address P.O. Box 628 Address P.O. Box 628  
Charleston, WV 25322 Charleston, WV 25322
- 8) OIL & GAS INSPECTOR TO BE NOTIFIED 9) DRILLING CONTRACTOR:  
 Name Rodney G. Dillon Name UNKNOWN  
 Address P.O. Box 7 Address             
Williamstown, WV 26187 375-3747
- 10) PROPOSED WELL WORK: Drill X / Drill deeper            / Redrill            / Stimulate            /  
 Plug off old formation            / Perforate new formation            /  
 Other physical change in well (specify)
- 11) GEOLOGICAL TARGET FORMATION, Brown Shale, Gordon, Big Lime
- 12) Estimated depth of completed well, 4860 feet
- 13) Approximate strata depths: Fresh, 322, 337 feet; salt,            feet.
- 14) Approximate coal seam depths: 272 (solid) 337 (solid) Is coal being mined in the area? Yes            / No X /

15) CASING AND TUBING PROGRAM

CASING OR TUBING TYPE	SPECIFICATIONS					FOOTAGE INTERVALS		CEMENT FILL-UP OR SACKS (Cubic feet)	PACKERS
	Size	Grade	Weight per ft.	New	Used	For drilling	Left in well		
Conductor	16"		65	X		30	30	10 sks.	Kinds
Fresh water									
Coal									Sizes
Intermediate	8-5/8"		24	X		1600	1600	420 sks. CT	Neat
Production	5-1/2"		15.50	X		4820	4820	285 sks. o	Depths set
Tubing								as req. by	rule 15.01
Liners									Perforations:
									Top Bottom

INSTRUCTIONS TO COAL OPERATOR, OWNER, OR LESSEE

The named coal operator, coal owner(s), and coal lessee are hereby notified that any objection they wish to make or are required to make by Code §22-4-3 must be filed with the Department of Mines within fifteen (15) days after the receipt of this Application by the Department.

The following waiver must be completed by the coal operator and by any coal owner or coal lessee who has recorded a declaration under Code §22-4-20, if the permit is to be issued within fifteen (15) days of the filing of the Application.

WAIVER

The undersigned coal operator            / owner            / lessee            / of the coal under this well location has examined this proposed well location. If a mine map exists which covers the area of the well location, the well location has been added to the mine map. The undersigned has no objection to the work proposed to be done at this location, provided, the well operator has complied with all applicable requirements of the West Virginia Code and the governing regulations.

Date:           , 19             
 By             
 Its           

12/01/2023  
 Coal Owner





1) Date: September 26, 19 84  
 2) Operator's Well No. Shonk Land Co. #34  
 3) API Well No. 47 039 4089  
 State County Permit

STATE OF WEST VIRGINIA  
 DEPARTMENT OF MINES, OIL AND GAS DIVISION  
 APPLICATION FOR A WELL WORK PERMIT

- 4) WELL TYPE: A Oil  / Gas  /  
 B (If "Gas", Production  / Underground storage  / Deep  / Shallow  /)
- 5) LOCATION: Elevation: 1322' Watershed: Ten Mile Fork of Cabin Creek  
 District: Cabin Creek County: Kanawha Quadrangle: Eskdale
- 6) WELL OPERATOR Cabot Oil & Gas Corp. of WV 7) DESIGNATED AGENT H. Baird Whitehead  
 Address P.O. Box 628 Address P.O. Box 628  
Charleston, WV 25322 Charleston, WV 25322
- 8) OIL & GAS INSPECTOR TO BE NOTIFIED Name Rodney G. Dillon 9) DRILLING CONTRACTOR: Name UNKNOWN  
 Address P.O. Box 7 Address \_\_\_\_\_  
Williamstown, WV 26187 375-3747
- 10) PROPOSED WELL WORK: Drill  / Drill deeper  / Redrill  / Stimulate   
 Plug off old formation  / Perforate new formation   
 Other physical change in well (specify) \_\_\_\_\_
- 11) GEOLOGICAL TARGET FORMATION, Brown Shale, Gordon, Big Lime  
 12) Estimated depth of completed well, 4860 feet  
 13) Approximate strata depths: Fresh, 322, 337 feet; salt, \_\_\_\_\_ feet.  
 14) Approximate coal seam depths: 272 (solid) 337 (solid) Is coal being mined in the area? Yes  No

RECEIVED  
 OCT 9 1984 X

15) CASING AND TUBING PROGRAM

CASING OR TUBING TYPE	SPECIFICATIONS					FOOTAGE INTERVALS		CEMENT FILL-UP OR SACKS (Cubic feet)	PACKERS DEPT. OF MINES
	Size	Grade	Weight per ft.	New	Used	For drilling	Left in well		
Conductor	16"		65	X		30	30	10 sks.	Kinds
Fresh water									
Coal									Sizes
Intermediate	8-5/8"		24	X		1600	1600	420 sks. CT, neat	Heats
Production	5-1/2"		15.50	X		4820	4820	285 sks. o	Depths set
Tubing								as req. by rule 15.01	
Liners									Perforations:
									Top Bottom

The law requires a comment period for surface owners. However, the permit can be issued in less than 15 days from the filing of the Application if the surface owner(s) of record sign(s) the following "Voluntary Statement of No Objection" on a facsimile of this surface owner's copy of the Application.

VOLUNTARY STATEMENT OF NO OBJECTION

I hereby state that I have read the instructions to surface owners on the reverse side of this Application for a Well Work Permit, and that I have received copies of (1) a Notice of Application for a Well Work Permit on Form IV-2(A), (2) an Application for a Well Work Permit on Form IV-2(B), (3) a survey plat on Form IV-6, and (4) a Construction and Reclamation Plan on Form IV-9, all for proposed well work on my surface land as described therein.  
 I further state that I have no objection to the planned work described in these materials, and I have no objection to a permit being issued based on those materials.

November 14, 1986

(For execution by corporation, partnership, etc.)

(For execution by natural persons)

NAME: \_\_\_\_\_  
 By \_\_\_\_\_  
 Its \_\_\_\_\_ Date \_\_\_\_\_

\_\_\_\_\_  
 (Signature) Date: \_\_\_\_\_  
 \_\_\_\_\_  
 (Signature) Date: \_\_\_\_\_

12/01/2023  
 Surface Owner





**INSTRUCTIONS TO SURFACE OWNERS  
AND  
EXPLANATION OF METHODS AND TIME LIMITS TO COMMENT  
ON OIL AND GAS WELL WORK PERMIT**

The well operator named in the Notice and this Application and the attached materials is applying for a permit from the State to do oil or gas well drilling or other well work. You are being served with these materials because surface owners have the right to file comments before the permit is issued. (NOTE: If the surface tract is owned by more than three persons, in multiple heirship for example, then these materials were served on you because your name appeared on the Sheriff's tax ticket on the land or because you actually occupy the surface tract. In either case, you may be the only owner who will actually receive these materials.) See Chapter 22, Article 4 of the W. Va. Code. Permits are valid for 24 months.

If you do not own any interest in the surface tract, please forward these materials to the true owner immediately if you know who it is. Also, please notify the well operator named in the materials and the Administrator of the Office of Oil and Gas in the West Virginia Department of Mines immediately.

**NOTE: You are not required to file any comment at all.**

**Where to file comments and obtain additional information:**

Administrator of the Office of Oil and Gas  
West Virginia Department of Mines  
1615 Washington Street East  
Charleston, West Virginia 25311  
(304) 348-2057

**Who may file comments?** If you wish to file comments, you must be an owner of record of (1) an interest in the surface tract on which the well already is or is about to be located, or (2) an interest in any other surface tract under the same oil or gas lease which will be utilized for roads or other land disturbances.

**Time limits for comments.** The law requires these materials to be delivered on or before the date the operator files his Application. You have **FIFTEEN (15) DAYS** after the filing date to file your comments as provided in **Methods for Filing Comments** below. You may call the Administrator's office at the above telephone number to be sure of the date. However, if you have been contacted by the well operator, and if you have signed a "voluntary statement of no objection" to any of the planned work described in these materials, then the permit may be issued at any time.

**Comments must be in writing.** Your comments must include your name, address and telephone number, the well operator's name and well number, and the approximate location of the proposed well site including district and county from the application. You may add other documents, such as sketches, maps or photographs to support your comments.

**Methods for filing comments.** Comments must be filed in person or received in the mail at the Administrator's office by the time stated above. Check with your postmaster to ensure adequate delivery time or to arrange special expedited handling.

The Administrator for Oil and Gas has the power to deny or condition a well work permit based on your comments on the following grounds:

- “(1) The proposed well work will constitute a hazard to the safety of persons; or
- “(2) The plan for soil erosion and sediment control is not adequate or effective; or
- “(3) Damage would occur to publicly owned lands or resources; or
- “(4) The proposed well work fails to protect fresh water sources or supplies.”

**If you want a copy of the permit** as it is finally issued, or a copy of the order denying the permit, you should request a copy from the Administrator.

**List of Water Testing Laboratories.** The Administrator maintains a list of water testing laboratories which you can hire to test your water to establish water quality prior to and after drilling. Contact the Administrator's office or an Oil and Gas Inspector to obtain a copy of the list.

**12/01/2023**  
Surface Owner



1) Date: September 26, 1984  
 2) Operator's  
 Well No. Shonk Land Co. #34  
 3) API Well No. 47 039 4089  
 State County Permit

STATE OF WEST VIRGINIA  
 DEPARTMENT OF MINES, OFFICE OF OIL & GAS

NOTICE OF APPLICATION FOR A WELL WORK PERMIT

4) SURFACE OWNER(S) OF RECORD TO BE SERVED

(i) Name Shonk Land Co., Ltd.  
 Address P.O. Box 969  
Charleston, West Virginia 25325

(ii) Name \_\_\_\_\_  
 Address \_\_\_\_\_

(iii) Name \_\_\_\_\_  
 Address \_\_\_\_\_

5(i) COAL OPERATOR Loss-Hamilton Coal Co.  
 Attn: Marty Burke  
 Address P.O. Box 175  
Hansford, WV 25103

5(ii) COAL OWNER(S) WITH DECLARATION ON RECORD:  
 Name Shonk Land Co., Ltd.  
 Address P.O. Box 969  
Charleston, West Virginia 25325

Name \_\_\_\_\_  
 Address \_\_\_\_\_

5(iii) COAL LESSEE WITH DECLARATION ON RECORD:

P 753 224 491

ress \_\_\_\_\_  
 \_\_\_\_\_

RECEIPT FOR CERTIFIED MAIL

NO INSURANCE COVERAGE PROVIDED  
 NOT FOR INTERNATIONAL MAIL

(See Reverse)

TO THE PERSON(S) NAME

- (1) The Application to be plugged and described and cemented
- (2) The plat
- (3) The Construction and Reclamation Plan

THE REASON YOU WHICH ARE SUMMARIZED (FORM IV-2(B) OR FORM IV-2(C)) ACTION AT ALL.

Take notice that the operator proposes to for a Well Work Permit Department of Mines and depicted on attached Construction and Reclamation Plan by hand to the person before the day of month

6) EXTRACTION RIGHTS

- Check and provide the following information:  
 Included is the information I hold the right to  
 The requirements of the Act

7) ROYALTY PROVISION

Is the right to or other contract for compensation to the volume of

If the answer is Yes, you may use Affirmation

Sent to <u>Loss-Hamilton Coal Co.</u>	
Street and No. Attn: <u>Marty Burke</u>	
<u>P.O. Box 175</u>	
P.O., State and ZIP Code <u>Hansford, WV 25103</u>	
Postage	\$
Certified Fee	75
Special Delivery Fee	
Restricted Delivery Fee	
Return Receipt Showing to whom and Date Delivered	60
Return receipt showing to whom, Date, and Address of Delivery	
TOTAL Postage and Fees	\$
Postmark of Date	

and the following documents:

- Form IV-4 if the well is drilling or other work,
- the proposed casing and

Form IV-6; and  
 the well work is only to implement control and for

THE REASON YOU WHICH ARE SUMMARIZED (FORM IV-2(B) OR FORM IV-2(C)) ACTION AT ALL.

the undersigned well operator and accompanying documents and Gas, West Virginia depicted on attached Application, the plat, and the or certified mail or delivered in circumstances) on or

RECEIVED  
 OCT 0 1984

to or contracts by which  
 reverse side for specifics.)

d upon a lease or leases or any similar provision is not inherently related ? Yes No

d. If the answer is Yes,

OIL & GAS DIVISION  
 DEPT. OF MINES

See the reverse side for line item instructions, and for instructions concerning the required copies of the Notice and Application, plat, and Construction and Reclamation Plan.

The truth of the information on the Notice and Application is verified and sworn to and the Notice is signed on behalf of the Well Operator in my County and State by

H. Baird Whitehead  
 this 26 day of September, 1984.  
 My commission expires March 5, 1989.

Roune Miller  
 Notary Public, Kanawha County,  
 State of West Virginia

WELL

OPERATOR CABOT OIL & GAS CORPORATION OF WV

By H. Baird Whitehead  
 Its Regional Manager, Drilling & Production  
 Address P.O. Box 628  
Charleston, WV 25322  
 Telephone (304) 347-1600

12/01/2023



I N T E R N A T I O N A L  
P 753 224 490

CONCERNING THE LINE ITEMS:

- 1) Date of Notice.
- 2) Your well name a
- 3) To be filled out
- 4) & 5) Use separate she
- 4) Surface owner(s) see also Code § co-owners of int in such lands".
- 5(i) "Coal Operator" corporation th
- 5(ii, iii) See Code § 22-4.
- 6) See Code § 22-4 tinuing contrac provided below.
- 7) See Code § § 22

**RECEIPT FOR CERTIFIED MAIL**

NO INSURANCE COVERAGE PROVIDED  
NOT FOR INTERNATIONAL MAIL

(See Reverse)

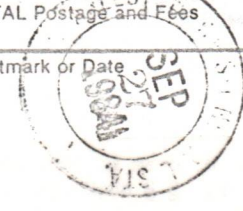
Sent to <b>Shonk Land Co., Ltd.</b>	
Street and No. <b>P.O. Box 969</b>	
P.O. State and ZIP Code <b>Charleston, WV 25325</b>	
Postage	\$
Certified Fee	75
Special Delivery Fee	
Restricted Delivery Fee	
Return Receipt Showing to whom and Date Delivered	60
Return receipt showing to whom, Date, and Address of Delivery	
TOTAL Postage and Fees	\$
Postmark or Date 	

Application. However, in common or other s section hold interests nership association or p.

ase(s) or other com- mation in the space

original and required ministrator, accom- (ii) a bond in one of other security allowed 4-12b and Regulation quired by Code § 22-4-1a(c) ode § 22-4-8a from the posed well.

er(s) and the person(s) 22-4-2a, and 22-4-2b.

CONCERNING THE REQUIRED

Filing. Code § 22-4 copies of the Notice panied by (i) a plat the forms prescribex by Code § 22-4-1k(d) 23, (iv) unless prev and 22-3-12a, and (v) owner of any water s

Service. In additio with an interest in

PS Form 3800, Feb. 1982

INFORMATION SUPPLIED UNDER CODE § 22-4-11(d)

IN LIEU OF FILING LEASE(S) AND OTHER CONTINUING CONTRACT(S)

Under the oath required to make the verification on the obverse side of this Notice, I depose and say that I am the person who signed the Notice for the Applicant, and that--

- (1) the tract of land is the same tract described in the Application to which this Notice applies, partly or wholly depicted in the accompanying plat, and described in the Construction and Reclamation Plan;
- (2) the parties and recordation data (if recorded) for lease(s) or other continuing contract(s) by which the Applicant claims the right to extract, produce or market the oil or gas are as follows:

Grantor, lessor, etc.	Grantee, lessee, etc.	Royalty	Book	Page
Shonk Land Co.	Larner Gas Co.		9	528
Larner Gas Co.	Donald C. Shonk		83	407
Donald C. Shonk	Godfrey L. Cabot, Inc. (COGC of WV)	12.5%	83	479

(CURRENT ROYALTY OWNERS - SHONK LAND CO.)

12/01/2023





IV-35  
(Rev 8-81)

DIVISION OF OIL & GAS  
DEPT. OF ENERGY  
State of West Virginia  
Department of Mines  
Oil and Gas Division

Date October 28, 1985  
Operator's  
Well No. #34  
Farm Shonk Land Co.  
API No. 47 - 039 - 4089

WELL OPERATOR'S REPORT  
OF  
DRILLING, FRACTURING AND/OR STIMULATING, OR PHYSICAL CHANGE

WELL TYPE: Oil \_\_\_ / Gas X / Liquid Injection \_\_\_ / Waste Disposal \_\_\_ /  
(If "Gas," Production \_\_\_ / Underground Storage \_\_\_ / Deep \_\_\_ / Shallow X /)

LOCATION: Elevation: 1322' Watershed Ten Mile Fork of Cabin Creek  
District: Cabin Creek County Kanawha Quadrangle Eskdale

COMPANY Cabot Oil & Gas Corporation of WV  
ADDRESS P.O. Box 628, Charleston, WV 25322  
DESIGNATED AGENT David G. McCluskey  
ADDRESS P.O. Box 628, Charleston, WV 25322  
SURFACE OWNER Shonk Land Company, Ltd.  
ADDRESS P.O. Box 969, Charleston, WV 25325  
MINERAL RIGHTS OWNER Same as above  
ADDRESS \_\_\_\_\_  
OIL AND GAS INSPECTOR FOR THIS WORK Carlos W. Hively ADDRESS 223 Pinch Ridge Road Elkview, WV 25071  
PERMIT ISSUED November 14, 1984  
DRILLING COMMENCED 3/29/85  
DRILLING COMPLETED 4/15/85  
IF APPLICABLE: PLUGGING OF DRY HOLE ON CONTINUOUS PROGRESSION FROM DRILLING OR REWORKING. VERBAL PERMISSION OBTAINED ON \_\_\_\_\_

Casing & Tubing	Used in Drilling	Left in Well	Cement fill up Cu. ft.
Size <u>20x16 Cond.</u>	<u>28'</u>	<u>28'</u>	
<u>13-3/8</u>	<u>141'</u>	<u>141'</u>	<u>45 sks.</u>
<u>9 5/8</u>			
<u>8 5/8</u>	<u>1724'</u>	<u>1724'</u>	<u>460 sks.</u>
<u>7</u>			
<u>5 1/2</u>	<u>3249'</u>	<u>3249'</u>	<u>200 sks.</u>
<u>4 1/2</u>			
<u>3</u>			
<u>2x1 1/2</u>	<u>3147.79</u>	<u>3147.79'</u>	
<del>10x6</del> <del>8x6</del>	<u>Arrowdrill prod. pkr. @</u>		
	<u>2130' K.B.</u>		

GEOLOGICAL TARGET FORMATION Brown Shale, Gordon, Big Lime Gordon 3170-3181 Depth BL 2200-2452 feet  
Depth of completed well 3260 feet Rotary X / Cable Tools \_\_\_\_\_  
Water strata depth: Fresh 2, 81, 222 feet; Salt ---- feet,  
Coal seam depths: 122-125 Is coal being mined in the area? NO

OPEN FLOW DATA  
Producing formation Big Lime & Gordon Gordon 3172-3180 Pay zone depth BL 2219-2403 feet  
Gas: Initial open flow --- Mcf/d Oil: Initial open flow --- Bbl/d  
6 hr. Final open flow 492 Mcf/d Final open flow --- Bbl/d  
Time of open flow between initial and final tests --- hours  
Static rock pressure 460 psig (surface measurement) after --- hours shut in  
(If applicable due to multiple completion--)  
Second producing formation Maxton Pay zone depth 2045-2054 feet  
Gas: Initial open flow --- Mcf/d Oil: Initial open flow --- Bbl/d  
Final open flow TSTM Mcf/d Oil: Final open flow --- Bbl/d  
Time of open flow between initial and final tests --- hours  
Static rock pressure 285 psig (surface measurement) after --- hours shut in

(Continue on reverse side)

KAN 4089

12/01/2023



RECEIVED

DETAILS OF PERFORATED INTERVALS, FRACTURING OR STIMULATING, PHYSICAL CHANGE, ETC.

Perf Gordon from 3172-3180 (2 shot/ft - 10 holes). Treated Gordon w/90 Q foam, 50,000# 20/40 sand, 250 gals 15% HCL & 737,500 Scf/N<sub>2</sub>. B/D perfs @ 1560 psi. ISIP after B/D 1300 psi. Max sand concentration 1.5#/gal. AIR 4 BPM H<sub>2</sub>O, 20,000 Scf/min N<sub>2</sub>. ATP 2100 psi, Max 2190 psi. T/F 180 bbls., S/L 149.4 bbls. ISIP 1620 psi, 5 min. 1600 psi, 10 min 1540 psi, 15 min 1520 psi. Perf B. Lime 2219', 21', 2347', 48', 53', 55', 72'-78', 98', 99', 2400'-03' (19 holes). Treated B. Lime w/10,000 gals, 15% gelled acid & 57,280 Scf/N<sub>2</sub>. B/D perfs @ 2000 psi. ISIP after B/D 1950 psi. ATP 1700 psi. Max 2000 psi. ISIP 1670 psi, 15 min 1300 psi. Perforated Maxton from 2045-2054'. Treated Maxton. Water frac 30# gel system. B/D w/250 gals 15% HCL @ 1650 psi. AIR 6 BPM H<sub>2</sub>O w/200 Scf N<sub>2</sub>. Total rate 6 BPM. ATP 2600 psi. Max 3500 psi. Total sand 30,000# 20/40. Max conc 2.5#/gal. T/F 640 bbls. S/L 430 bbls. Total N<sub>2</sub> 114,000 Scf. ISIP 3400 psi, 5 min 2340 psi, 15 min 2100 psi. Set arrowdrill prod. pkr. @ 2130' KB.

WELL LOG

FORMATION	COLOR	HARD OR SOFT	TOP FEET	BOTTOM FEET	REMARKS
					Including indication of all fresh and salt water, coal, oil and gas
Surface Rock			0	30	
Sandstone			30	235	
Shale and Shells			235	520	
Siltstone			520	765	
1st Salt Sand			765	1300	
Shale			1300	1405	
2nd Salt Sand			1405	1464	
Sand and Shale			1464	1590	
Shale and Shells			1590	2020	
Lower Maxton			2020	2056	
Shale			2056	2058	
Little Lime			2058	2200	
Big Lime			2200	2452	
Shale			2452	2483	
Injun			2483	2507	
Shale			2507	2702	
Weir			2702	2707	
Shale			2707	2900	
Coffee Shale			2900	2945	
Berea Grit			2945	2987	
Shale			2987	3170	
Gordon			3170	3181	
Shale			3181	3259	
				TD 3260	

(Attach separate sheets as necessary)

CABOT OIL & GAS CORPORATION OF WEST VIRGINIA  
Well Operator

By: David H Mccluskey 12/01/2023  
Date: October 28, 1985

Note: Regulation 2.02(i) provides as follows:  
"The term 'log' or 'well log' shall mean a systematic detailed geological record of all formations, including coal, encountered in the drilling of a well."



STATE OF WEST VIRGINIA  
DEPARTMENT OF MINES  
OIL AND GAS WELLS DIVISION

RECEIVED

APR 1 - 1985

OIL & GAS DIVISION  
DEPT. OF MINES

INSPECTOR'S WELL REPORT

Permit No. 039-4089

Oil or Gas Well \_\_\_\_\_  
(KIND)

Company Cabot Oil & Gas

Address \_\_\_\_\_

Farm Shonk Land

Well No. Shonk #34

District Cabin Creek County Kanawha

Drilling commenced \_\_\_\_\_

Drilling completed \_\_\_\_\_ Total depth \_\_\_\_\_

Date shot \_\_\_\_\_ Depth of shot \_\_\_\_\_

Initial open flow \_\_\_\_\_ /10ths Water in \_\_\_\_\_ Inch

Open flow after tubing \_\_\_\_\_ /10ths Merc. in \_\_\_\_\_ Inch

Volume \_\_\_\_\_ Cu. Ft.

Rock pressure \_\_\_\_\_ lbs. \_\_\_\_\_ hrs.

Oil \_\_\_\_\_ bbls., 1st 24 hrs.

Fresh water \_\_\_\_\_ feet \_\_\_\_\_ feet

Salt water \_\_\_\_\_ feet \_\_\_\_\_ feet

CASING AND TUBING	USED IN DRILLING	LEFT IN WELL	PACKERS
Size			
16			Kind of Packer _____
13			
10			Size of _____
8 1/4			
6 3/8			Depth set _____
5 3/16			
3			Perf. top _____
2			Perf. bottom _____
Liners Used			Perf. top _____
			Perf. bottom _____

CASING CEMENTED \_\_\_\_\_ SIZE \_\_\_\_\_ No. FT. \_\_\_\_\_ Date \_\_\_\_\_

NAME OF SERVICE COMPANY \_\_\_\_\_

COAL WAS ENCOUNTERED AT \_\_\_\_\_ FEET \_\_\_\_\_ INCHES

\_\_\_\_\_ FEET \_\_\_\_\_ INCHES \_\_\_\_\_ FEET \_\_\_\_\_ INCHES

\_\_\_\_\_ FEET \_\_\_\_\_ INCHES \_\_\_\_\_ FEET \_\_\_\_\_ INCHES

Drillers' Names Smith Drilling Co. Rig # 8

Remarks: set 30' of conductor pipe + cemented to surface.

3-29-85  
DATE

Charles W. Hines  
12/01/2023  
DISTRICT WELL INSPECTOR







STATE OF WEST VIRGINIA  
DEPARTMENT OF MINES  
OIL AND GAS WELLS DIVISION

RECEIVED

APR 9 - 1985

INSPECTOR'S WELL REPORT OIL & GAS DIVISION  
DEPT. OF MINES

Permit No. 039-4089

Oil or Gas Well \_\_\_\_\_  
(KIND)

Company Cabot Oil & Gas

Address \_\_\_\_\_

Farm Shank Landco.

Well No. Shank #34

District Cabin Creek County Kanawha

Drilling commenced \_\_\_\_\_

Drilling completed \_\_\_\_\_ Total depth \_\_\_\_\_

Date shot \_\_\_\_\_ Depth of shot \_\_\_\_\_

Initial open flow \_\_\_\_\_ /10ths Water in \_\_\_\_\_ Inch

Open flow after tubing \_\_\_\_\_ /10ths Merc. in \_\_\_\_\_ Inch

Volume \_\_\_\_\_ Cu. Ft.

Rock pressure \_\_\_\_\_ lbs. \_\_\_\_\_ hrs.

Oil \_\_\_\_\_ bbls., 1st 24 hrs.

Fresh water \_\_\_\_\_ feet \_\_\_\_\_ feet

Salt water \_\_\_\_\_ feet \_\_\_\_\_ feet

CASING AND TUBING	USED IN DRILLING	LEFT IN WELL	PACKERS
Size			Kind of Packer _____
16			
13			
10			Size of _____
8 1/4			
6 3/8			Depth set _____
5 3/16			
3			Perf. top _____
2			Perf. bottom _____
Liners Used			Perf. top _____
			Perf. bottom _____

CASING CEMENTED \_\_\_\_\_ SIZE \_\_\_\_\_ No. FT. \_\_\_\_\_ Date \_\_\_\_\_

NAME OF SERVICE COMPANY \_\_\_\_\_

COAL WAS ENCOUNTERED AT \_\_\_\_\_ FEET \_\_\_\_\_ INCHES

\_\_\_\_\_ FEET \_\_\_\_\_ INCHES \_\_\_\_\_ FEET \_\_\_\_\_ INCHES

\_\_\_\_\_ FEET \_\_\_\_\_ INCHES \_\_\_\_\_ FEET \_\_\_\_\_ INCHES

Drillers' Names Smith Drilling Co Rig # 8

Remarks: Drilling at 850' + soaping hole.

2-4-85  
DATE

Carlson W. Hines  
DISTRICT WELL INSPECTOR 12/01/2023



Form 26  
2/16/82

RECEIVED  
OIL & GAS DIVISION

STATE OF WEST VIRGINIA  
DEPARTMENT OF MINES  
OIL AND GAS WELLS DIVISION

INSPECTOR'S PLUGGING REPORT

Permit No. \_\_\_\_\_ Well No. \_\_\_\_\_

COMPANY \_\_\_\_\_ ADDRESS \_\_\_\_\_

FARM \_\_\_\_\_ DISTRICT \_\_\_\_\_ COUNTY \_\_\_\_\_

Filling Material Used \_\_\_\_\_

Liner			Location	Amount	Packer	Location		
PLUGS USED AND DEPTH PLACED			BRIDGES		CASING AND TUBING			
CEMENT-THICKNESS	WOOD-SIZE	LEAD	CONSTRUCTION-LOCATION		RECOVERED	SIZE	LOST	

Drillers' Names \_\_\_\_\_

Remarks:

\_\_\_\_\_ I hereby certify I visited the above well on this date.  
DATE

\_\_\_\_\_  
DISTRICT WELL INSPECTOR 12/01/2023



STATE OF WEST VIRGINIA  
DEPARTMENT OF MINES  
OIL AND GAS WELLS DIVISION

RECEIVED  
APR 9 - 1985

OIL & GAS DIVISION  
INSPECTOR'S WELL REPORT  
DEPT. OF MINES

Permit No. 039-4089

Oil or Gas Well \_\_\_\_\_  
(KIND)

Company Cabot Oil & Gas

Address \_\_\_\_\_

Farm Shankland co.

Well No. Shank #34

District Cabin Creek County Kanawha

Drilling commenced \_\_\_\_\_

Drilling completed \_\_\_\_\_ Total depth \_\_\_\_\_

Date shot \_\_\_\_\_ Depth of shot \_\_\_\_\_

Initial open flow \_\_\_\_\_ /10ths Water in \_\_\_\_\_ Inch

Open flow after tubing \_\_\_\_\_ /10ths Merc. in \_\_\_\_\_ Inch

Volume \_\_\_\_\_ Cu. Ft.

Rock pressure \_\_\_\_\_ lbs. \_\_\_\_\_ hrs.

Oil \_\_\_\_\_ bbls., 1st 24 hrs.

Fresh water \_\_\_\_\_ feet \_\_\_\_\_ feet

Salt water \_\_\_\_\_ feet \_\_\_\_\_ feet

CASING AND TUBING	USED IN DRILLING	LEFT IN WELL	PACKERS
Size			Kind of Packer _____
16			
13			
10			Size of _____
8 1/4			
6 5/8			Depth set _____
5 3/16			
3			Perf. top _____
2			Perf. bottom _____
Liners Used			Perf. top _____
			Perf. bottom _____

CASING CEMENTED \_\_\_\_\_ SIZE \_\_\_\_\_ No. FT. \_\_\_\_\_ Date \_\_\_\_\_

NAME OF SERVICE COMPANY \_\_\_\_\_

COAL WAS ENCOUNTERED AT \_\_\_\_\_ FEET \_\_\_\_\_ INCHES

\_\_\_\_\_ FEET \_\_\_\_\_ INCHES \_\_\_\_\_ FEET \_\_\_\_\_ INCHES

\_\_\_\_\_ FEET \_\_\_\_\_ INCHES \_\_\_\_\_ FEET \_\_\_\_\_ INCHES

Drillers' Names Smith Drilling Co. Rig # 8

Remarks: 937' deep + Twisted off Drill pipe + Fishing for Tools.

4-5-85.  
DATE

Calvin High  
DISTRICT WELL INSPECTOR

12/01/2023



Form 26  
2/16/82

RECEIVED  
APR 9 1982  
OIL & GAS DIVISION  
DEPT. OF MINES

STATE OF WEST VIRGINIA  
DEPARTMENT OF MINES  
OIL AND GAS WELLS DIVISION

INSPECTOR'S PLUGGING REPORT

Permit No. \_\_\_\_\_

Well No. \_\_\_\_\_

COMPANY \_\_\_\_\_ ADDRESS \_\_\_\_\_

FARM \_\_\_\_\_ DISTRICT \_\_\_\_\_ COUNTY \_\_\_\_\_

Filling Material Used \_\_\_\_\_

Liner	Location		Amount	Packer	Location		
PLUGS USED AND DEPTH PLACED			BRIDGES		CASING AND TUBING		
CEMENT-THICKNESS	WOOD-SIZE	LEAD	CONSTRUCTION-LOCATION		RECOVERED	SIZE	LOST

Drillers' Names \_\_\_\_\_

Remarks:

\_\_\_\_\_ I hereby certify I visited the above well on this date.  
DATE

\_\_\_\_\_ 12/01/2023  
DISTRICT WELL INSPECTOR



STATE OF WEST VIRGINIA  
DEPARTMENT OF MINES  
OIL AND GAS WELLS DIVISION

RECEIVED

APR 17 1985

OIL & GAS DIVISION

INSPECTOR'S WELL REPORT DEPT. OF MINES

Permit No. 039-4089

Oil or Gas Well \_\_\_\_\_  
(KIND)

Company <u>Cabot Oil &amp; Gas</u>	CASING AND TUBING	USED IN DRILLING	LEFT IN WELL	PACKERS
	Address _____	Size		
Farm <u>Shonk &amp; Sons</u>	16			
Well No. <u>Shonk #34</u>	13			Size of _____
District <u>Cabin Creek</u> County <u>Kanawha</u>	10			
Drilling commenced _____	8 1/4			Depth set _____
Drilling completed _____ Total depth _____	6 3/8			
Date shot _____ Depth of shot _____	5 3/16			Perf. top _____
Initial open flow _____ /10ths Water in _____ Inch	3			Perf. bottom _____
Open flow after tubing _____ /10ths Merc. in _____ Inch	2			Perf. top _____
Volume _____ Cu. Ft.	Liners Used _____			Perf. bottom _____
Rock pressure _____ lbs. _____ hrs.	CASING CEMENTED _____ SIZE _____ No. FT. _____ Date _____			
Oil _____ bbls., 1st 24 hrs.	NAME OF SERVICE COMPANY _____			
Fresh water _____ feet _____ feet	COAL WAS ENCOUNTERED AT _____ FEET _____ INCHES			
Salt water _____ feet _____ feet	_____ FEET _____ INCHES _____ FEET _____ INCHES			

Drillers' Names Smith Drilling Co. Rig # 8

Remarks: Drilling 9+1293' + soaping hole.

4-8-85  
DATE

Carlos W. Hirsch  
12/01/2023  
DISTRICT WELL INSPECTOR



Form 26  
2/16/82

RECEIVED  
APR 17 1982  
OIL & GAS DIVISION  
DEPT. OF MINES

STATE OF WEST VIRGINIA  
DEPARTMENT OF MINES  
OIL AND GAS WELLS DIVISION  
INSPECTOR'S PLUGGING REPORT

Permit No. \_\_\_\_\_

Well No. \_\_\_\_\_

COMPANY \_\_\_\_\_ ADDRESS \_\_\_\_\_

FARM \_\_\_\_\_ DISTRICT \_\_\_\_\_ COUNTY \_\_\_\_\_

Filling Material Used \_\_\_\_\_

Liner			Location	Amount	Packer	Location		
PLUGS USED AND DEPTH PLACED			BRIDGES			CASING AND TUBING		
CEMENT-THICKNESS	WOOD-SIZE	LEAD	CONSTRUCTION-LOCATION			RECOVERED	SIZE	LOST

Drillers' Names \_\_\_\_\_

Remarks:

\_\_\_\_\_ I hereby certify I visited the above well on this date.  
DATE

\_\_\_\_\_  
DISTRICT WELL INSPECTOR

12/01/2023



STATE OF WEST VIRGINIA  
DEPARTMENT OF MINES  
OIL AND GAS WELLS DIVISION

RECEIVED  
APR 17 1985

OIL & GAS DIVISION

DEPT. OF MINES

INSPECTOR'S WELL REPORT

Permit No. 039-4089

Oil or Gas Well \_\_\_\_\_  
(KIND)

Company <u>Cabot Oil &amp; Gas</u> Address _____ Farm <u>Shank Land Co.</u> Well No. <u>Shank # 34</u> District <u>Cabin Creek &amp; County Kanawha</u> Drilling commenced _____ Drilling completed _____ Total depth _____ Date shot _____ Depth of shot _____ Initial open flow _____ /10ths Water in _____ Inch Open flow after tubing _____ /10ths Merc. in _____ Inch Volume _____ Cu. Ft. Rock pressure _____ lbs. _____ hrs. Oil _____ bbls., 1st 24 hrs. Fresh water _____ feet _____ feet Salt water _____ feet _____ feet	CASING AND TUBING	USED IN DRILLING	LEFT IN WELL	PACKERS
	Size			
	16			Kind of Packer _____
	13			
	10			Size of _____
	8 1/4			
	6 5/8			Depth set _____
	5 3/16			
	3			Perf. top _____
	2			Perf. bottom _____
Liners Used			Perf. top _____	
			Perf. bottom _____	

CASING CEMENTED \_\_\_\_\_ SIZE \_\_\_\_\_ No. FT. \_\_\_\_\_ Date \_\_\_\_\_

NAME OF SERVICE COMPANY \_\_\_\_\_

COAL WAS ENCOUNTERED AT \_\_\_\_\_ FEET \_\_\_\_\_ INCHES

\_\_\_\_\_ FEET \_\_\_\_\_ INCHES \_\_\_\_\_ FEET \_\_\_\_\_ INCHES

\_\_\_\_\_ FEET \_\_\_\_\_ INCHES \_\_\_\_\_ FEET \_\_\_\_\_ INCHES

Drillers' Names Smith Drilling Co - Rig # 8

Remarks: set 1714' of 8 5/8" casing + cemented with 460 SKS. class A 3% c.c. plug down at 9:45 p.m. 4-10-85. Today waiting on cement + working on Rig.

4-11-85  
DATE

Carlson H. Hight 12/01/2023  
DISTRICT WELL INSPECTOR



Form 26  
2/16/82

RECEIVED  
APR 17 1982  
OIL & GAS DIVISION  
DEPT. OF MINES

STATE OF WEST VIRGINIA  
DEPARTMENT OF MINES  
OIL AND GAS WELLS DIVISION  
**INSPECTOR'S PLUGGING REPORT**

Permit No. \_\_\_\_\_ Well No. \_\_\_\_\_

COMPANY \_\_\_\_\_ ADDRESS \_\_\_\_\_

FARM \_\_\_\_\_ DISTRICT \_\_\_\_\_ COUNTY \_\_\_\_\_

Filling Material Used \_\_\_\_\_

Liner			Location			Amount			Packer			Location		
PLUGS USED AND DEPTH PLACED			BRIDGES			CASING AND TUBING								
CEMENT-THICKNESS	WOOD-SIZE	LEAD	CONSTRUCTION-LOCATION			RECOVERED	SIZE	LOST						

Drillers' Names \_\_\_\_\_

Remarks: \_\_\_\_\_  
\_\_\_\_\_

\_\_\_\_\_ I hereby certify I visited the above well on this date.  
DATE

\_\_\_\_\_ 12/01/2023  
DISTRICT WELL INSPECTOR



STATE OF WEST VIRGINIA  
DEPARTMENT OF MINES  
OIL AND GAS WELLS DIVISION

RECEIVED

APR 22 1985

INSPECTOR'S WELL REPORT

OIL & GAS DIVISION

DEPT. OF MINES  
(KIND)

Permit No. 039-4089

Company <u>Cabot Oil &amp; Gas</u>	CASING AND TUBING	USED IN DRILLING	LEFT IN WELL	PACKERS
Address _____	Size			
Farm <u>Shonk Land Co.</u>	16			Kind of Packer _____
Well No. <u>Shonk # 34</u>	13			
District <u>Cabin Creek County Kanawha</u>	10			Size of _____
Drilling commenced _____	8 1/4			
Drilling completed _____ Total depth _____	6 1/2			Depth set _____
Date shot _____ Depth of shot _____	5 3/16			
Initial open flow _____ /10ths Water in _____ Inch	3			Perf. top _____
Open flow after tubing _____ /10ths Merc. in _____ Inch	2			Perf. bottom _____
Volume _____ Cu. Ft.	Liners Used			Perf. top _____
Rock pressure _____ lbs. _____ hrs.				Perf. bottom _____
Oil _____ bbls., 1st 24 hrs.	CASING CEMENTED _____ SIZE _____ No. FT. _____ Date _____			
Fresh water _____ feet _____ feet	NAME OF SERVICE COMPANY _____			
Salt water _____ feet _____ feet	COAL WAS ENCOUNTERED AT _____ FEET _____ INCHES			
	_____ FEET _____ INCHES _____ FEET _____ INCHES			
	_____ FEET _____ INCHES _____ FEET _____ INCHES			

Drillers' Names Smith Drilling Co. Rig # 8

Remarks: T.D. hole at 3230' on 4-14-85. Today moving Rig off location.

4-15-85

DATE

Carlos W. Hirsch  
DISTRICT INSPECTOR

12/01/2023



Form 26  
2/16/82

**STATE OF WEST VIRGINIA  
DEPARTMENT OF MINES  
OIL AND GAS WELLS DIVISION  
INSPECTOR'S PLUGGING REPORT**

RECEIVED  
APR 27 1982  
OIL & GAS DIVISION  
DEPT. OF MINES

Permit No. \_\_\_\_\_ Well No. \_\_\_\_\_

COMPANY \_\_\_\_\_ ADDRESS \_\_\_\_\_

FARM \_\_\_\_\_ DISTRICT \_\_\_\_\_ COUNTY \_\_\_\_\_

Filling Material Used \_\_\_\_\_

Liner			Location	Amount	Packer	Location		
PLUGS USED AND DEPTH PLACED			BRIDGES			CASING AND TUBING		
CEMENT-THICKNESS	WOOD-SIZE	LEAD	CONSTRUCTION-LOCATION			RECOVERED	SIZE	LOST

Drillers' Names \_\_\_\_\_

Remarks: \_\_\_\_\_

\_\_\_\_\_ I hereby certify I visited the above well on this date.  
DATE

\_\_\_\_\_  
DISTRICT WELL INSPECTOR 12/01/2023



INSPECTOR'S PERMIT SUMMARY FORM

11-14-84

WELL TYPE Gas  
ELEVATION 1322  
DISTRICT Cabin Creek  
QUADRANGLE Eskdale  
COUNTY Kangaroo

API# 47-039 - 4089  
OPERATOR Cobot oil + Gas  
TELEPHONE \_\_\_\_\_  
FARM Shankland  
WELL # Shank # 34

SURFACE OWNER \_\_\_\_\_ COMMENTS \_\_\_\_\_ TELEPHONE \_\_\_\_\_  
TARGET FORMATION \_\_\_\_\_ DATE APPLICATION RECEIVED \_\_\_\_\_

DATE STARTED \_\_\_\_\_  
LOCATION 12-20-84 NOTIFIED \_\_\_\_\_ DRILLING COMMENCED 3-28-85

WATER DEPTHS \_\_\_\_\_, \_\_\_\_\_, \_\_\_\_\_, \_\_\_\_\_  
COAL DEPTHS \_\_\_\_\_, \_\_\_\_\_, \_\_\_\_\_, \_\_\_\_\_

CASING

Ran 140 feet of 13 3/8 "pipe on 4-1-85 with 35 SKS fill up  
Ran 1714 feet of 8 5/8 "pipe on 4-10-85 with 460 SKS fill up  
Ran \_\_\_\_\_ feet of \_\_\_\_\_ "pipe on \_\_\_\_\_ with \_\_\_\_\_ fill up  
Ran \_\_\_\_\_ feet of \_\_\_\_\_ "pipe on \_\_\_\_\_ with \_\_\_\_\_ fill up

TD 3220 feet on 4-14-85

RECEIVED  
DEPARTMENT OF ENERGY  
OIL AND GAS

PLUGGING

APR 15 1986

Type	From	To	Pipe removed

Pit Discharge date: \_\_\_\_\_ Type \_\_\_\_\_

Field analysis ph \_\_\_\_\_ fe \_\_\_\_\_ cl \_\_\_\_\_

Well Record received \_\_\_\_\_

Date Released 4-10-86

Carlos W. Hanely 12/01/2023  
Inspector's signature



API# 47 039 - 4089

LIST ALL VISITS FOR THIS PERMIT

	DATE	TIME	PURPOSE	COMMENTS
1	12-20-84		Inspection	Building location
2	3-28-85		"	move Rig on location
3	4-1-85		"	set 13 3/8 casing
4	4-8-85		"	1293' + seeping hole
5	4-10-85		"	set 8 5/8" casing
6	4-15-86		"	I.D. hole + move off location
7	7-29-85		"	check Reclamation
8	12-4-85		"	Relinquished + no A.P.E. number
9	4-10-86		"	Released
10				
11				
12				
13				
14				
15				
16				
17				
18				
19				
20				

Notes



**RECEIVED**  
NOV 1 1985

DIVISION OF OIL & GAS  
DEPARTMENT OF ENERGY

<p>1.0 API well number: (If not available, leave blank. 14 digits.)</p>	<p>47- 039 - 4089</p>							
<p>2.0 Type of determination being sought: (Use the codes found on the front of this form.)</p>	<p>103 Section of NGPA</p>	<p>N/A Category Code</p>						
<p>3.0 Depth of the deepest completion location: (Only needed if sections 103 or 107 in 2.0 above.)</p>	<p>3260 feet</p>							
<p>4.0 Name, address and code number of applicant: (35 letters per line maximum. If code number not available, leave blank.)</p>	<p>Cabot Oil &amp; Gas Corporation of W.Va. Name P. O. Box 628 Street Charleston WV 25322 City State Zip Code</p>			<p>000728 Seller Code</p>				
<p>5.0 Location of this well: [Complete (a) or (b).] (a) For onshore wells (35 letters maximum for field name.)</p>	<p>Cabin Creek Field Name Kanawha WV County State</p>							
<p>(b) For OCS wells:</p>	<p>N/A</p> <p>Area Name Block Number</p> <p>Date of Lease: Mo. Day Yr. OCS Lease Number</p>							
<p>(c) Name and identification number of this well: (35 letters and digits maximum.)</p>	<p>Shonk Land #34</p>							
<p>(d) If code 4 or 5 in 2.0 above, name of the reservoir: (35 letters maximum.)</p>	<p>N/A</p>							
<p>6.0 (a) Name and code number of the purchaser: (35 letters and digits maximum. If code number not available, leave blank.)</p>	<p>Consolidated Gas Transmission Corp. Name</p>			<p>004228 Buyer Code</p>				
<p>(b) Date of the contract:</p>	<p>1 2 0 1 4 7 Mo. Day Yr.</p>							
<p>(c) Estimated annual production:</p>	<p>MMcf.</p>							
<p>7.0 Contract price: (As of filing date. Complete to 3 decimal places.)</p>	<p>(a) Base Price (\$/MMBTU)</p>	<p>(b) Tax</p>	<p>(c) All Other Prices [Indicate (+) or (-).]</p>	<p>(d) Total of (a), (b) and (c)</p>				
<p>8.0 Maximum lawful rate: (As of filing date. Complete to 3 decimal places.)</p>	<p>-----</p>	<p>-----</p>	<p>-----</p>	<p>-----</p>				
<p>9.0 Person responsible for this application:</p>	<p>H. Baird Whitehead Name Regional Manager Drilling &amp; Production Title</p> <p><i>H. Baird Whitehead</i> Signature</p> <p>November 1, 1985 Date Application is Completed</p> <p>(304) 347-1600 Phone Number</p>							
<table border="1" style="width:100%; border-collapse: collapse;"> <tr> <td style="text-align: center;">Agency Use Only</td> </tr> <tr> <td style="text-align: center;">Date Received by Juris. Agency</td> </tr> <tr> <td style="text-align: center;">NOV 1 1985</td> </tr> <tr> <td style="text-align: center;">Date Received by FERC</td> </tr> </table>	Agency Use Only	Date Received by Juris. Agency	NOV 1 1985	Date Received by FERC				
Agency Use Only								
Date Received by Juris. Agency								
NOV 1 1985								
Date Received by FERC								

12/01/2023



STATE OF WEST VIRGINIA  
DEPARTMENT OF MINES, OIL AND GAS DIVISION

15842-56

NOV 30 1985

COVER SHEET, STATE APPLICATION FOR WELL CLASSIFICATION

Date: November 1, 19 85 8150  
Applicant's Name: Cabot Oil & Gas Corporation of WV  
Address: P. O. Box 628  
Charleston, WV 25322  
Gas Purchaser Contract No. 1019  
Date of Contract 12/1/47  
(Month, day and year)

AGENCY USE ONLY

WELL DETERMINATION FILE NUMBER

851101-1030-039-4089

Use Above File Number on all  
Communications Relating to This Well

First Purchaser: Consolidated Gas Transmission Corp.  
Address: 445 West Main Street  
(Street or P.O. Box)  
Clarksburg, WV 26301  
(City) (State) (Zip Code)  
FERC Seller Code 000728

Designated Agent: H. Baird Whitehead

Address: P. O. Box 628  
Charleston, WV 25322

FERC Buyer Code 004228

NAME AND TITLE OF PERSON TO WHOM QUESTIONS CONCERNING THIS APPLICATION SHALL BE ADDRESSED:

Name: Ed Hindman Regulatory Assistant  
(Print) (Title)

Signature: E. Hindman

Address: P. O. Box 628  
(Street or P.O. Box)  
Charleston WV 25322  
(City) (State) (Zip Code)

Telephone: (304) 347-1600  
(Area Code) (Phone Number)

(Certificate of Proof of Service to Purchaser)

Copy sent to Purchaser by Certified Mail P532 407 708 on November 1, 1985  
NGPA Category Applied For

NGPA SECTION/SUBSECTION

- 102 New Natural Gas
  - 102-2 2.5 Mile Test
  - 102-3 1000 Foot Deeper Test
  - 102-4 New Onshore Reservoir
- 103 New Onshore Production Well
  - X 103 New Onshore Production Well
- 107 High Cost Natural Gas
  - 107-0 Deep (more than 15,000 feet)
  - 107-1 Geopressed Brine
  - 107-2 Coal Seams
  - 107-3 Devonian Shale
  - 107-5 Production enhancement
  - 107-6 New Tight Formation
  - 107-7 Recompletion Tight Formation

- 108 Stripper Well Natural Gas
  - 108- Stripper Well
  - 108-1 Seasonally Affected
  - 108-2 Enhanced Recovery
  - 108-3 Temporary Pressure Buildup

AGENCY USE ONLY

QUALIFIED

12/01/2023

RECEIVED  
NOV 1 1985

DIVISION OF OIL & GAS  
DEPARTMENT OF ENERGY

Date Received

Determination Date



STATE OF WEST VIRGINIA  
DEPARTMENT OF MINES, OIL AND GAS DIVISION

Operator's Shonk Land #34  
Well No. \_\_\_\_\_

API Well No. 47 - 039 - 4089  
State County Permit

WELL CLASSIFICATION FORM  
NEW ONSHORE PRODUCTION WELL  
NGPA Section 103

DESIGNATED AGENT H. Baird Whitehead  
ADDRESS P. O. Box 628  
Charleston, WV 25322

WELL OPERATOR Cabot Oil & Gas Corp. of WV  
ADDRESS P. O. Box 628  
Charleston, WV 25322

LOCATION: Elevation 1322'  
Watershed Ten Mile Fork of Cabin Creek  
Dis. Cabin Creek County Kanawha Quad. Eskdale

GAS PURCHASER Consolidated Gas Trans. Corp.  
ADDRESS 445 West Main Street  
Clarksburg, WV 26301

Gas Purchase Contract No. 1019  
Meter Chart Code N/A  
Date of Contract 12/1/47

\* \* \* \* \*

Date surface drilling was begun: 3/29/85

Indicate the bottom hole pressure of the well and explain how this was calculated:

	BL&Gordon/Maxton	BL&Gordon/Maxton
BHP = $P_1 + P_1(e^{GL/53.34T} - 1)$	$P_1 = 460/285$ PSIA $T = 87/80$ $G = .64/.64$ $L = 2743/2049$	BHP = 489/298 PSIA

AFFIDAVIT

I, H. Baird Whitehead, having been first sworn according to law state that surface drilling of the well for which this determination is sought was begun on or after February 19, 1977; the well satisfies applicable state or federal well spacing requirements and the well is not within a proration unit, in existence at the time surface drilling began, which was applicable to the reservoir from which gas is or will be produced and which applied to any other well producing gas in commercial quantities or on which surface drilling began on or after February 19, 1977, and which was capable of producing gas in commercial quantities. I state, further, that I have concluded, to the best of my information, knowledge and belief, that the well for which this determination is sought is a new onshore production well and that I am not aware of any information not described in the application which is inconsistent with this conclusion.

*H. Baird Whitehead*

STATE OF WEST VIRGINIA,

COUNTY OF Kanawha, TO WIT:

I, Lorene Miller, a Notary Public in and for the state and county aforesaid, do certify that H. Baird Whitehead, whose name is signed to the writing above, bearing date the 1st day of November, 19 85, has acknowledged the same before me, in my county aforesaid.

Given under my hand and official seal this 1st day of November, 19 85.  
My term of office expires on the 5th day of March, 19 89.

[NOTARIAL SEAL]

*Lorene Miller*  
Notary Public

12/01/2023



KAYFORD

LATITUDE 38° 2' 30"

LONGITUDE: 81° 25' 00"

10,000'

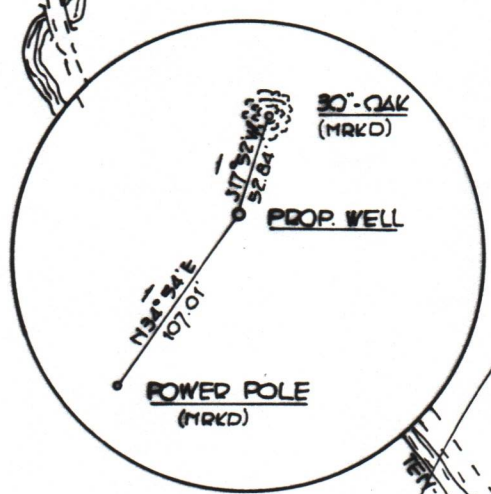

**SUONK LAND CO., LTD.**  
 TM-80 PAR. 1  
 DB-1816 PG. 236  
 4519.4 ACRES

REFERENCE 1" = 100'

CONCRETE MONUMENT - K1

PROPOSED SUONK #34

**ROBERT C. & PAMELA A. FORD**  
 TM-89 PAR. 1  
 DB-1993 PG. 334  
 2954.59 ACRES

N67° 52' 33" E 2373.00'

75' TOPO LOCA.

COPPER PLUG IN SIDEWALK

**-SURVEY TIES-**

- (A) - N16° 01' W --- 463.72'
- (B) - S50° 24' E --- 130.85'
- (C) - N04° 17' W --- 363.32'
- (D) - S22° 11' E --- 232.28'
- (E) - N09° 54' W --- 234.17'

FILE NO. \_\_\_\_\_  
 DRAWING NO. \_\_\_\_\_  
 SCALE 1" = 200 FT.  
 MINIMUM DEGREE OF ACCURACY 1:2000  
 PROVEN SOURCE OF ELEVATION BM-800' NW OF LOCA.

I THE UNDERSIGNED, HEREBY CERTIFY THAT THIS PLAT IS CORRECT TO THE BEST OF MY KNOWLEDGE AND BELIEF AND SHOWS ALL THE INFORMATION REQUIRED BY LAW AND THE REGULATIONS ISSUED AND PRESCRIBED BY THE DEPARTMENT OF MINES.  
 (SIGNED) *Byron D. Stuman L.L.S.*  
 R.P.E. \_\_\_\_\_ L.L.S. - No. 736 -

NEW SEAL APPLIED FOR  
 PLACE SEAL HERE

(+) DENOTES LOCATION OF WELL ON UNITED STATES TOPOGRAPHIC MAPS  
 FORM IV-6 (8-78)



Department of Mines  
 Oil & Gas Division

DATE DECEMBER 6, 19 83  
 OPERATOR'S WELL NO. SUONK-34  
 API WELL NO. 47-039-4089  
 STATE COUNTY PERMIT

WELL TYPE: OIL \_\_\_ GAS  LIQUID INJECTION \_\_\_ WASTE DISPOSAL \_\_\_  
 (IF "GAS", PRODUCTION \_\_\_ STORAGE \_\_\_ DEEP \_\_\_ SHALLOW   
 LOCATION: ELEVATION 1322' WATER SHED TEN MILE FORK OF CABIN CREEK  
 DISTRICT CABIN CREEK COUNTY KANAWHA  
 QUADRANGLE ESKDALE

SURFACE OWNER SUONK LAND CO., LTD. ACREAGE 4519.4  
 OIL & GAS ROYALTY OWNER SUONK LAND CO., LTD. LEASE ACREAGE 1000.49  
 LEASE NO. 47-0641

PROPOSED WORK: DRILL  CONVERT \_\_\_ DRILL DEEPER \_\_\_ REDRILL \_\_\_ FRACTURE OR STIMULATE \_\_\_ PLUG OFF OLD FORMATION \_\_\_ PERFORATE NEW FORMATION \_\_\_ OTHER PHYSICAL CHANGE IN WELL (SPECIFY) \_\_\_\_\_

PLUG AND ABANDON \_\_\_ CLEAN OUT AND REPLUG \_\_\_  
 TARGET FORMATION DEVONIAN SHALE ESTIMATED DEPTH 5300'  
 WELL OPERATOR C.O.G.C. OF W.VA DESIGNATED AGENT H. BAIRD WHITEHEAD  
 ADDRESS PO. BOX 628 CHAS. WV. 25301 ADDRESS PO. BOX 628 CHAS. WV. 25301



**CABOT OIL & GAS-CORPORATION**  
**OF WEST VIRGINIA**  
 SHONK LAND COMPANY #34  
**KOLB ENTERPRISES Ltd.**  
 CHARLESTON, W. VA.

12/01/2023

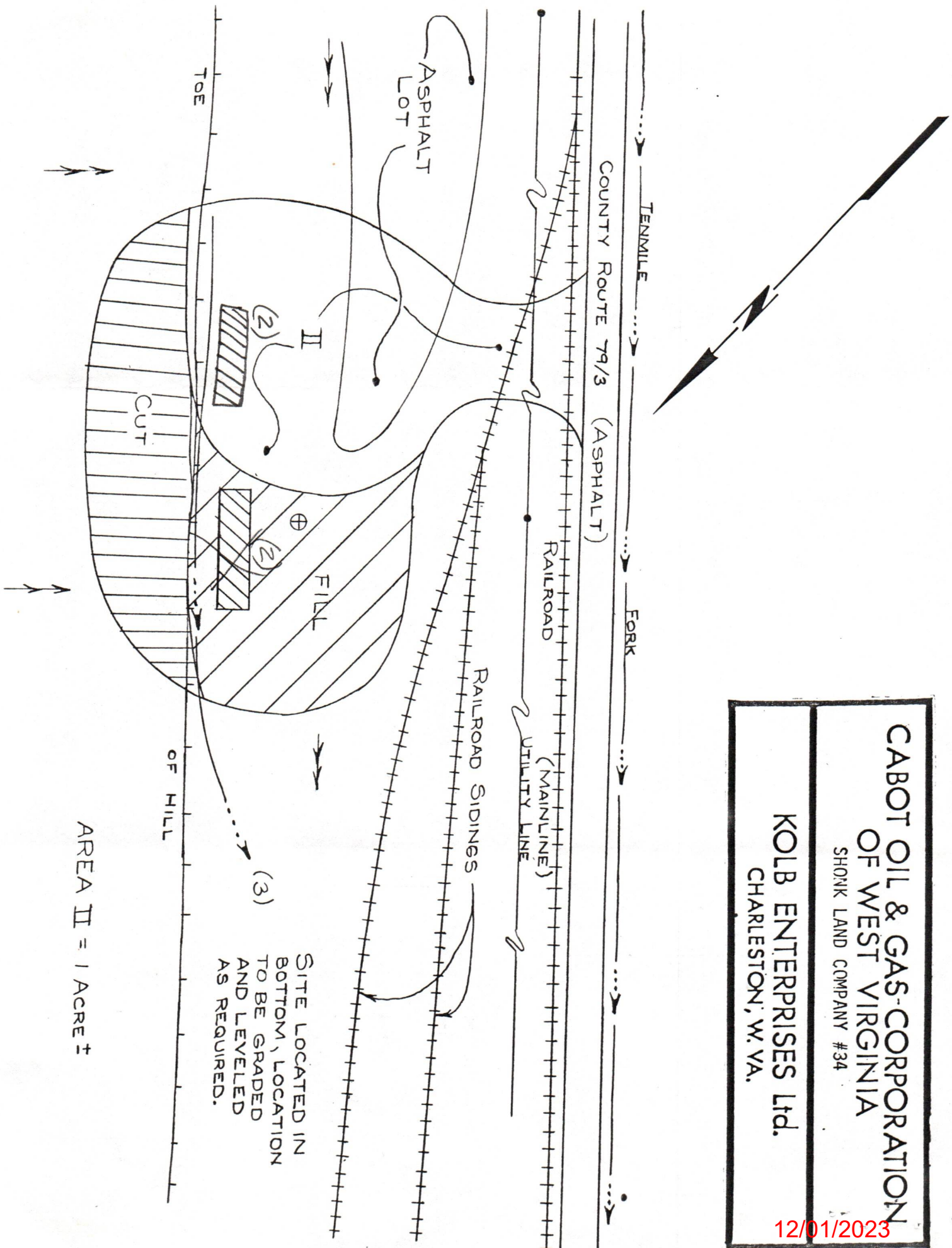

AREA II = 1 ACRE ±

SITE LOCATED IN  
 BOTTOM, LOCATION  
 TO BE GRADED  
 AND LEVELED  
 AS REQUIRED.





DATE September 6, 1984  
WELL NO. Shonk Land Co. #34  
API NO. 47 - 039 - 4089

SEP 26 1984

State of West Virginia  
Department of Mines  
Oil and Gas Division

Construction and Reclamation Plan

SEP. 14 1984

COMPANY NAME Cabot Oil & Gas Corporation of WV DESIGNATED AGENT Steven Turk  
ADDRESS P.O. Box 628, Chas. WV 25322 ADDRESS P.O. Box 628 Chas. WV 25322  
TELEPHONE 304-347-1600 TELEPHONE 304-347-1600  
LANDOWNER Shonk Land Co., Ltd. SOIL CONS. DISTRICT Capitol

Revegetation to be carried out by \_\_\_\_\_ Company Contractor \_\_\_\_\_ (Agent)

This plan has been reviewed by \_\_\_\_\_ CAPITOL \_\_\_\_\_ SCD. All corrections and additions have become a part of this plan.

SEP. 25 1984

(Date)

"FIELD REVIEWED"

12-27-83

RECEIVED

OCT 9 1984

R. C. Alford

(SCD Agent)

"SEE ATTACHED COMMENTS"

ACCESS ROAD

LOCATION

STRUCTURE	ACCESS ROAD	LOCATION
STRUCTURE <u>N/A</u> (A)		STRUCTURE _____ (1)
SPACING _____		MATERIAL _____
PAGE REF. MANUAL _____		PAGE REF. MANUAL _____
STRUCTURE _____ (B)		STRUCTURE <u>Pit</u> (2)
SPACING _____		MATERIAL <u>lined with plastic</u>
PAGE REF. MANUAL _____		PAGE REF. MANUAL <u>N/A</u>
STRUCTURE _____ (C)		STRUCTURE <u>Sediment Barrier</u> (3)
SPACING _____		MATERIAL <u>Straw Bales or Filter Fence</u>
PAGE REF. MANUAL _____		PAGE REF. MANUAL <u>2:16, 2:18, 2:19</u>

OIL & GAS DIVISION  
DEPT. OF MINES

All structures should be inspected regularly and repaired if necessary. All commercial timber is to be cut and stacked and all brush and small timber to be cut and removed from the site before earth work begins.

TREATMENT AREA I		Revegetation	TREATMENT AREA II	
Lime _____	Tons/acre	Lime _____	Tons/acre	
or correct to pH <u>6.5</u>		or correct to pH <u>6.5</u>		
Fertilizer <u>500</u>	lbs/acre	Fertilizer <u>500</u>	lbs/acre	
(10-20-20 or equivalent)		(10-20-20 or equivalent)		
Mulch _____	Tons/acre	Mulch <u>Hay or Straw @ 1 1/2</u>	Tons/acre	
Seed* _____	lbs/acre	Seed* <u>Ky 31 Tall Fescue</u>	40 lbs/acre	
<u>N/A</u>	lbs/acre	<u>Redtop</u>	5 lbs/acre	
	lbs/acre		lbs/acre	

\*Inoculate all legumes such as vetch, trefoil and clovers with the proper bacterium. Inoculate with 3X the recommended amount.

PLAN PREPARED BY [Signature] 12/01/2023



Note: Please request landowner cooperation to protect new seedlings for one growing season. Attach separate sheets as necessary for comments.

Cabot Oil and Gas Corporation of WV  
ADDRESS P.O. Box 628  
Charleston, WV 25322  
PHONE NO. (304) 347-1600



ATTACH OR PHOTOCOPY SECTION OF INVOLVED TOPOGRAPHIC MAP. QUADRANGLE Eskdale

LEGEND

WELL SITE   
ACCESS ROAD 

















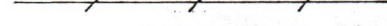

PHOTOCOPY ATTACHED

WELL SITE PLAN

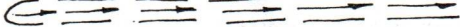
SKETCH TO INCLUDE WELL LOCATION, EXISTING ACCESS ROAD, ROADS TO BE CONSTRUCTED, WELLSITE, DRILLING PITS AND NECESSARY STRUCTURES NUMBERED OR LETTERED TO CORRESPOND WITH THE FIRST PART OF THIS PLAN. INCLUDE ALL NATURAL DRAINAGE.

LEGEND

WELL LOCATION		DRILLING PIT	
PROPOSED ROAD		EXISTING ROAD	
PROPERTY BOUNDARY		DIVERSION	
EXISTING FENCE		PROPOSED FENCE	
STREAM		SPRING	
WET SPOT		OPEN DITCH	
DRAIN PIPE		BUILDING	
WATERWAY		CULVERT	
RIP RAP		SLOPE OF LAND	

SKETCH ATTACHED

COMMENTS: Location to be tilted toward highwall to divert runoff through sediment control.

12/01/2023