



1) Date: September 24, 1985
2) Operator's Well No. Ohley #54
3) API Well No. 47 039 -4267
State County Permit

DIVISION OF OIL & GAS
STATE OF WEST VIRGINIA
DEPARTMENT OF ENERGY, OIL AND GAS DIVISION

APPLICATION FOR A WELL WORK PERMIT

- 4) WELL TYPE: A Oil / Gas X
B (If "Gas", Production X / Underground storage / Deep / Shallow X)
- 5) LOCATION: Elevation: 1817 Watershed: Power House Hollow
District: Cabin Creek 2 County: Kanawha Quadrangle: Eskdale 7.5' 340
- 6) WELL OPERATOR A & W Energy Corp. CODE: 1100 7) DESIGNATED AGENT Roland C. Baer, Jr.
Address P. O. Box 2587 Address P. O. Box 2587
Charleston, WV 25329 Charleston, WV 25329
- 8) OIL & GAS INSPECTOR TO BE NOTIFIED Name Carlos Hively
Address 223 Pinch Ridge Road
Elkview, WV 25071
- 9) DRILLING CONTRACTOR: Name Address
- 10) PROPOSED WELL WORK: Drill X / Drill deeper / Redrill / Stimulate X
Plug off old formation / Perforate new formation X
Other physical change in well (specify)
- 11) GEOLOGICAL TARGET FORMATION, Injun, Weir, Devonian Shale
- 12) Estimated depth of completed well, 5290 feet
- 13) Approximate trata depths: Fresh, 1240 feet; salt, 2140 feet.
- 14) Approximate coal seam depths: 2640 Is coal being mined in the area? Yes X / No
- 15) CASING AND TUBING PROGRAM

CASING OR TUBING TYPE	SPECIFICATIONS					FOOTAGE INTERVALS		CEMENT FILL-UP OR SACKS (Cubic feet)	PACKERS
	Size	Grade	Weight per ft.	New	Used	For drilling	Left in well		
Conductor									Kinds
Fresh water	9 5/8"	SMLS	32	X		1400'	1400'	300 cts.	By Rule 15.05
Coal	7"	SMLS	23	X		2300'	2300'	200 cts.	Sizes
Intermediate									
Production	4 1/2"	SMLS	10.5	X		5290'	5290'	200-400 cts.	Depths set Or As Required
Tubing									By Rule 15.01
Lin...									Perforations:
									Top Bottom

OFFICE USE ONLY
DRILLING PERMIT

Permit number 47-039-4267 Date December 5 19 85

This permit covering the well operator and well location shown below is evidence of permission granted to drill in accordance with the pertinent legal requirements subject to the conditions contained herein and on the reverse hereof. Notification must be given to the District Oil and Gas Inspector. (Refer to No. 8) Prior to the construction of roads, locations and pits for any permitted work. In addition, the well operator or his contractor shall notify the proper district oil and gas inspector 24 hours before actual permitted work has commenced.)

The permitted work is as described in the Notice and Application, plat, and reclamation plan, subject to any modifications and conditions specified on the reverse hereof.

Permit expires December 5, 1987 unless well work is commenced prior to that date and prosecuted with due diligence.

Bond:	Agent: ALB	Plat: MN MN	Casing Fee 23-61 2562	WPCP MN	S&E MN	Other
-------	------------	-------------	-----------------------	---------	--------	-------

Director, Division of Oil and Gas
12/08/2023 file

NOTE: Keep one copy of this permit posted at the drilling location.

See the reverse side of the APPLICANT'S COPY for instructions to the well operator.

OFFICE USE ONLY

PERMIT MODIFICATIONS AND CONDITIONS (IF ANY) TO THE PROPOSED WELL WORK

WELL TYPE: A B C D E F G H I J K L M N O P Q R S T U V W X Y Z

LOCATION: A B C D E F G H I J K L M N O P Q R S T U V W X Y Z

WELL OPERATOR: A & W Energy Corp. CODE: **1100**

ADDRESS: P. O. Box 2587, Charleston, WV 25329

CONTRACTOR: **Carlson Hively**, 223 Pinch Ridge Road, Blakview, WV 25071

PROPOSED WELL WORK: New well Existing well Abandonment Other

Geological Information: **Intun, West, Devonian Shale**

Estimated depth of completed well: **2300** feet

Approximate total depth: **2340** feet

Actual maximum completion depth: **2340** feet

OFFICE USE ONLY

This part of Form WW-2(B) is to record the dates of certain occurrences and any follow-up inspections.

	Date	Date(s)
Application received		
Well work started		
Completion of the drilling process		
Well Record received		
Reclamation completed		
OTHER INSPECTIONS		

Reason: _____

Reason: _____

SEP. 30 1985

RECEIVED
OCT - 3 1985



WW-9

DATE September 30, 1985

WELL NO. Ohley 54

API NO. 47 - 039 - 4267

DIVISION OF OIL & GAS *State of West Virginia*
DEPARTMENT OF ENERGY
Department of ENERGY
Oil and Gas Division

CONSTRUCTION AND RECLAMATION PLAN

COMPANY NAME Allegheny & Western Energy Corp. DESIGNATED AGENT Roland C. Baer
Address Box 2587 Charleston, WV Address Box 2587, Charleston, WV 25329
Telephone 343-4327 Telephone 343-4327
LANDOWNER Ohley Land Co. SOIL CONS. DISTRICT Capital
Revegetation to be carried out by Roland C. Baer (Agent)

This plan has been reviewed by Capital SCD. All corrections and additions become a part of this plan: OCT. 2 1985 (Date)

"FIELD REVIEWED"

R. C. Baer
(SCD Agent)

ACCESS ROAD

"SEE ATTACHED COMMENTS" LOCATION

Structure Drainage Ditch (A)
Spacing Along Access Road
Page Ref. Manual _____
Structure _____ (B)
Spacing 12" Min. - 42" Max. I.D. as shown on sketch.
Page Ref. Manual 2:7 to 2:11
Structure Cross Drains (C)
Spacing As shown on sketch
Page Ref. Manual 2:1 to 2:6

Structure Diversion Ditch (1)
Material Earthen
Page Ref. Manual 2:12 to 2:13
Structure Sediment Barrier (2)
Material Straw Bales
Page Ref. Manual 2:16
Structure Pit (3)
Material Dug and plastic lined
Page Ref. Manual _____

All structures should be inspected regularly and repaired if necessary. All commercial timber is to be cut and stacked and all brush and small timber to be cut and removed from the site before dirt work begins.

REVEGETATION

Treatment Area I
Lime 3.0 Tons/acre
or correct to pH 6.5
Fertilizer 600 lbs/acre
(10-20-20 or equivalent)
Mulch Hay or Straw 2.0 Tons/acre
Seed* Ky. 31 Tall Fescue 45 lbs/acre
Crownvetch 10 lbs/acre
Rye Grass 10 lbs/acre

Treatment Area II
Lime 3.0 Tons/acre
or correct to pH 6.5
Fertilizer 600 lbs/acre
(10-20-20 or equivalent)
Mulch Hay or Straw 2.0 Tons/acre
Seed* Ky. 31 Tall Fescue 45 lbs/acre
Crownvetch 10 lbs/acre
Rye Grass 10 lbs/acre

*Inoculate all legumes such as vetch, trefoil and clovers with the proper bacterium. Inoculate with 3X recommended amount.

PLAN PREPARED BY

George J. Kelly
A E Associates, Ltd.

ADDRESS 1206 Virginia Street, East
Charleston, WV 25301

PHONE NO. (304) 346-0505

NOTES: Please request landowner's cooperation to protect new seeding for one growing season. Attach separate sheets as necessary for comments.

12/08/2023

Note: Access Road to be constructed or upgraded with erosion control in mind. Road is to be sloped 1 to 2% toward open ditch line. All outlets of drainage and ditches will be to stable areas. All brush and timber to be cut prior to any earth movement. Timber 6" and up to be trimmed and stacked. Topsoil to be stockpiled for reclamation.

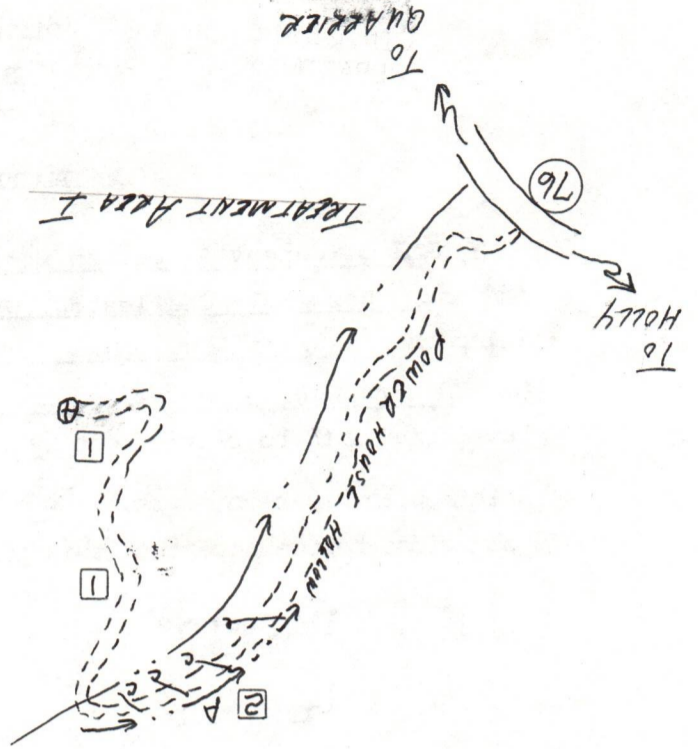
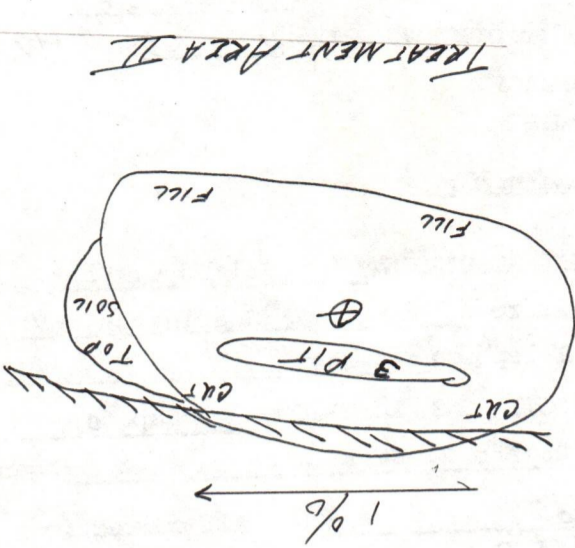

SPACING OF	LENGTH OF	4600' TOTAL
1	2600' 370 70%	AS NEEDED
2	2000' 1270 16%	
ACCESS RD SLOPE		

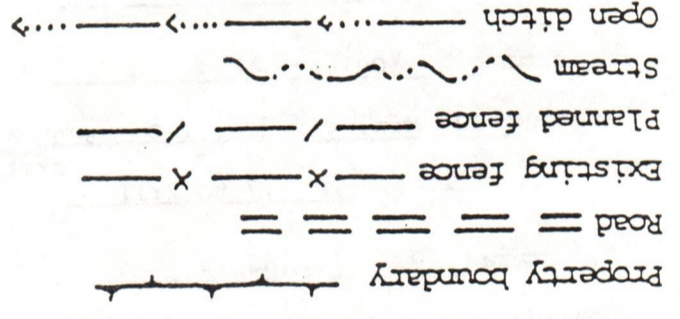
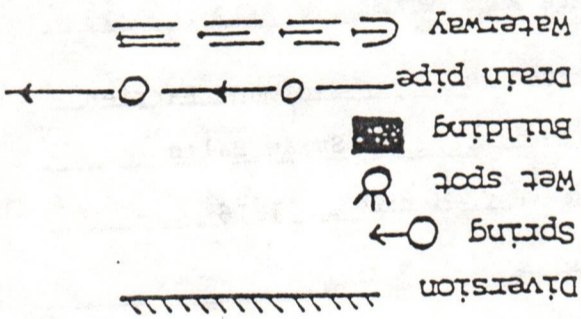

LEGEND

part of this plan. Include all natural drainage. Drilling pits and necessary structures numbered or lettered to correspond with the first

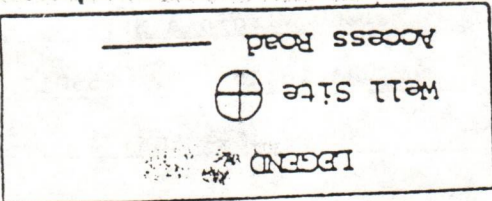
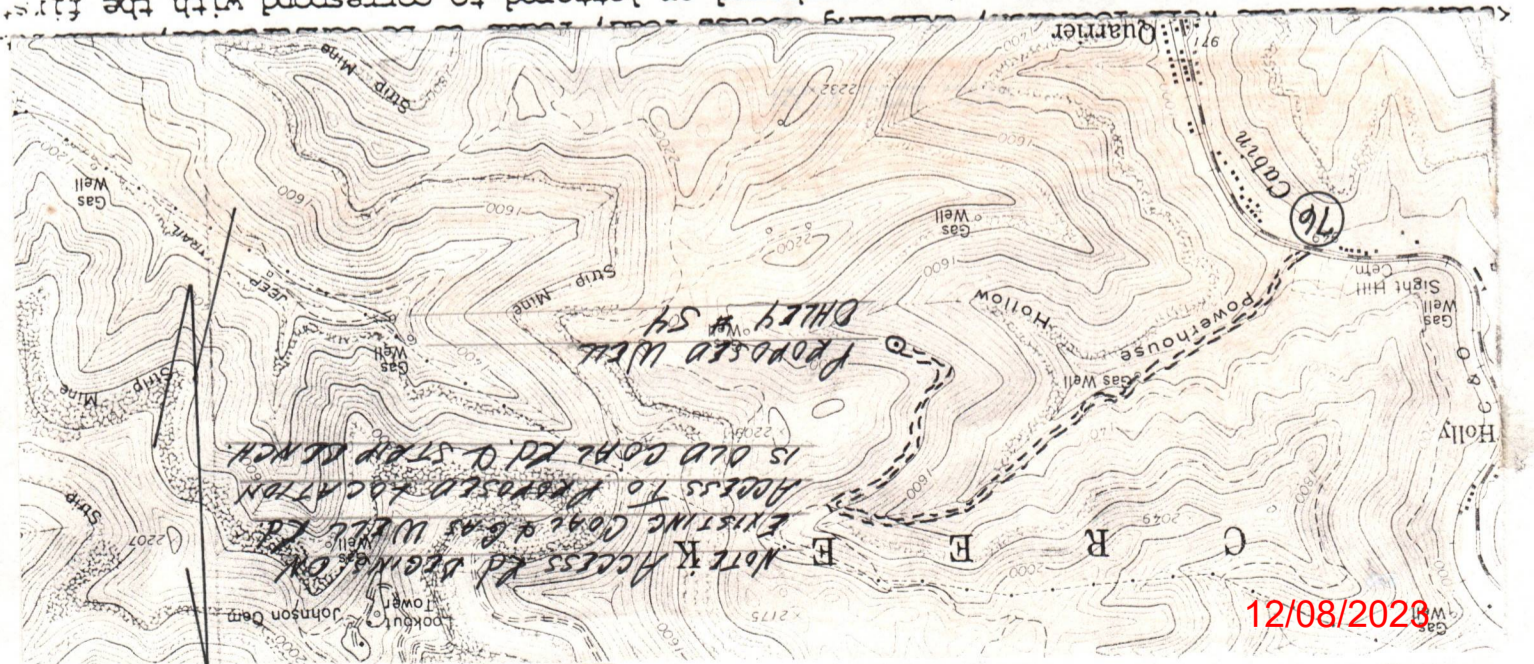

ATTACH OR PHOTOCOPY SECTION OF INVOLVED TOPOGRAPHIC MAP. QUADRANGLE ESKDALE T.5'

1) Date: September 16, 1985
Operator's
2) Well No. Ohley #54
3) API Well No. 47 - 039 - 4267
State County Permi

STATE OF WEST VIRGINIA
DEPARTMENT OF ENERGY, DIVISION OF OIL & GAS
NOTICE OF APPLICATION FOR A WELL WORK PERMIT

4) SURFACE OWNER(S) OF RECORD TO BE SERVED
5 (i) COAL OPERATOR Imperial Colliery Company
Address P. O. Box 638
Lynchburg, Virginia 24505
(i) Name Ohley Land Company
Address P. O. Box 638
Lynchburg, Virginia
5 (ii) COAL OWNER(S) WITH DECLARATION ON RECORD:
Name Ohley Land Company
Address P. O. Box 638
Lynchburg, Virginia 24505
(ii) Name _____
Address _____
(iii) Name _____
Address _____

P 235 698 878
RECEIPT FOR CERTIFIED MAIL

NO INSURANCE COVERAGE PROVIDED—
NOT FOR INTERNATIONAL MAIL
(See Reverse)

SENT TO C. Lynch Christian, Jr.	
Imperial Colliery Co.	
STREET AND NO. Box 638	
P.O., STATE AND ZIP CODE Lynchburg, VA 24505	
POSTAGE	\$ 2.40
CERTIFIED FEE	1.45 ^c
SPECIAL DELIVERY	c
RESTRICTED DELIVERY	c
SHOW TO WHOM AND DATE DELIVERED	c
SHOW TO WHOM, DATE, AND ADDRESS OF DELIVERY	c
SHOW TO WHOM AND DATE DELIVERED WITH RESTRICTED DELIVERY	c
SHOW TO WHOM, DATE AND ADDRESS OF DELIVERY WITH RESTRICTED DELIVERY	c
TOTAL POSTAGE AND FEES	\$ 3.85
POSTMARK OR DATE	

TO THE PERSON(S)

- (1) The A invol and,
- (2) The p
- (3) The C to pl recla

THE REASON WHICH ARE SUMMA WW-2(B) DESIGNA

Take notic erator propos for a Well Worl well at the loc Copies of this have been mail above (or by p to the Director

6) EXTRACTION

Check and Includ hol The re

7) ROYALTY PE

Is the right to extract, produce or market the oil or gas based upon a lease or leases or other contract or contracts providing for flat well royalty or any similar provision for compensation to the owner of the oil or gas in place which is not inherently related to the volume of oil or gas so extracted, produced or marketed? Yes No

If the answer above is No, nothing additional is needed. If the answer is Yes, you may use Affidavit Form WW-60.

See the reverse side for line item instructions, and for instructions concerning the required copies of the Notice and Application, plat, and Construction and Reclamation Plan.

The truth of the information on the Notice and Application is verified and sworn to and the Notice is signed on behalf of the Well Operator in my County and State by
R. H. Hess

this 16th day of September, 19 85,
My Commission expires 1/9, 19 90.

John D. Martin
Notary Public, Kanawha County,
State of West Virginia

WELL OPERATOR Allegheny & Western Energy Corp.
By R.H. Hess
Its President
Address P. O. Box 2587
Charleston, WV 25329
Telephone (304) 343-4327

ESSEE WITH DECLARATION ON RECORD:
Imperial Colliery Company
P. O. Box 638
Lynchburg, Virginia 24505

orm and the following documents:

B) which sets out the parties is the well and its location g program; on Form WW-6, and (unless the well work is only and sediment control and for

RIGHTS REGARDING THE APPLICATION OF THE COPY OF THE APPLICATION TAKE ANY ACTION AT ALL.

Code, the undersigned well op ation and accompanying documents Oil and Gas, with respect to a. epticted on attached Form WW-6. nstruction and Reclamation Plan id by hand to the person(s) named fore the day of mailing or delivery

contract or contracts by which I (see reverse side for specifics.)

DIVISION OF OIL & GAS
DEPARTMENT OF ENERGY

RECEIVED
OCT - 5 1985

I N S T R U C T I O N S T O A P P L I C A N T

CONCERNING THE LINE ITEMS:

- 1) Date of Notice.
- 2) Your well name and number.
- 3) To be filled out by the Division of Oil & gas.
- 4) & 5) Use separate sheet if necessary.
- 4) Surface owner(s) of record to be served with Notice and Application. However, see also Code §22B-1-9(b) if "more than three tenants in common or other co-owners of interest described in subsection (a) of this section hold interests in such lands".
- 5(i) "Coal Operator" means any person, firm, partnership, partnership association or corporation that proposes to or does operate a coal mine.
- 5(ii, iii) See Code §22B-1-36.
- 6) See Code §22-4-11(c). However, in lieu of filing the lease(s) or other continuing contract(s), the Applicant may fill out the information in the space provided below.
- 7) See Code § § 22-4-11 (d, e).

CONCERNING THE REQUIRED COPIES FOR FILING AND SERVICE:

Filing. Code §22B-1-6 and Regulation 7.02 provide that the original and required copies of the Notice and Application must be filed with the Administrator, accompanied by (i) a plat in the form prescribed by Regulation 11, (ii) a bond in one of the forms prescribed by Regulation 12, or in lieu thereof the other security allowed by Code §22B-1-2C and the reclamation required by Code §22B-1-30 and Regulation 23; (iv) unless previously paid on the same well, the fees required by Code §22B-1-2(c) and 22B-1-29, and (v) if applicable, the consent required by Code §22B-1-21 from the owner of any water well on dwelling within 200 feet of the proposed well.

Service. In addition, service must be made on the surface owner(s) and the person(s) with an interest in the coal. See Code § § 22B-1-9, 22-B-1-13 and 22B-1-14.

INFORMATION SUPPLIED UNDER CODE §22B-1-8(d)
IN LIEU OF FILING LEASE(S) AND OTHER CONTINUING CONTRACT(S)

Under the oath required to make the verification on the obverse side of this Notice, I depose and say that I am the person who signed the Notice for the Applicant, and that--

- (1) the tract of land is the same tract described in the Application to which this Notice applies, partly or wholly depicted in the accompanying plat, and described in the Construction and Reclamation Plan;
- (2) the parties and recordation data (if recorded) for lease(s) or other continuing contract(s) by which the Applicant claims the right to extract, produce or market the oil or gas are as follows:

<u>Grantor, lessor, etc.</u>	<u>Grantee, lessee, etc.</u>	<u>Royalty</u>	<u>Book page</u>
Farmout From:			
Columbia Gas Transmission Corp.	<i>Allegheny & Western Energy Corp.</i>	1/8	Not Recorded 5-11-78
United Fuel Gas Co.	Ohley Coal Co.	1/8	102/08/2023 114

↔



1) Date: September 24, 1985
 2) Operator's Well No. Ohley #54
 3) API Well No. 47 State 039 County Permit

STATE OF WEST VIRGINIA
DEPARTMENT OF ENERGY, OIL AND GAS DIVISION

APPLICATION FOR A WELL WORK PERMIT

- 4) WELL TYPE: A Oil / Gas /
 B (If "Gas", Production / Underground storage / Deep / Shallow)
- 5) LOCATION: Elevation: 1817 Watershed: Power House Hollow
 District: Cabin Creek County: Kanawha Quadrangle: Esksdale 7.5'
- 6) WELL OPERATOR A & W Energy Corp. CODE: _____ 7) DESIGNATED AGENT Roland C. Baer, Jr.
 Address P. O. Box 2587 Address P. O. Box 2587
Charleston, WV 25329 Charleston, WV 25329
- 8) OIL & GAS INSPECTOR TO BE NOTIFIED Name Carlos Hively 9) DRILLING CONTRACTOR:
 Address 223 Pinch Ridge Road Name _____
Elkview, WV 25071 Address _____
- 10) PROPOSED WELL WORK: Drill / Drill deeper _____ / Redrill _____ / Stimulate _____
 Plug off old formation _____ / Perforate new formation /
 Other physical change in well (specify) _____
- 11) GEOLOGICAL TARGET FORMATION, Injun, Weir, Devonian Shale
- 12) Estimated depth of completed well, 5290 feet
- 13) Approximate trata depths: Fresh, 1240 feet; salt, 2140 feet
- 14) Approximate coal seam depths: 2640 Is coal being mined in the area? Yes No _____

15) CASING AND TUBING PROGRAM

CASING OR TUBING TYPE	SPECIFICATIONS					FOOTAGE INTERVALS		CEMENT FILLUP OR SACKS (Cubic feet)	PACKERS	
	Size	Grade	Weight per ft.	New	Used	For drilling	Left in well		Kinds	
Conductor										
Fresh water	9 5/8"	SMLS	32	X		1400'	1400'	300 cts	By Rule 15.05	
Coal	7"	SMLS	33	X		2300'	2300'	200 cts	Sizes	
Intermediate										
Production	4 1/2"	SMLS	10.5	X		5290'	5290'	200-430 cts	Depths set Or As Required	
Tubing									By Rule 15.01	
Liners									Perforations	
									Top	Bottom

INSTRUCTIONS TO COAL OPERATOR, OWNER, OR LESSEE

The named coal operator, coal owner(s), and coal lessee are hereby notified that any objection they wish to make or are required to make by Code 22B-1-15,16, or 17 must be filed with the Department of Energy within fifteen (15) days after the receipt of this Application by the Department.

The following waiver must be completed by the coal operator and by any coal owner or coal lessee who has recorded a declaration under Code 22B-1-36 if the permit is to be issued within fifteen (15) days of the filing of the Application.

WAIVER

The undersigned coal operator _____ / owner _____ lessee _____ / of the coal under this well location has examined this proposed well location. If a mine map exists which covers the area of the well location, the well location has been added to the mine map. The undersigned has no objection to the work proposed to be done at this location, provided, the well operator has complied with all applicable requirements of the West Virginia Code and the governing regulations.

Ohley Land Company - Coal Owner

Imperial Colliery Co.
Coal lessee & Operator

Date: 12/4, 1985

By C. Lynch Christian, III
 Vice President
 12/08/2023



1) Date: September 24, 1985
 2) Operator's Well No. Ohley #54
 3) API Well No. 47 039
 State County Permit

STATE OF WEST VIRGINIA
 DEPARTMENT OF ENERGY, OIL AND GAS DIVISION
APPLICATION FOR A WELL WORK PERMIT

- 4) WELL TYPE: A Oil / Gas /
 B (If "Gas", Production / Underground storage / Deep / Shallow /)
- 5) LOCATION: Elevation: 1817 / Watershed: Power House Hollow
 District: Cabin Creek / County: Kanawha / Quadrangle: Ekdale 7.5'
- 6) WELL OPERATOR A & W Energy Corp. CODE: _____ 7) DESIGNATED AGENT Roland C. Baer, Jr.
 Address P. O. Box 2587 Address P. O. Box 2587
Charleston, WV 25329 Charleston, WV 25329
- 8) OIL & GAS INSPECTOR TO BE NOTIFIED Name Carlos Hively 9) DRILLING CONTRACTOR:
 Address 223 Pinch Ridge Road Address _____
Elkview, WV 25071
- 10) PROPOSED WELL WORK: Drill / Drill deeper / Redrill / Stimulate
 Plug off old formation / Perforate new formation /
 Other physical change in well (specify) _____
- 11) GEOLOGICAL TARGET FORMATION, Injun, Weir, Devonian Shale
- 12) Estimated depth of completed well, 5290 feet
 13) Approximate strata depths: Fresh, 1240 feet; salt, 2140 feet.
 14) Approximate coal seam depths: 2640 Is coal being mined in the area? Yes No

RECEIVED
 DEC - 5 1985
 DIVISION OF OIL & GAS
 DEPARTMENT OF ENERGY

15) CASING AND TUBING PROGRAM

CASING OR TUBING TYPE	SPECIFICATIONS					FOOTAGE INTERVALS		CEMENT FILL-UP OR SACKS (Cubic feet)	PACKERS
	Size	Grade	Weight per ft.	New	Used	For drilling	Left in well		
Conductor									Kinds
Fresh water	9 5/8"	SMLS	32	X		1400'	1400'	300 cts	By Rule 15.05
Coal	7"	SMLS	23	X		2300'	2300'	200 cts	Sizes
Intermediate									
Production	4 1/2"	SMLS	10.5	X		5290'	5290'	200-400 cts	Depths set Or As Required
Tubing									By Rule 15.01
Liners									Perforations:
									Top Bottom

The law requires a comment period for surface owners. However, the permit can be issued in less than 15 days from the filing of the Application if the surface owner(s) of record sign(s) the following "Voluntary Statement of No Objection" on a facsimile of this surface owner's copy of the Application.

VOLUNTARY STATEMENT OF NO OBJECTION

I hereby state that I have read the instructions to surface owners on the reverse side of this Application, and that I have received copies of (1) a Notice of Application for a Well Work Permit on Form WW-2(A), (2) an Application for a Well Work Permit on Form WW-2(B), (3) a survey plat on Form WW-6, and (4) a Construction and Reclamation Plan on Form WW-9, all for proposed well work on my surface land as described therein.

I further state that I have no objection to the planned work described in these materials, and I have no objection to a permit being issued based on those materials.

(For execution by corporation, partnership, etc.) (For execution by natural persons)

NAME: Ohley Land Company

By C. Lynch Christian, III

Its President Date 12/4/85

(Signature) _____ Date _____

(Signature) 12/08/2023

Date _____

INSTRUCTIONS TO SURFACE OWNERS
AND
EXPLANATION OF METHODS AND TIME LIMITS TO COMMENT
ON OIL AND GAS WELL WORK PERMIT

The well operator named in the Notice and this Application and the attached materials is applying for a permit from the State to do oil or gas well drilling or other well work. You are being served with these materials because surface owners have the right to file comments before the permit is issued. (NOTE: If the surface tract is owned by more than three persons, in multiple heirship for example, then these materials were served on you because your name appeared on the Sheriff's tax ticket on the land or because you actually occupy the surface tract. In either case, you may be the only owner who will actually receive these materials.) See Chapter 22B, Article 1 of the W. Va. Code. Permits are valid for 24 months.

If you do not own any interest in the surface tract, please forward these materials to the true owner immediately if you know who it is. Also, please notify the well operator named in the materials and the Director of the Division of Oil and Gas in the West Virginia Department of Energy immediately.

NOTE : YOU ARE NOT REQUIRED TO FILE ANY COMMENT AT ALL.

WHERE TO FILE COMMENTS AND OBTAIN ADDITIONAL INFORMATION :

Director, Division of Oil and Gas
West Virginia Department of Energy
1615 Washington Street, East
Charleston, West Virginia 25311-2192
(304) - 348 - 3500

Who may file comments? If you wish to file comments, you must be an owner of record of (1) and interest in the surface tract on which the well already is or is about to be located, or (2) an interest in any other surface tract over the same oil or gas lease which will be utilized for roads or other land disturbances.

Time limits for comments. The law requires these materials to be delivered on or before the date the operator files his Application. You have FIFTEEN (15) DAYS after the filing date to file your comments as provided in METHODS FOR FILING COMMENTS below. You may call the Director's office at the above telephone number to be sure of the date. However, if you have been contacted by the well operator, and if you have signed a "voluntary statement of no objection" to any of the planned work described in these materials, then the permit may be issued at any time.

Comments must be in writing. Your comments must include your name, address and telephone number, the well operator's name and well number, and the approximate location of the proposed well site including district and county from the application. You may add other documents, such as sketches, maps or photographs to support your comments.

Methods for filing comments. Comments must be filed in person or received in the mail at the Director's office by the time stated above. Check with your postmaster to ensure adequate delivery time or to arrange special expedited handling.

The Director for Oil and Gas has the power to deny or condition a well work permit based on your comments on the following grounds:

- "(1) The proposed well work will constitute a hazard to the safety of persons; or
- "(2) The plan for soil erosion and sediment control is not adequate or effective; or
- "(3) Damage would occur to publicly owned lands or resources; or
- "(4) The proposed well work fails to protect fresh water sources or supplies."

If you want a copy of the permit as it is finally issued, or a copy of the order denying the permit, you should request a copy from the Director.

List of Water Testing Laboratories. The Director maintains a list of water testing laboratories which you can hire to test your water to establish water quality prior to and after drilling. Contact the Director's office or an Oil and Gas Inspector to obtain a copy of the list.

12/08/2023

CAPITOL SOIL CONSERVATION DISTRICT
WESTMORELAND PLACE
400 ALLEN DRIVE
CHARLESTON, WEST VIRGINIA 25302

DATE: OCTOBER 2, 1985

RECEIVED
OCT - 3 1985

WELL SITE: OHLEY 54
Allegheny & Western Energy Corp
DIVISION OF OIL & GAS
DEPARTMENT OF ENERGY

QUADRANGLE: ESKDALE

LANDOWNER: OHLEY LAND COMPANY

PLAN PREPARED BY: George F. Rollins, Jr., A E Associates, Ltd.

PLAN RECEIVED BY CAPITOL SCD ON: SEPTEMBER 30, 1985, delivered by Jr. Rollins

PLAN REVIEWED BY: Linda M. Cable, District Manager, Capitol SCD, on
October 1, 1985.

SITE FIELD REVIEWED YES DATE 9-30-85 NO

RECLAMATION 'PLAN COMMENTS:

up Powerhouse Hollow

(1) The existing road from route 76 to the beginning of the proposed access road requires upgrading. The following practices will help to reduce erosion and aid in maintaining the road:

- Ditch lines need pulled,
- Road needs to be sloped toward ditch line,
- Cross drains need to be installed,
- If a ditch cannot be constructed, then the road must be sloped to the outside and the berm removed.

R. C. Alford

R. C. ALFORD, CHAIRMAN
BOARD OF SUPERVISORS

NOTE: ALL COMMENTS SHOULD BE STUDIED
SO THEY WILL NOT BE REPEATED
ON FUTURE PLANS!

cc: Office of Oil & Gas, WV Dept. of Energy

12/08/2023

RECEIVED
OCT - 3 1985

SITE REGISTRATION APPLICATION FORM
STATE OF WEST VIRGINIA/NPDES GENERAL PERMIT FOR OIL AND GAS
DRILLING PIT WASTE DISCHARGE
DIVISION OF OIL & GAS
DEPARTMENT OF ENERGY

1. Company Name Allegheny & Western Energy Corporation
2. Mailing Address P. O. Box 2587 Charleston, West Virginia 25329
street city state zip
3. Telephone (304) 343-4327
4. Well Name Ohley #54
5. Latitude 38° 05' 00" Longitude 81° 25' 00"
6. NPDES # WV0073343
7. Dept. Oil & Gas Permit NO. 47-039-4267
8. County Kanawha
9. Nearest Town Quarrier
10. Nearest Stream Power House Hollow
11. Tributary of Cabin Creek
12. Will Discharge be Contracted Out? yes x no _____
13. If Yes, Proposed Contractor A E Associates, Ltd.
Address P. O. Box 607 Charleston, West Virginia 25322
Telephone (304) 346-0505
14. Proposed Disposal Method: UIC _____ Land application x*
Off Site Disposal x* Reuse _____ Centralized Treatment _____
Thermal Evaporation x* Other _____ *Note: As Field Conditions Require
15. Attach to this application a topographic map (a duplicate of the one submitted to the Office of Oil and Gas) showing the outline of the facility, location of wells, springs, rivers and other surface water bodies, and drinking water wells known to the applicant in the area of the lease that may be impacted by any land application.

Nothing in the general permit shall be deemed in any way to create new, or enlarge existing, rights of riparian owners or others. Neither does anything in the general permit create new, or enlarge existing, obligations or duties of an operator pursuant to the requirements of W. Va. Code S22-4-1 et seq. The issuance of the general permit does not convey any property rights of any sort. Nor shall the issuance of the general permit give rise to any presumptions of law or findings of fact inuring to or for the benefit of persons other than the State of West Virginia.



WR-35

Date March 1986
Operator's
Well No. Ohley #54
Farm Ohley Land Co
API No. 47 - 039 - 4267

State of West Virginia
DEPARTMENT OF ENERGY
Oil and Gas Division

WELL OPERATOR'S REPORT
OF
DRILLING, FRACTURING AND/OR STIMULATING, OR PHYSICAL CHANGE

WELL TYPE: Oil ___ / Gas X / Liquid Injection ___ / Waste Disposal ___ /
(If "Gas," Production X / Underground Storage ___ / Deep ___ / Shallow X /)

LOCATION: Elevation: 1817 Watershed Power House Hollow
District: Cabin Creek County Kanawha Quadrangle Eskdale

COMPANY Allegheny & Western Energy Corporation
ADDRESS P. O. Box 2587, Charleston, WV 25329
DESIGNATED AGENT Dennis L. Mann
ADDRESS P. O. Box 2587 Charleston, WV 25329
SURFACE OWNER Ohley Lnad Comapny
ADDRESS Lynchburg, VA
MINERAL RIGHTS OWNER J E Watson III
ADDRESS Fairmont, WV
OIL AND GAS INSPECTOR FOR THIS WORK Carlos
Hively ADDRESS Elkview, Wv
PERMIT ISSUED 9-24-85
DRILLING COMMENCED 12-7-85
DRILLING COMPLETED 12-15-85

Casing Tubing	Used in Drilling	Left in Well	Cement fill up Cu. ft.
Size 20-16 Cond.			
13 ³ / ₈ 10	40	40	To Surf
9 5/8	1280	1280	290 sx
8 5/8			
7	2614	2614	175 sx
5 1/2			
4 1/2	5442	5442	250 sx
3			
2			
Liners used			

IF APPLICABLE: PLUGGING OF DRY HOLE ON CONTINUOUS PROGRESSION FROM DRILLING OR REWORKING. VERBAL PERMISSION OBTAINED ON _____

GEOLOGICAL TARGET FORMATION Devonian Shale Depth 33187 feet
Depth of completed well 5442 feet Rotary X / Cable Tools _____
Water strata depth: Fresh 1240 feet; Salt 2140 feet
Coal seam depths: 2640 Is coal being mined in the area? No

OPEN FLOW DATA

Producing formation Injun Pay zone depth 2800 feet
Gas: Initial open flow _____ Mcf/d Oil: Initial open flow _____ Bbl/d
Final open flow 205 Mcf/d Final open flow _____ Bbl/d
Time of open flow between initial and final tests _____ hours
Static rock pressure 580 psig (surface measurement) after 24 hours shut in
(If applicable due to multiple completion--)
Second producing formation Devonian Shale Pay zone depth 3318 feet
Gas: Initial open flow _____ Mcf/d Oil: Initial open flow _____ Bbl/d
Final open flow 320 Mcf/d Oil: Final open flow _____ Bbl/d
Time of open flow between initial and final tests _____ hours
Static rock pressure 580 psig (surface measurement) after 24 hours shut in

(Continue on reverse side)

KAN 4267

DETAILS OF PERFORATED INTERVALS, FRACTURING OR STIMULATING, PHYSICAL CHANGE, ETC.

Perforate 2890-3913 w/45 holes

4071-5314 w/50 holes

Frac with 60,000# 20/40 sand 1000 gallons 15% acid and 1140 MscfN₂

Frac with 60,000# 20/40 sand 1000 gallons 15% acid and 1140 MscfN₂

WELL LOG

FORMATION	COLOR	HARD OR SOFT	TOP FEET	BOTTOM FEET	REMARKS
					Including indication of all fre and salt water, coal, oil and g
Sandstone and Shale			0	1745	
Salt Sand			1745	1866	
Shale			1866	1895	
Salt Sand			1895	2225	
Sand and Shale			2225	2322	
Limestone			2322	2356	
Shale and Sand			2356	2446	
Little Lime			2446	2497	
Salt and Lime			2497	2538	
Big Lime			2538	2800	
Big Injun			2800	2850	
Silty Shale			2850	2908	
Weir			2908	2913	
Silty Shale			2913	3252	
Berea Siltstone			3252	3318	
Devonian Shale			3318	5442	

(Attach separate sheets as necessary)

ALLEGHENY & WESTERN ENERGY CORPORATION

Well Operator

By: Dani L. Man

Date: April 16, 1986

12/08/2023

Note: Regulation 2.02(i) provides as follows:
 "The term 'log' or 'well log' shall mean a systematic
 detailed geological record of all formations, including
 coal, encountered in the drilling of a well."

12-5-85

1R-26
Obverse

INSPECTOR'S PERMIT SUMMARY FORM

WELL TYPE _____
ELEVATION 1817
DISTRICT Cabin Creek
QUADRANGLE Eskdale
COUNTY Kanawha

API# 47-039 - 4267
OPERATOR A+W Energy
TELEPHONE _____
FARM Ohley Land Co.
WELL # Ohley 54

SURFACE OWNER Ohley Land Co
TARGET FORMATION _____
DATE STARTED _____
LOCATION 12-6-85

COMMENTS _____ TELEPHONE _____
DATE APPLICATION RECEIVED _____
NOTIFIED _____ DRILLING COMMENCED 12-2-85

WATER DEPTHS _____, _____, _____, _____
COAL DEPTHS _____, _____, _____, _____

CASING

Ran 1165' feet of 9 5/8 "pipe on 12-9-85 with 440 SKS fill up
Ran 2614 feet of 7 "pipe on 12-12-85 with 1255 SKS fill up
Ran 5374 feet of 4 1/2 "pipe on 12-16-85 with 2505 SKS fill up
Ran _____ feet of _____ "pipe on _____ with _____ fill up
TD 5450 feet on 12-16-85

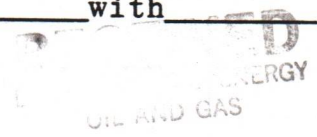

PLUGGING

MAY 27 1986

Type	From	To	Pipe Removed

Pit Discharge date: _____ Type _____
Field analysis ph _____ fe _____ cl _____
Well Record received _____

Date Released 5-20-86

Carlson W. Husley 12/08/2023
Inspector's signature

API# 47039-4267

LIST ALL VISITS FOR THIS PERMIT

	DATE	TIME	PURPOSE	COMMENTS
1	12-6-85		Inspection	Building location
2	12-9-85		"	set surface casing
3	12-12-85		"	set 7" casing
4	12-16-85		"	T.D. hole + set 4 1/2" casing
5	1-9-86		"	well hooked up
6	3-19-86		"	working on Reclamation
7	4-10-86		"	location reclaimed & seeded
8	5-20-86		"	Released.
9				
10				
11				
12				
13				
14				
15				
16				
17				
18				
19				
20				

Notes

COAL COORDINATES

N 9,776.32
E 19,815.13

LATITUDE 38° 05' 00"

LONGITUDE 81° 25' 00"

8,950'

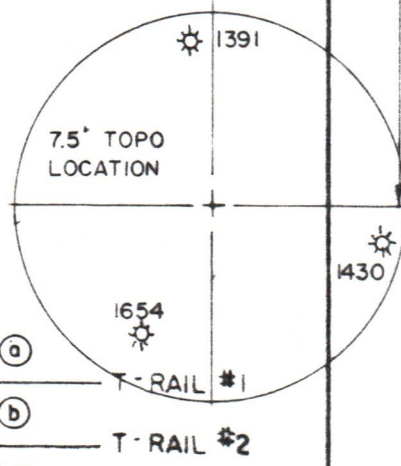
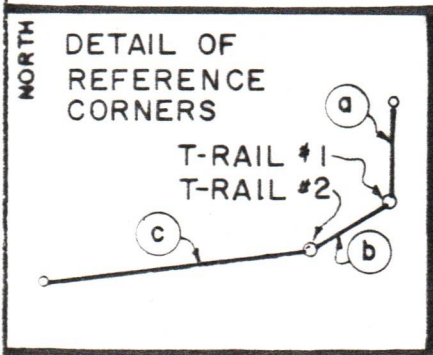
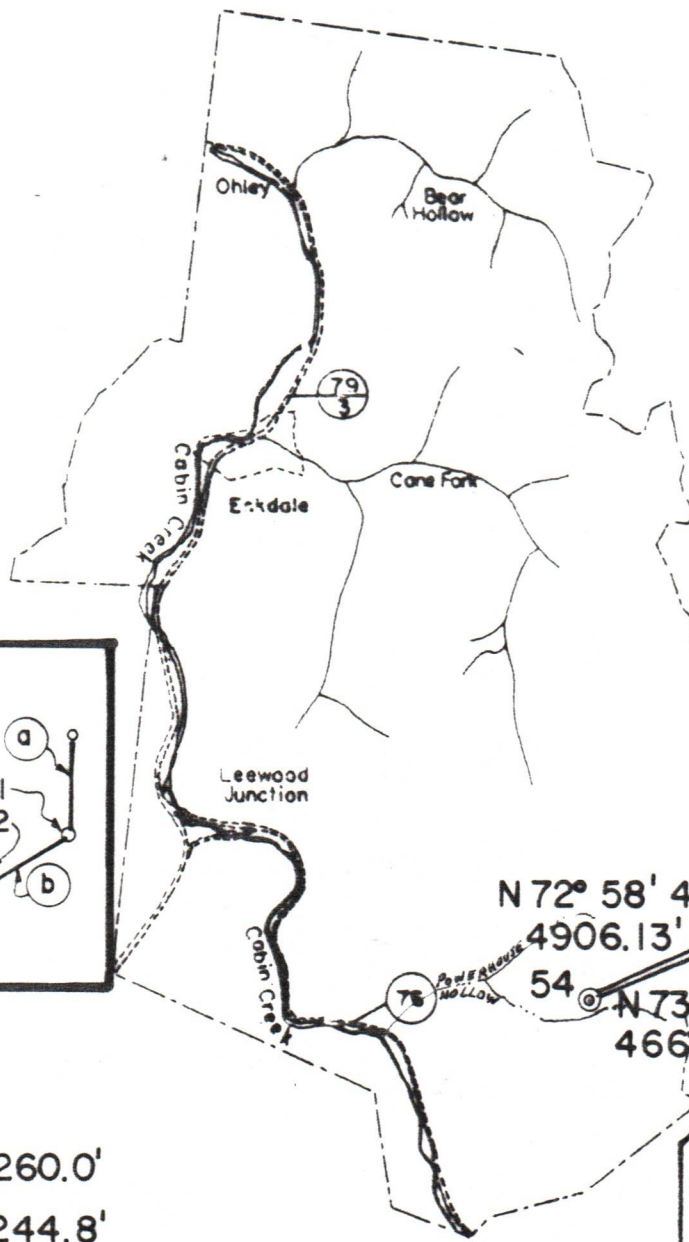

- Ⓐ S 03° 00' W 260.0'
- Ⓑ S 58° 15' W 244.8'
- Ⓒ S 82° 44' W 684.5'

N 72° 58' 48" E
4906.13'
54
N 73° 44' 35" E
4669.98'

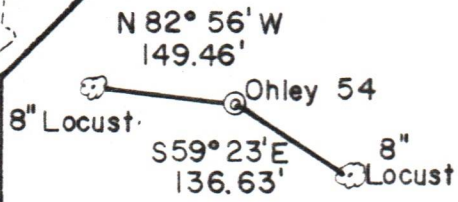

FILE NO. 100002-01
DRAWING NO. _____
SCALE 1" = 4000'
MINIMUM DEGREE OF ACCURACY 1 in 2500'
PROVEN SOURCE OF ELEVATION ESKDALE (812')

I THE UNDERSIGNED, HEREBY CERTIFY THAT THIS PLAT IS CORRECT TO THE BEST OF MY KNOWLEDGE AND BELIEF AND SHOWS ALL THE INFORMATION REQUIRED BY LAW AND THE REGULATIONS ISSUED AND PRESCRIBED BY THE DEPARTMENT OF MINES.
(SIGNED) *Bryan L. Bill*
R.P.E. 8485 L.L.S. _____

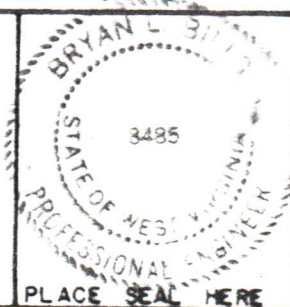

(+) DENOTES LOCATION OF WELL ON UNITED STATES TOPOGRAPHIC MAPS
FORM IV-6
(8-78)



DATE SEPT. 10 19 85
OPERATOR'S WELL NO. 54
API WELL NO. _____
47 - 039 - 4267
STATE COUNTY PERMIT

Department of Mines
Oil & Gas Division

WELL TYPE: OIL ___ GAS LIQUID INJECTION ___ WASTE DISPOSAL ___
(IF "GAS", PRODUCTION STORAGE ___ DEEP ___ SHALLOW
LOCATION: ELEVATION 1817 WATER SHED POWER HOUSE HOLLOW
DISTRICT CABIN CREEK COUNTY KANAWHA
QUADRANGLE ESKDALE 7.5

SURFACE OWNER OHLEY LAND CO. ACREAGE 5438
OIL & GAS ROYALTY OWNER OHLEY COAL CO. LEASE ACREAGE 5438
LEASE NO. _____

12/08/2023

PROPOSED WORK: DRILL CONVERT ___ DRILL DEEPER ___ REDRILL ___ FRACTURE OR STIMULATE PLUG OFF OLD FORMATION ___ PERFORATE NEW FORMATION OTHER PHYSICAL CHANGE IN WELL (SPECIFY) _____

PLUG AND ABANDON ___ CLEAN OUT AND REPLUG ___
TARGET FORMATION MARCELLUS SHALE ESTIMATED DEPTH 5290
WELL OPERATOR ALLEGHENY & WESTERN DESIGNATED AGENT ROLAND C. BAER
ADDRESS 20 BOX 2587 ADDRESS SAME
CHARLESTON, WV 25329