



West Virginia Department of Environmental Protection  
Office of Oil and Gas

**WELL LOCATION FORM: GPS**

API: 047-039-04914φ WELL NO.: Shonk # 43

FARM NAME: Shonk Land Co., LTD.

RESPONSIBLE PARTY NAME: New River Energy Corporation

COUNTY: Kanawha DISTRICT: Cabin Creek

QUADRANGLE: Eskdale 7.5'

SURFACE OWNER: Shonk Land Company, LLC

ROYALTY OWNER: Cabot Oil and Gas

UTM GPS NORTHING: 4208209

UTM GPS EASTING: 461890 GPS ELEVATION: 726 m

The Responsible Party named above has chosen to submit GPS coordinates in lieu of preparing a new well location plat for a plugging permit or assigned API number on the above well. The Office of Oil and Gas will not accept GPS coordinates that do not meet the following requirements:

1. Datum: NAD 1983. Zone: 17 North. Coordinate Units: meters, Altitude: height above mean sea level (MSL) – meters.
2. Accuracy to Datum – 3.05 meters
3. Data Collection Method:  
Survey grade GPS  : Post Processed Differential   
Real-Time Differential   
Mapping Grade GPS  : Post Processed Differential   
Real-Time Differential

4. **Letter size copy of the topography map showing the well location.**  
I the undersigned, hereby certify this data is correct to the best of my knowledge and belief and shows all the information required by law and the regulations issued and prescribed by the Office of Oil and Gas.

	VP - Oil and Gas Operations	9/18/12
Signature	Title	Date

39.04914P

1. ACCESS WILL BE VIA EXISTING SURFACE MINE HALLRoads AND EXISTING ROADS ON TENNILE FURY

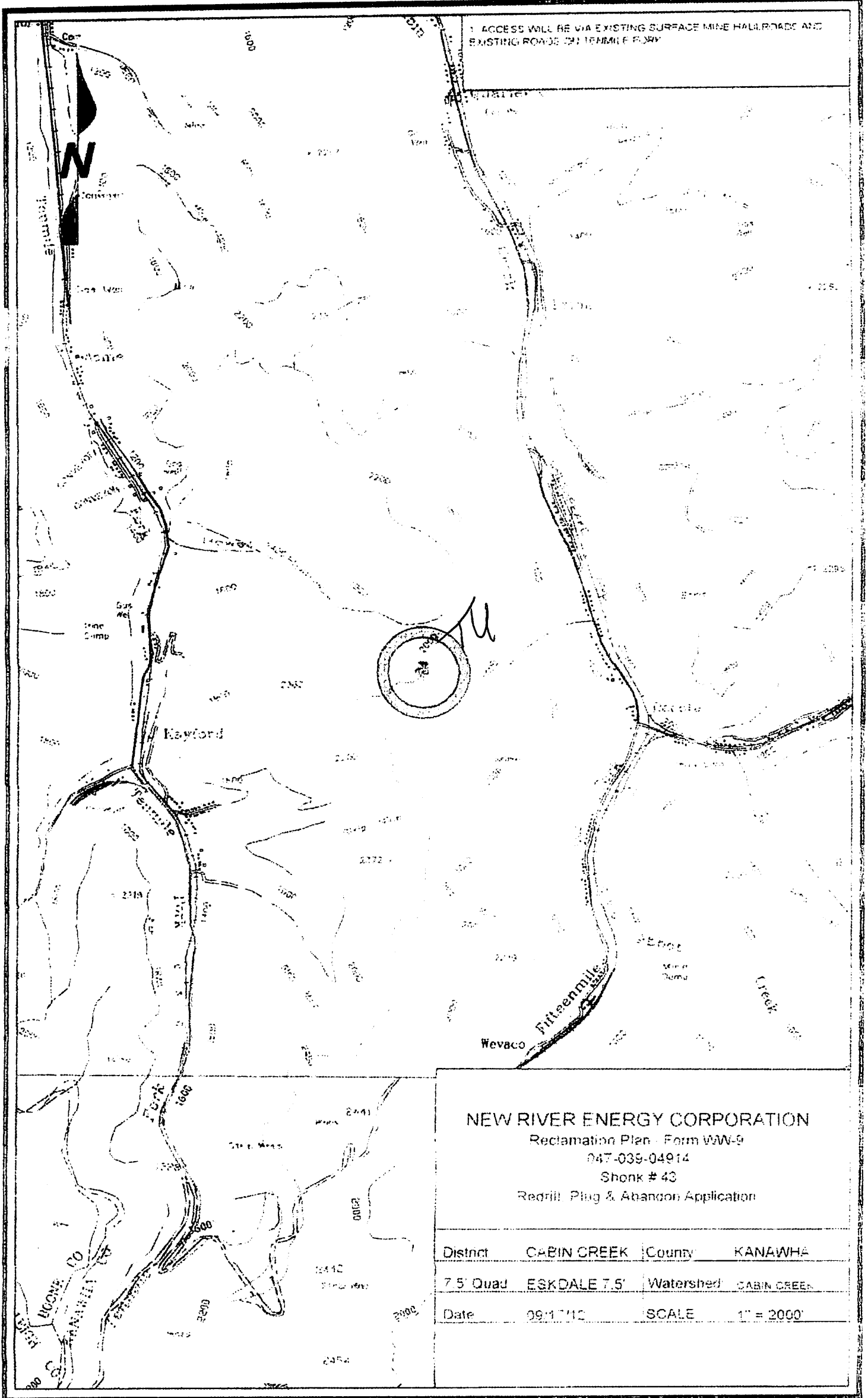

**NEW RIVER ENERGY CORPORATION**

Reclamation Plan - Form WW-9

047-039-04914

Shonk # 43

Redrill, Plug & Abandon Application

District	CABIN CREEK	County	KANAWHA
7.5' Quad	ESKDALE 7.5'	Watershed	CABIN CREEK
Date	09/17/10	SCALE	1" = 2000'

12/07/2012