

NOTE: ALL WELLS IDENTIFIED WITHIN 2400' ARE SHOWN

BRUCE CAMERON
TM 31 PAR. 01
1947/300
9874.11 AC.

NORTH

LEATHERWOOD
CREEK

65

| WELL SITE | |
|---------------------|------------------|
| STATE PLANE WV | |
| SOUTH ZONE NAD 1927 | |
| N - 527,046.08 | E - 1,906,180.54 |
| LATITUDE: 38.4472 | |
| LONGITUDE: 81.3275 | |

(•) DENOTES LOCATION OF WELL ON UNITED STATES TOPOGRAPHIC MAPS

| | |
|----------------------------|--------------------|
| FILE NO. | CA2841R(CI-11).DGN |
| DRAWING NO. | CA 826419 |
| SCALE | 1" = 1000' |
| MINIMUM DEGREE OF ACCURACY | 1:200 |
| PROVEN SOURCE OF ELEVATION | MAPPING GRADE GPS |

I THE UNDERSIGNED, HEREBY CERTIFY THAT THIS PLAT IS CORRECT TO THE BEST OF MY KNOWLEDGE AND BELIEF AND SHOWS ALL THE INFORMATION REQUIRED BY LAW AND THE REGULATIONS ISSUED AND PRESCRIBED BY THE DEPARTMENT OF ENVIRONMENTAL PROTECTION.

(SIGNED) *Paul E. Miller*
R.P.E. _____ L.L.S. _____ 647

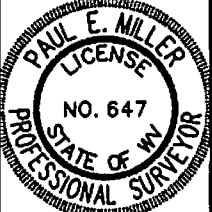
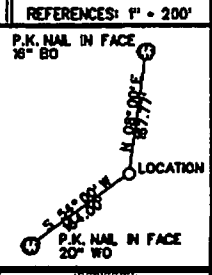

STATE OF WEST VIRGINIA
DIVISION OF ENVIRONMENTAL PROTECTION
OIL AND GAS DIVISION

DATE FEBRUARY 15, 20 07
OPERATOR'S WELL NO. 826419
API WELL NO. _____

WELL TYPE: OIL GAS LIQUID INJECTION WASTE DISPOSAL
(IF "GAS,") PRODUCTION STORAGE DEEP SHALLOW

LOCATION: ELEVATION 1178' WATER SHED LEFT FORK OF LEATHERWOOD CREEK
DISTRICT BIG SANDY COUNTY KANAWHA
QUADRANGLE CLENDENIN, WV 7.5'

SURFACE OWNER BRUCE CAMERON ACREAGE 14.400
OIL & GAS ROYALTY OWNER J. A. HOLLEY, EST., et al. LEASE ACREAGE 5245
LEASE NO. 1004592

PROPOSED WORK: DRILL CONVERT DRILL DEEPER REDRILL FRACTURE OR
STIMULATE PLUG OFF OLD FORMATION PERFORATE NEW
FORMATION OTHER PHYSICAL CHANGE IN WELL (SPECIFY) _____

PLUG AND ABANDON CLEAN OUT AND REPLUG

TARGET FORMATION DEVONIAN SHALE ESTIMATED DEPTH 5765'
WELL OPERATOR CHESAPEAKE APPALACHIA, L.L.C. DESIGNATED AGENT MIKE JOHN
ADDRESS P.O. BOX 6070, CHARLESTON, WV 25362 ADDRESS SAME

FORM W-6

COUNTY NAME
PERMIT