

Latitude 38° 10'

Longitude 81° 25'

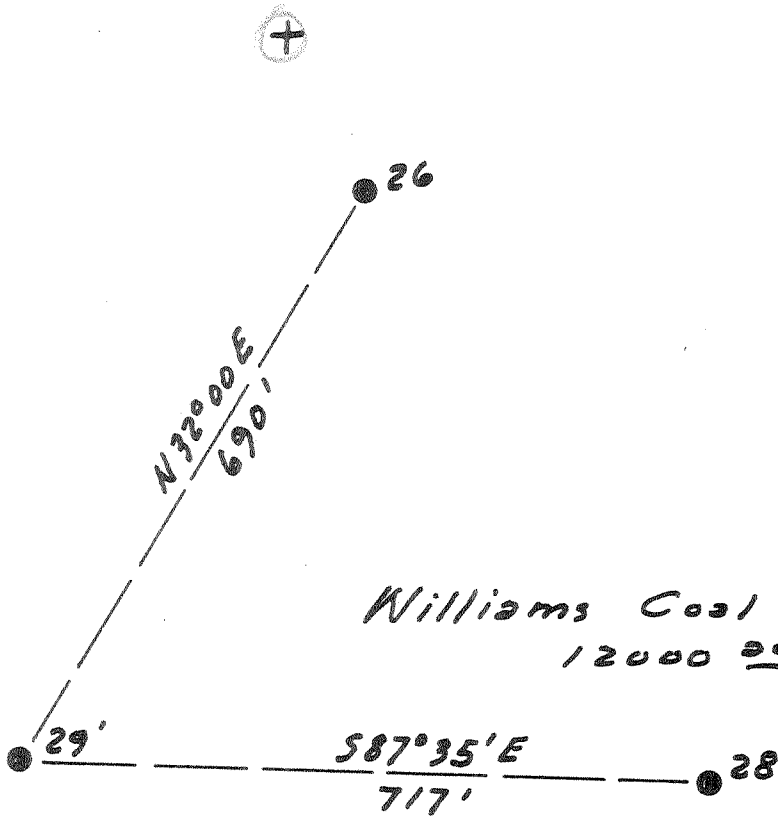

4.37 W  
3.4 R

New Location   
 Drill Deeper   
 Abandonment

Company The Pure Oil Co.  
 Address Newark, Ohio Box 551  
 Farm Williams Coal Co.  
 Tract \_\_\_\_\_ Acres 12000 Lease No. 5012  
 Well (Farm) No. 29 Serial No. 346  
 Elevation (Spirit Level) 1572  
 Quadrangle Montgomery  
 County Kanwha District Cabin Creek  
 Engineer J. B. Hunter  
 Engineer's Registration No. Ohio - 2912  
 File No. \_\_\_\_\_ Drawing No. \_\_\_\_\_  
 Date 5-1-51 Scale 1" = 200'

STATE OF WEST VIRGINIA  
 DEPARTMENT OF MINES  
 OIL AND GAS DIVISION  
 CHARLESTON

WELL LOCATION MAP

FILE NO. KAN-845-A  
 NOW 39-6308

+ Denotes location of well on United States Topographic Maps, scale 1 to 62,500, latitude and longitude lines being represented by border lines as shown.

- Denotes one inch spaces on border line of original tracing.

FO 240

WILLIAMS COAL Co., No. 29 - THE PURE OIL Co. - KAN-845-A



STATE OF WEST VIRGINIA  
DEPARTMENT OF MINES  
OIL AND GAS DIVISION

1649

WELL RECORD

Permit No. KAW 845-A

Oil or Gas Well Water Injection  
(KIND)

Company The Pure Oil Company  
Address P. O. Box 551, Newark, Ohio  
Farm Williams Coal Company Acres 12,000  
Location (waters) \_\_\_\_\_  
Well No. 29 Elev. 1572  
District Cabin Creek County Kanawha  
The surface of tract is owned in fee by Shonk Land Company  
802 Kanawha Banking & Trust Bldg.  
Address Charleston, W. Va.  
Mineral rights are owned by Same as above  
Address \_\_\_\_\_  
Drilling commenced March 7, 1916  
Drilling completed July 7, 1916  
Date Shot 7/8/16 From No record To \_\_\_\_\_  
With 80 Qts. Glycerine

Casing and Tubing	Used in Drilling	Left in Well	Packers
Size			Kind of Packer
16			
13			
10-3/4"	1055'	1055'	Size of
8 1/4"	1918'	None	
6 5/8"	2577' 6"	2577' 6"	In 1925 mudded with Depth set 12 wagon loads of clay
5 3/16"	<del>2527'</del>	2527'	
3"		3221'	Perf. top
2"			Perf. bottom
Liners Used			Perf. top
			Perf. bottom

Open Flow \_\_\_\_\_ /10ths Water in \_\_\_\_\_ Inch  
\_\_\_\_\_ /10ths Merc. in \_\_\_\_\_ Inch  
Volume \_\_\_\_\_ Cu. Ft.  
Rock Pressure \_\_\_\_\_ lbs. \_\_\_\_\_ hrs.  
Oil \_\_\_\_\_ 200 \_\_\_\_\_ bbls., 1st 24 hrs.  
Fresh water 100 372 feet \_\_\_\_\_ feet  
Salt water 1750 2310 feet \_\_\_\_\_ feet

3" tubing cemented with 65 sacks cement  
CASING CEMENTED \_\_\_\_\_ SIZE \_\_\_\_\_ No. Ft. \_\_\_\_\_ Date \_\_\_\_\_  
COAL WAS ENCOUNTERED AT 126 FEET 36 INCHES  
370 FEET 24 INCHES 540 FEET 48 INCHES  
840 FEET 60 INCHES \_\_\_\_\_ FEET \_\_\_\_\_ INCHES

Formation	Color	Hard or Soft	Top	Bottom	Oil, Gas or Water	Depth Found	Remarks
Sand	yellow		0	16			
Sand	gray		16	126	water	100	
Coal	black		126	129			
Slate	black		129	159			
Sand	blue		159	370			
Coal	black		370	372	water	372	5 bailers per hr
Sand	gray		372	540			
Coal	black		540	544			
Slate	black		544	550			
Sand	gray		550	840			
Coal	black		840	845			
Sand	blue & gray		845	985			
Slate	white		985	1015			
Sand	white		1015	1330			
Not recorded on orig. log			1330	1465			
Slate	black		1465	1475			
Grampus	gray		1475	1550			
Slate & shells	Black		1550	1633			
SALT SAND	gray		1633	1850	water	1750	
Slate	black		1850	1853			
SALT SAND	gray		1853	1897			
Slate	black		1897	1905			
Sandy Lime	gray		1905	1907			
Red Rock	red		1907	1910			
Lime	white		1910	1918			
Lime	white		1918	1938			
Sand	pink		1938	1953			
Slate & shells	gray		1953	2040			
Red Rock			2040	2093			
Slate & Shells	gray		2093	2250			
Sand	gray		2250	2380	Water	2310	6 bailers per hr.
Lime	blue		2380	2400			
Slate	black		2400	2405			

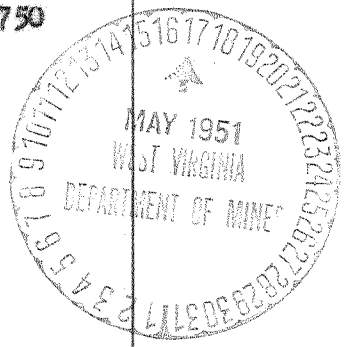

Cont'd on reverse side

(Over)  
FEB 29 1952

Formation	Color	Hard or Soft	Top	Bottom	Oil, Gas or Water	Depth Found	Remarks
Lime	white		2405	2509			
Slate cave	white		2509	2515			
Lime	black		2515	2572			
BIG LIME	white		2572	2767	Gas	2710 and 2732	
BIG INJUN	red		2767	2822			
Slate & shells	gray		2822	3204			
BEREA GRIT	white		3204	3240	oil	3224	
TOTAL DEPTH				3244			

Date May 11, 19 51

APPROVED THE PURE OIL COMPANY, Owner

By [Signature]  
 (Title)  
 Division Superintendent