

UTM NAD.83
17 04 48730E
42 50 963N

WATERLAND TRUCKING
2416/517
TM 36 PAR 17

NAD 83
LAT. 38.4054285N
LONG. 81.5872051W

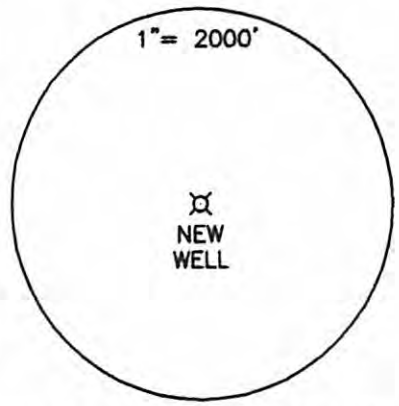

STATE PLANE COOR.
NAD 83
N 512,301
E 1,800,236

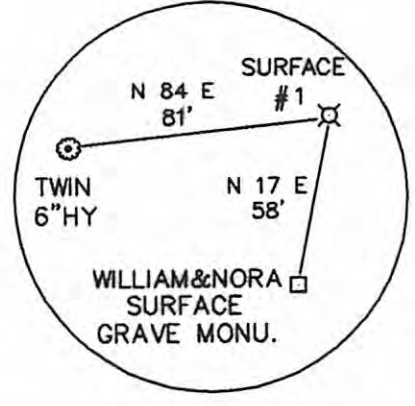

(+) DENOTES LOCATION OF WELL ON UNITED STATES TOPOGRAPHIC MAPS

FILE NO. _____
DRAWING NO. 11-27
SCALE 1"=300
MINIMUM DEGREE OF ACCURACY 1 IN 200
PROVEN SOURCE OF ELEVATION GPS

I THE UNDERSIGNED, HEREBY CERTIFY THAT THIS PLAT IS CORRECT TO THE BEST OF MY KNOWLEDGE AND BELIEF AND SHOWS ALL THE INFORMATION REQUIRED BY LAW AND THE REGULATIONS ISSUED AND PRESCRIBED BY THE DEPARTMENT OF ENERGY.

(SIGNED) *[Signature]*
R.P.E. _____ L.L.S. 851



STATE OF WEST VIRGINIA
Department of Environmental Protection
OFFICE OF OIL AND GAS

DATE 9/6, 2010
OPERATOR'S WELL NO. SURFACE #1
API WELL NO. _____
47 - 039 - 016314
STATE COUNTY PERMIT

WELL TYPE: OIL ___ GAS X LIQUID INJECTION ___ WASTE DISPOSAL ___
(IF "GAS") PRODUCTION X STORAGE ___ DEEP ___ SHALLOW X

LOCATION: ELEVATION 925 WATER SHED _____ MINK SHOAL RUN: _____
DISTRICT ELK COUNTY KANAWHA

QUADRANGLE BIG CHIMNEY

SURFACE OWNER WILLIAM L. SURFACE ACREAGE 6.74
OIL & GAS ROYALTY OWNER WILLIAM L. SURFACE LEASE ACREAGE 10.4
LEASE NO. _____

PROPOSED WORK: DRILL X CONVERT ___ DRILL DEEPER ___ REDRILL ___ FRACTURE OR STIMULATE X PLUG OFF OLD FORMATION ___ PERFORATE NEW FORMATION ___ OTHER PHYSICAL CHANGE IN WELL (SPECIFY): _____

PLUG AND ABANDON ___ CLEAN OUT AND REPLUG ___

TARGET FORMATION BASE OF LOWER HURON/RHINESTREET ESTIMATED DEPTH 5500
WELL OPERATOR RESERVE OIL & GAS INC. DESIGNATED AGENT J. SCOTT FRESHWATER
ADDRESS 929 CHARLESTON ROAD ADDRESS 929 CHARLESTON ROAD
SPENCER, WV 25276 SPENCER, WV 25276

CANCELLED

11/22/2013