

**NOTES**

TIES TO WELLS AND CORNERS ARE BASED ON STATE PLANE GRID NORTH WV SOUTH ZONE NAD '27.  
 TIES TO REFERENCES ARE BASED ON MAGNETIC NORTH 06-06-12.  
 LEASE BOUNDARY SHOWN HEREON TAKEN FROM A DEED RECORDED IN DEED BOOK 2433 AT PAGE 856 AND INFORMATION PROVIDED BY RAVEN RIDGE ENERGY, LLC.  
 SURFACE OWNER AND ADJOINER INFORMATION TAKEN FROM THE ASSESSOR AND COUNTY CLERK RECORDS OF KANAWHA COUNTY IN MAY, 2012 AND INFORMATION PROVIDED BY RAVEN RIDGE ENERGY, LLC.  
 WELL LAT./LONG. ESTABLISHED BY DGPS(SUBMETER MAPPING GRADE).

**CRUM #3A**  
**STATE PLANE**  
**COORDINATES**  
 (N) 545701  
 (E) 1896601

**CRUM #3A**  
**L & L DECIMAL**  
 38.49808  
 81.36129

**CRUM #3A**  
**UTM (NAD 83)**  
 4261154 N  
 468509 E

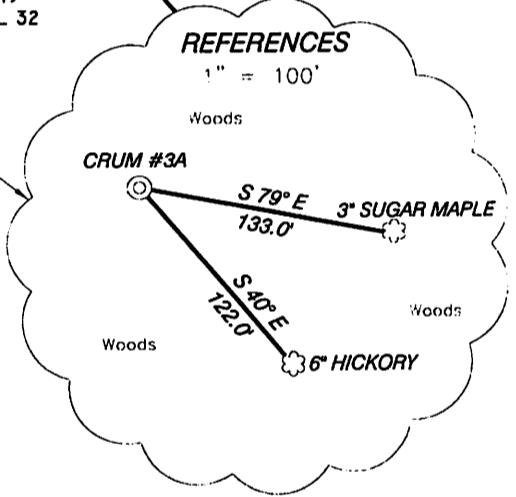
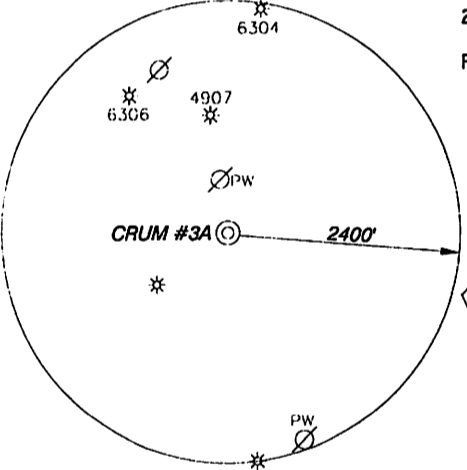

I, THE UNDERSIGNED, HEREBY CERTIFY THAT THIS PLAT IS CORRECT TO THE BEST OF MY KNOWLEDGE AND BELIEF AND SHOWS ALL THE INFORMATION REQUIRED BY LAW AND THE REGULATIONS ISSUED AND PRESCRIBED BY THE DIVISION OF ENVIRONMENTAL PROTECTION.

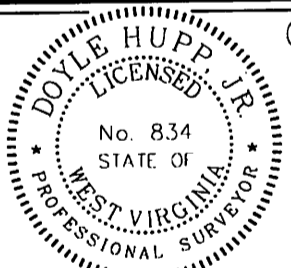

(+) DENOTES LOCATION OF WELL ON UNITED STATES TOPOGRAPHIC MAPS.  
 DATE NOVEMBER 29, 2012  
 OPERATORS WELL NO. CRUM #3A  
 API WELL NO. 47-039-06346  
 STATE COUNTY PERMIT

P.S. 8.54  
  
**HUPP Surveying & Mapping**  
 P.O. Box 647 Grantsville, WV 26147  
 (304) 354-7035 EMAIL: hupp@frontiernet.net

MINIMUM DEGREE OF ACCURACY 1/200 FILE NO. W2144 (BK 60-1)  
 PROVEN SOURCE OF ELEVATION DGPS (SUBMETER GRADE) SCALE 1" = 500'

STATE OF WEST VIRGINIA  
 DIVISION OF ENVIRONMENTAL PROTECTION  
 OFFICE OF OIL AND GAS

WELL TYPE: OIL  GAS  LIQUID INJECTION  WASTE DISPOSAL  IF "GAS" PRODUCTION  STORAGE  DEEP  SHALLOW

LOCATION: ELEVATION 978' WATERSHED SAND BRANCH OF BIG SANDY CREEK  
 DISTRICT BIG SANDY COUNTY KANAWHA QUADRANGLE CLENDENIN 7.5'

SURFACE OWNER DANIEL & LAURA BODKINS ACREAGE 48.16±  
 ROYALTY OWNER AVA CRUM, et al LEASE ACREAGE 146.5±

PROPOSED WORK: DRILL  CONVERT  DRILL DEEPER  REDRILL  FRACTURE OR STIMULATE  PLUG OFF OLD FORMATION  PERFORATE NEW FORMATION  PLUG AND ABANDON  CLEAN OUT AND REPLUG  OTHER

PHYSICAL CHANGE IN WELL (SPECIFY) \_\_\_\_\_ TARGET FORMATION BEREA  
 ESTIMATED DEPTH 3,000'

WELL OPERATOR RAVEN RIDGE ENERGY, LLC. DESIGNATED AGENT RYAN CUNNINGHAM  
 ADDRESS 3230 PENNSYLVANIA AVE. CHARLESTON, WV 25302 ADDRESS 3230 PENNSYLVANIA AVE. CHARLESTON, WV 25302

12/28/2012

# RAVEN RIDGE ENERGY, LLC. CRUM #3A

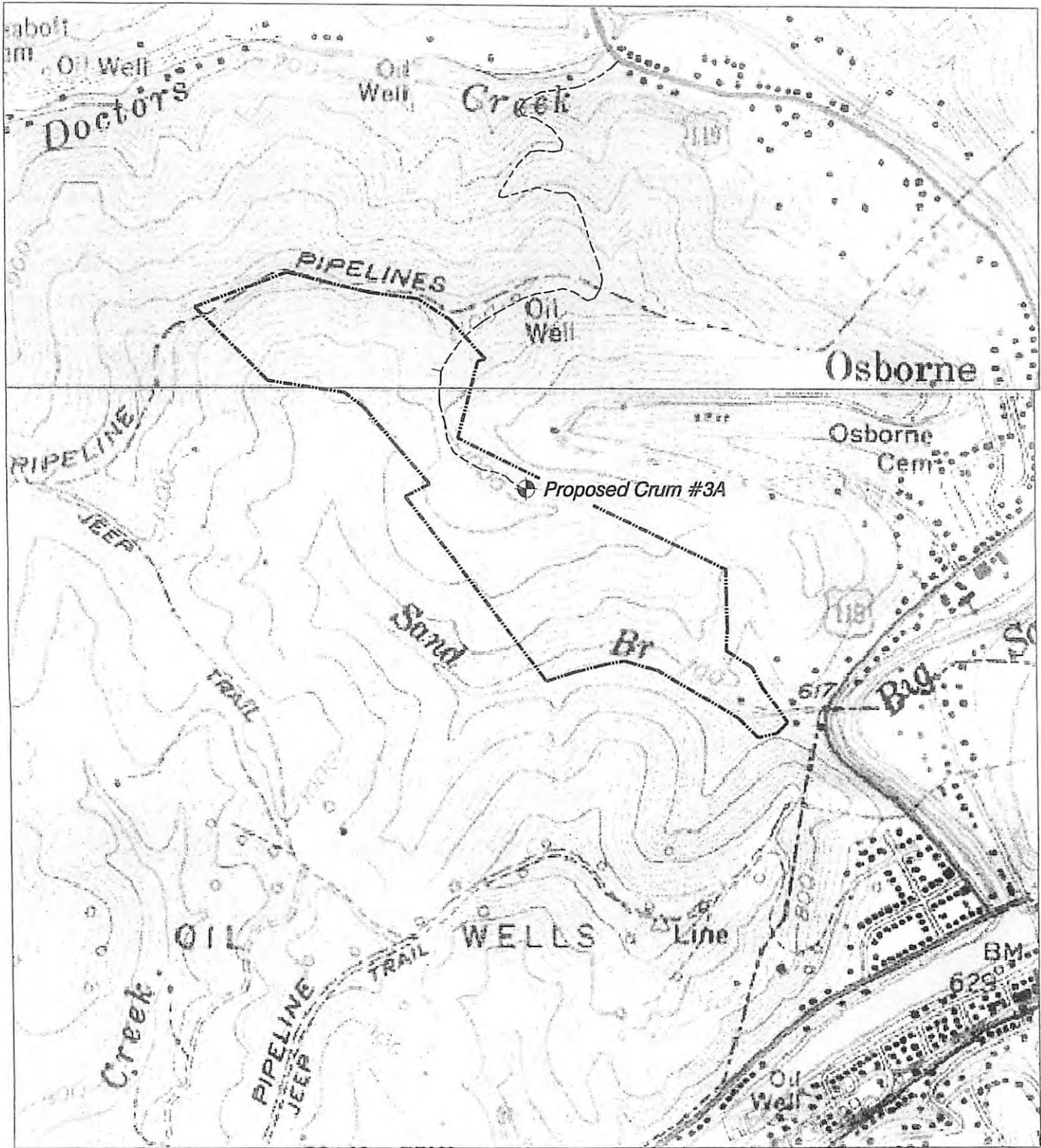

NORTH

### HUPP Surveying & Mapping

P.O. BOX 647 GRANTSVILLE, WV 26147  
PH: (304)354-7035 E-MAIL: hupp@frontiernet.net

1" = 1000'  
Clendenin Quad

Raven Ridge Energy, LLC.  
3230 Pennsylvania Ave.  
Charleston, WV 25302

Office of Environmental Policy  
LET: 1 2016  
WV Department of Environmental Protection