

NOTES

TIES TO WELLS AND CORNERS ARE BASED ON STATE PLANE GRID NORTH WV SOUTH ZONE NAD 83.

TIES TO REFERENCES ARE BASED ON MAGNETIC NORTH 11-28-12.

LEASE BOUNDARY SHOWN HEREON TAKEN FROM A LEGAL DESCRIPTION PROVIDED BY RAVEN RIDGE ENERGY, LLC.

SURFACE OWNER AND ADJOINER INFORMATION TAKEN FROM THE ASSESSOR AND COUNTY CLERK RECORDS OF KANAWHA COUNTY IN MAY, 2012 AND INFORMATION PROVIDED BY RAVEN RIDGE ENERGY, LLC.

WELL 121/100G ESTABLISHED BY DGPS (SUBMETER MAPPING GRADE)

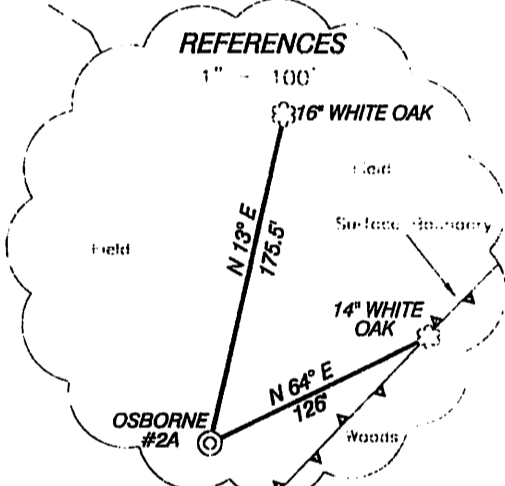

I, Doyle Hupp, Jr., hereby certify that this plat is correct to the best of my knowledge and belief and shows all the information required by law and the regulations issued and prescribed by the Division of Environmental Protection.

Doyle Hupp, Jr.
HUPP Surveying & Mapping
P.O. Box 647 Grantsville, WV 26147
(304) 554-7035 EMAIL: hupp@frontiernet.net

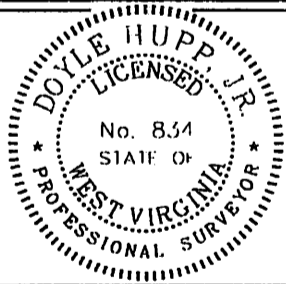

(+) DENOTES LOCATION OF WELL ON ON STATE'S TOPOGRAPHIC MAPS

DATE: NOVEMBER 28, 2013

OPERATORS WELL NO. OSBORNE #2A

API WELL NO. 47-039-06348R

STATE: WV COUNTY: MORGAN

MINIMUM GRID OF ACCURACY: 1/200

FILE NO: W2143 (BK 63--8)

SCALE: 1" = 100'

SOURCE OF ELEVATION: DGPS (SUBMETER GRADE)

STATE OF WEST VIRGINIA
DIVISION OF ENVIRONMENTAL PROTECTION
OFFICE OF OIL AND GAS

WELL TYPE	<input checked="" type="checkbox"/> GAS	<input type="checkbox"/> LIQUID INJECTION	<input type="checkbox"/> WASTE DISPOSAL	<input type="checkbox"/> IF "GAS" PRODUCTION	<input checked="" type="checkbox"/> STORAGE	<input type="checkbox"/> DEEP	<input checked="" type="checkbox"/> SHALLOW
LOCATION	VA. ZON 846' WATERSHED SAND BRANCH OF BIG SANDY CREEK						
DISTRICT	BIG SANDY		COUNTY	KANAWHA			
QUADRANGLE	CLINTON NW 7 1/2		ACREAGE	25.861			
LEASE NO.	124.81		LEASE ACRIAGE	124.81			
PROPOSED WORK:	DRILL <input checked="" type="checkbox"/> CONVERT <input type="checkbox"/> DRILL DEEPER <input type="checkbox"/> REDRILL <input type="checkbox"/> FRACTURE OR STIMULATE <input checked="" type="checkbox"/> PLUG OFF OLD FORMATION <input type="checkbox"/> PERFORATE NEW FORMATION <input type="checkbox"/> PLUG AND ABANDON <input type="checkbox"/> CLEAN OUT AND REPLUG <input type="checkbox"/> OTHER <input type="checkbox"/>						
PHYSICAL CHANGE IN WELL (SPECIFY)	TARGET FORMATION		BEREA				
ESTIMATED DEPTH	3,000'		12/13/2013				

WELL OPERATOR: RAVEN RIDGE ENERGY, LLC. DESIGNATED AGENT: RYAN CUNNINGHAM

ADDRESS: 3230 PENNSYLVANIA AVE. CHARLESTON, WV 25302

3906348R

Form W-9

RAVEN RIDGE ENERGY, LLC. OSBORNE #2A

Page 1 of 1

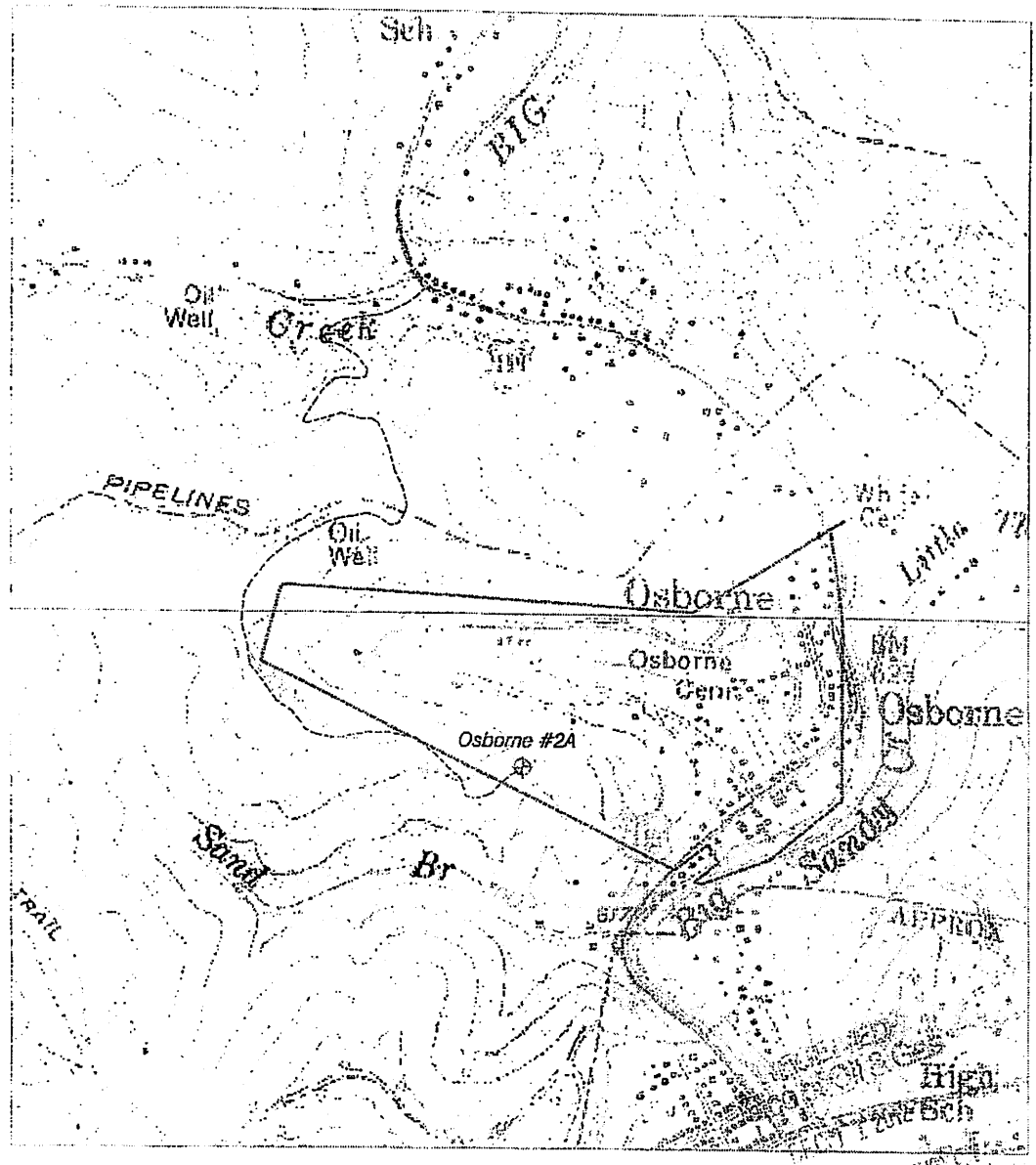

HUPP Surveying & Mapping	1" = 1000' Clendenin Quad	Raven Ridge Energy, LLC. 3230 Pennsylvania Ave. Charleston, WV 25302
P.O. BOX 547 GRANTSVILLE, WV 26147 PH: (304) 354-7035 E-MAIL: hupp@frontiernet.net		

Received

NOV 25 2013

Office of Oil and Gas
WV Dept. of Environmental Protection