

I, THE UNDERSIGNED, HEREBY CERTIFY THAT THIS PLAT IS CORRECT TO THE BEST OF MY KNOWLEDGE AND BELIEF AND SHOWS ALL THE INFORMATION REQUIRED BY LAW AND THE REGULATIONS ISSUED AND PRESCRIBED BY THE DIVISION OF ENVIRONMENTAL PROTECTION.

P.S. 8.34

 HUPP Surveying & Mapping
 P.O. Box 047 Grantsville, WV 26147
 (304) 354-7035 EMAIL: hupp@frontiernet.net

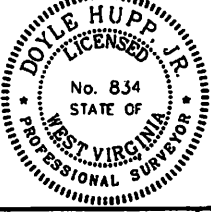

(+) DENOTES LOCATION OF WELL ON UNITED STATES TOPOGRAPHIC MAPS.
 DATE AUGUST 14, 2012
 OPERATORS WELL NO. WHITE #1A
 API WELL NO. 47-039-06354
 STATE COUNTY PERMIT

MINIMUM DEGREE OF ACCURACY 1/200 FILE NO. W2146 (BK 37-48)
 PROVEN SOURCE OF ELEVATION DGPS (SUBMETER GRADE) SCALE 1" = 500'

STATE OF WEST VIRGINIA
 DIVISION OF ENVIRONMENTAL PROTECTION
 OFFICE OF OIL AND GAS

WELL TYPE: OIL GAS LIQUID INJECTION WASTE DISPOSAL IF "GAS" PRODUCTION STORAGE DEEP SHALLOW

LOCATION: ELEVATION 859' WATERSHED TRIBUTARY OF JORDAN CREEK
 DISTRICT BIG SANDY COUNTY KANAWHA QUADRANGLE BLUE CREEK 7.5'

SURFACE OWNER: IRENE SEABOLT ACRES: 25.1
 ROYALTY OWNER: IRENE RUNYON, et al. LEASE ACRES: 112.0

PROPOSED WORK: LEASE NO. _____
 CONVERT DRILL DEEPER REDRILL FRACTURE OR STIMULATION PLUG OR DITCH
 PERFORATE NEW FORMATION PLUG AND ABANDON CLEAN OUT AND REPLUG OTHER _____
 PHYSICAL CHANGE IN WELL (SPECIFY) _____ TARGET FORMATION BERCA
 ESTIMATED DEPTH 3,000'

WELL OPERATOR RAVEN RIDGE ENERGY, L.L.C. DESIGNATED AGENT RYAN CUNNINGHAM
 ADDRESS 3230 PENNSYLVANIA AVE. CHARLESTON, WV 25302 ADDRESS 3230 PENNSYLVANIA AVE. CHARLESTON, WV 25302

03/22/2013

39 06354

Form W-9

Raven Ridge Energy, LLC. White #1A

Page 1 of 1

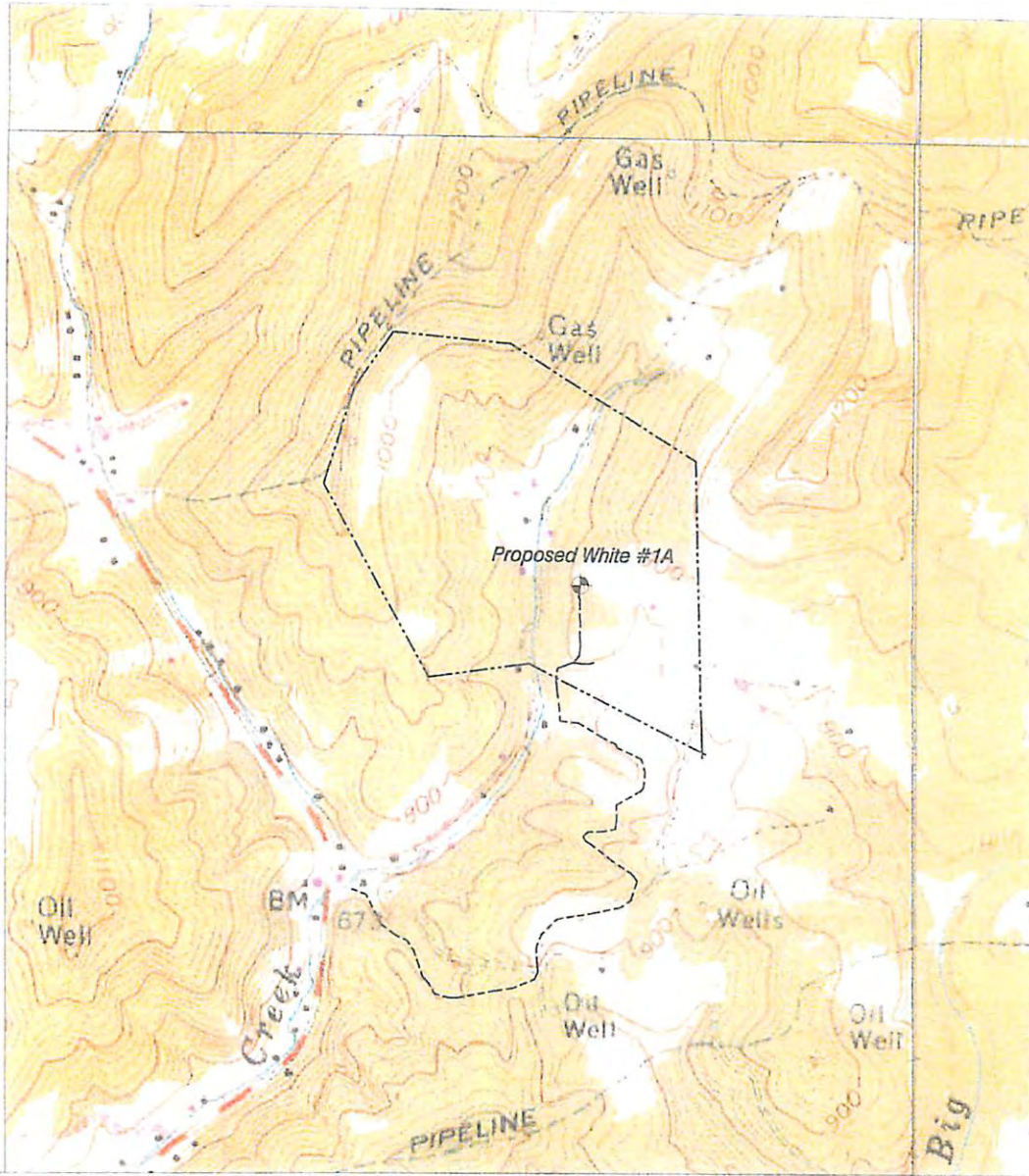

HUPP Surveying & Mapping

P.O. BOX 647 GRANTSVILLE, WV 26147
PH: (304)354-7035 E-MAIL: hupp@frontier.net

1" = 1000'
Blue Creek Quad

Raven Ridge Energy, LLC.
3230 Pennsylvania Ave.
Charleston, WV 25302

Received
Office of Oil & Gas
MAR 15 2013

03/22/2013