

HAYS #9H

HAYS #9H SURFACE HOLE		
WV STATE PLANE COORDINATES	L & L DECIMAL	UTM (NAD 83) ZONE 17 METERS
SOUTH ZONE -NAD 27	NAD 27	
(N) 540701	38.48429	4259830
(E) 1890368	81.38300	488610

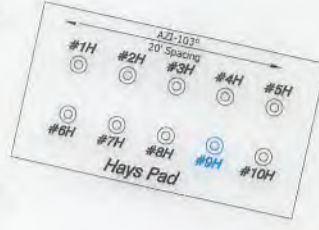

HAYS #9H LANDING POINT		
STATE PLANE COORDINATES	L & L DECIMAL	UTM (NAD 83) ZONE 17 METERS
SOUTH ZONE -NAD 27	NAD 27	
(N) 540435	38.48357	4259549
(E) 1891386	81.37944	488920

HAYS #9H BOTTOM HOLE		
STATE PLANE COORDINATES	L & L DECIMAL	UTM (NAD 83) ZONE 17 METERS
SOUTH ZONE -NAD 27	NAD 27	
(N) 537730	38.47615	4258725
(E) 1892155	81.37671	487155



LINE LEGEND

LEASE BOUNDARY	---
SURFACE BOUNDARY	---
CREEK/STREAM	---
ROADS	---
PROPOSED LATERAL	---
SURVEYED LINE	---

NOTES ON SURVEY

- NO WATER WELLS OR DEVELOPED SPRINGS WITHIN 250' WERE FOUND.
- TIES TO WELLS AND CORNERS ARE BASED ON STATE PLANE GRID NORTH WV SOUTH ZONE NAD '27, WELL LAT./LONG. ESTABLISHED BY DGPS(SUB-METER GRADE).
- SURFACE OWNER AND ADJOINER INFORMATION TAKEN FROM THE ASSESSOR AND COUNTY CLERK RECORDS OF KANAWHA COUNTY IN NOVEMBER, 2018 AND INFORMATION PROVIDED BY CUNNINGHAM ENERGY, LLC.
- WELLS SHOWN ARE TAKEN FROM RECORDS OF WVDEP.

REFERENCES

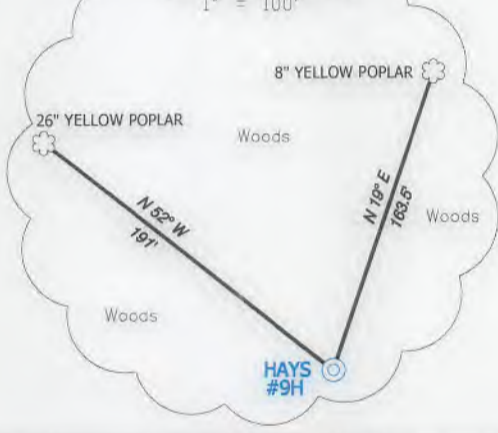

I, THE UNDERSIGNED, HEREBY CERTIFY THAT THIS PLAT IS CORRECT TO THE BEST OF MY KNOWLEDGE AND BELIEF AND SHOWS ALL THE INFORMATION REQUIRED BY LAW AND THE RULES ISSUED AND PRESCRIBED BY THE DEPARTMENT OF ENVIRONMENTAL PROTECTION.

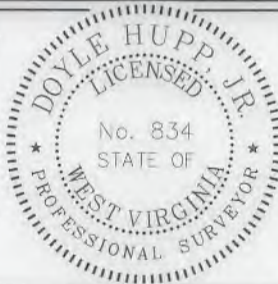

(+) DENOTES LOCATION OF WELL ON UNITED STATES TOPOGRAPHIC MAPS.

DATE MARCH 4, 2019

OPERATORS WELL NO. HAYS #9H

API WELL NO. 47-039-06393H PERMIT

P.S. 834

HUPP Surveying & Mapping
 P.O. Box 647 Grantsville, WV 26147
 (304) 354-7035 EMAIL: hupp@frontiernet.net

MINIMUM DEGREE OF ACCURACY	<u>1/200</u>	FILE NO. <u>W2637 (BK 92-78)</u>
PROVEN SOURCE OF ELEVATION	<u>DGPS (SUBMETER GRADE)</u>	SCALE <u>1" = 1000'</u>

STATE OF WEST VIRGINIA
 DIVISION OF ENVIRONMENTAL PROTECTION
 OFFICE OF OIL AND GAS

WELL TYPE : OIL GAS LIQUID INJECTION WASTE DISPOSAL IF "GAS" PRODUCTION STORAGE DEEP SHALLOW

LOCATION :
 ELEVATION 880' WATERSHED ELK RIVER
 DISTRICT BIG SANDY COUNTY KANAWHA QUADRANGLE BLUE CREEK 7.5'

SURFACE OWNER CUNNINGHAM ENERGY, LLC ACREAGE 34.75±
 ROYALTY OWNER HAYS HEIRS, et al LEASE ACREAGE 93.51±

PROPOSED WORK : LEASE NO. _____
 DRILL CONVERT DRILL DEEPER REDRILL FRACTURE OR STIMULATE PLUG OFF OLD FORMATION PERFORATE NEW FORMATION PLUG AND ABANDON CLEAN OUT AND REPLUG OTHER _____
 PHYSICAL CHANGE IN WELL (SPECIFY) _____ TARGET FORMATION WEIR
 ESTIMATED DEPTH TVD-2000' MD-5870'

WELL OPERATOR CUNNINGHAM ENERGY, LLC. DESIGNATED AGENT RYAN CUNNINGHAM
 ADDRESS 3230 PENNSYLVANIA AVE. CHARLESTON, WV 25302 ADDRESS 3230 PENNSYLVANIA AVE. CHARLESTON, WV 25302

LONGITUDE 81°22'30" 5,735' COUNTY NAME PERMIT