

LATITUDE 30° 25'

LONGITUDE 81° 25'

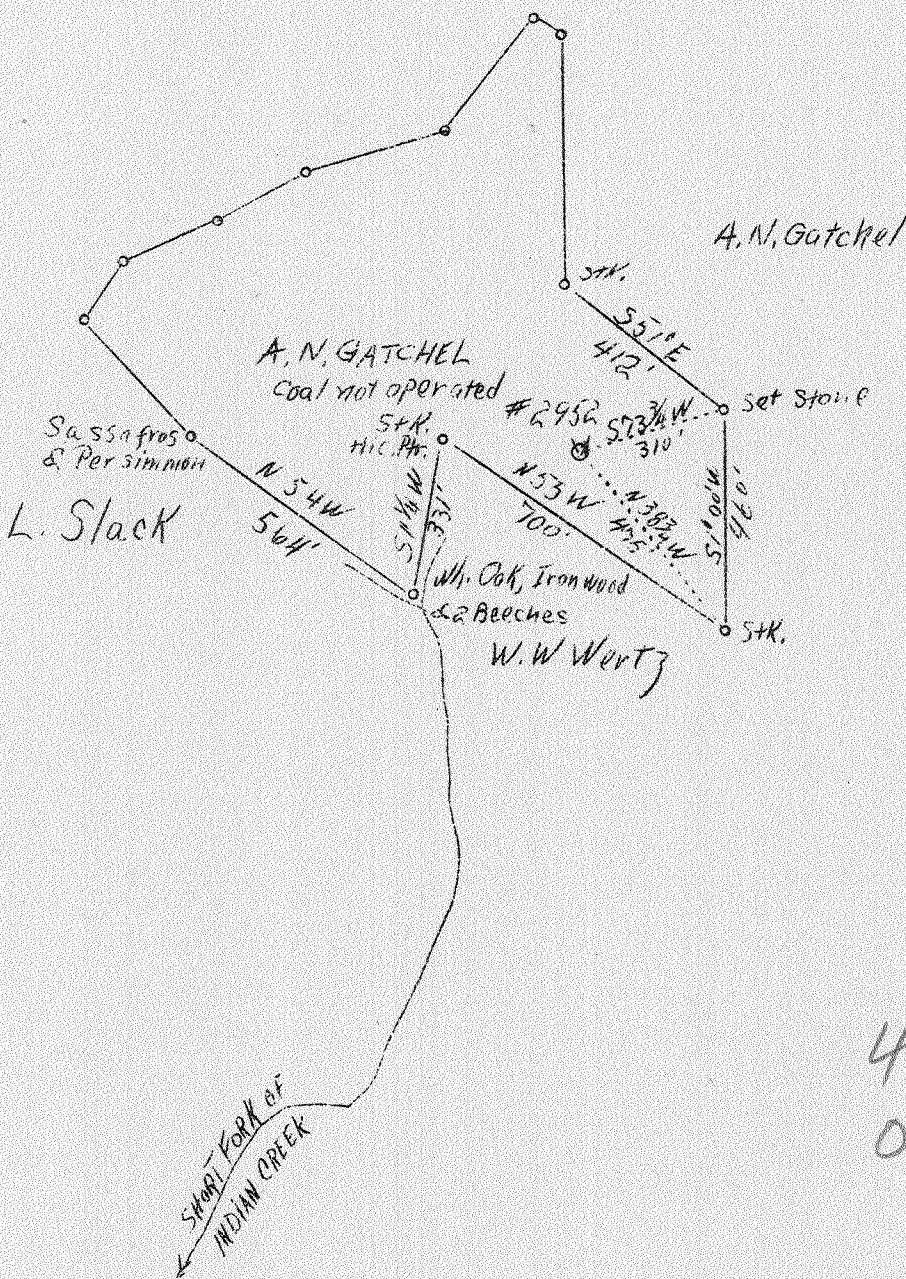
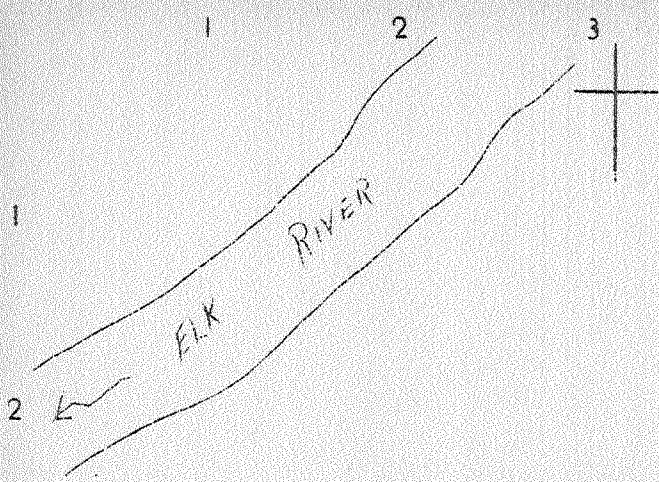

Abd.

APR 18 1938

Company Virginian Gasoline & Oil Co.
 Address Charleston, W.Va.
 Farm A.N. Gatchel.
 Tract Acres 65 Lease No. 724
 Well (Farm) No. 2 Serial No. 2952
 Elevation (Spirit Level) 902'
 Quadrangle Clendenin
 County Kanawha District Elk
 Engineer G.A. Cunningham
 Engineer's Registration 659
 File No. 68-63 Drawing No. _____
 Date April 12, 1938 Scale 1"-400'

STATE OF WEST VIRGINIA
 Department of Mines
 OIL AND GAS DIVISION
 CHARLESTON

WELL LOCATION MAP

File No. Kan-239-A

Denotes location of well on United States Topographic Maps, scale 1 to 62,500, latitude and longitude lines being represented by border lines as shown.

Denotes one inch spaces on border line of original tracing.

239A

Elk District, Kanawha County, W. Va.
 By Virginia Gasoline & Oil Co., Charleston, W. Va.
 On 65 acres, on Elk River.
 Elevation, 902.0' L.
 Surface and minerals owned by A. M. Gatchel, Dial, W. Va.
 Drilling commenced Aug. 3, 1912; completed, Sept. 14, 1912.
 Shot at 2034'.
 Oil, 150 bbls., 1st 24 hrs.
 8 1/2" casing, 460' (pulled); 6 3/4", 1679'.
 Coal was encountered at 268-272, 390-392, and 480-485'.
 Oil well. Abandonment reported to Dept. of Mines Apr. 12, 1938.
 Original depth, 1943'. Deepened to 2067' Nov. 12, 1915.
 Record to ROT from Mrs. Griffith April 14, 1938.

	Top.	Bottom.
Clay	0	14
Slate and shells	14	268
Coal	268	272
Slate	272	310
Lime	310	330
Black slate	330	334
Lime	334	390
Coal	390	392
Slate	392	399
Sand	399	460
Slate	460	480
Coal	480	485
Slate	485	510
Sand	510	570
Shells	570	635
Slate	635	720
Sand	720	786
Slate	786	955
Salt Sand	955	1469
Slate and shells	1469	1514
Marion Sand	1514	1622
Slate	1622	1626
Little Lime	1626	1656
Slate	1656	1665
Shells	1665	1671
Pencil Cove	1671	1675
Pig Lime	1675	1845
Black sand	1845	1870
Red rock	1870	1880
Slate and shells	1880	1926
Sand (oil), (squaw)	1926	1943
Total depth		1943
DRILLED DEEPER NOVEMBER 12, 1915:		
Veir Sand (show of oil, 2040')	2032	2065
Total depth		2067

WEST VIRGINIA DEPARTMENT OF MINES
OIL AND GAS DIVISION

603

WELL RECORD

Permit No. KAW-239-A

Oil or Gas Well Oil
(Kind)

Company Virginian Gasoline & Oil Company
 Address Charleston, W. Va.
 Farm A. N. Gatchel Acres 65
 Location (waters) Elk River
 Well No. 2952 Elev. 902.0
 District Elk County Kanawha
 The surface of tract is owned in fee by A. N. Gatchel
 Address Dial, W. Va.
 Mineral rights are owned by same
 Address _____
 Drilling commenced August 3, 1912
 Drilling completed September 14, 1912
 Date shot _____ Depth of shot 2034
 Open Flow /10ths Water in _____ Inch
 /10ths Merc. in _____ Inch
 Volume _____ Cu. Ft.
 Rock Pressure _____ lbs. _____ hrs.
 Oil 150 _____ bbls., 1st 24 hrs.
 Fresh water _____ feet _____ feet
 Salt water _____ feet _____ feet

Casing and Tubing	Used in Drilling	Left in Well	Packers
Size			Kind of Packer
16			
13			
10			Size of
8 1/4	460	—	
6 5/8	1679	1679	Depth set
5 3/16			
3			Perf. top
2			Perf. bottom
Liners Used			Perf. top
			Perf. bottom

CASING CEMENTED _____ SIZE _____ No. FT. _____ Date _____
 COAL WAS ENCOUNTERED AT 268 FEET 48 INCHES
390 FEET 24 INCHES 480 FEET 60 INCHES
 _____ FEET _____ INCHES _____ FEET _____ INCHES

Formation	Color	Hard or Soft	Top	Bottom	Oil Gas or Water	Depth Found	Remarks
Clay				14			
Slate & Shells			14	268			
Coal			268	272			
Slate			272	310			
Lime			310	330			
Black Slate			330	334			
Lime			334	390			
Coal			390	392			
Slate			392	399			
Sand			399	460			
Slate			460	480			
Coal			480	485			
Slate			485	540			
Sand			540	570			
Shells			570	635			
Slate			635	720			
Sand			720	786			
Slate			786	955			
Salt Sand			955	1469			
Slate & Shells			1469	1514			
Maxon Sand			1514	1622			
Slate			1622	1626			
Little Lime			1626	1656			
Slate			1656	1665			
Shells			1665	1671			
Pencil Cave			1671	1675			
Big Lime			1675	1845			
Black Sand			1845	1870			
Red Rock			1870	1880			
Slate and Shells			1880	1926			
Sand (Oil)			1926	1943			
Total Depth				1943			
Drilled Deeper November 12, 1915							
Weir			2032	2065	Show of Oil	2040	
Total Depth				2067			

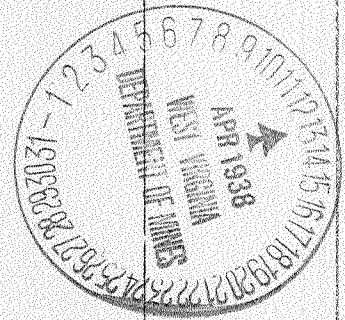

Formation	Color	Hard or Soft	Top	Bottom	Oil, Gas or Water	Depth Found	Remarks

Date April 12, 1938

APPROVED VIRGINIAN GASOLINE & OIL COMPANY, Owner

By G.A. Cunningham
(Title) Engineer