

LATITUDE 38° 25'

LONGITUDE 81° 25'

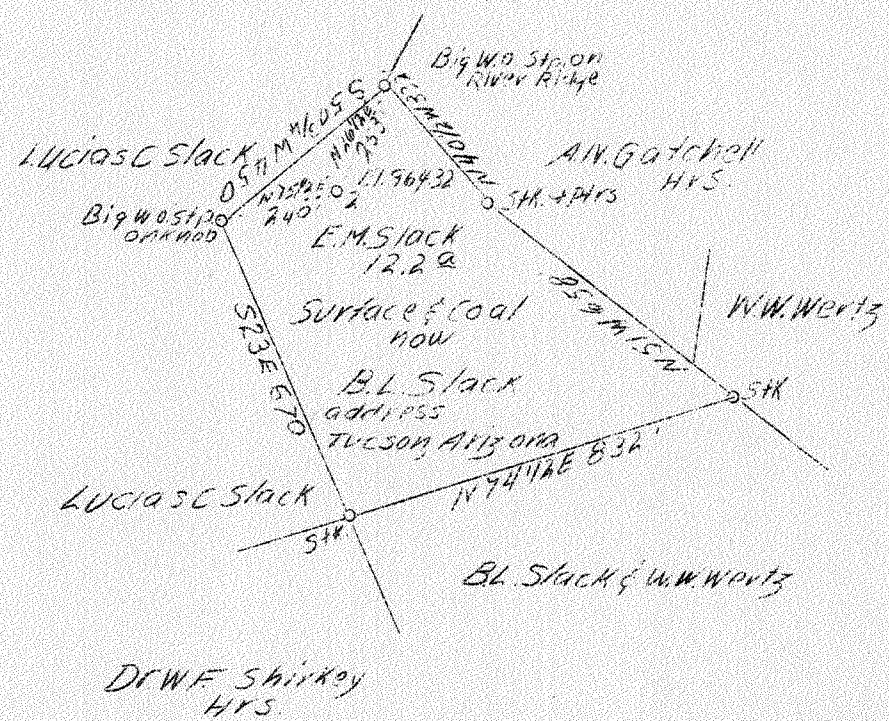

N



4.4W  
0.66 A

✓  
MAR 20 1939

Well to be abrid.

Company	South Penn Oil Co.
Address	411-7th Ave., Pgh., Pa.
Farm	E. M. Slack
Acres	40
Lease No.	62784
Well (Farm) No.	Two
Quadrangle	Clendenin
County	Kanawha
District	Elk
Engineer	E. C. Tabler
Eng. Reg. No.	-
Date	Feb. 9, 1939
Scale	400' - 1"

WC

STATE OF WEST VIRGINIA  
 Department of Mines  
 OIL & GAS DIVISION  
 Charleston

WELL LOCATION MAP

File No. Kan-252-A

x Denotes location of well on U. S. Topographic Maps, scale 1 to 62,500, latitude and longitude lines being represented by border lines as shown.

- Denotes one inch spaces on border line of original tracing.

6-6-1939

744

WELL RECORD

Permit No. 252A

Oil or Gas Well OIL (Kind)

Company SOUTH PENN OIL COMPANY  
 Address 411 Seventh Ave., Pittsburgh, Pa.  
 Farm S. M. Slack Acres 40  
 Location (waters) Indian Creek  
 Well No. 2 Elev. 964.32'  
 District Elk County Kanawha  
 The surface of tract is owned in fee by S. M. Slack Tucson, Arizona  
 Mineral rights are owned by Nellie B. Slack et al o/S. L. Slack, Box 1924 Tucson, Arizona  
 Drilling commenced October 1, 1912  
 Drilling completed November 20, 1912  
 Date shot 8-21-14 Depth of shot Weir  
 9-25-20 Weir  
 Open Flow /10ths Water in Squaw Inch  
 /10ths Merc. in Inch  
 Volume Cu. Ft.  
 Rock Pressure lbs. hrs.  
 Oil 25 bbls., 1st 24 hrs.  
 Fresh water feet feet  
 Salt water 1110 feet feet

Casing and Tubing	Used in Drilling	Left in Well	Packers
Size			Kind of Packer
16			
13			
10			Size of
8 1/4	515'		
6 5/8	1760'		Depth set
5 3/16			
3			Perf. top
2			Perf. bottom
Liners Used			Perf. top
Cond. 10'			Perf. bottom

CASING CEMENTED SIZE No. FT. Date  
 COAL WAS ENCOUNTERED AT 360 FEET 48 INCHES  
 480 FEET 60 INCHES FEET INCHES  
 FEET INCHES FEET INCHES

Formation	Color	Hard or Soft	Top	Bottom	Oil Gas or Water	Depth Found	Remarks
Mud, Slate & Red Rock				100			
Sand			100	130			
Slate & Shells			130	360			
Coal			360	364			
Sand			364	420			
Slate			420	440			
Sand			440	480			
Coal			480	485			
Lime & Slate			485	600			
Sand			600	730			
Slate & Shells			730	1030			
Salt Sand			1030	1600			
Slate			1600	1605	Water	1110	Hole Full
Maxon Sand			1605	1700			
Little Lime			1700	1718			
Pencil Cave			1718	1725			
Big Lime			1725	1880			
Big Injun Sand			1880	1920			
Red Rock, Slate & Shells			1920	2000			
Squaw Sand			2000	2006			
Slate			2006	2008	Gas & Oil	2000	
Sand			2008	2021	Oil	2008	
Total Depth				2021			
DRILLED DESPER: Commenced Feb. 12, 1914. Completed Feb. 21, 1914.							
Commenced drilling			2021				
Slate & Shells			2021	2130			
Weir Sand			2130	2162	Oil	2148-50	
Total Depth				2162			

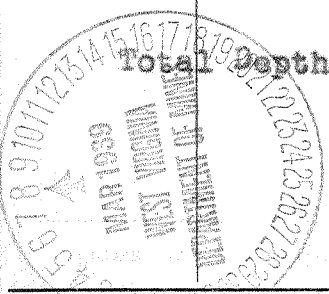

MAY 21 1930

