

LATITUDE 38° 25'

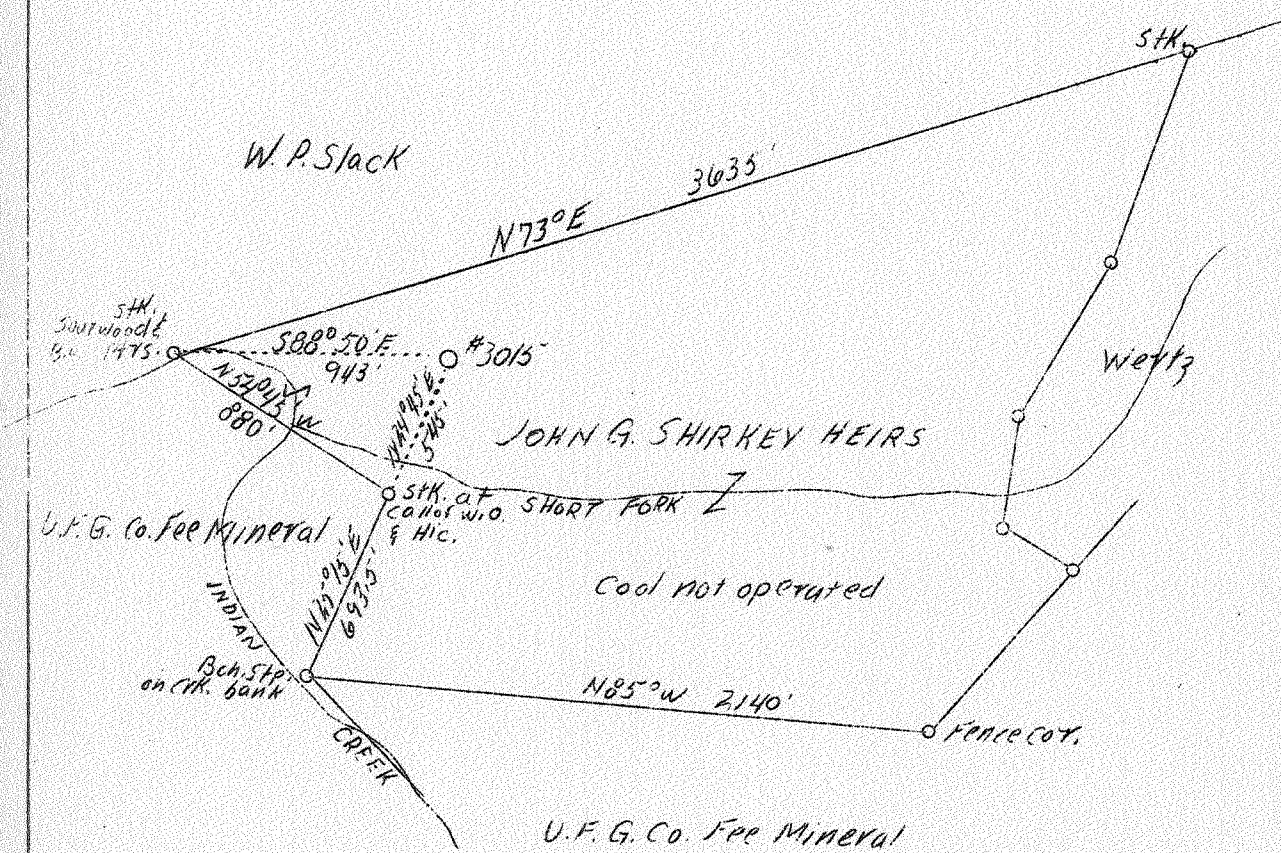

LONGITUDE 81° 30'



0.3 W
0.194 R

✓ JUL 10 1939

ABD.

Company	Virginian Gasoline & Oil Co.	STATE OF WEST VIRGINIA
Address	Charleston, W. Va.	Department of Mines
Farm	John G. Shirkey Heirs	OIL & GAS DIVISION
Acres	90	Charleston
Lease No.	898	
Well (Farm) No.	6	WELL LOCATION MAP
Serial No.	3015	File No. <u>KAN-271-A</u>
Elevation (SL)	701.0°	
Quadrangle	Charleston	
County	Kanawha	
District	Elk	
Engineer	G. A. Cunningham	x Denotes location of well on U. S. Topographic Maps, scale 1 to 62,500, latitude and longitude lines being represented by border lines as shown.
Eng. Reg. No.	659	- Denotes one inch spaces on border line of original tracing.
File No.	68-63	
Date	June 29, 1939	
Scale	1" = 660'	

STATE OF WEST VIRGINIA
DEPARTMENT OF MINES
OIL AND GAS DIVISION

765

WELL RECORD

Aband
Permit No. 271-A
Charleston EC.

Oil or Gas Well Oil
(Kind)

Company Virginian Gasoline & Oil Co.
Address Charleston, W. Va.
Farm John G. Shirkey Hrs. Acres 90
Location (waters) Indian Creek
Well No. 3015 Elev. 701
District Elk County Kanawha
The surface of tract is owned in fee by J. G. Shirkey Hrs.
Address Charleston, W. Va.
Mineral rights are owned by Same
Address _____
Drilling commenced Nov. 9, 1912
Drilling completed Dec. 23, 1912
Date shot _____ Depth of shot 1843
Open Flow /10ths Water in _____ Inch
/10ths Merc. in _____ Inch
Volume _____ Cu. Ft.
Rock Pressure _____ lbs. _____ hrs.
Oil 3 _____ bbls., 1st 24 hrs.
Fresh water _____ feet _____ feet
Salt water 850 and 1539 feet _____ feet

Casing and Tubing	Used in Drilling	Left in Well	Packers
Size			
16			Kind of Packer
13			
10			Size of
8 1/4	<u>430</u>	<u>---</u>	
6 5/8	<u>1474</u>	<u>1474</u>	Depth set
5 3/16			
3			Perf. top
2			Perf. bottom
Liners Used			Perf. top
			Perf. bottom

CASING CEMENTED _____ SIZE _____ No. FT. _____ Date _____
COAL WAS ENCOUNTERED AT 110 FEET 48 INCHES
_____ FEET _____ INCHES 280 FEET 36 INCHES
_____ FEET _____ INCHES _____ FEET _____ INCHES

Formation	Color	Hard or Soft	Top	Bottom	Oil Gas or Water	Depth Found	Remarks
Sand & shale			--	110			Pay in Squaw 1754 - 1758
Coal			110	114			
Slate			114	280			
Coal			280	283			
Slate & Shells			283	350			
Lime			350	395			
Sand			395	435			
Slate & Shells			435	450			
Sand			450	500			
Black Slate			500	525			
Lime			525	575			
Slate & Shells			575	630			
Big Dunkard			630	670			
Slate & Shells			670	735			
Salt Sand			735	1280			Hole full water 850'
Slate			1280	1290			
Lime			1290	1350			
Maxon Sand			1350	1400			
Little Lime			1400	1425			
Break			1425	1428			
Lime			1428	1438			
Pencil Cave			1438	1445			
Big Lime			1445	1605			Water in Lime 1539'
Injun Sand			1605	1635			
Red Rock			1635	1652			
Slate & Shells			1652	1726			
Squaw Sand			1726	1739			
Slate & Shells			1739	1808			
Shell			1808	1813			
Slate & Shell			1813	1839			
Weir Sand			1839	1854			2nd Pay 1844-1848
Break			1854	1861			Show of Gas in Squaw
Sand			1861	1870			
Total Depth				1870			

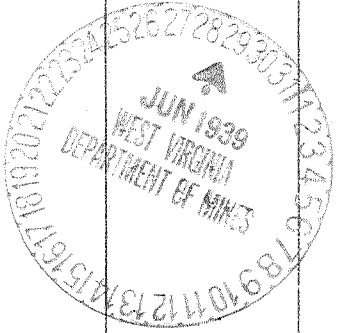

Formation	Color	Hard or Soft	Top	Bottom	Oil, Gas or Water	Depth Found	Remarks

Date June 29, 1939

APPROVED VIRGINIAN GASOLINE & OIL CO., Owner

By G.A. Cunningham
(Title)