

New Location   
 Drill Deeper   
 Abandonment

Company VIRGINIAN GASOLINE & OIL CO.  
 Address CHARLESTON, WVA.  
 Farm VIRGINIAN GASOLINE & OIL CO. MIN.  
 Tract \_\_\_\_\_ Acres LOTS Lease No. 21775  
 Well (Farm) No. 1 Serial No. 1721  
 Elevation (BAROMETER) 753  
 Quadrangle CLENDENIN  
 County KANAWHA District CABIN CREEK  
 Engineer [Signature]  
 Engineer's Registration No. 659  
 File No. 74-51 Drawing No. \_\_\_\_\_  
 Date MARCH 19, 1940 Scale 1" = 100'

STATE OF WEST VIRGINIA  
 DEPARTMENT OF MINES  
 OIL AND GAS DIVISION  
 CHARLESTON

**WELL LOCATION MAP**  
 FILE NO. KAN-290A

+ Denotes location of well on United States Topographic Maps, scale 1 to 62,500, latitude and longitude lines being represented by border lines as shown.

- Denotes one inch spaces on border line of original tracing.

AFFIDAVIT IN TRIPLICATE TO TIME AND MANNER OF PLUGGING AND FILLING WELL

(Required by Section 9, Chapter 98, Acts 1939)

WEST VIRGINIA DEPARTMENT OF MINES OIL AND GAS SECTION

H. Commercial Coal

COAL OPERATOR

Silman Oil Co., 311 Penn. Ave., Charleston, W. Va.

June 10, 1940

WELL AND LOCATION

Big Sandy District

Mason County

Well No. 1

M. Cummings Farm

Affidavit to be made in triplicate. One copy to be filed by agent or other with the Department. One copy to be retained by the coal operator and the third copy (and extra copies if required) to be mailed to each coal operator above named at their respective addresses.

AFFIDAVIT

STATE OF WEST VIRGINIA,

COUNTY OF Mason

being first duly sworn according to law deposes and says that they are experienced in the work of plugging

and filling oil and gas wells and were employed by Silman Oil Co., well operator, and participated in the work of plugging and filling the above well, that said work was commenced on the

25 day of April, 1940, and that the well was plugged and filled in the following manner:

Manner in which sand was plugged: Total Depth 1780 Clay 1780 to 1870 Seed Plug 1870 to 1887 Cement 1887 to 1887 Clay 1887 to 1880 Pulled 6 5/8 casing Hole Bridged 70 feet Cement 70 to 60 Clay 60 to Surface

Manner in which coal was plugged:

Description of monument:

Cemented post on surface 6"x6"x6"

and that the work of plugging and filling said well was completed on the 8 day of June

1940. And further deposes and swears that

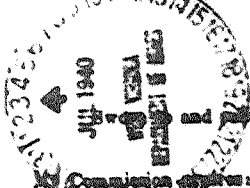

sworn and subscribed before me this 27 day of June, 1940

W. A. 112160

Commission expires:

Notary Public

7/27/40, 1950

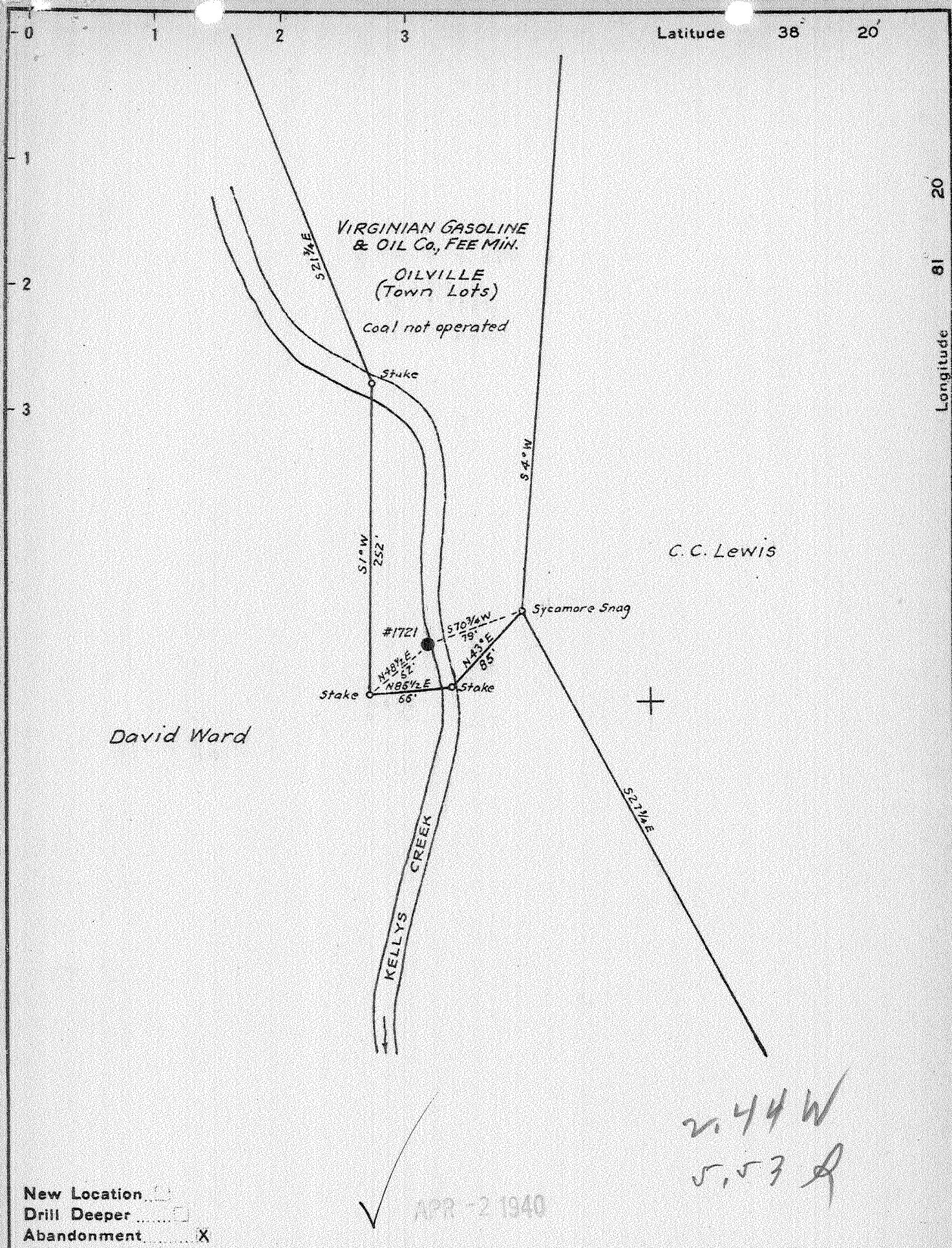

Company	VIRGINIAN GASOLINE & OIL CO.
Address	CHARLESTON, W.VA.
Farm	VIRGINIAN GASOLINE & OIL CO., MIN.
Tract	Acres LOTS Lease No. 21775
Well (Farm) No.	1 Serial No. 1721
Elevation (BAROMETER)	753
Quadrangle	CLENDENIN
County	KANAWHA District CABIN CREEK
Engineer	
Engineer's Registration No.	659
File No.	74-51 Drawing No.
Date	MARCH 19, 1940 Scale 1" = 100'

STATE OF WEST VIRGINIA  
DEPARTMENT OF MINES  
OIL AND GAS DIVISION  
CHARLESTON

WELL LOCATION MAP  
FILE NO. KAN-290A

+ Denotes location of well on United States Topographic Maps, scale 1 to 62,500, latitude and longitude lines being represented by border lines as shown.

- Denotes one inch spaces on border line of original tracing.

Cabin Creek District, Kanawha County, W. Va.  
By Virginian Gasoline & Oil Co., Charleston, W. Va. 200A  
Abandoned under permit Kan-....-A.

On Lots, Kelleys Creek.

Elevation, 753' L.

Minerals owned by Virginian Gasoline & Oil Co., Charleston, W. Va.

Drilling commenced February 1, 1919; completed, April 2, 1919.

13" casing, 27'; 10", 210'; 8 $\frac{1}{4}$ ", 1120'; 6 $\frac{5}{8}$ ", 1500'; all left in.

Coal was encountered at 185-187'.

12 $\frac{1}{2}$ " casing, 27'; 10", 210'; 8 $\frac{1}{4}$ ", 1120'; 6 $\frac{5}{8}$ ", 1500'; all left in.

Oil well. Abandonment reported to Dept. of Mines March 19, 1940.

Record to RCT from Mrs. Griffith March 27, 1940.

	Top.	Bottom.
Gravel	0	27
Slate	27	185
Coal	185	187
Slate	187	280
Sand	280	330
Lime	330	380
Sand	380	480
Slate	480	500
Lime	500	580
Slate	580	585
Lime	585	605
Slate	605	610
Grampus Sand	610	700
Slate	700	760
Salt Sand	760	915
Slate	915	990
2nd Salt Sand	990	1080
Slate	1080	1100
Lime	1100	1130
Red rock	1130	1140
Slate	1140	1200
Lime	1200	1240
Slate	1240	1280
Red rock	1280	1300
Maxton Sand	1300	1350
Slate	1350	1410
Little Lime	1410	1450
Pencil Cave slate	1450	1470
Lime	1470	1475
Pencil Cave	1475	1485
Big Lime	1485	1700
Big Injun Sand	1700	1750
Slate	1750	1774
Weir Sand (show oil, 1900'; oil pay, 1918-1933')	1774	1936
Black lime	1936	1939
Total depth		1945

STATE OF WEST VIRGINIA  
DEPARTMENT OF MINES  
OIL AND GAS DIVISION

816

Adams  
290-A 3

WELL RECORD

Permit No. ....

Oil or Gas Well Oil  
(Kind)

Company Virginian Gasoline & Oil Company  
 Address Charleston, W. Va.  
 Farm Wm. H. Thomas Hrs. Acres Lots  
 Location (waters) Kelleys Creek  
 Well No. 1721 Elev. 753  
 District Cabin Creek County Kanawha  
 The surface of tract is owned in fee by .....  
 Address .....  
 Mineral rights are owned by Virginian Gaso. & Oil Co.  
 Address Charleston, W. Va.  
 Drilling commenced February 1, 1919  
 Drilling completed April 2, 1919  
 Date shot ..... Depth of shot .....  
 Open Flow /10ths Water in ..... Inch  
 /10ths Merc. in ..... Inch  
 Volume ..... Cu. Ft.  
 Rock Pressure ..... lbs ..... hrs.  
 Oil ..... bbls., 1st 24 hrs.  
 Fresh water ..... feet ..... feet  
 Salt water ..... feet ..... feet

Casing and Tubing	Used in Drilling	Left in Well	Packers
Size			
16			Kind of Packer
13	27	27	
10	210	210	Size of
8 1/4	1120	1120	
6 5/8	1500	1500	Depth set
5 3/16			
3			Perf. top
2			Perf. bottom
Liners Used			Perf. top
			Perf. bottom

CASING CEMENTED ..... SIZE ..... No. Ft. .... Date  
 COAL WAS ENCOUNTERED AT 185 FEET 24 INCHES  
 FEET INCHES FEET INCHES  
 FEET INCHES FEET INCHES

Formation	Color	Hard or Soft	Top	Bottom	Oil, Gas or Water	Depth Found	Remarks
Gravel				27			
Slate			27	185			
Coal			185	187			
Slate			187	280			
Sand			280	330	12-1/2 Casing - 27 ft.		
Line			330	380	10 in. Casing 210 "		
Sand			380	480	8-1/4 ..... 1120 "		
Slate			480	500	6-5/8 ..... 1500 "		
Line			500	580			
Slate			580	585			All casing left in well
Line			585	605			
Slate			605	610			
Sand (Grampus)			610	700			
Slate			700	760			
Salt Sand			760	915			
Slate			915	990			
2nd Salt Sand			990	1080			
Slate			1080	1100			
Line			1100	1130			
Red Rock			1130	1140			
Slate			1140	1200			
Line			1200	1240			
Slate			1240	1280			
Red Rock			1280	1300			
Maxon Sand			1300	1350			
Slate			1350	1410			
Little Line			1410	1450			
Pencil Cave Slate			1450	1470			
Line			1470	1475			
Pencil Cave			1475	1485			
Big Line			1485	1700			
Big Injun			1700	1750			
Slate			1750	1774			
Weir Sand			1774	1936			
Black Line			1936	1939			
Show Oil			1900				
Oil Pay			1918	1933			
Total Depth				1945			



