

Latitude 38° 10'

Longitude 81° 25'

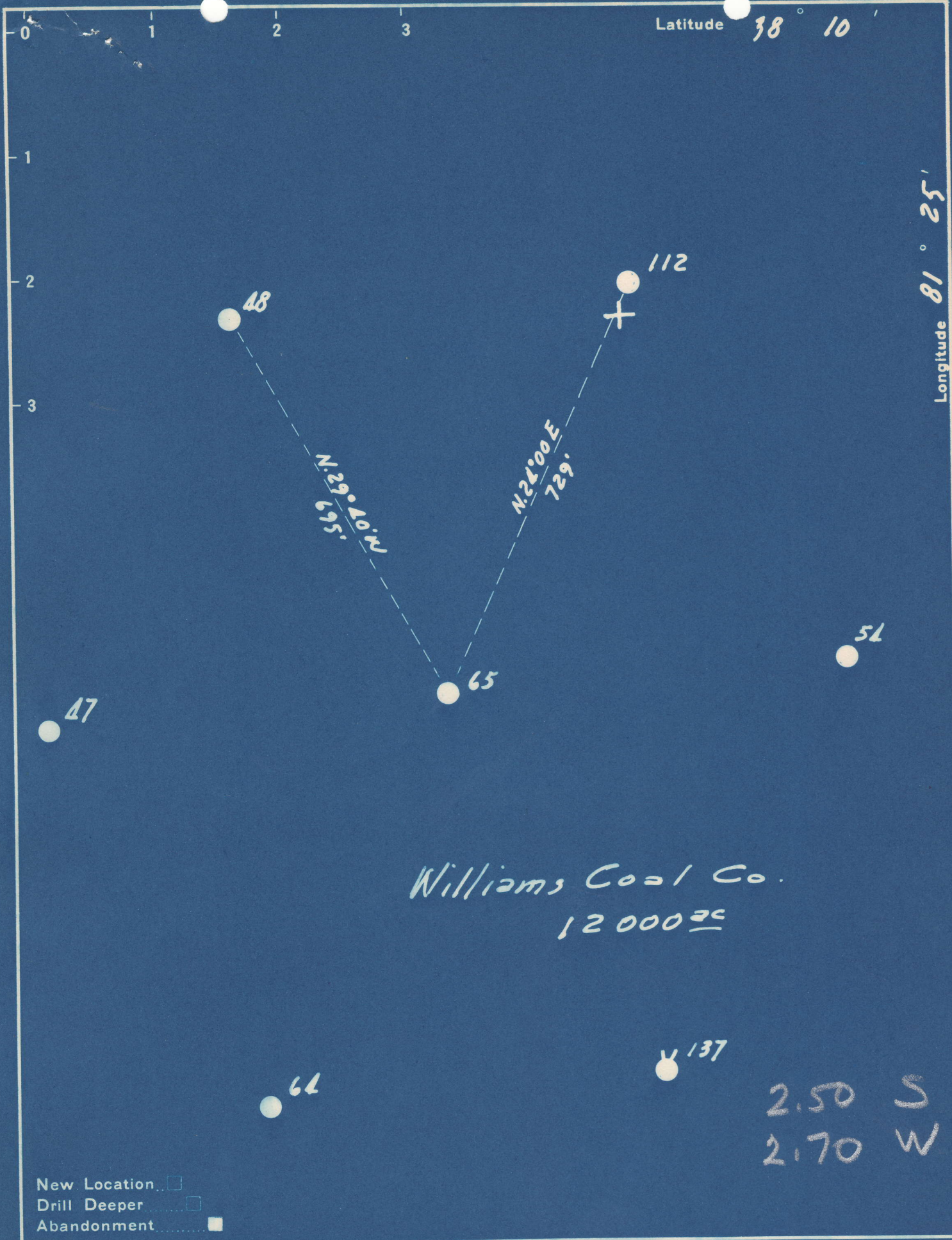

Williams Coal Co.
12000[±]

2.50 S
2.70 W

New Location
 Drill Deeper
 Abandonment

Company The Pure Oil Co.
 Address Newark, Ohio
 Farm Williams Coal Co.
 Tract _____ Acres 12000 Lease No. 5012
 Well (Farm) No. 65 Serial No. 294
 Elevation (Spirit Level) 985
 Quadrangle Montgomery
 County Kanawha District Cabin Creek
 Engineer J. B. Hunter
 Engineer's Registration No. Ohio 2912
 File No. _____ Drawing No. _____
 Date 6-8-19 Scale 1" = 200'

STATE OF WEST VIRGINIA
 DEPARTMENT OF MINES
 OIL AND GAS DIVISION
 CHARLESTON

WELL LOCATION MAP
 FILE NO. KAN-645-A

+ Denotes location of well on United States Topographic Maps, scale 1 to 62,500, latitude and longitude lines being represented by border lines as shown.
 - Denotes one inch spaces on border line of original tracing.

6-8-19

WILLIAMS COAL CO. NO. 65 WELL.

645A

Cabin Creek District, Kanawha County, W. Va.
 By The Pure Oil Col., Box 551, Newark, Ohio.
 Abandoned under permit Kan-.....-A?
 On 12,000 acres, on Cabin Creek.
 Elevation, 985' L.
 Surface and minerals owned by Shonk Land Co., 802 Kanawha Banking & Trust
 Bldg., Charleston, W. Va.
 Drilling commenced July 18, 1917; completed Sept. 18, 1917.
 Shot Oct. 1, 1917, at 2658-2671', with 50 qts. nitroglycerine.
 Salt water at 1145'.
 10 $\frac{3}{4}$ " casing, 420'; 8 $\frac{5}{8}$ ", 1365'; 7" O. D., 2000'; 5 $\frac{1}{2}$ ", 2048'; 2" tubing,
 2699'; 5 $\frac{1}{2}$ " 13# liner, 456' 10".
 Packers - 2 - 5 $\frac{1}{2}$ " x 7", packers set in Big Lime; 1 - wall and 1 anchor.
 Coal was encountered at 260-265, 300-305, and 400-405'.
 Oil well. Record to Dept. of Mines dated Sept. 28, 1949.
 Record to RCT from Mrs. Griffith Sept. 9, 1950. Old File No. 1472.

	Top.	Bottom.
Earth, Yellow	0	10
Sand, white	10	40
Slate, black	40	120
Sand, white	120	160
Slate, black	160	260
Coal, black	260	265
Lime, white	265	300
Coal, black	300	305
Sand, white	305	400
Coal, black	400	405
Lime, white	405	430
Slate, black	430	450
Sand, white	450	500
Slate, black	500	600
Lime, white	600	630
Sand, white	630	665
Slate, black	665	690
Lime, gray	690	720
Slate, black	720	730
Lime, black	730	780
Slate, black	780	785
Lime, black	785	860
Slate, black	860	870
Grampus Sand, yellow	870	1010
Slate, black	1010	1035
Salt Sand, white (hole full water, 1145')	1035	1370
Shells, white	1370	1400
Lime, black	1400	1450
Shells, white	1450	1500
Lime, black	1500	1530
Shells, white	1530	1570
Red rock	1570	1640
Slate, black	1640	1745
Pink rock	1745	1765
Slate, black	1765	1810
Red rock	1810	1830
Maxton Sand, white	1830	1840
Slate, black	1840	1900
Little Lime, black	1900	1935

(OVER)

WILLIAMS COAL CO. NO. 65 WELL (Continued).

	Top.	Bottom.
Slate, black	1935	1950
Lime, black	1950	1960
Slate, black	1960	1985
Big Lime, white	1985	2230
Big Injun Sand, red	2230	2250
Slate and shells, white	2250	2385
Lime, white	2385	2410
Slate and shells, white	2410	2575
Lime, black	2575	2615
Slate, white	2615	2630
Shale, brown	2630	2640
Berea Sand, white	2640	2672
Slate, black	2672	2673
Slate, black	2673	2674
Total depth (clean-out 8-10-37)		2674

Top.	Bottom.	
0	10	Earth, yellow
10	40	Sand, white
40	150	Slate, black
150	180	Sand, white
180	280	Slate, black
280	385	Coal, black
385	500	Lime, white
500	605	Coal, black
605	705	Sand, white
705	805	Coal, black
805	905	Lime, white
905	1000	Slate, black
1000	1100	Sand, white
1100	1200	Slate, black
1200	1300	Lime, white
1300	1400	Sand, white
1400	1500	Slate, black
1500	1600	Lime, white
1600	1700	Sand, white
1700	1800	Slate, black
1800	1900	Lime, white
1900	2000	Sand, white
2000	2100	Slate, black
2100	2200	Lime, white
2200	2300	Sand, white
2300	2400	Slate, black
2400	2500	Lime, white
2500	2600	Sand, white
2600	2700	Slate, black
2700	2800	Lime, white
2800	2900	Sand, white
2900	3000	Slate, black
3000	3100	Lime, white
3100	3200	Sand, white
3200	3300	Slate, black
3300	3400	Lime, white
3400	3500	Sand, white
3500	3600	Slate, black
3600	3700	Lime, white
3700	3800	Sand, white
3800	3900	Slate, black
3900	4000	Lime, white
4000	4100	Sand, white
4100	4200	Slate, black
4200	4300	Lime, white
4300	4400	Sand, white
4400	4500	Slate, black
4500	4600	Lime, white
4600	4700	Sand, white
4700	4800	Slate, black
4800	4900	Lime, white
4900	5000	Sand, white
5000	5100	Slate, black
5100	5200	Lime, white
5200	5300	Sand, white
5300	5400	Slate, black
5400	5500	Lime, white
5500	5600	Sand, white
5600	5700	Slate, black
5700	5800	Lime, white
5800	5900	Sand, white
5900	6000	Slate, black
6000	6100	Lime, white
6100	6200	Sand, white
6200	6300	Slate, black
6300	6400	Lime, white
6400	6500	Sand, white
6500	6600	Slate, black
6600	6700	Lime, white
6700	6800	Sand, white
6800	6900	Slate, black
6900	7000	Lime, white
7000	7100	Sand, white
7100	7200	Slate, black
7200	7300	Lime, white
7300	7400	Sand, white
7400	7500	Slate, black
7500	7600	Lime, white
7600	7700	Sand, white
7700	7800	Slate, black
7800	7900	Lime, white
7900	8000	Sand, white
8000	8100	Slate, black
8100	8200	Lime, white
8200	8300	Sand, white
8300	8400	Slate, black
8400	8500	Lime, white
8500	8600	Sand, white
8600	8700	Slate, black
8700	8800	Lime, white
8800	8900	Sand, white
8900	9000	Slate, black
9000	9100	Lime, white
9100	9200	Sand, white
9200	9300	Slate, black
9300	9400	Lime, white
9400	9500	Sand, white
9500	9600	Slate, black
9600	9700	Lime, white
9700	9800	Sand, white
9800	9900	Slate, black
9900	10000	Lime, white

Salt Sand, white (hole full water)



STATE OF WEST VIRGINIA
DEPARTMENT OF MINES
OIL AND GAS DIVISION

1472

WELL RECORD

Permit No. KAN 645-A

Oil or Gas Well OIL
(KIND)

Company The Pure Oil Co.,
Address PO Br. 551 - Newark, Ohio
Farm Williams Coal Company Acres 12,000
Location (waters) Cabin Creek
Well No. 65 Elev. 985'
District Cabin Creek County Kanawha
The surface of tract is owned in fee by Shenk Land Co.,
802 Kan. Bkng. & Tr. Co., Address Charleston, W. Va.
Mineral rights are owned by Shenk Land Co.,
802 Kan. Bkng. & Tr. Co., Address Charleston, W. Va.
Drilling commenced 7-18-17
Drilling completed 9-18-17
Date Shot 10-1-17 From 2658 To 2672
With 50 Qts. Nitro-glycerine
Open Flow /10ths Water in _____ Inch
/10ths Merc. in _____ Inch
Volume _____ Cu. Ft.
Rock Pressure _____ lbs. _____ hrs.
Oil _____ bbls., 1st 24 hrs.
Fresh water _____ feet _____ feet
Salt water 1115 feet _____ feet

Casing and Tubing	Used in Drilling	Left in Well	Packers
Size			2 - 5 1/2" x 7 1/2" packers set in Big Line
16			Kind of Packer <u>1 - Wall and 1 - Anchor.</u>
13			Size of _____
10	<u>120'</u>	<u>120'</u>	Depth set _____
8 1/4" <u>8-5/8"</u>	<u>1365'</u>	<u>filled</u>	Perf. top _____
6 5/8" <u>7" OD</u>	<u>2000'</u>	<u>2000'</u>	Perf. bottom _____
5 3/16" <u>5 1/2"</u>		<u>2018'</u>	Perf. top _____
3			Perf. bottom _____
2" <u>2" tbg.</u>		<u>2699'</u>	
Liners Used <u>13'</u>		<u>156' 10"</u>	

CASING CEMENTED _____ SIZE _____ No. Ft. _____ Date _____
COAL WAS ENCOUNTERED AT 260 FEET 60 INCHES
300 FEET 60 INCHES 100 FEET 60 INCHES
_____ FEET _____ INCHES _____ FEET _____ INCHES

Formation	Color	Hard or Soft	Top	Bottom	Oil, Gas or Water	Depth Found	Remarks
Earth	yel		0	10			
sand	white		10	10			
slate	black		10	120			
sand	white		120	160			
slate	black		160	260			
COAL	black		260	265			
lime	white		265	300			
COAL	black		300	305			
sand	white		305	400			
COAL	black		400	405			
lime	white		405	430			
slate	black		430	450			
sand	white		450	500			
slate	black		500	600			
lime white	white		600	630			
sand	white		630	665			
slate	black		665	690			
lime	grey		690	720			
slate	black		720	730			
lime	black		730	780			
slate	black		780	785			
lime	black		785	860			
slate	black		860	870			
granite	yel		870	1010			
slate	black		1010	1035			
Salt Sand	white		1035	1370	Water	1115	hole full wtr.
Shells	white		1370	1400			
lime	black		1400	1450			
Shells	white		1450	1500			
lime	black		1500	1530			
Shells	white		1530	1570			
Red Rock			1570	1610			
Slate	black		1610	1715			
Rock	pink		1715	1765			
Slate	black		1765	1810			
Red Rock			1810	1830			
Maron Sand	white		1830	1840			
Slate	black		1840	1900			
Little lime	black		1900	1935			



Formation	Color	Hard or Soft	Top	Bottom	Oil, Gas or Water	Depth Found	Remarks
Slate	black		1935	1950			
Line	black		1950	1960			
Slate	black		1960	1985			
Big Line	white		1985	2230			
Injun sand	red		2230	2250			
Slate & shells	white		2250	2385			
Line	white		2385	2410			
Slate & shells	white		2410	2575			
Line	black		2575	2615			
Slate	white		2615	2630			
Shale	brown		2630	2640			
Berea Sand	white		2640	2672			
Slate	black		2672	2673			
Slate	black		2673	2674 Total Depth, clean-out 8/10/37.			

Date September 28, 19 49

THE PURE OIL COMPANY

APPROVED P. O. Box 551, Newark, Ohio, Owner

By Ford Miller

(Title)

Senior Superintendent