

Latitude $38^{\circ} 10'$

Longitude $81^{\circ} 25'$

Williams Coal Co
12000²⁵

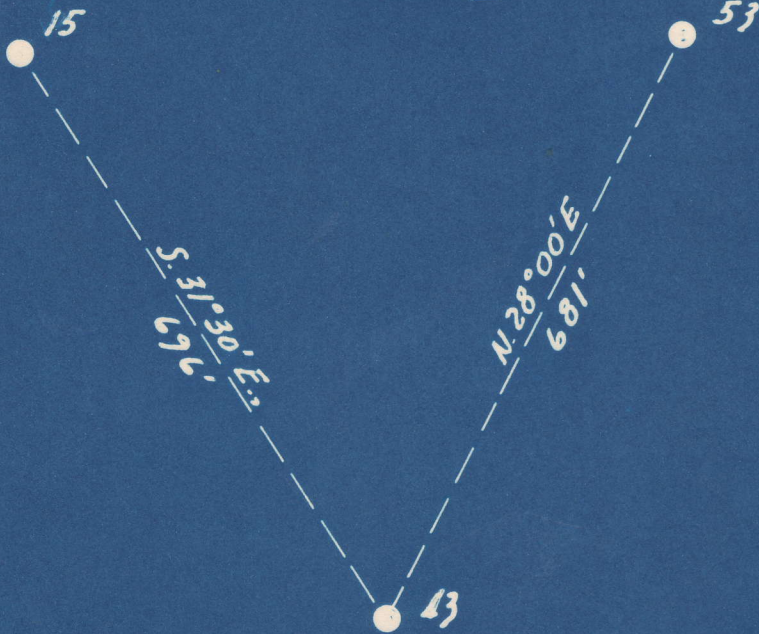

S 3.01
W 3.25

New Location
Drill Deeper
Abandonment

Company The Pure Oil Co.
 Address Newark, Ohio
 Farm Williams Coal Co.
 Tract _____ Acres 12000 Lease No. 5012
 Well (Farm) No. 43 Serial No. 311
 Elevation (Spirit Level) 1470
 Quadrangle Montgomery WC
 County Kanawha District Cabin Creek
 Engineer J. B. Hunt
 Engineer's Registration No. Ohio-2912
 File No. _____ Drawing No. _____
 Date 11-22-49 Scale 1" = 200'

STATE OF WEST VIRGINIA
DEPARTMENT OF MINES
OIL AND GAS DIVISION
CHARLESTON

WELL LOCATION MAP
FILE NO. KAN-669-A

+ Denotes location of well on United States Topographic Maps, scale 1 to 62,500, latitude and longitude lines being represented by border lines as shown.

- Denotes one inch spaces on border line of original tracing.

6-6-240

WILLIAMS COAL CO. NO. 43 WELL.

669A

Cabin Creek District, Kanawha County, W. Va.

By The Pure Oil Co., Box 551, Newark, Ohio.

Abandoned under permit Kan-.....-A?

On 12,000 acres, on Cabin Creek.

Elevation, 1470' L.

Surface and minerals owned by Shonk Lend Co., 802 Kanawha Banking & Trust Bldg., Charleston, W. Va.

Drilling commenced June 19, 1916; completed July 22, 1917.

Shot July 24, 1917, at 3155-3170', with 60 qts.

Oil, 25 bbls., 1st 24 hrs.

Fresh water, 315 and 600'.

Salt water, 1660 and 2060'.

10" casing, 960'; 8 1/4" casing, 2050' (pulled); 6 5/8" casing, 2490'; 3" tubing, 3141'.

Coal was encountered at 615-620 and 925-928'.

Oil well. Now water injection well. Record to Dept. of Mines dated Dec. 20, 1949.

Record to RCT from Mrs. Griffith Sept. 9, 1950. Old File No. 1471.

	Top.	Bottom.
Conductor	0	16
Sand, white	16	30
Slate, dark	30	300
Sand, white (water, 315', 2 bailers per hour)	300	320
Slate, black	320	520
Sand, white	520	610
Lime, dark	610	615
Coal, black	615	620
Sand, white	620	700
Lime, black	700	775
Sand, white (water, 800', 6 bailers per hour)	775	850
Slate, white	850	925
Coal, black	925	928
Lime, black	928	960
Sand, white	960	1000
Slate, black	1000	1020
Lime, black	1020	1165
Slate, black	1165	1220
Sand, white	1220	1270
Slate, black	1270	1300
Sand, white	1300	1385
Slate, black	1385	1390
Big Dunkard Sand, gray	1390	1465
Slate, black	1465	1520
Salt Sand, white (water, 1680', filled up 1000')	1520	1870
Slate, white	1870	1890
Lime, gray	1890	1910
Slate, black	1910	2010
Red rock	2010	2055
Sand, white (water, 2060', 15 BPH)	2055	2065
Slate and lime	2065	2475
Pencil Cave, black	2475	2480
Big Lime, white	2480	2710
Big Injun Sand, red	2710	2745
Slate and lime, black	2745	3130
Slate, brown	3130	3137
Berea Sand (oil and gas, 3139')	3137	3171
Total depth		3172



STATE OF WEST VIRGINIA
DEPARTMENT OF MINES
OIL AND GAS DIVISION

1471

Permit No. KAN-669-A

WELL RECORD

Oil or Gas Well Injection
(KIND)

Company The Pure Oil Company
 Address P.O. Box 951 - Newark, Ohio
 Farm Williams Coal Company Acres 12,000
 Location (waters) Cabin Creek
 Well No. 13 Elev. 1170
 District Cabin Creek County Lawrence
 The surface of tract is owned in fee by Shack Land Company
Trust Co. Inc. Address Charleston, W. Va.
 Mineral rights are owned by Shack Land Company
Trust Co. Inc. Address Charleston, W. Va.
 Drilling commenced 6/10/16
 Drilling completed 7/22/17
 Date Shot 7/22/17 From 3195 To 3170
 With 60 lbs.

Casing and Tubing	Used in Drilling	Left in Well	Packers
Size			
16			Kind of Packer
13			
10	960'	960'	Size of
8 1/4	800'	711-4'	
6 1/2	700'	600'	Depth set
5 3/16	312'	312'	
3			Perf. top
2			Perf. bottom
Liners Used			Perf. top
			Perf. bottom

Open Flow /10ths Water in Inch
 /10ths Merc. in Inch
 Volume Cu. Ft.
 Rock Pressure lbs. hrs.
 Oil bbls., 1st 24 hrs.
 Fresh water feet feet
 Salt water feet feet

CASING CEMENTED SIZE No. Ft. Date
 COAL WAS ENCOUNTERED AT FEET INCHES
 FEET INCHES FEET INCHES
 FEET INCHES FEET INCHES

Formation	Color	Hard or Soft	Top	Bottom	Oil, Gas or Water	Depth Found	Remarks
Conductor			0	16			
Sand	white		16	19			
Slate	dark		19	30			
Sand	white		30	38	water	315'	2 barrels p. 1
Slate	black		38	50			
Sand	white		50	58			
Line	dark		58	65			
Coal	black		65	68			
Sand	white		68	73			
Line	black		73	75			
Sand	white		75	85	water	800'	6 barrels p. 1
Slate	white		85	95			
Coal	black		95	98			
Line	black		98	100			
Sand	white		100	105			
Slate	black		105	110			
Line	black		110	120			
Sand	white		120	127			
Slate	black		127	130			
Sand	white		130	135			
Slate	black		135	140			
Big rounded	gray		140	145			
Slate	black		145	150			
SALT SAND	white		150	157	water	1600'	Filled up 1000'
Slate	white		157	160			
Line	gray		160	170			
Slate	black		170	201			
Red rock			201	205			
Sand	white		205	209	water	2800'	15 bbls p. 1
Slate & line			209	215			
Pencil Cove	black		215	220			
Big line	white		220	270			
Big line	red		270	275			
Slate & line	black		275	310			
Slate	brown		310	317			

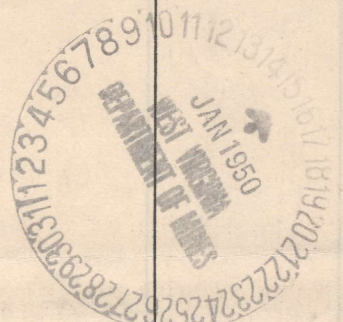

Formation	Color	Hard or Soft	Top	Bottom	Oil, Gas or Water	Depth Found	Remarks
SHALE SAND	white		3137	3171 3172	Oil & gas	3139'	
		TOTAL DEPTH					

DEPARTMENT OF MINES

December 20,

19

Date _____, 19

APPROVED _____, Owner

By _____ (Title)