

Latitude 38° 10'

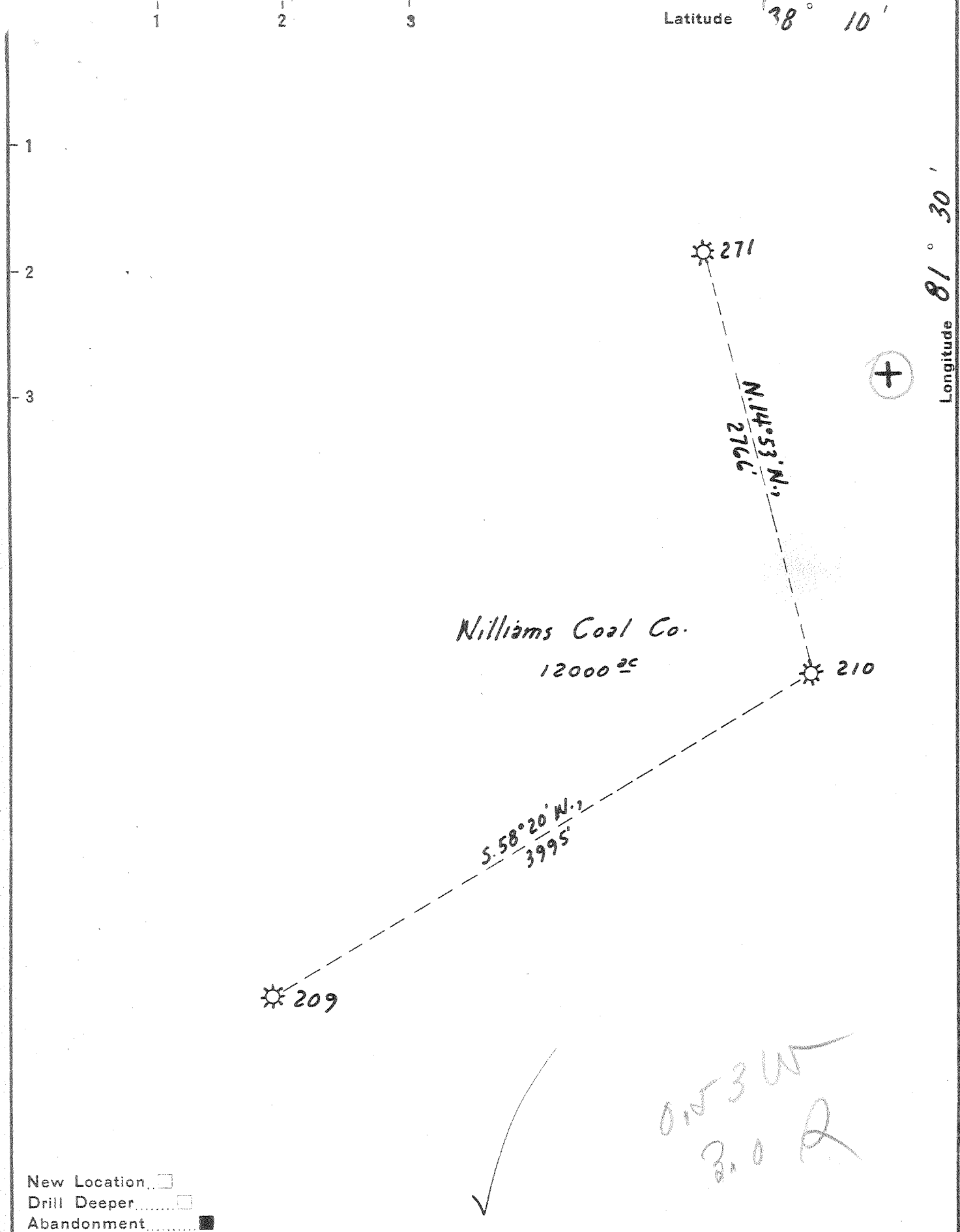

Longitude 81° 30'

New Location
 Drill Deeper
 Abandonment

Company The Pure Oil Co.
 Address Newark, Ohio Box 551
 Farm Williams Coal Co.
 Tract _____ Acres 12000 Lease No. 5012
 Well (Farm) No. 210 Serial No. 337
 Elevation (Spirit Level) 1450
 Quadrangle Peytona
 County Kanawha District Cabin Creek
 Engineer J. B. Hunter
 Engineer's Registration No. Ohio-2912
 File No. _____ Drawing No. _____
 Date 4-25-51 Scale 1" = 800'

STATE OF WEST VIRGINIA
 DEPARTMENT OF MINES
 OIL AND GAS DIVISION
 CHARLESTON

WELL LOCATION MAP
 FILE NO. KAN-833-A

+ Denotes location of well on United States Topographic Maps, scale 1 to 62,500, latitude and longitude lines being represented by border lines as shown.
 - Denotes one inch spaces on border line of original tracing.

"IMPERIAL" TRACING CLOTH
 K & E CO., N. Y.

6-6241
 KAN-833-A

WILLIAMS COAL CO. 210 - THE PURE OIL CO. -

WILLIAMS COAL CO. NO. 210 WELL.

Cabin Creek District, Kanawha County, W. Va.

By The Pure Oil Co., Box 551, Newark, Ohio.

Abandoned under permit Kan-.....-A?

On 12,000 acres, on Cabin Creek.

Elevation, 1450' L.

Surface and minerals owned by Shonk Land Co., 802 Kanawha Banking & Trust

Bldg., Charleston, W. Va.

Drilling commenced March 22, 1921; completed July 19, 1921.

Well was not shot.

Volume, 2,826,144 cu. ft.

10 $\frac{5}{8}$ " casing, 964'; 8 $\frac{5}{8}$ " , 1830' (pulled); 7" , 2499'.

Packer, 3 x 6 $\frac{5}{8}$ x 16, set at 3039'.

Coal was encountered at 200-205, 600-705, and 840-845'.

Gas well. Record to Dept. of Mines dated April 30, 1951.

Record to RCT from Mrs. Griffith Aug. 27, 1951. Old File No. 1587.

	Top.	Bottom.
Sand	0	16
Mud	16	30
Sand	30	130
Slate	130	170
Sand	170	200
Coal	200	205
Slate	205	230
Sand	230	280
Slate	280	295
Sand	295	340
Slate	340	380
Sand	380	405
Slate	405	450
Lime	450	480
Sand	480	520
Slate	520	530
Lime	530	550
Slate	550	565
Sand	565	665
Slate	665	700
Coal	700	705
Sand	705	740
Slate	740	780
Lime	780	840
Coal	840	845
Slate	845	860
Sand	860	870
Slate	870	925
Lime	925	1000
Slate	1000	1090
Sand	1090	1140
Lime	1140	1180
Slate	1180	1250
Lime	1250	1275
Sand	1275	1285
Slate	1285	1305
Sand	1305	1320
Grampus Sand	1320	1420
Slate	1420	1430

(OVER)

WILLIAMS COAL CO. NO. 210 WELL (Continued).

	Top.	Bottom.
Sand	1430	- 1440
Slate	1440	- 1480
Salt Sand	1480	- 1735
Slate	1735	- 1745
Lime	1745	- 1800
Slate	1800	- 1815
Lime	1815	- 1850
Slate and shells	1850	- 1900
Red rock	1900	- 1935
Slate and shells	1935	- 2020
Sand	2020	- 2145
Slate	2145	- 2160
Maxton Sand	2160	- 2205
Slate and shells	2205	- 2397
Little Lime	2397	- 2430
Pencil Cave	2430	- 2445
Big Lime (gas, 2530 and 2600')	2445	- 2630
Big Injun Sand	2630	- 2660
Slate and shells	2660	- 3000
Lime shells	3000	- 3015
Brown shale	3015	- 3031
Berea Grit (gas, 3049 to to 3070')	3031	- 3070
Black slate	3070	- 3071
Total depth		3071



1587

STATE OF WEST VIRGINIA
DEPARTMENT OF MINES
OIL AND GAS DIVISION

WELL RECORD

Permit No. KAN-833-A

Oil or Gas Well Gas

(KIND)

Company The Pure Oil Company
Address P.O. Box 551, Newark, Ohio
Farm Williams Coal Co. Acres 12,000
Location (waters) Cabin Creek
Well No. 210 Elev. 1450'
District Cabin Creek County Kanawha
The surface of tract is owned in fee by Shonk Land Co.
802 Kanawha Banking and Trust Co. Bldg. Address Charleston, W. Va.
Mineral rights are owned by Same as above
Address _____

Casing and Tubing	Used in Drilling	Left in Well	Packers
Size			Kind of Packer
16			
13			
10 10-3/4"	964'	964'	Size of <u>3"x6-5/8"</u>
8 8-5/8"	1830'	Pulled	<u>x 16"</u>
7 7"	2499'	2499'	Depth set <u>3039'</u>
5 3/16			
3			Perf. top
2			Perf. bottom
Liners Used			Perf. top
			Perf. bottom

Drilling commenced March 22, 1921
Drilling completed July 19, 1921
Date Shot Not shot From _____ To _____
With _____
Open Flow _____ /10ths Water in _____ Inch
_____ /10ths Merc. in _____ Inch
Volume 2,826,144 Cu. Ft.
Rock Pressure _____ lbs. _____ hrs.
Oil _____ bbls., 1st 24 hrs.
Fresh water _____ feet _____ feet
Salt water _____ feet _____ feet

CASING CEMENTED _____ SIZE _____ No. Ft. _____ Date _____
COAL WAS ENCOUNTERED AT 200' FEET 60 INCHES
700 FEET 60 INCHES 840 FEET 60 INCHES
_____ FEET _____ INCHES _____ FEET _____ INCHES

Formation	Color	Hard or Soft	Top	Bottom	Oil, Gas or Water	Depth Found	Remarks
Sand			0	16			
Mud			16	30			
Sand			30	130			
Slate			130	170			
Sand			170	200			
Coal			200	205			
Slate			205	230			
Sand			230	280			
Slate			280	295			
Sand			295	340			
Slate			340	380			
Sand			380	405			
Slate			405	450			
Lime			450	480			
Sand			480	520			
Slate			520	530			
Lime			530	550			
Slate			550	565			
Sand			565	665			
Slate			665	700			
Coal			700	705			
Sand			705	740			
Slate			740	780			
Lime			780	840			
Coal			840	845			
Slate			845	860			
Sand			860	870			
Slate			870	925			
Lime			925	1000			
Slate			1000	1090			
Sand			1090	1140			
Lime			1140	1180			
Slate			1180	1250			
Lime			1250	1275			
Sand			1275	1285			
Slate			1285	1305			
Sand			1305	1320			
Grampus			1320	1420			
Slate			1420	1430			

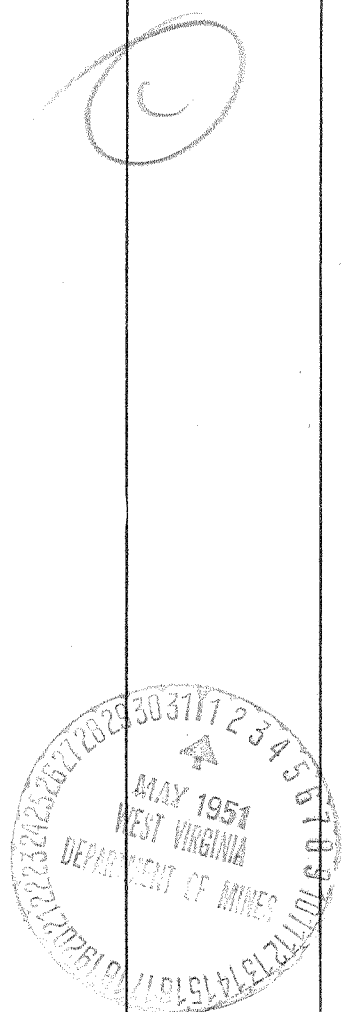

Formation	Color	Hard or Soft	Top	Bottom	Oil, Gas or Water	Depth Found	Remarks
Sand			1430	1440			
Slate			1440	1480			
SALT SAND			1480	1735			
Slate			1735	1745			
Lime			1745	1800			
Slate			1800	1815			
Lime			1815	1850			
Slate & Shells			1850	1900			
Red Rock			1900	1935			
Slate & Shells			1935	2020			
Sand			2020	2145			
Slate			2145	2160			
Maxon Sand			2160	2205			
Slate & Shells			2205	2397			
Little Lime			2397	2430			
Pencil Cave			2430	2445			
Big Lime			2445	2630	Gas	2530' & 2600'	
Big Injun			2630	2660			
Slate & Shells			2660	3000			
Lime Shells			3000	3015			
Brown Shale			3015	3031			
BURMA GRIT			3031	3070	Gas	3049' to 3070'	
Black Slate			3070	3071			
TOTAL DEPTH				3071			

Date April 30, 1957

THE PURE OIL COMPANY

APPROVED P.O. Box 521, Newark, Ohio, Owner

By Guy J. Anderson
 Division Superintendent