

Latitude 38° 10'

Longitude 81° 25'

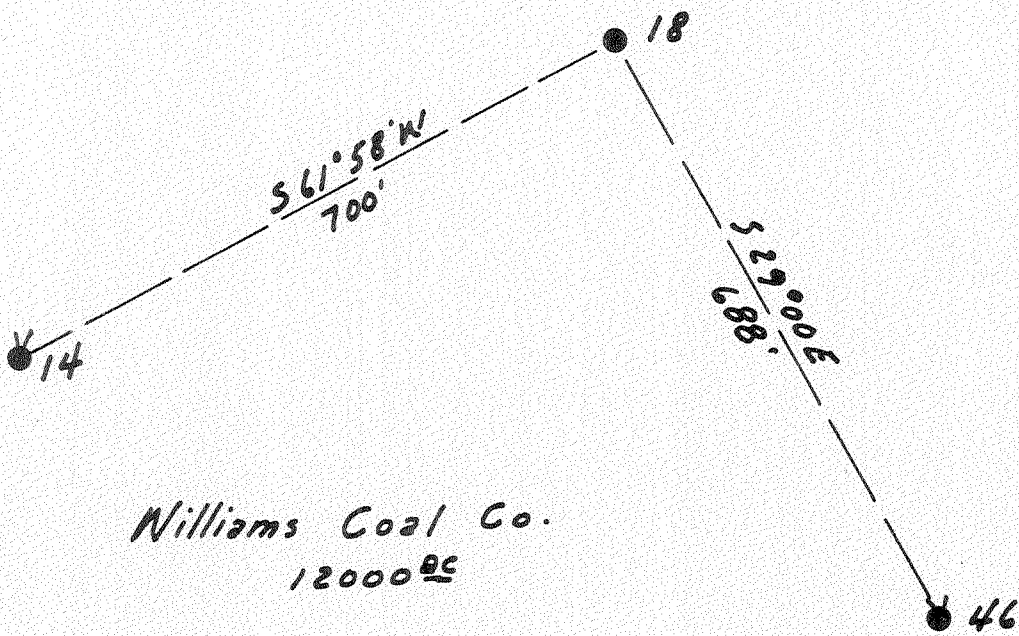

Williams Coal Co.
12000 AC

New Location
 Drill Deeper
 Abandonment

310 W
 716 ✓

Company The Pure Oil Co.
 Address Newark, Ohio Box 551
 Farm Williams Coal Co.
 Tract _____ Acres 12000 Lease No. 5012
 Well (Farm) No. 18 Serial No. 339
 Elevation (Spirit Level) 1590
 Quadrangle Montgomery
 County Kanawha District Cabin Creek
 Engineer J. B. Hunter
 Engineer's Registration No. Ohio-2912
 File No. _____ Drawing No. _____
 Date 5-1-51 Scale 1" = 200'

STATE OF WEST VIRGINIA
 DEPARTMENT OF MINES
 OIL AND GAS DIVISION
 CHARLESTON

WELL LOCATION MAP
 FILE NO. KAN-838-A

+ Denotes location of well on United States Topographic Maps, scale 1 to 62,500, latitude and longitude lines being represented by border lines as shown.
 - Denotes one inch spaces on border line of original tracing.

8-0240

"IMPERIAL" TRACING CLOTH
 K & E CO., N. Y.

WILLIAMS COAL Co., 18 - THE PURE OIL Co., - KAN-838-A

WILLIAMS COAL CO. NO. 18 WELL.

838A

Cabin Creek District, Kanawha County, W. Va.

By The Pure Oil Co., Box 551, Newark, Ohio.

Abandoned under permit Kan-.....-A7

On 12,000 acres.

Elevation, 1596' L.

Surface and minerals owned by Shook Land Co., 802 Kanawha Banking & Trust Bldg., Charleston, W. Va.

Drilling commenced Dec. 16, 1915; completed March 28, 1916.

Shot March 29, 1916, at 3248-3264', with 80 qts. glycerine.

Oil, 75 bbls., let 24 hrs.

10 3/4" casing, 1080'; 8 1/2", 2000' (pulled); 6 1/2", 2582'; 2" tubing, 3236'.

Spec. gas anchor packer, 7 x 2 x 3 x 16, set at 3240'; cemented with 35 sacks cement, then mudded with 120 sacks of clay.

Coal was encountered at 920-924 and 1038-1040'.

Water injection well. Record to Dept. of Mines dated May 15, 1951.

Record to ROT from Mrs. Griffith July 9, 1952. O. F. No. 1669.

	Top.	Bottom.
Conductor	0	9
Sand	9	100
Slate	100	140
Sand	140	160
Slate	160	260
Sand	260	300
Slate	300	330
Sand	330	375
Slate	375	410
Sand	410	490
Slate	490	510
Sand	510	520
Slate	520	550
Sand	550	575
Slate	575	585
Sand	585	600
Slate	600	620
Sand	620	650
Slate	650	680
Sand	680	730
Slate	730	740
Sand	740	780
Slate	780	800
Sand	800	810
Slate	810	815
Sand	815	840
Slate	840	850
Sand	850	875
Slate	875	920
Coal	920	924
Slate	924	930
Sand	930	960
Slate	960	970
Sand	970	1000
Slate	1000	1010
Sand	1010	1030
Slate	1030	1038
Coal	1038	1040
Sand	1040	1100

WILLIAMS COAL CO. NO. 19 WELL (Continued).

	Top.	Bottom.
Slate	1100	- 1105
Sand	1105	- 1120
Slate and shells	1120	- 1200
Sand	1200	- 1275
Slate	1275	- 1280
Sand	1280	- 1460
Slate	1460	- 1465
Crampus rock	1465	- 1555
Lime	1555	- 1575
Lime slate	1575	- 1625
Salt Sand	1625	- 1970
Slate lime	1970	- 1980
Sand	1980	- 2000
Lime shells	2000	- 2050
Slate shells	2050	- 2110
Slate	2110	- 2125
Sand	2125	- 2190
Red rock	2190	- 2250
Slate	2250	- 2315
Red rock	2315	- 2320
Slate	2320	- 2330
Red rock	2330	- 2375
Slate	2375	- 2420
Red rock	2420	- 2450
Murton Sand	2450	- 2460
Slate	2460	- 2480
Little lime	2480	- 2530
Break	2530	- 2535
Lime	2535	- 2550
Pencil	2550	- 2555
Big lime, black	2555	- 2580
Big lime, white	2580	- 2790
Keener Sand	2790	- 2810
Big Injun Sand	2810	- 2840
Slate shells	2840	- 3214
Slate, black	3214	- 3234
Berea Sand	3234	- 3264
Lime, black	3264	- 3271
Total depth		3271



STATE OF WEST VIRGINIA
DEPARTMENT OF MINES
OIL AND GAS DIVISION

1669

WELL RECORD

Permit No. KAN-838-A

Oil or Gas Well Water Inj.
(KIND)

Company The Pure Oil Company
Address P. O. Box 551, Newark, Ohio
Farm Williams Coal Company Acres 12,000
Location (waters) _____
Well No. 18 Elev. 1596'
District Cabin Creek County Kanawha

The surface of tract is owned in fee by Shonk Land Company
602 Kanawha Banking & Trust Bldg.
Address Charleston, W. Va.

Mineral rights are owned by Same as above
Address _____

Drilling commenced December 16, 1915

Drilling completed March 28, 1916

Date Shot 3/29/16 From 3248' To 3264'

With 80 Qts. Glycerine

Open Flow /10ths Water in _____ Inch
/10ths Merc. in _____ Inch

Volume _____ Cu. Ft.

Rock Pressure _____ lbs. _____ hrs.

Oil 75 bbls., 1st 24 hrs.

Fresh water _____ feet _____ feet

Salt water _____ feet _____ feet

Casing and Tubing	Used in Drilling	Left in Well	Packers
Size			
16			Kind of Packer <u>Spec.</u>
13			<u>Gas Anchor</u>
10-3/4"	<u>1080'</u>	<u>1080'</u>	Size of <u>7"x2"x3"x16"</u>
8 1/4"	<u>2000'</u>	<u>None</u>	<u>24'</u>
6 5/8"	<u>2582'</u>	<u>2582'</u>	Depth set. <u>3240'</u> *
5 3/16"			
3			Perf. top _____
2		<u>3236'</u>	Perf. bottom _____
Liners Used			Perf. top _____
			Perf. bottom _____
*Cemented with 35 sacks cement then mudded with 120 sacks of clay			
CASING CEMENTED	SIZE	No. Ft.	Date

COAL WAS ENCOUNTERED AT 920 FEET 48 INCHES
1038 FEET 24 INCHES FEET INCHES
FEET INCHES FEET INCHES

Formation	Color	Hard or Soft	Top	Bottom	Oil, Gas or Water	Depth Found	Remarks
Conductor			0	9			
Sand			9	100			
Slate			100	140			
Sand			140	160			
Slate			160	260			
Sand			260	300			
Slate			300	330			
Sand			330	375			
Slate			375	410			
Sand			410	490			
Slate			490	510			
Sand			510	520			
Slate			520	550			
Sand			550	575			
Slate			575	585			
Sand			585	600			
Slate			600	620			
Sand			620	650			
Slate			650	680			
Sand			680	730			
Slate			730	740			
Sand			740	780			
Slate			780	800			
Sand			800	810			
Slate			810	815			
Sand			815	840			
Slate			840	850			
Sand			850	875			
Slate			875	920			
Coal			920	924			
Slate			924	930			
Sand			930	960			
Slate			960	970			
Sand			970	1000			
Slate			1000	1010			
Sand			1010	1030			
Slate			1030	1038			
Coal			1038	1040			
Sand			1040	1100			

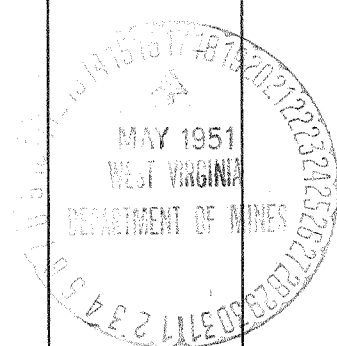

(Over)

JUL 9 1952

Formation	Color	Hard or Soft	Top	Bottom	Oil, Gas or Water	Depth Found	Remarks
Slate			1100	1105			
Sand			1105	1120			
Slate & shells			1120	1200			
Sand			1200	1275			
Slate			1275	1280			
Sand			1280	1460			
Slate			1460	1465			
Grampus Rock			1465	1555			
Line			1555	1575			
Line slate			1575	1625			
SALT SAND			1625	1970			
Slate Line			1970	1980			
Sand			1980	2000			
Line shells			2000	2050			
Slate shells			2050	2110			
Slate			2110	2125			
Sand			2125	2190			
Red Rock			2190	2250			
Slate			2250	2315			
Red Rock			2315	2320			
Slate			2320	2330			
Red Rock			2330	2375			
Slate			2375	2420			
Red Rock			2420	2450			
MAXON			2450	2460			
Slate			2460	2480			
Little Lime			2480	2530			
Break			2530	2535			
Lime			2535	2550			
Pencil			2550	2555			
BIG LIME, black			2555	2580			
BIG LIME, white			2580	2790			
Keener Sand			2790	2810			
INJUN SAND			2810	2840			
Slate shells			2840	3214			
Slate, black			3214	3234			
BEREA SAND			3234	3264			
Lime, black			3264	3271			
TOTAL DEPTH				3271			

Date May 15, 19 51

APPROVED THE PURE OIL COMPANY, Owner

By [Signature] (Title)

Division Superintendent