

Latitude 38° 10'

Longitude 81° 25'

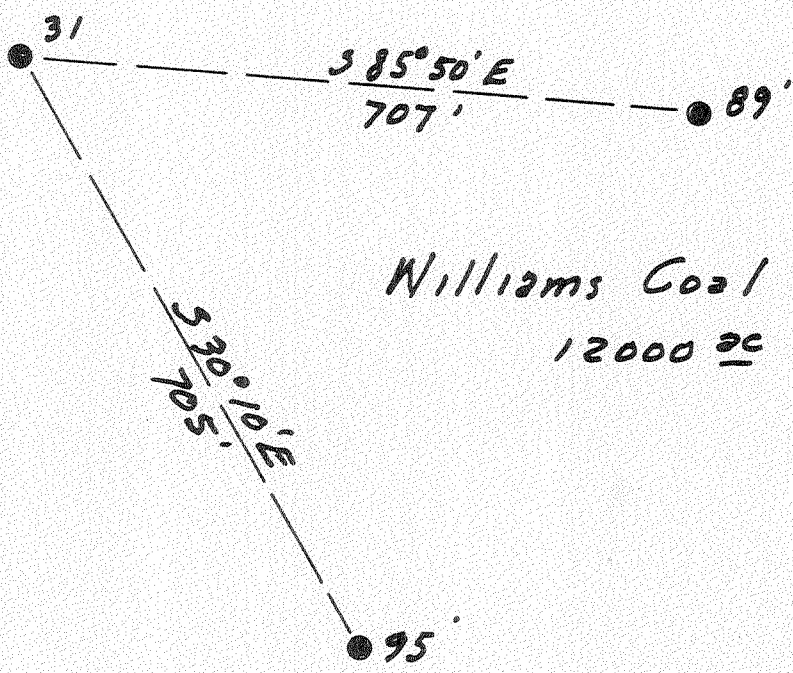

Williams Coal Co.
12000 ac

3.82 W
3.71 Q

- New Location
- Drill Deeper
- Abandonment

Company The Pure Oil Co.
 Address Newark, Ohio Box 551
 Farm Williams Coal Co.
 Tract _____ Acres 12000 Lease No. 5012
 Well (Farm) No. 31 Serial No. 347
 Elevation (Spirit Level) 1510
 Quadrangle Montgomery
 County Kenawha District Cabin Creek
 Engineer J. B. Hunter
 Engineer's Registration No. Ohio-2912
 File No. _____ Drawing No. _____
 Date 5-1-51 Scale 1" = 200'

STATE OF WEST VIRGINIA
DEPARTMENT OF MINES
OIL AND GAS DIVISION
CHARLESTON

WELL LOCATION MAP
FILE NO. KAN-846-A

+ Denotes location of well on United States Topographic Maps, scale 1 to 62,500, latitude and longitude lines being represented by border lines as shown.

- Denotes one inch spaces on border line of original tracing.

WILLIAMS COAL Co., No. 31 - THE PURE OIL Co., - KAN-846-A



STATE OF WEST VIRGINIA
DEPARTMENT OF MINES
OIL AND GAS DIVISION

1743

WELL RECORD

Permit No. KAN-846-A

Oil or Gas Well Water Injection
(KIND)

Company The Pure Oil Company
 Address P. O. Box 551, Newark, Ohio
 Farm Williams Coal Company Acres 12,000
 Location (waters) _____
 Well No. 31 Elev. 1510'
 District Cabin Creek County Kanawha
 The surface of tract is owned in fee by Shonk Land Company
802 Kanawha Banking & trust bldg.
 Address Charleston, W. Va.
 Mineral rights are owned by Same as above
 Address _____
 Drilling commenced June 3, 1916
 Drilling completed August 24, 1916
 Date Shot 8/29/16 From 3180 To 3196 1st shot
8/17/24 From 3181 To 3194 2nd shot
 With 1st shot 70 qts glycerine; 2nd shot 90 qts glycerine
 Open Flow _____ /10ths Water in _____ Inch
 _____ /10ths Merc. in _____ Inch
 Volume _____ Cu. Ft.
 Rock Pressure _____ lbs. _____ hrs.
 Oil _____ 75 bbls., 1st 24 hrs.
 Fresh water 300 840 feet _____ feet
 Salt water 1700 feet _____ feet

| Casing and Tubing | Used in Drilling | Left in Well | Packers |
|-------------------|------------------|--------------|---------------------------------------|
| Size | | | |
| 16 | | | Kind of Packer _____ |
| 13 | | | |
| 10 - 3/4" | <u>985'</u> | <u>985'</u> | Size of _____ |
| 8 1/4 | <u>1872'</u> | <u>None</u> | |
| 6 5/8 | <u>2530'</u> | <u>2530'</u> | Depth set _____ |
| 5 3/16 | | | <u>Cemented with 32 sacks cement.</u> |
| 3 | | <u>3181'</u> | Perf. top _____ |
| 2 | | | Perf. bottom _____ |
| | | | Perf. top _____ |
| | | | Perf. bottom _____ |

CASING CEMENTED _____ SIZE _____ No. Ft. _____ Date _____
 COAL WAS ENCOUNTERED AT 840 FEET 48 INCHES
950 FEET 36 INCHES FEET INCHES
 FEET INCHES FEET INCHES

| Formation | Color | Hard or Soft | Top | Bottom | Oil, Gas or Water | Depth Found | Remarks |
|---|--------|--------------|------|--------|-------------------|-------------|-----------|
| Note: Casinghead lowered 2' in 1945. All measurements should be made from a point 2' above casinghead. | | | | | | | |
| Soil | yellow | | 0 | 14 | | | |
| Sand | white | | 14 | 30 | | | |
| Slate | black | | 30 | 80 | | | |
| Sand | white | | 80 | 200 | | | |
| Slate | black | | 200 | 230 | | | |
| Sand | white | | 230 | 320 | water | 300 | 3 bailers |
| Slate | black | | 320 | 400 | | | |
| Slate & shells | black | | 400 | 560 | | | |
| Sand | white | | 560 | 670 | | | |
| Lime | black | | 670 | 800 | | | |
| Sand | white | | 800 | 840 | | | |
| Coal | black | | 840 | 844 | water | 840 | 6 bailers |
| Slate & Lime | gray | | 844 | 875 | | | |
| Sandy lime | white | | 875 | 950 | | | |
| Coal | black | | 950 | 953 | | | |
| Slate & shells | black | | 953 | 985 | | | |
| Sand | gray | | 985 | 1045 | | | |
| Slate | black | | 1045 | 1125 | | | |
| Lime & sand | white | | 1125 | 1210 | | | |
| Slate | black | | 1210 | 1270 | | | |
| Sand | gray | | 1270 | 1380 | | | |
| Broken | black | | 1380 | 1410 | | | |
| Grampus | yellow | | 1410 | 1500 | | | |
| Slate & shells | black | | 1500 | 1560 | | | |
| SALT SAND | white | | 1560 | 1870 | water | 1700 | hole full |
| Slate | black | | 1870 | 1875 | | | |
| Sandy lime | gray | | 1875 | 2000 | | | |
| Red Rock | | | 2000 | 2200 | | | |
| Shells | blue | | 2200 | 2260 | | | |
| Rock & shells | black | | 2260 | 2400 | | | |
| Slate cave | blue | | 2400 | 2420 | | | |
| Black Lime | | | 2420 | 2460 | | | |
| Slate & shells | black | | 2460 | 2490 | | | |
| Lime | gray | | 2490 | 2500 | | | |
| Pencil | black | | 2500 | 2505 | | | |
| BIG LIME | white | | 2505 | 2730 | | | |
| BIG INJUN | red | | 2730 | 2780 | | | |

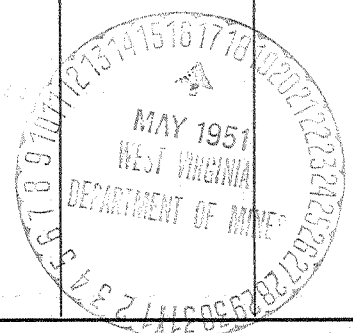

(Over) REC 2 1952

| Formation | Color | Hard or Soft | Top | Bottom | Oil, Gas or Water | Depth Found | Remarks |
|-------------|-------|--------------|------|--------|-------------------|-------------|---------|
| Shells | blue | | 2780 | 3000 | | | |
| Slate | black | | 3000 | 3095 | | | |
| Lime | gray | | 3095 | 3150 | | | |
| Shale | brown | | 3150 | 3166 | | | |
| BEREA SAND | white | | 3166 | 3196 | | | |
| Slate | black | | 3196 | 3201 | | | |
| TOTAL DEPTH | | | | 3201 | | | |

Date May 11, 19 51

APPROVED THE PURE OIL COMPANY, Owner

By [Signature]
 (Title)
 Division Superintendent