

Latitude 18 10

Longitude 81 25

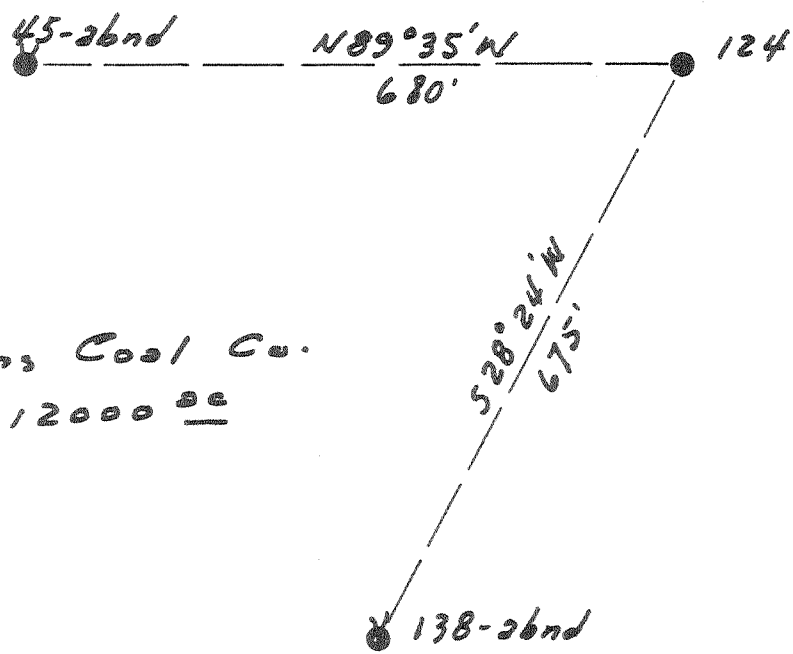

Williams Coal Co.  
12000 ac

Left Fk Longbottom Cr.

7.9365  
7.972

New Location   
 Drill Deeper   
 Abandonment

Company The Pure Oil Co.  
 Address Newark, Ohio  
 Farm Williams Coal Co.  
 Tract \_\_\_\_\_ Acres 12000 Lease No. 5012  
 Well (Farm) No. 124 Serial No. 359  
 Elevation (Spirit Level) 1185'  
 Quadrangle Montgomery  
 County Kanawha District Cabin Creek  
 Engineer J. B. Hunter  
 Engineer's Registration No. Ohio-2912  
 File No. \_\_\_\_\_ Drawing No. \_\_\_\_\_  
 Date 5-1-51 Scale 1" = 200'

STATE OF WEST VIRGINIA  
 DEPARTMENT OF MINES  
 OIL AND GAS DIVISION  
 CHARLESTON

WELL LOCATION MAP  
 FILE NO. KAN-858-A

+ Denotes location of well on United States Topographic Maps, scale 1 to 62,500, latitude and longitude lines being represented by border lines as shown.

- Denotes one inch spaces on border line of original tracing.

IMPERIAL TRACING CLOTH  
 K & F CO., N. Y.

WILLIAMS COAL CO., 124 - THE PURE OIL CO. - KAN-858-A



STATE OF WEST VIRGINIA  
DEPARTMENT OF MINES  
OIL AND GAS DIVISION

1747

WELL RECORD

Permit No. KAN-858-A

Oil or Gas Well Water Injec.  
(KIND)

Company The Pure Oil Company  
Address P. O. Box 551, Newark, Ohio  
Farm Williams Coal Company Acres 12,000  
Location (waters) \_\_\_\_\_  
Well No. 124 Elev. 1185'  
District Cabin Creek County Kanawha  
The surface of tract is owned in fee by Shonk Land Company  
802 Kanawha Banking & Trust Bldg.  
Address Charleston, W. Va.  
Mineral rights are owned by Same as above  
Address \_\_\_\_\_  
Drilling commenced August 15, 1917  
Drilling completed October 26, 1917  
Date Shot 12-10-17 From 2875 To 2886  
With 50 Qts Glycerine

Casing and Tubing	Used in Drilling	Left in Well	Packers
Size			Kind of Packer <u>ONS</u>
16			<u>spec. gas anchor.</u>
13			Size of <u>1"ODx1 1/2"x</u>
10-3/4"	<u>580'</u>	<u>580'</u>	<u>3"x16"</u>
8 1/4"	<u>1564'</u>	<u>None</u>	Depth set <u>2861 1/2'</u>
6 5/8"	<u>2214'</u>	<u>2214'</u>	<u>packer loaded with</u>
5 3/16"			<u>2 cu. ft. clay, 20</u>
3"			<u>sacks cement, then</u>
* <u>2 1/2"</u>		<u>2858'</u>	<u>Perf. top</u>
<u>Liners Used</u>			<u>105 sacks of clay.</u>
			<u>Perf. bottom</u>
			<u>Perf. top</u>
			<u>Perf. bottom</u>

Open Flow /10ths Water in \_\_\_\_\_ Inch  
/10ths Merc. in \_\_\_\_\_ Inch  
Volume \_\_\_\_\_ Cu. Ft.  
Rock Pressure \_\_\_\_\_ lbs. \_\_\_\_\_ hrs.  
Oil Pumped 4 bbls., 1st 24 hrs.  
Fresh water \_\_\_\_\_ feet \_\_\_\_\_ feet  
Salt water \_\_\_\_\_ feet \_\_\_\_\_ feet

CASING CEMENTED	SIZE	No. Ft.	Date
COAL WAS ENCOUNTERED AT <u>295</u> FEET <u>48</u> INCHES			
<u>439</u>	<u>36</u>	<u>538</u>	<u>72</u>

Formation	Color	Hard or Soft	Top	Bottom	Oil, Gas or Water	Depth Found	Remarks
Note: Casinghead lowered 2' in 1940. All measurements should be made from a point 2' above casinghead.							
Soil			0	10			
Sand			10	60			
Slate & shells			60	225			
Sand			225	275			
Slate & shells			275	295			
Coal			295	299			
Slate & shells			299	340			
Sand			340	390			
Lime			390	439			
Coal			439	442			
Lime			442	490			
Sand			490	538			
Coal			538	544			
Slate			544	574			
Sand			574	600			
Slate & shells			600	830			
Sand			830	885			
Slate & shells			885	955			
Sand			955	1070			
GRAMPUS			1070	1180			
Lime			1180	1235			
SALT SAND			1235	1540			
Slate & shells			1540	1645			
Red Rock			1645	1860			
Slate & shells			1860	1955			
Red Rock			1955	1980			
MAXON SAND			1980	1990			
Slate & shells			1990	2130			
Little Lime			2130	2160			
Slate & shells			2160	2198			
BIG LIME			2198	2425			
BIG INJUN			2425	2455			
Slate & shells			2455	2858			
BEREA SAND			2858	2886			
Lime			2886	2887			
TOTAL DEPTH				2887			

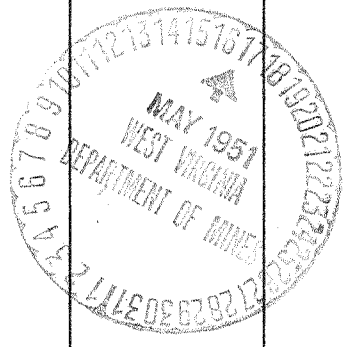

Formation	Color	Hard or Soft	Top	Bottom	Oil, Gas or Water	Depth Found	Remarks

Date May 14, 19 51

APPROVED THE PURE OIL COMPANY, Owner

By [Signature] (Title)  
Division Superintendent