

LATITUDE

LONGITUDE

7'5 OGIS topo location

7.5' loc \_\_\_\_\_ 15' loc \_\_\_\_\_  
(calc.) \_\_\_\_\_

Company OHio Fuel Oil Co.

Farm Mary Balow & Andrew  
Porter 1 (804)

Quad \_\_\_\_\_

County Kanawha

District Cabin Creek

WELL LOCATION MAP

File No. 70007

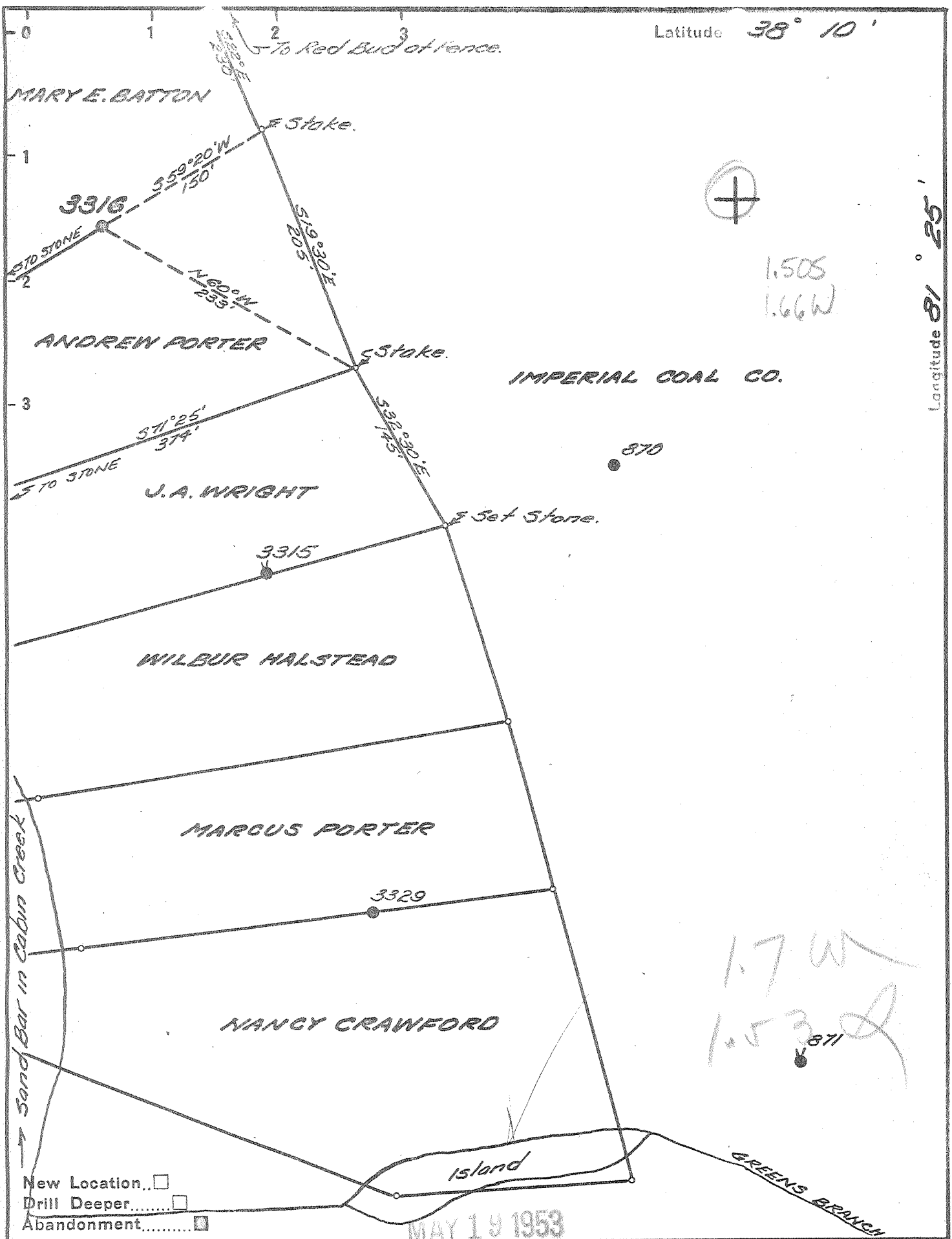

Company PRESTON OIL CO.  
 Address CHARLESTON W.VA.  
 Farm BATTON & PORTER  
 Tract \_\_\_\_\_ Acres 4 Lease No. 27186  
 Well (Farm) No. 1 Serial No. 3316  
 Elevation (Spirit Level) 704'  
 Quadrangle MONTGOMERY  
 County KANAWHA District CABIN CRK  
 Engineer Hubert S. Herrell  
 Engineer's Registration No. 2529  
 File No. 70-43 Drawing No. \_\_\_\_\_  
 Date 5-6-53 Scale 1"=100'

STATE OF WEST VIRGINIA  
 DEPARTMENT OF MINES  
 OIL AND GAS DIVISION  
 CHARLESTON

WELL LOCATION MAP  
 FILE NO. KAN-1003-A

+ Denotes location of well on United States Topographic Maps, scale 1 to 62,500, latitude and longitude lines being represented by border lines as shown.  
 - Denotes one inch spaces on border line of original tracing.

BATTON & PORTER No. 1 (3316) - PRESTON OIL CO. - KAN-1003-A

70007  
cant locate

Cabin Creek District, Kanawha County, W. Va.  
 By The Ohio Fuel Oil Co. (Virginian Gasoline & Oil Co.).  
 Map Square 70-43.  
 On Leases Nos. 1931 and 1934, of 4 acres.  
 Rig contractor, W. B. Heeter.  
 Drilling contractor, W. B. Heeter, Charleston, W. Va.  
 Commenced Nov. 21, 1916; completed March 7, 1917.  
 Drillers: John Phillips,.....Barker.  
 12 $\frac{1}{2}$ " casing, 37'; 10", 420'; 8 $\frac{1}{4}$ ", 1090' (pulled); 6 $\frac{5}{8}$ ", 1770'.  
 Shot March 10, 1917, with 90 qts.  
 Oil, flowed 15 bbls., 1st 24 hrs.

	Top.	Bottom.	Thickness.
Sand (12 $\frac{1}{2}$ " casing, 37')	37	- 50	13
Coal	50	- 55	5
Sand	55	- 90	35
Slate	90	- 125	35
Sand	125	- 145	20
Slate	145	- 175	30
Sand	175	- 195	20
Slate	195	- 210	15
Lime	210	- 220	10
Slate	220	- 230	10
Sand lime	230	- 355	125
Sand	355	- 365	10
Lime	365	- 430	65
Slate	430	- 435	5
Lime	435	- 450	15
Sandy lime	450	- 600	150
Gramphis Sand	600	- 725	125
Slate	725	- 785	60
Salt Sand	785	- 1080	295
Slate	1080	- 1090	10
Shells	1090	- 1140	50
Slate	1140	- 1160	20
Lime	1160	- 1225	65
Red rock	1225	- 1240	15
Lime	1240	- 1255	15
Red rock	1255	- 1280	25
Slate	1280	- 1310	30
Red rock	1310	- 1325	15
Shells	1325	- 1340	15
Slate	1340	- 1400	60
Shells	1400	- 1515	115
Slate	1515	- 1565	50
Maxton Sand	1565	- 1635	70
Slate	1635	- 1650	15
Lime	1650	- 1680	30
Slate	1680	- 1735	55
Big Lime	1735	- 1935	200
Big Injun Sand	1935	- 1970	35
Shells	1970	- 2050	80
Slate	2050	- 2070	20
Shells	2070	- 2100	30
Slate	2100	- 2150	50
Shells	2150	- 2200	50
Lime and shells	2200	- 2275	75
Slate	2275	- 2397	122
Berea Sand (oil, 2416 $\frac{1}{2}$ ') Total depth	2397	- 2429 $\frac{1}{2}$	32 $\frac{1}{2}$
		2432 $\frac{1}{2}$	