

Latitude 38° 15'

Longitude 81° 25'

SUNDAY CREEK CO.

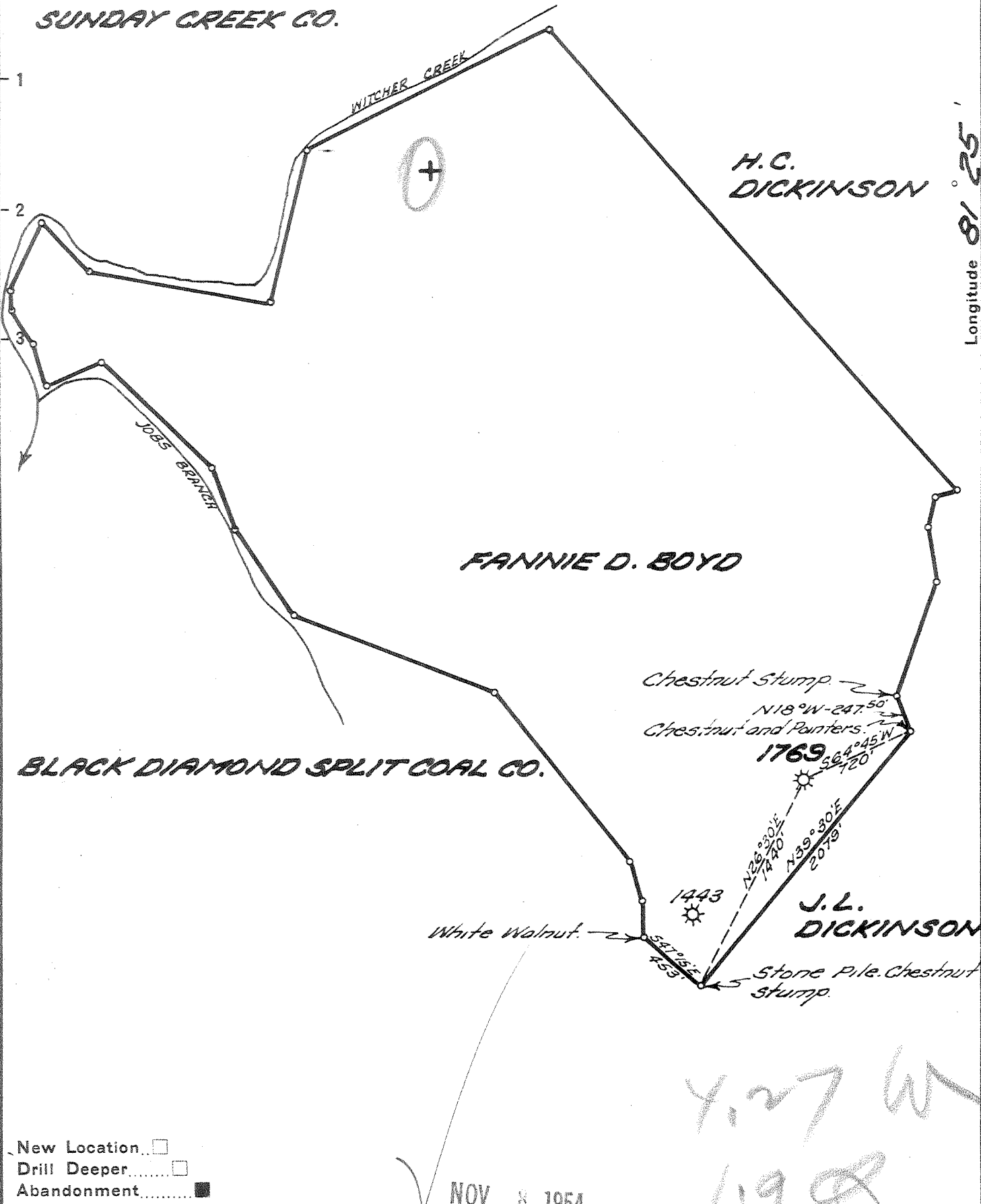

- New Location
- Drill Deeper
- Abandonment

Company UNITED FUEL GAS CO.  
 Address CHARLESTON, W. VA.  
 Farm FANNIE D. BOYD  
 Tract \_\_\_\_\_ Acres 410 Lease No. 16466  
 Well (Farm) No. 4 Serial No. 1769  
 Elevation (Spirit Level) 1300.00'  
 Quadrangle MONTGOMERY  
 County KANAWHA District CABIN CREEK  
 Engineer Paul E. Jochims  
 Engineer's Registration No. 669  
 File No. 68-49 Drawing No. \_\_\_\_\_  
 Date 8-20-54 Scale 1"=800'

STATE OF WEST VIRGINIA  
 DEPARTMENT OF MINES  
 OIL AND GAS DIVISION  
 CHARLESTON

WELL LOCATION MAP  
 FILE NO. KAN-1119-A

+ Denotes location of well on United States Topographic Maps, scale 1 to 62,500, latitude and longitude lines being represented by border lines as shown.

- Denotes one inch spaces on border line of original tracing.

6-6 241

FANNIE D. BOYD No. 4 (1769) - U.F.G. Co. - KAN-1119-A



STATE OF WEST VIRGINIA  
DEPARTMENT OF MINES  
OIL AND GAS DIVISION

1827

WELL RECORD

Oil or Gas Well Gas  
(KIND)

Quadrangle Montgomery

Permit No. 119-A

Company UNITED FUEL GAS CO.  
Address P.O. Box 1273, Charleston 25, W. Va.  
Farm Fannie D. Boyd Acres 410  
Location (waters) Dickinson Branch  
Well No. 1769 Elev. 1300'  
District Cabin Creek County Kanawha  
The surface of tract is owned in fee by \_\_\_\_\_  
Address \_\_\_\_\_  
Mineral rights are owned by Kan. Valley Bank, Trustee  
Fannie D. Boyd Estate Address Charleston, W. Va.  
Drilling commenced 2-2-28  
Drilling completed 5-11-28  
Date Shot 5-2-38 From \_\_\_\_\_ To \_\_\_\_\_  
With 30 qts.  
Open Flow 10 /10ths Water in 2 Inch  
\_\_\_\_\_ /10ths Merc. in \_\_\_\_\_ Inch  
Volume 133,000 Cu. Ft.  
Rock Pressure 244 lbs. 48 hrs.  
Oil \_\_\_\_\_ bbls., 1st 24 hrs.  
Fresh water 315' feet 373 feet  
Salt water 1390' feet \_\_\_\_\_ feet

Casing and Tubing	Used in Drilling	Left in Well	Packers
Size			Kind of Packer
16			<u>Anchor</u>
13			Size of
10			<u>3x5-3/16x16</u>
8 1/4		<u>730'</u>	Depth set
6 1/2		<u>1945'</u>	<u>2218'</u>
5 3/16			Perf. top
3		<u>2434'</u>	Perf. bottom
2			Perf. top
Liners Used			Perf. bottom

CASING CEMENTED \_\_\_\_\_ SIZE \_\_\_\_\_ No. Ft. \_\_\_\_\_ Date \_\_\_\_\_

COAL WAS ENCOUNTERED AT 315 FEET 36 INCHES  
370 FEET 36 INCHES FEET INCHES  
FEET INCHES FEET INCHES

Formation	Color	Hard or Soft	Top	Bottom	Oil, Gas or Water	Depth Found	Remarks
Soil				17			
Coal			315	318	3 b. water	315'	
Coal			370	373	8 b. water	at 373'	
Salt Sand			1250	1460	Hole full water	1390'	
Salt Sand			1580	1735	Hole reduced at	2048'	
Little Lime			1860	1900			
Pencil Cave			1920	1925	Gas	2250-2252, 2310-2312, 2355-2370	
Big Lime			1925	2110			
Keener Sand			2110	2130			
Big Engine			2130	2165			
Slate & Shells			2165	2215			
Lime			2215	2225			
Weir Sand			2225	2412			
Slate			2412	2419			
Total depth			2419'				

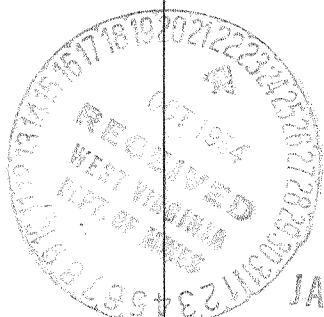

JAN 7 1955

Formation	Color	Hard or Soft	Top	Bottom	Oil, Gas or Water	Depth Found	Remarks

Date October 21, 19 54

APPROVED UNITED FUEL GAS CO., Owner

By *S. R. Furrill*  
(Title)

Mgr. Civil Engineering Dept.