

Latitude  $38^{\circ} 35'$

Longitude  $81^{\circ} 20'$

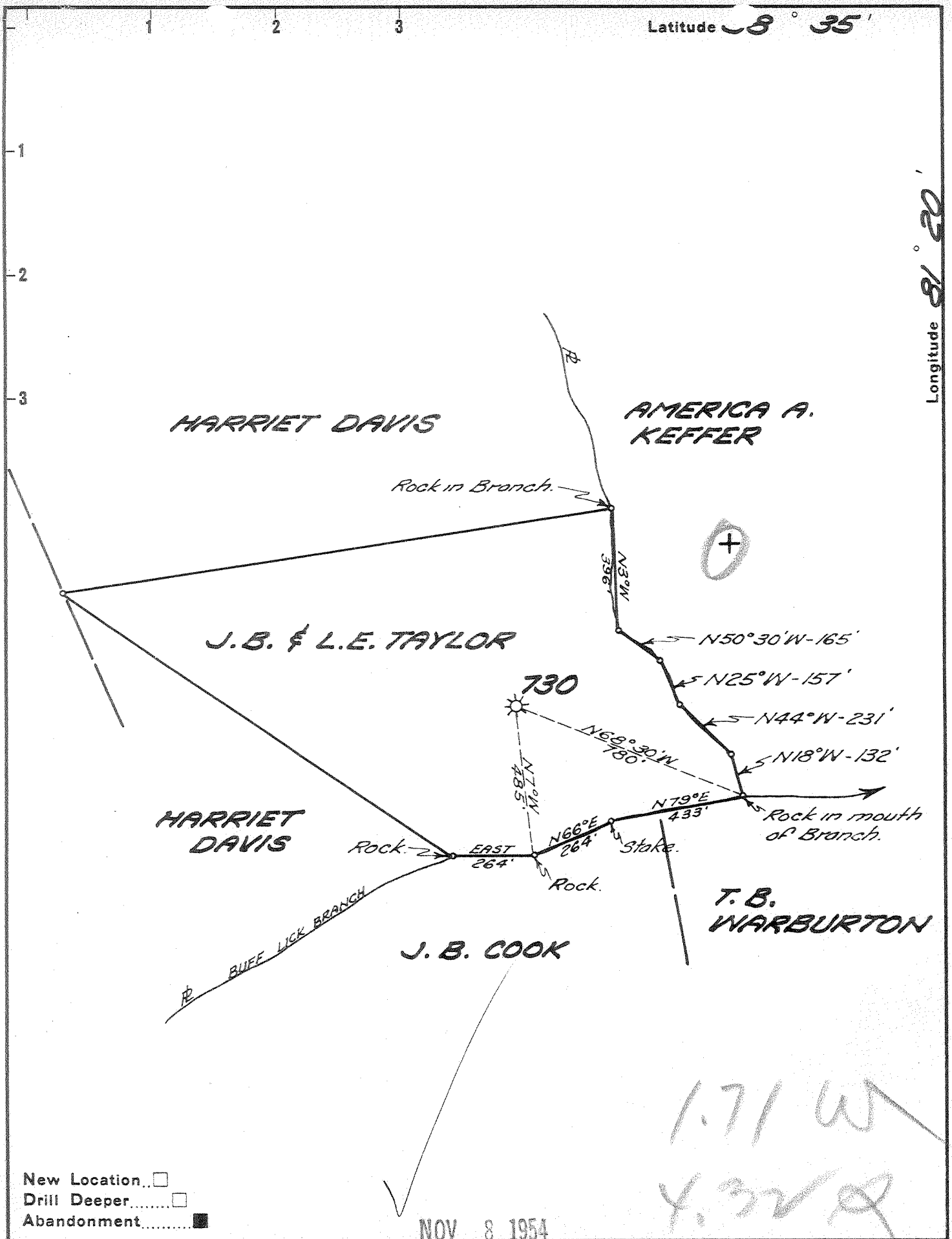

New Location   
 Drill Deeper   
 Abandonment

NOV 8 1954

1.71 W  
 4.32 W

Company UNITED FUEL GAS CO.  
 Address CHARLESTON, W. VA.  
 Farm J.B. & L.E. TAYLOR  
 Tract \_\_\_\_\_ Acres 30 Lease No. 4492  
 Well (Farm) No. \_\_\_\_\_ Serial No. 730  
 Elevation (Spirit Level) 650'  
 Quadrangle WALTON  
 County KANAWHA District BIG SANDY  
 Engineer Seibert R. Frawley  
 Engineer's Registration No. 2529  
 File No. 76-71 Drawing No. \_\_\_\_\_  
 Date 10-25-54 Scale 1" = 400'

STATE OF WEST VIRGINIA  
 DEPARTMENT OF MINES  
 OIL AND GAS DIVISION  
 CHARLESTON

WELL LOCATION MAP  
 FILE NO. KAN-1124-A

+ Denotes location of well on United States Topographic Maps, scale 1 to 62,500, latitude and longitude lines being represented by border lines as shown.  
 - Denotes one inch spaces on border line of original tracing.

6-6 220



STATE OF WEST VIRGINIA  
DEPARTMENT OF MINES  
OIL AND GAS DIVISION

1855

WELL RECORD

Quadrangle Walton

Permit No. 1127A

Oil or Gas Well Gas  
(KIND)

Company UNITED FUEL GAS CO.  
Address P.O. Box 1273, Charleston 25, W. Va.  
Farm J. B. & L. E. Taylor Acres 30  
Location (waters) Buff Lick Run  
Well No. 730 Elev. 650'  
District Big Sandy County Kanawha  
The surface of tract is owned in fee by \_\_\_\_\_

Address \_\_\_\_\_  
Mineral rights are owned by J. B. Taylor  
farmers & Citizens State Bank, Clendenin, W. Va.  
Drilling commenced 11-8-15  
Drilling completed 12-13-15  
Date Shot \_\_\_\_\_ From \_\_\_\_\_ To \_\_\_\_\_  
With \_\_\_\_\_

Open Flow \_\_\_\_\_ /10ths Water in \_\_\_\_\_ Inch  
14 /10ths Merc. in 2 Inch  
Volume 999,000 Cu. Ft.  
Rock Pressure 385 lbs. 48 hrs.  
Oil \_\_\_\_\_ bbls., 1st 24 hrs.  
Fresh water 150 feet \_\_\_\_\_ feet  
Salt water 1025 feet 1030' feet

Casing and Tubing	Used in Drilling	Left in Well	Packers
Size			
16			Kind of Packer
13			<u>Parmaco</u>
10		<u>21'</u>	Size of
8 1/4			<u>2x5-3/16x16</u>
6 5/8		<u>1515'</u>	Depth set
5 3/16			<u>1572'</u>
3			Perf. top
2		<u>1720'</u>	Perf. bottom
Liners Used			Perf. top
			Perf. bottom

CASING CEMENTED \_\_\_\_\_ SIZE \_\_\_\_\_ No. Ft. \_\_\_\_\_ Date \_\_\_\_\_

COAL WAS ENCOUNTERED AT 300 FEET 60 INCHES  
\_\_\_\_\_ FEET \_\_\_\_\_ INCHES FEET \_\_\_\_\_ INCHES  
\_\_\_\_\_ FEET \_\_\_\_\_ INCHES FEET \_\_\_\_\_ INCHES

Formation	Color	Hard or Soft	Top	Bottom	Oil, Gas or Water	Depth Found	Remarks
Red Rock			0	22			
Sand			22	125			
Slate			125	135			
Lime			135	150			
Sand			150	190			
Lime			190	225			
Little Dunkard Sand			225	290			
Slate			290	300			
Coal			300	305			Hole full water at 150' Salt water at 1025' & hole full 1030'
Big Dunkard Sand			305	390			Small show gas at 1335'
Slate			390	395			Gas show at 1520'
Sand			395	415			Hole reduced to 5-3/16" at 1530'
Slate & Lime Shells			415	500			Gas in Injun at 1615' to 1625'
Sand			500	625			Gas in Injun at 1635' to 1640'
Slate			625	695			
Sand			695	725			
Slate			725	765			
Lime			765	790			
Sand			790	825			
Slate			825	915			
Sand			915	955			
Lime			955	970			
1st Salt Sand			970	1120			
Slate & Lime Shells			1120	1190			
2nd Salt Sand			1190	1390			
Maxon Sand			1390	1435			
Little Lime			1435	1465			
Big Lime			1465	1610			
Big Injun			1610	1650			
Slate & Shells			1650	1700 1/2			
Total depth			1700 1/2'				

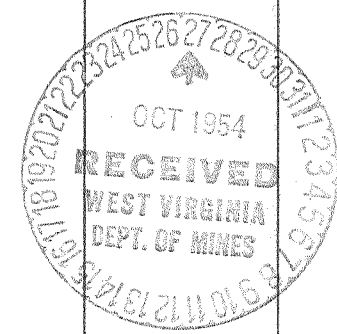

APR 22 1955

Formation	Color	Hard or Soft	Top	Bottom	Oil, Gas or Water	Depth Found	Remarks

Date October 26, 19 54

APPROVED UNITED FUEL GAS CO., Owner

By S. A. Ferrell  
(Title)

Mgr. Civil Engineering Dept.

MATHEWS PRINTING AND LITHOGRAPHING CO.  
CHARLESTON, W. VA.