

Latitude 38° 15'

Longitude 81° 20'

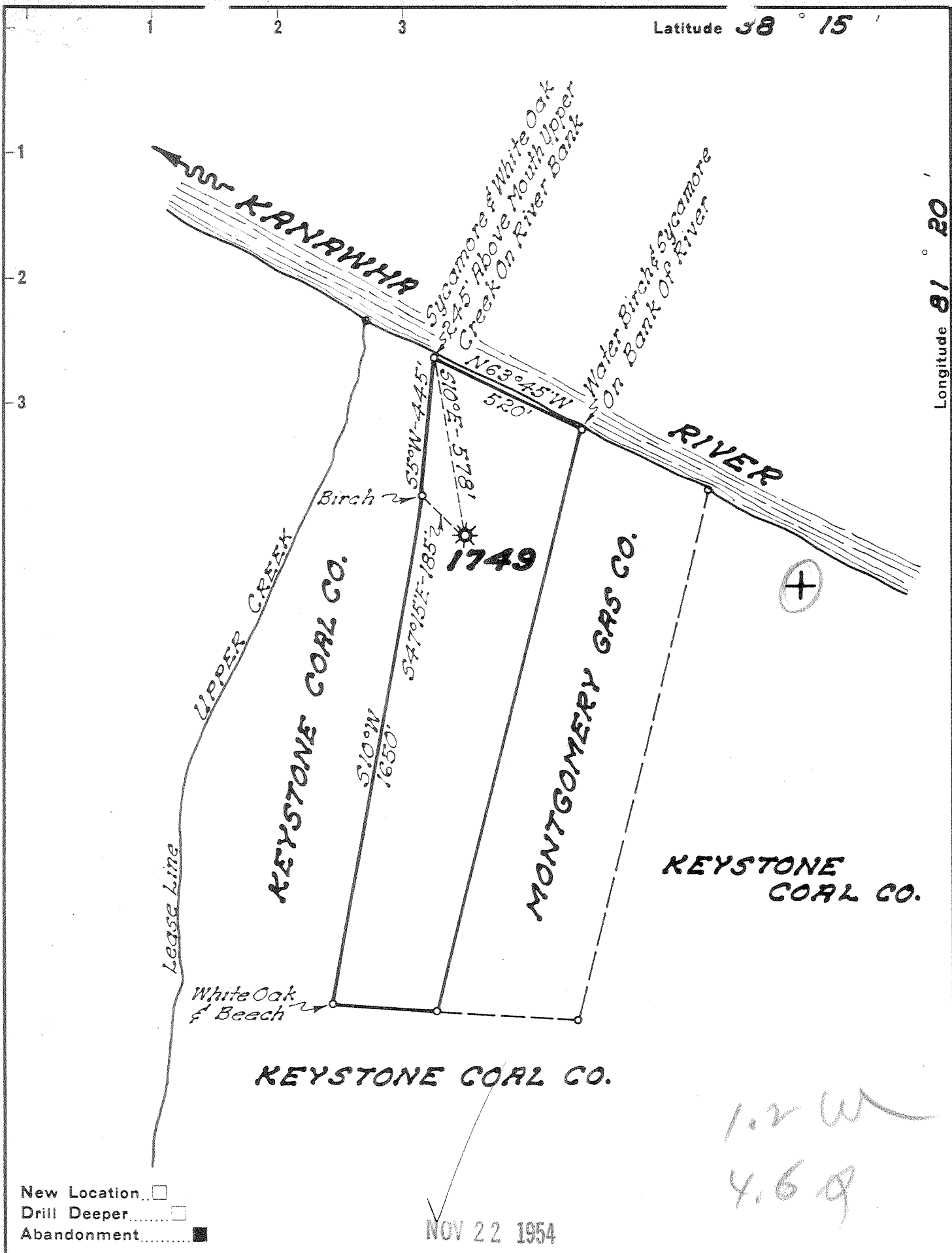

Company UNITED FUEL GAS CO.
 Address CHARLESTON, W. VA.
 Farm KEYSTONE COAL CO.
 Tract _____ Acres 17 3/4 Pt. 13679 Lease No. _____
 Well (Farm) No. _____ Serial No. 1749
 Elevation (Spirit Level) 756.0
 Quadrangle MONTGOMERY
 County KANAWHA District CABIN CR.
 Engineer _____
 Engineer's Registration No. 669
 File No. 76-47 Drawing No. _____
 Date 11-8-54 Scale 1"=400'

STATE OF WEST VIRGINIA
 DEPARTMENT OF MINES
 OIL AND GAS DIVISION
 CHARLESTON

WELL LOCATION MAP
 FILE NO. KAN-1145-A

+ Denotes location of well on United States Topographic Maps, scale 1 to 62,500, latitude and longitude lines being represented by border lines as shown.

- Denotes one inch spaces on border line of original tracing.

6-6242



STATE OF WEST VIRGINIA
DEPARTMENT OF MINES
OIL AND GAS DIVISION

1909

Quadrangle Montgomery

WELL RECORD

Permit No. 1145 A Oil or Gas Well Gas (KIND)

Company UNITED FUEL GAS COMPANY
Address P.O. Box 1273, Charleston 25, W. Va.
Farm Keystone Coal Co. Acres 1856
Location (waters) Kanawha River
Well No. 1749 Elev. 756'
District Cabin Creek County Kanawha
The surface of tract is owned in fee by _____
Address _____
Mineral rights are owned by Eastern Gas & Fuel Assoc.
Coal Division - Koppers Bldg. Pittsburgh 19, Pa.
Drilling commenced 10-18-27
Drilling completed 5-20-28
Date Shot 5-21-28 From 2034 To 2046
With 40 qts.
Open Flow 22 /10ths Water in _____ 2 Inch
_____ /10ths Merc. in _____ Inch
Volume 223,000 Cu. Ft.
Rock Pressure 343# lbs. _____ hrs.
Oil _____ bbls., 1st 24 hrs.
Fresh water _____ feet _____ feet
Salt water _____ feet _____ feet

Casing and Tubing	Used in Drilling	Left in Well	Packers
Size			Kind of Packer
16			<u>Anchor</u>
13			Size of
10		<u>390'</u>	<u>3x5-3/16x16</u>
8 1/4	<u>1080'</u>		Depth set
6 5/8		<u>1772'</u>	<u>2239'</u>
5 3/16			Perf. top
3		<u>2114'</u>	Perf. bottom
2			Perf. top
Liners Used			Perf. bottom

CASING CEMENTED _____ SIZE _____ No. Ft. _____ Date _____

COAL WAS ENCOUNTERED AT 62 FEET 36 INCHES
346 FEET 36 INCHES 580 FEET 48 INCHES
_____ FEET _____ INCHES _____ FEET _____ INCHES
_____ FEET _____ INCHES _____ FEET _____ INCHES

Formation	Color	Hard or Soft	Top	Bottom	Oil, Gas or Water	Depth Found	Remarks
Soil			0	14			
Grey Mud			14	30			
Gritty Lime			30	62			
Coal			62	65			
Slate			65	80			
Sand			80	170			
Slate & Shells			170	250			
Lime			250	275			
Slate			275	285			
Sand			285	346			
Coal			346	349			
Slate			349	450			
Lime			450	501			
Sand			501	580			
Coal			580	584			
Slate			584	590			
Sand			590	800			
Slate			800	804			
Salt Sand			804	1011			
Slate			1011	1014			
Sand			1014	1188			
Slate			1188	1198			
Sand			1198	1257			
Red Rock			1257	1378			
Sand & Shells			1378	1400			
Maxon Sand			1400	1435			
Slate			1435	1445			
Red Rock			1445	1460			
Slate & Lime			1460	1655			
Pencil Cave			1655	1660			
Lime			1660	1685			
Slate			1685	1700			
Black Lime			1700	1747			
Big Lime			1747	1920			
Big Injun			1920	1966			
Black Lime			1966	1970			
Sandy Lime			1970	1988			
Shells			1988	2011			
Weir Sand			2011	2052			

Hole was filled back to 2099' which is now the Total depth

First hole drilled 1080' and abandoned 434'-4" of 10" casing left in cemented

Hole reduced at 1852'

Gas show no test 1860'
Gas show no test 1958'

Gas 2030-2045

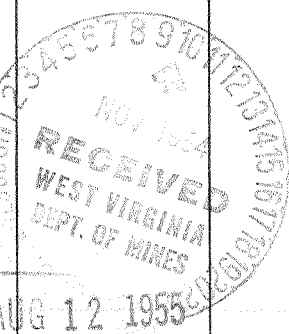

Formation	Color	Hard or Soft	Top	Bottom	Oil, Gas or Water	Depth Found	Remarks
Slate			2052	2134			
Lime Shells			2134	2372			
Brown Shale			2372	2384			
Berea Grit			2384	2390			
Lime			2390	2444			
Total depth			2444'				

Date November 8, 1954

APPROVED UNITED FUEL GAS CO., Owner

By *S. R. Ferrell*
 (Title)
 Mgr. Civil Engineering Dept.