

Latitude 78° 35'

Longitude 81° 15'

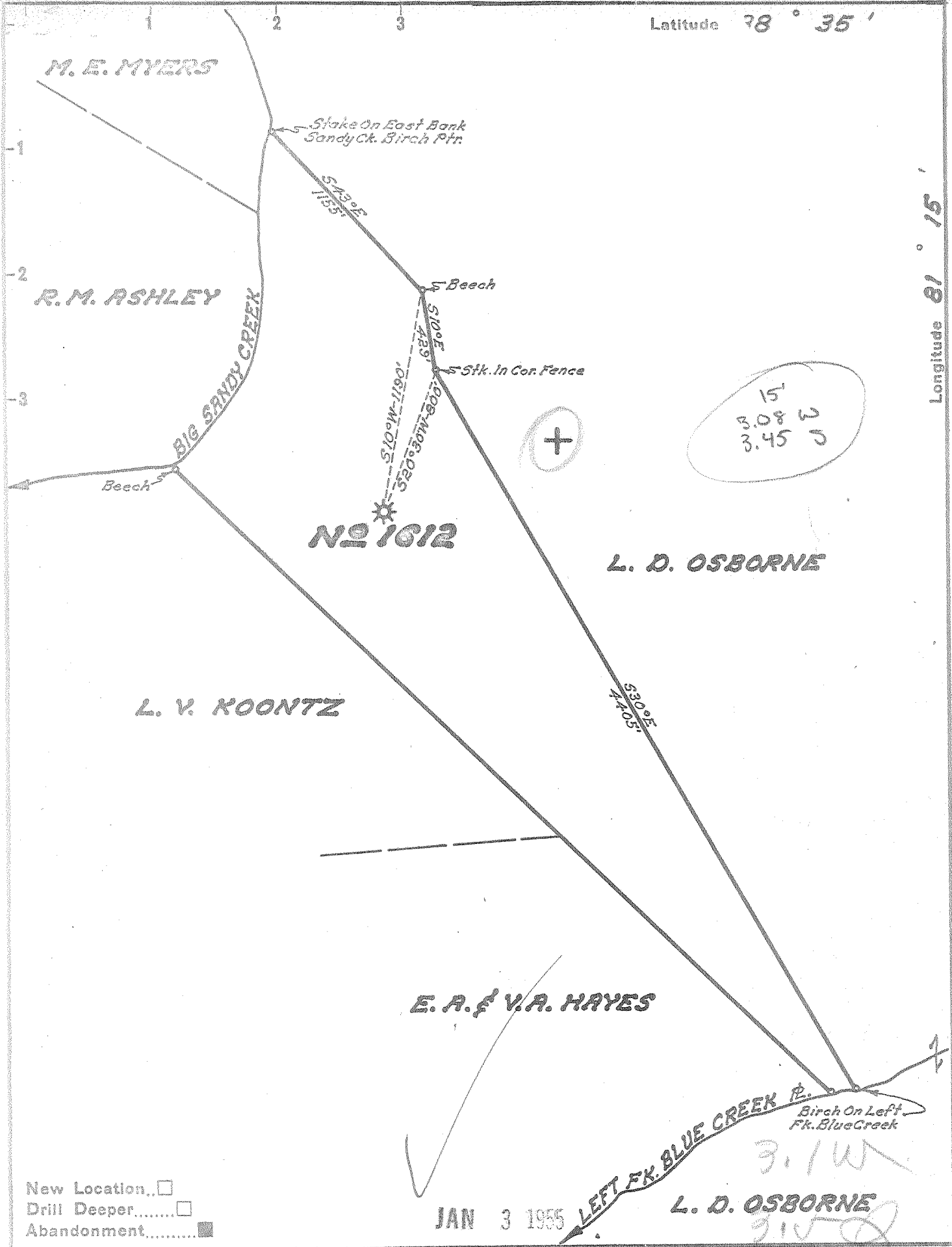

New Location
 Drill Deeper
 Abandonment

JAN 3 1955

Company UNITED FUEL GAS CO.
 Address CHARLESTON, W.VA.
 Farm C.H. OSBORNE
 Tract _____ Acres 108 Lease No. 17558
 Well (Farm) No. _____ Serial No. 1612
 Elevation (Spirit Level) 747.0
 Quadrangle WALTON
 County KANAWHA District BIG SANDY
 Engineer Seibert A. Howell
 Engineer's Registration No. 2529
 File No. 78-71 Drawing No. _____
 Date 12-14-54 Scale 1"=660'

STATE OF WEST VIRGINIA
 DEPARTMENT OF MINES
 OIL AND GAS DIVISION
 CHARLESTON

WELL LOCATION MAP
 FILE NO. KAN-1157-A

+ Denotes location of well on United States Topographic Maps, scale 1 to 62,500, latitude and longitude lines being represented by border lines as shown.

- Denotes one inch spaces on border line of original tracing.



STATE OF WEST VIRGINIA
DEPARTMENT OF MINES
OIL AND GAS DIVISION

1875

Quadrangle Walton
Permit No. 1157-A

WELL RECORD

Oil or Gas Well Gas
(KIND)

Company UNITED FUEL GAS CO.
Address P.O. Box 1273, Charleston 25, W. Va.
Farm C. H. Osborne Acres 108
Location (waters) Big Sandy Creek
Well No. 1612 Elev. 747'
District Big Sandy County Kanawha
The surface of tract is owned in fee by _____
Address _____
Mineral rights are owned by Hoyt G. Osborne, et al
Rt. 3 Address Clendenin, W.Va.
Drilling commenced 6-14-26
Drilling completed 7-31-26
Date Shot _____ From _____ To _____
With _____
Open Flow 8 /10ths Water in 2 Inch
_____ /10ths Merc. in _____ Inch
Volume 134,400 Cu. Ft.
Rock Pressure 150 B.L. 196 In. lbs. _____ hrs.
Oil _____ bbls., 1st 24 hrs.
Fresh water 532 feet _____ feet
Salt water _____ feet _____ feet

Casing and Tubing	Used in Drilling	Left in Well	Packers
Size			
16			Kind of Packer Anchor
13			
10			Size of 3x5-3/16x16
8 3/4	441'		Depth set 1566'
6 5/8		1502'6"	
5 3/16			
3		1690'11"	Perf. top
2			Perf. bottom
Liners Used			Perf. top
			Perf. bottom

CASING CEMENTED _____ SIZE _____ No. Ft. _____ Date _____
COAL WAS ENCOUNTERED AT 200 FEET 36 INCHES
492 FEET 48 INCHES FEET INCHES
FEET INCHES FEET INCHES

Formation	Color	Hard or Soft	Top	Bottom	Oil, Gas or Water	Depth Found	Remarks
Red Rock			0	30	Hole full water 532'		
Slate			30	55	Hole reduced 1529'		
Sand			55	145	Lime gas 1550-1553'		
Slate			145	200			
Coal			200	203	Injun Gas 1618-1628'		
Slate			203	220			
Sand			220	435			
Slate			435	492			
Coal			492	496			
Slate			496	532			
Sand			532	570			
Slate			570	665			
Sand			665	746			
Slate			746	785			
Sand			785	810			
Slate			810	865			
Salt Sand			865	1135			
Slate & Lime			1135	1150			
Sand			1150	1347			
Slate & Shells			1347	1377			
Red Rock			1377	1380			
Slate & Shells			1380	1400			
Maxon Sand			1400	1430			
Little Lime			1430	1463			
Cave			1463	1473			
Big Lime			1473	1611			
Big Injun			1611	1629			
Slate			1629	1659			
Red Rock			1659	1679			
Total depth			1679'				

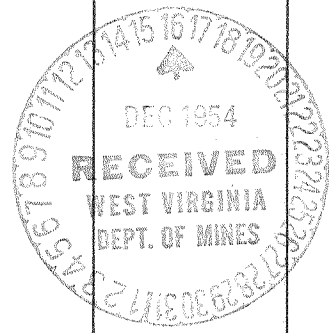

APR 22 1955

(Over)

