

Latitude 8° 35'

Longitude 81° 25'

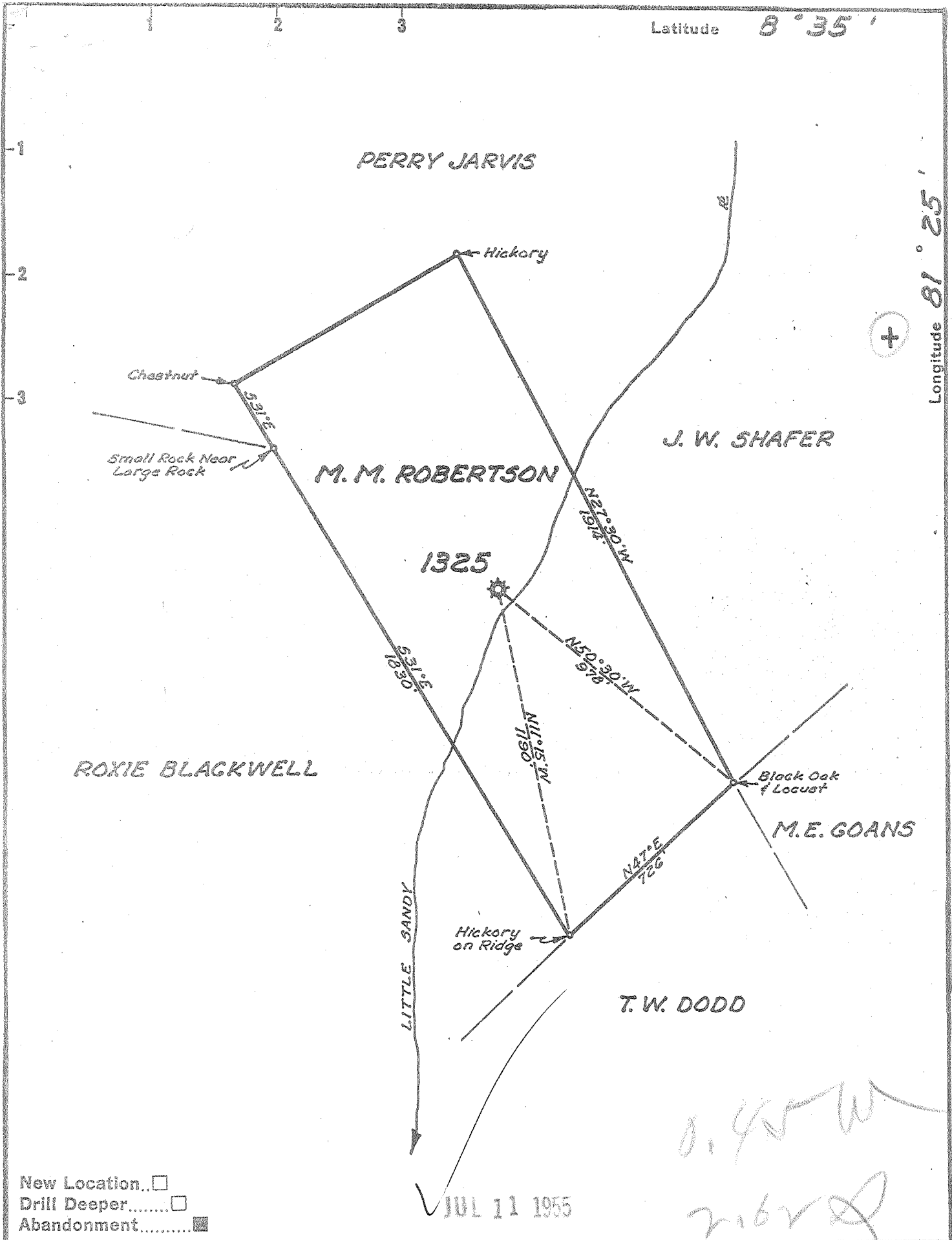

New Location
 Drill Deeper
 Abandonment

JUL 11 1955

0.45 W
2162

Company UNITED FUEL GAS CO.
 Address CHARLESTON, W. VA.
 Farm M. M. ROBERTSON
 Tract _____ Acres 41 Lease No. 11986
 Well (Farm) No. _____ Serial No. 1325
 Elevation (Spirit Level) 735.0'
 Quadrangle WALTON
 County KANAWHA District BIG SANDY
 Engineer Lybert R. Howell
 Engineer's Registration No. 2529
 File No. 72-71 Drawing No. _____
 Date 6-24-55 Scale 1"=400'

STATE OF WEST VIRGINIA
 DEPARTMENT OF MINES
 OIL AND GAS DIVISION
 CHARLESTON

WELL LOCATION MAP
 FILE NO. KAN-1184-A

+ Denotes location of well on United States Topographic Maps, scale 1 to 62,500, latitude and longitude lines being represented by border lines as shown.
 - Denotes one inch spaces on border line of original tracing.

M. M. ROBERTSON No. 1325 — U. F. G. Co. — 6-6-198 KAN-1184-A



STATE OF WEST VIRGINIA
DEPARTMENT OF MINES
OIL AND GAS DIVISION

1957

WELL RECORD

Oil or Gas Well Gas
(KIND)

Quadrangle Walton
Permit No. 1184-A

Company UNITED FUEL GAS COMPANY
Address P.O. Box 1273, Charleston 25, W. Va.
Farm M. M. Robertson, et al Acres 41
Location (waters) Little Sandy
Well No. 1325 Elev. 735'
District Big Sandy County Kanawha
The surface of tract is owned in fee by _____
Address _____
Mineral rights are owned by D. W. Taylor, et al
405 Beech Ave. Address Charleston, W. Va.
Drilling commenced 11-26-23
Drilling completed 1-19-24
Date Shot _____ From _____ To _____
With _____

Casing and Tubing	Used in Drilling	Left in Well	Packers
Size			
16			Kind of Packer <u>Anchor</u>
13			
10		<u>29</u>	Size of <u>3x5-3/16</u>
8 1/4	<u>450'</u>		Depth set <u>1612</u>
6 5/8		<u>1562'</u>	
5 3/16			Perf. top _____ Perf. bottom _____
3		<u>1723' 8"</u>	
2			
Liners Used			Perf. top _____ Perf. bottom _____

Open Flow 8 /10ths Water in _____ Inch
/10ths Merc. in 3 _____ Inch
Volume 1,118,000 Cu. Ft.
Rock Pressure 187 lbs. _____ hrs.
Oil _____ bbls., 1st 24 hrs.
Fresh water _____ feet _____ feet
Salt water _____ feet _____ feet

CASING CEMENTED _____ SIZE _____ No. Ft. _____ Date _____
COAL WAS ENCOUNTERED AT _____ FEET _____ INCHES
_____ FEET _____ INCHES FEET _____ INCHES
_____ FEET _____ INCHES FEET _____ INCHES

Formation	Color	Hard or Soft	Top	Bottom	Oil, Gas or Water	Depth Found	Remarks
Gravel			15	29	Hole reduced 1597' Gas 1659-1675		
Slate & Red Rock			29	270			
Dunkard Sand			270	410			
Slate			410	500			
Sand			500	585			
Slate & Shells			585	735			
Sand			735	800			
Slate & Shells			800	1045			
Salt Sand			1045	1492			
Little Lime			1492	1517			
Big Lime			1517	1647			
Injun			1647	1687			
Slate			1687	1708			
Total depth			1708'				

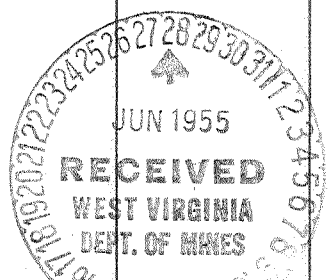

JAN. 23 1955

