

Latitud 38° 10'

Longitude 81° 30'

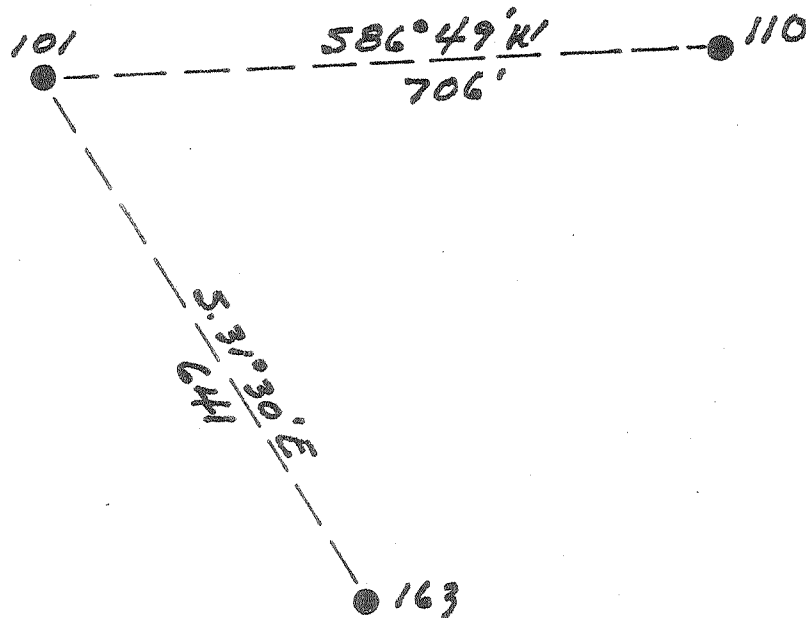

Williams Coal Co.

12000 ac

New Location...   
 Drill Deeper.....   
 Abandonment.....

✓ SEP 27 1955

12  
 J.H.W.  
 3.78  
 7.8

Company Pure Oil Co.  
 Address Newark, Ohio  
 Farm Williams Coal Co.  
 Tract \_\_\_\_\_ Acres 12000 Lease No. 5012  
 Well (Farm) No. 101 Serial No. 429  
 Elevation (Spirit Level) 1260  
 Quadrangle Peytona  
 County Kenawha District Cabin Creek  
 Engineer J.H. Hunter  
 Engineer's Registration No. Ohio-2912  
 File No. \_\_\_\_\_ Drawing No. \_\_\_\_\_  
 Date 10-22-53 Scale 1"=200'

STATE OF WEST VIRGINIA  
 DEPARTMENT OF MINES  
 OIL AND GAS DIVISION  
 CHARLESTON

WELL LOCATION MAP  
 FILE NO. KAN-1195-A

+ Denotes location of well on United States Topographic Maps, scale 1 to 62,500, latitude and longitude lines being represented by border lines as shown.

- Denotes one inch spaces on border line of original tracing.

X-0 (240)

WILLIAMS COAL CO. (No. 10) - PURE OIL CO. - KAN-1195-A



STATE OF WEST VIRGINIA DEPARTMENT OF MINES OIL AND GAS DIVISION

1966

WELL RECORD

WATER INJECTION

Permit No. 1195-A Oil or Gas Well (KIND)

Company The Pure Oil Company
Address Box 351 - Newark, Ohio
Farm Williams Coal Company Acres 12,000
Location (waters) Cabin Creek
Well No. 102 Elev. 1260
District Cabin Creek County Kanawha
The surface of tract is owned in fee by Frank Land Company
302 Kan. Smkg & Trust Co. Address Charleston, W. Va.
Mineral rights are owned by Ditto
Address
Drilling commenced July 19, 1917
Drilling completed October 15, 1917
Date Shot 12/6/17 From 2922 To 2935
With 60 lbs. Glycerine

Table with columns: Casing and Tubing, Used in Drilling, Left in Well, Packers. Rows include sizes 16, 13, 10, 8 1/4, 6 5/8, 5 3/16, 3, 2 and packer details like Kind of Packer, Size of, Depth set, Perf. top/bottom.

Open Flow /10ths Water in Inch /10ths Merc. in Inch
Volume Cu. Ft.
Rock Pressure lbs. hrs.
Oil 71 bbls., 1st 24 hrs.
Fresh water 140 feet feet
Salt water 1375 feet 1910 feet 1950 feet

CASING CEMENTED SIZE No. Ft. Date
COAL WAS ENCOUNTERED AT 100 FEET 24 INCHES
690 FEET 36 INCHES 715 FEET 36 INCHES
FEET INCHES FEET INCHES

Main well log table with columns: Formation, Color, Hard or Soft, Top, Bottom, Oil, Gas or Water, Depth Found, Remarks. Includes entries for sand, slate, coal, and limestone with depths from 0 to 2220 feet.

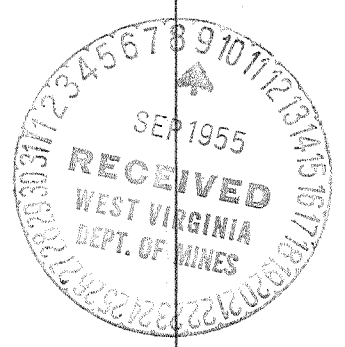

JUNE 21 1956

Formation	Color	Hard or Soft	Top	Bottom	Oil, Gas or Water	Depth Found	Remarks
IG LIME	white		2220	2465			
IG LIMON	red		2465	2490			
late & shells	black		2490	2710			
IR SAND	white		2710	2745			
late & shells	black		2745	2890	Gas	2710'	Show of gas
hale	brown		2890	2905			
IR SAND	white		2905	2935	Gas	2922'	
				2939		Oil 2922'-2935'	
				2939 TOTAL DEPTH			
				2942 T.D. AFTER C.O.			

Note: Casing head lowered 4' in 1949. All measurements should be made from a point 4' above casing.

Date October 21, 1951

APPROVED THE PURE OIL COMPANY, Owner

By Guy J. Anderson  
Division Superintendent (Title)