

Latitude 38° 30'

Longitude 81° 25'

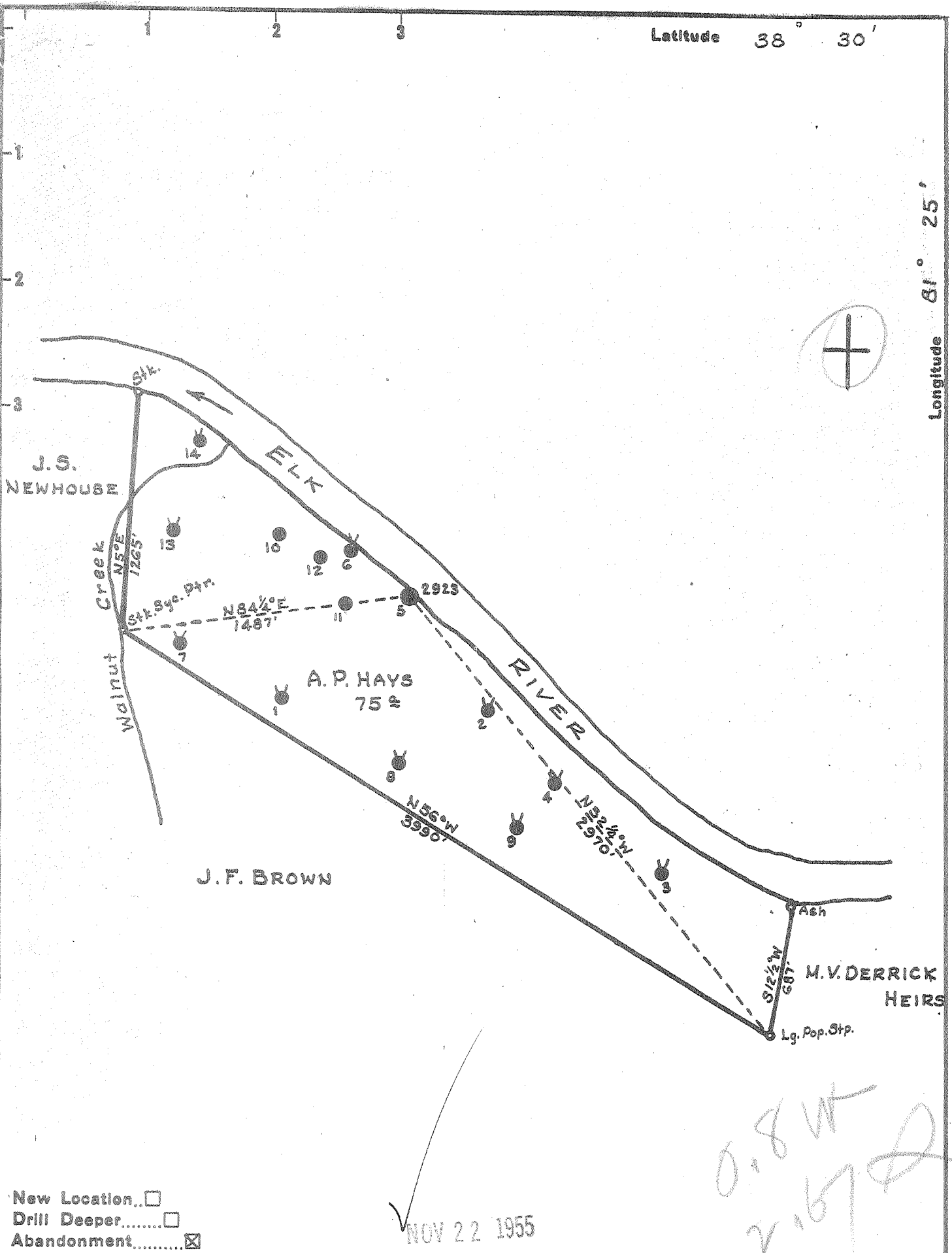

- New Location...
- Drill Deeper.....
- Abandonment.....

NOV 22 1955

0.8 W
2.167

Company	PIPE SALES & SUPPLY, INC.
Address	CHARLESTON, W. VA.
Farm	A. P. HAYS
Tract	Acres 75 Lease No. 759
Well (Farm) No.	5 Serial No. 2923
Elevation (Spirit Level)	601
Quadrangle	CLENDENIN
County	KANAWHA District BIG SANDY
Engineer	PAUL E. JOACHIM
Engineer's Registration No.	669
File No.	72-67 Drawing No.
Date	OCT. 20, 1955 Scale 1" = 660'

STATE OF WEST VIRGINIA
DEPARTMENT OF MINES
OIL AND GAS DIVISION
CHARLESTON

WELL LOCATION MAP
FILE NO. KAN-1221-A

+ Denotes location of well on United States Topographic Maps, scale 1 to 62,500, latitude and longitude lines being represented by border lines as shown.

- Denotes one inch spaces on border line of original tracing.

60217

A.P. HAYS No. 5 (2923) - PIPE SALES & SUPPLY, INC. - KAN-1221-A



STATE OF WEST VIRGINIA
DEPARTMENT OF MINES
OIL AND GAS DIVISION

1998

Quadrangle Clendenen
Kane
Permit No. 12-21-A

WELL RECORD

Oil or Gas Well _____
(KIND)

Company The Ohio Fuel Oil Company
Address Charleston, W. Va.
Farm A. P. Hays Acres 75
Location (waters) Elk River (Walnut Creek)
Well No. 5, Serial 2923 Elev. 601'
District Big Sandy County Kenawha
The surface of tract is owned in fee by _____
Address _____
Mineral rights are owned by _____
Address _____
Drilling commenced June 15, 1912
Drilling completed July 18, 1912
Date Shot _____ From _____ To _____
With _____
Open Flow _____ /10ths Water in _____ Inch
_____ /10ths Merc. in _____ Inch
Volume _____ Cu. Ft.
Rock Pressure _____ lbs. _____ hrs.
Oil _____ bbls., 1st 24 hrs.
Fresh water _____ feet _____ feet
Salt water _____ feet _____ feet

Casing and Tubing	Used in Drilling	Left in Well	Packers
Size			Kind of Packer
16			
13			
10	25'	25'	Size of
8 1/4	440'	pulled	
6 5/8	1394'	1394'	Depth set
5 3/16			
3			Perf. top
2			Perf. bottom
Liners Used			Perf. top
			Perf. bottom

CASING CEMENTED _____ SIZE _____ No. Ft. _____ Date _____

COAL WAS ENCOUNTERED AT _____ FEET _____ INCHES
_____ FEET _____ INCHES _____ FEET _____ INCHES
_____ FEET _____ INCHES _____ FEET _____ INCHES

Formation	Color	Hard or Soft	Top	Bottom	Oil, Gas or Water	Depth Found	Remarks
Sand				250			
Slate and Shell			250	490			
First Cow Run			490	550			
Slate & Shell			550	775			
SALT SAND			775	1185			
Break			1185	1224			
Red Rock			1224	1240			
Little Lime			1240	1330			
Slate & Shells			1330	1385			
BIG LIME			1385	1515			
Keener Sand			1515	1545			
Slate			1545	1647			
Oil Sand (Weir)			1647	1668			
Total Depth				1668			

RECEIVED
MAY 19 1955
WEST VIRGINIA
DEPT. OF MINES
MAR 28 1957