

Latitude 38° 25'

Longitude 81° 15'

ANNA ORT



ANNA ORT

A. H. MULLINS

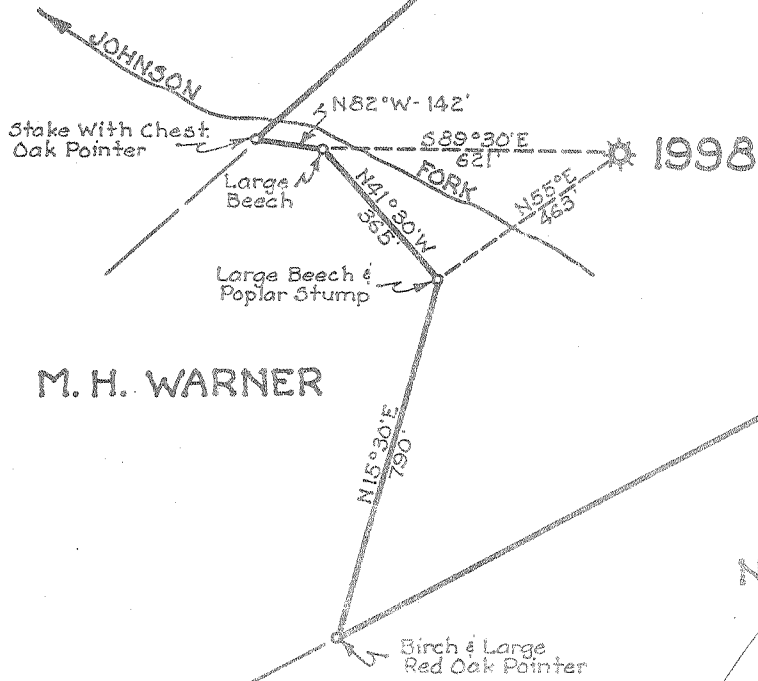

New Location...   
 Drill Deeper.....   
 Abandonment.....

JAN. 23 1956

2.41 W  
 1.72 Q

Company UNITED FUEL GAS CO.  
 Address CHARLESTON, W. VA.  
 Farm ANNA ORT  
 Tract \_\_\_\_\_ Acres 20 Lease No. 16640  
 Well (Farm) No. \_\_\_\_\_ Serial No. 1998  
 Elevation (Spirit Level) 1150.0'  
 Quadrangle CLENDENIN  
 County KANAWHA District ELK  
 Engineer Hubert K. Ferrell  
 Engineer's Registration No. 2529  
 File No. 80-61 Drawing No. \_\_\_\_\_  
 Date 1-3-56 Scale 1"=400'

STATE OF WEST VIRGINIA  
 DEPARTMENT OF MINES  
 OIL AND GAS DIVISION  
 CHARLESTON

WELL LOCATION MAP  
 FILE NO. KAN-1233-A

+ Denotes location of well on United States Topographic Maps, scale 1 to 62,500, latitude and longitude lines being represented by border lines as shown.

- Denotes one inch spaces on border line of original tracing.

6-6-220



STATE OF WEST VIRGINIA  
DEPARTMENT OF MINES  
OIL AND GAS DIVISION

1955

Quadrangle Clendenin

WELL RECORD

Oil or Gas Well Gas

(KIND)

Permit No. 1723-A

Company UNITED FUEL GAS CO.

Address P.O. Box 1273, Charleston 25, W. Va.

Farm Anna Ort Acres 20

Location (waters) Johnson Fork

Well No. 1998 Elev. 1150'

District Elk County Kanawha

The surface of tract is owned in fee by \_\_\_\_\_  
Address \_\_\_\_\_

Mineral rights are owned by Lillian O. Duff  
1115 Camden Dr. Address Charleston, W. Va.

Drilling commenced 9-12-28

Drilling completed 9-28-28

Date Shot \_\_\_\_\_ From \_\_\_\_\_ To \_\_\_\_\_

With \_\_\_\_\_

Open Flow \_\_\_\_\_ /10ths Water in \_\_\_\_\_ Inch  
8 /10ths Merc. in 2 Inch

Volume 497,280 Cu. Ft.

Rock Pressure 215 lbs. \_\_\_\_\_ hrs.

Oil \_\_\_\_\_ bbls., 1st 24 hrs.

Fresh water 170 feet \_\_\_\_\_ feet

Salt water \_\_\_\_\_ feet \_\_\_\_\_ feet

Casing and Tubing	Used in Drilling	Left in Well	Packers
Size			
16			Kind of Packer <u>Anchor</u>
13			
10			Size of <u>3"x8-1/4"x16"</u>
8 1/4		<u>647'4"</u>	Depth set <u>1012'9"</u>
6 5/8			
5 3/16		<u>1061'11"</u>	Perf. top _____
3			Perf. bottom _____
2			Perf. top _____
Liners Used			Perf. bottom _____

CASING CEMENTED \_\_\_\_\_ SIZE \_\_\_\_\_ No. Ft. \_\_\_\_\_ Date \_\_\_\_\_

COAL WAS ENCOUNTERED AT 233 FEET 238 INCHES  
400 FEET 60 INCHES FEET INCHES  
FEET INCHES FEET INCHES

Formation	Color	Hard or Soft	Top	Bottom	Oil, Gas or Water	Depth Found	Remarks
Conductor			0		Water at 170'		
Sand			16	150			
Slate			150	165			
Lime			165	233	Gas 1023-1031'		
Coal			233	238	Gas 1043-1045		
Sand			238	320			
Lime			320	400			
Coal			400	405			
Sand			405	552			
Slate			552	597			
Sand			597	630			
Slate & Shell			630	935			
Sand			935	985			
Slate			985	1000			
Lime			1000	1029			
Gas Sand			1029				
Total depth			1054'				

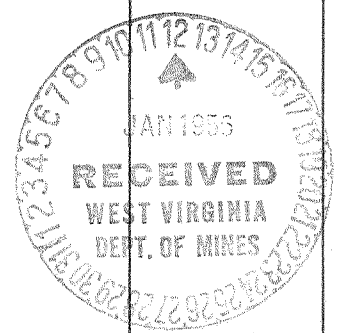

JUNE 21 1956

