

Latitude 38° 25'

Longitude 81° 30'

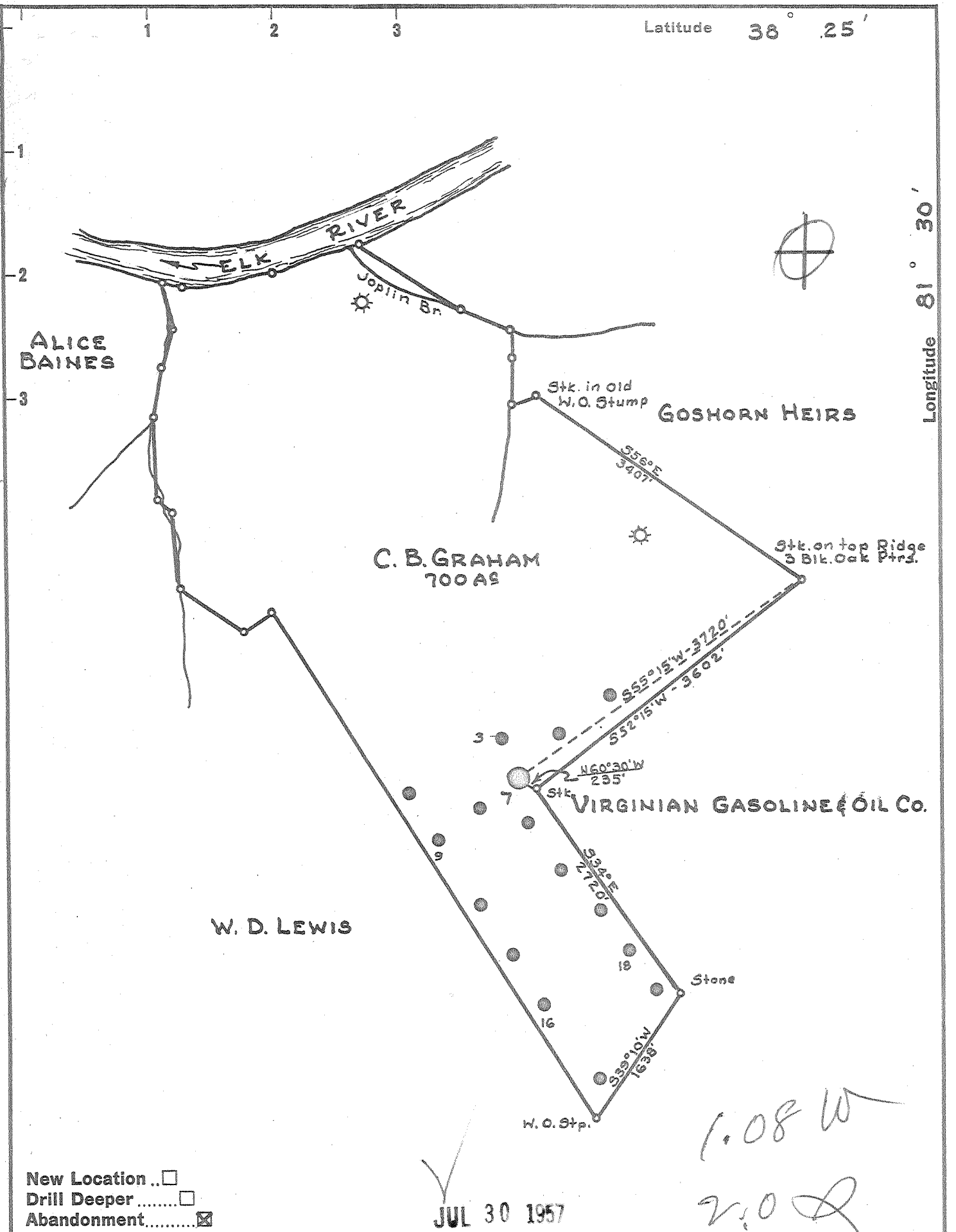

New Location ..
 Drill Deeper
 Abandonment

JUL 30 1957

Company RICHARD JACKSON
 Address CHARLESTON, W. VA.
 Farm C. B. GRAHAM
 Tract _____ Acres 700 Lease No. _____
 Well (Farm) No. 7 Serial No. F2940
 Elevation (Spirit Level) 1072
 Quadrangle CHARLESTON
 County KANAWHA District ELK
 Engineer PAUL E. JOACHIM
 Engineer's Registration No. 669
 File No. 66-61 Drawing No. _____
 Date JULY 12, 1957 Scale 1"=1320'

STATE OF WEST VIRGINIA
 DEPARTMENT OF MINES
 OIL AND GAS DIVISION
 CHARLESTON

WELL LOCATION MAP
 FILE NO. KAN-1260-A

+ Denotes location of well on United States Topographic Maps, scale 1 to 62,500, latitude and longitude lines being represented by border lines as shown.

- Denotes one inch spaces on border line of original tracing.

6-0215

C. B. GRAHAM No. 7 (F-2940) - RICHARD JACKSON - KAN-1260-A



2026

STATE OF WEST VIRGINIA
DEPARTMENT OF MINES
OIL AND GAS DIVISION

Quadrangle Charleston
Permit No. Ab 1760-A

WELL RECORD

Oil or Gas Well (KIND)

Company South Penn Natural Gas Company
Address Parkersburg, W. Va.
Farm C. B. Graham Acres 700
Location (waters) _____
Well No. 7 Elev. 1072
District Blk County Kanawha
The surface of tract is owned in fee by _____
Address _____
Mineral rights are owned by C. B. Graham
Charleston, W. Va. Address _____
Drilling commenced December 1, 1917
Drilling completed March 21, 1918
Date Shot _____ From _____ To _____
With _____
Open Flow /10ths Water in _____ Inch
/10ths Merc. in _____ Inch
Volume _____ Cu. Ft.
Rock Pressure _____ lbs. _____ hrs.
Oil _____ bbls., 1st 24 hrs.
Fresh water _____ feet _____ feet
Salt water _____ feet _____ feet

Casing and Tubing	Used in Drilling	Left in Well	Packers
Size			Kind of Packer
16			
13			
10			Size of
8 1/4	<u>1938'</u>	<u>1938'</u>	Depth set
6 3/8 7"			
5 3/16			
3			Perf. top
2			Perf. bottom
Liners Used			Perf. top
			Perf. bottom

CASING CEMENTED _____ SIZE _____ No. Ft. _____ Date _____
COAL WAS ENCOUNTERED AT _____ FEET _____ INCHES
_____ FEET _____ INCHES FEET _____ INCHES
_____ FEET _____ INCHES FEET _____ INCHES

Formation	Color	Hard or Soft	Top	Bottom	Oil, Gas or Water	Depth Found	Remarks
Clay			0	12			
Slate			12	40			
Line			40	75			
Sand			75	90			
Slate			90	115			
Line			115	130			
Sand			130	145			
Slate			145	200			
Line			200	260			
Sand			260	300			
Slate			300	360			
Line			360	430			
Sand			430	500			
Line			500	560			
Slate			560	600			
Sand			600	700			
Slate			700	730			
Line			730	800			
Sand			800	840			
Line			840	900			
Slate			900	940			
Line			940	960			
Slate			960	1000			
Sand			1000	1640	- Salt		
Slate			1640	1645			
Sand			1645	1655			
Slate & Shells			1655	1685			
Maxon Sand			1685	1705			
Little Line			1705	1725			
Slate			1725	1730			
Line			1730	1740			
Pencil Cove			1740	1746			
Big Line			1746	1900			
Keener Sand			1900	1934			
Big Injun			1934	1975			
Line			1975	1985			
Slate			1985	12000			

SEP 27 1957 RECEIVED WEST VIRGINIA

JUL 1957 RECEIVED WEST VIRGINIA DEPT. OF MINES

DEC 6 1957 (Over)

Formation	Color	Hard or Soft	Top	Bottom	Oil, Gas or Water	Depth Found	Remarks
Line			2000	2015			
Slate			2015	2030			
Sandy Sand			2030	2050			
Slate & Shells			2050	2110			
Weir Sand			2110	2179	Blk Oil	2112-2115	
Slate			2179	2183	Oil	2129-2135	
Total Depth				2183	Oil	2148-2158	

Date _____, 19____

APPROVED _____, Owner

By _____ (Title)