

Latitude 39 ° 35''

Longitude 81 ° 15'

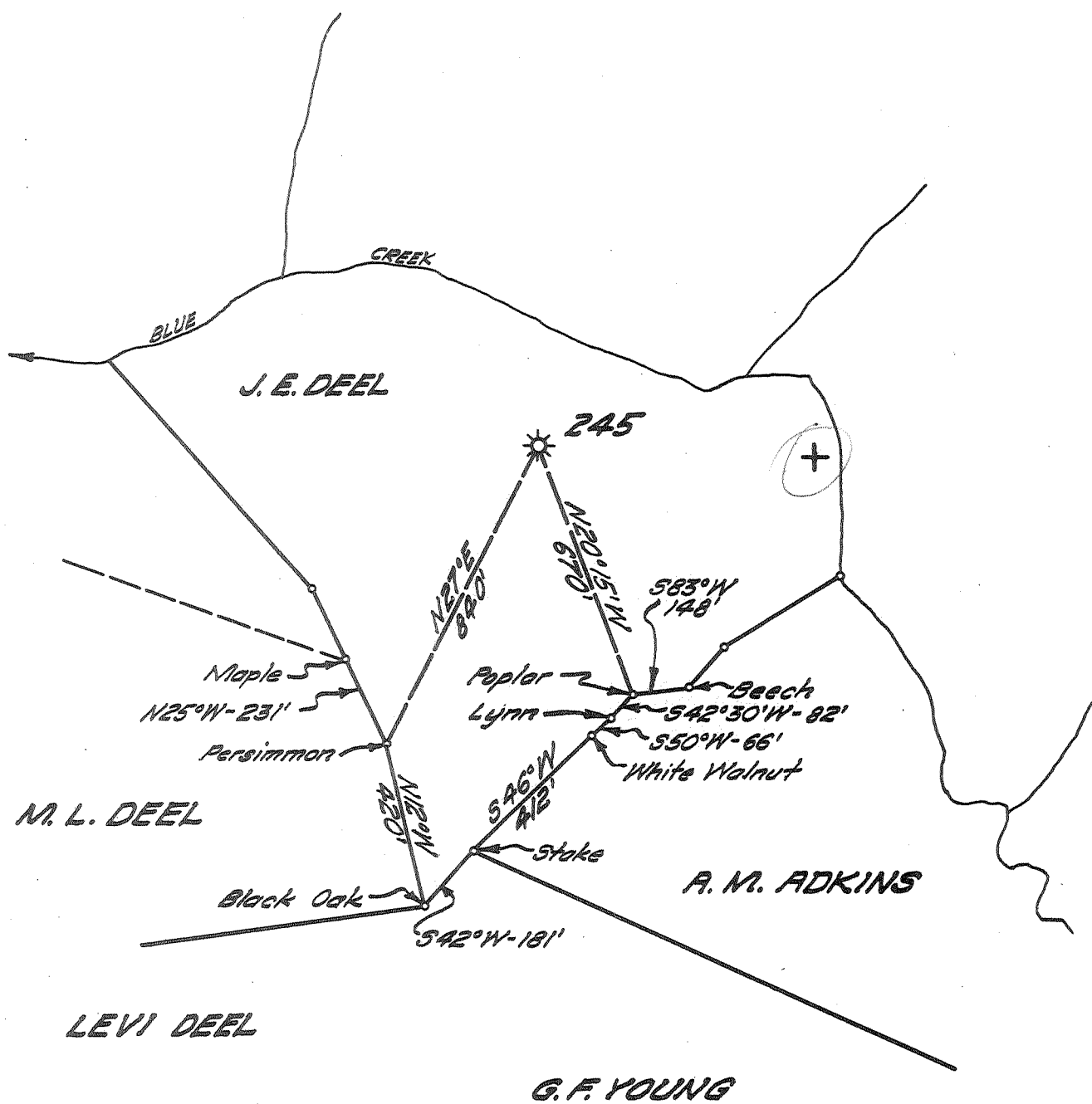

New Location
 Drill Deeper
 Abandonment

JUN 6 1960

now
47

Company UNITED FUEL GAS CO.
 Address CHARLESTON, W. VA.
 Farm J. E. DEEL
 Tract _____ Acres 60 Lease No. 4448
 Well (Farm) No. _____ Serial No. 245
 Elevation (Spirit Level) 900.21
 Quadrangle WALTON
 County KANAWHA District BIG SANDY
 Engineer Paul G. ...
 Engineer's Registration No. 669
 File No. 80-69 Drawing No. _____
 Date 5-12-60 Scale 1" = 400'

STATE OF WEST VIRGINIA
 DEPARTMENT OF MINES
 OIL AND GAS DIVISION
 CHARLESTON

WELL LOCATION MAP
 FILE NO. KAN-1303 H

+ Denotes location of well on United States Topographic Maps, scale 1 to 62,500, latitude and longitude lines being represented by border lines as shown.

- Denotes one inch spaces on border line of original tracing.

J. E. DEEL no. 245

O. F. G. Co.

KAN-1303-A



2063

STATE OF WEST VIRGINIA
DEPARTMENT OF MINES
OIL AND GAS DIVISION

Quadrangle Walton *SE*
Permit No. - B53A

WELL RECORD

Oil or Gas Well Gas
(KIND)

Company United Fuel Gas Company
 Address P.O. Box 1273; Charleston 25, W. Va.
 Farm J. E. Deel Acres 60
 Location (waters) Little Blue Creek
 Well No. 245 Elev. 900.21
 District Big Sandy County Kanawha
 The surface of tract is owned in fee by _____
 Address _____
 Mineral rights are owned by E. G. Robertson
 Address Clendenin, W. Va.
 Drilling commenced 3-31-10
 Drilling completed 5-13-10
 Date Shot - _____ From _____ To _____
 With _____
 Open Flow _____ /10ths Water in _____ Inch
 _____ /10ths Merc. in 3766 Inch
 Volume _____ Cu. Ft.
 Rock Pressure 460 lbs. _____ hrs.
 Oil _____ bbls., 1st 24 hrs.
 WELL ACIDIZED _____

Casing and Tubing	Used in Drilling	Left in Well	Packers
Size			Kind of Packer
16			
13			
10		165'	Size of
8 1/4		705	
6 5/8		1551	Depth set
5 3/16			1561'
3		1670	Perf. top
2			Perf. bottom
Liners Used			Perf. top
			Perf. bottom

CASING CEMENTED _____ SIZE _____ No. Ft. _____ Date _____

COAL WAS ENCOUNTERED AT 235 FEET 72 INCHES
410 FEET 24 INCHES 441 FEET 72 INCHES
555 FEET 36 INCHES FEET INCHES

WELL FRACTURED _____
 RESULT AFTER TREATMENT _____
 ROCK PRESSURE AFTER TREATMENT _____
 Fresh Water _____ Feet Salt Water 1072' Feet 1160'

Formation	Color	Hard or Soft	Top	Bottom	Oil, Gas or Water	Depth	Remarks
Sand			10	140	1st water	1072	
Coal			235	241	Hole full water	1160	
Sand			241	253			
Sand			361	410	Gas in Lime at 1605',		small show
Coal			410	412	Gas 1645-1656		
Coal			441	447			
Little Dunkard Sand			464	530	Test when shut in 7/10		Merc. 6-5/8" (3,766 M)
Sand			530	555			
Coal			555	558			
Big Dunkard Sand			629	725			
Break			725	740			
Gas Sand			955	1007			
Break			1007	1013			
1st Salt Sand			1013	1375			
Break			1375	1381			
Second Salt Sand			1381	1420			
Break			1430	1435			
Maxton Sand			1435	1490			
Little Lime			1490	1520			
Break			1520	1525			
Pencil Cave			1525	1540			
Big Lime			1540	1640	4' Bit left in hole below gas pay		
Big Injun			1640	1662			
Total Depth			1662'				

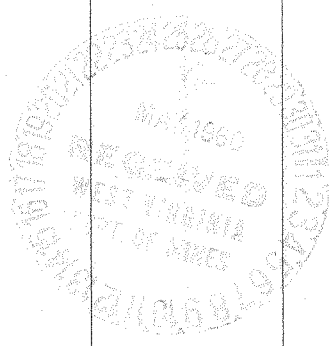

JAN 3 1961

