

1.70S  
 0.88W  
 27.5' loc  
 EA  
 06/24/50

1.70  
 2.88  
 4.58  
 0.88  
 2.25  
 3.13

7.5 OGIS topo location

7.5' loc \_\_\_\_\_ 15' loc 4.58S  
 \_\_\_\_\_ (calc.) 3.13W

Company WFG

Farm BG & S (1009)

Quad Newton (S12) other SW

County \_\_\_\_\_

District Big Sandy

WELL LOCATION MAP

File No. Kan 1304A

Latitude 38° 35'

# BROWN, GOSHORN & SWANN

Longitude 81° 10'

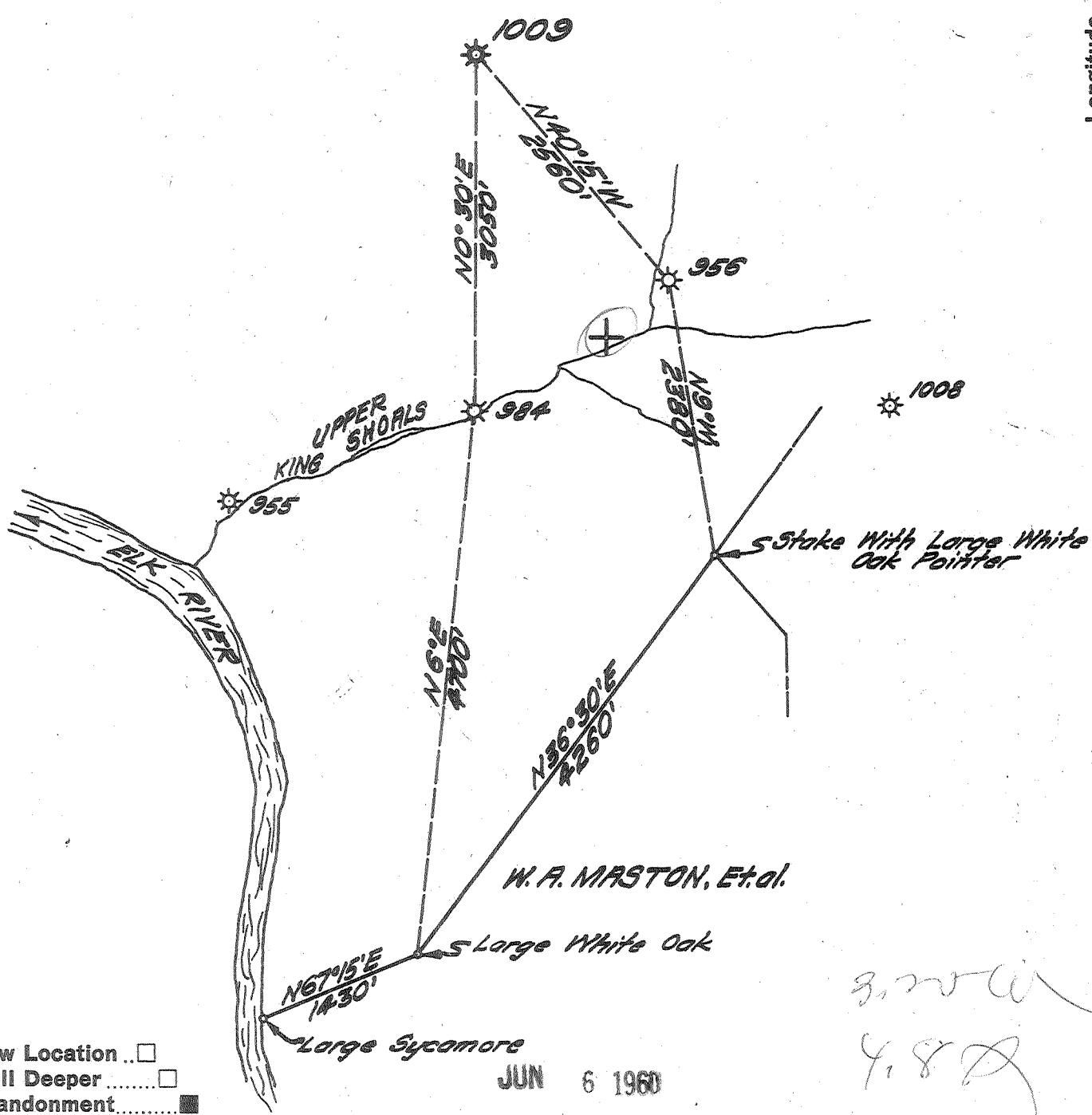

New Location ..   
 Drill Deeper .....   
 Abandonment .....

*3.200*  
*4.80*

Company UNITED FUEL GAS CO.  
 Address CHARLESTON, W.VA.  
 Farm BROWN, GOSHORN & SWANN  
 Tract \_\_\_\_\_ Acres 1500 Lease No. 1532  
 Well (Farm) No. \_\_\_\_\_ Serial No. 2274  
 Elevation (Spirit Level) 1122.50'  
 Quadrangle OTTER  
 County KANAWHA District BIG SANDY  
 Engineer Robert R. Jewell  
 Engineer's Registration No. 2529  
 File No. 82-71 Drawing No. \_\_\_\_\_  
 Date 5-6-60 Scale 1" = 1320'

STATE OF WEST VIRGINIA  
 DEPARTMENT OF MINES  
 OIL AND GAS DIVISION  
 CHARLESTON

## WELL LOCATION MAP

FILE NO. KAN-1304-A

+ Denotes location of well on United States Topographic Maps, scale 1 to 62,500, latitude and longitude lines being represented by border lines as shown.  
 - Denotes one inch spaces on border line of original tracing.



2062

STATE OF WEST VIRGINIA  
DEPARTMENT OF MINES  
OIL AND GAS DIVISION

Quadrangle Otter  
Permit No. 134/A

WELL RECORD

Oil or Gas Well Gas  
(KIND)

Company United Fuel Gas Company  
 Address P.O. Box 1273; Charleston 25, W. Va.  
 Farm Brown, Goshorn, & Swan Acres 2384-1/2 Fee  
 Location (waters) Upper King Shoals  
 Well No. 1009 Elev. 1122.50  
 District Big Sandy County Kanawha  
 The surface of tract is owned in fee by \_\_\_\_\_  
 Address \_\_\_\_\_  
 Mineral rights are owned by James F. Brown, III, Trustee, et al  
Box 88 Address Charleston, W. Va.  
 Drilling commenced 11-2-17  
 Drilling completed 12-21-17  
 Date Shot \_\_\_\_\_ From \_\_\_\_\_ To \_\_\_\_\_  
 With \_\_\_\_\_  
 Open Flow \_\_\_\_\_ /10ths Water in \_\_\_\_\_ Inch  
 \_\_\_\_\_ /10ths Merc. in \_\_\_\_\_ Inch  
 Volume \_\_\_\_\_ Cu. Ft.  
 Rock Pressure \_\_\_\_\_ lbs. \_\_\_\_\_ hrs.  
 Oil \_\_\_\_\_ bbls., 1st 24 hrs.  
 WELL ACIDIZED \_\_\_\_\_  
 WELL FRACTURED \_\_\_\_\_

Casing and Tubing	Used in Drilling	Left in Well	Packers
Size			
16			Kind of Packer _____
13			<u>Parm. Anchor</u>
10			Size of _____
8 1/4	<u>550'</u>	<u>Pulled</u>	<u>3" x 5-3/16" x 16"</u>
6 5/8		<u>1733' 8"</u>	Depth set _____
3		<u>1889' 4"</u>	<u>1784'</u>
2			Perf. top _____
Liners Used			Perf. bottom _____
			Perf. top _____
			Perf. bottom _____

CASING CEMENTED \_\_\_\_\_ SIZE \_\_\_\_\_ No. Ft. \_\_\_\_\_ Date \_\_\_\_\_  
 COAL WAS ENCOUNTERED AT 595 FEET 36 INCHES  
 \_\_\_\_\_ FEET \_\_\_\_\_ INCHES FEET \_\_\_\_\_ INCHES  
 \_\_\_\_\_ FEET \_\_\_\_\_ INCHES FEET \_\_\_\_\_ INCHES

RESULT AFTER TREATMENT \_\_\_\_\_  
 ROCK PRESSURE AFTER TREATMENT \_\_\_\_\_  
 Fresh Water \_\_\_\_\_ Feet Salt Water \_\_\_\_\_ Feet

Formation	Color	Hard or Soft	Top	Bottom	Oil, Gas or Water	Depth	Remarks
Sand			0	450	Reduced Hole at 1764'		
Slate			450	595	6-5/8" Casing set at 1714'		
Coal			595	598	8-1/4" Casing set at 550'		
Slate			598	900			
Gas Sand			900	1000	1st gas 1823' - 1828'		No Test
Slate			1000	1040	2nd Gas 1851' - 1854'		No Test
Salt Sand			1040	1490	3rd gas 1858' - 1866'		Test 6/10
Lime			1490	1570	Mercury through 6-5/8" Casing.		
Red Rock			1570	1598			
Maxon Sand			1598	1668			
Little Lime			1668	1696			
Slate			1696	1704			
Big Lime			1704	1802			
Keener			1802	1812			
Big Injun Sand			1812	1868			
Total Depth			1874'				

